

A Project By



MFHS INFRA

PROJECT PRIVATE LIMITED

(A Group Company of Silver City Builders & Developers)



DREAM

LOTUS

Where life blossoms

Commercial Cum Residential Apartment





DREAM
LOTUS

Where life blossoms

Welcome to Dream Lotus
 Dream Lotus is a thoughtfully designed 7-storey premium development combining elegant residences with strategically placed commercial spaces. Located directly on the main road, it offers unmatched connectivity, lifestyle comfort, and investment potential.



GROUND FLOOR PLAN

Highlight Features

- Prime main road property
- Excellent visibility for businesses
- Close to schools, hospitals, markets & public transport
- Easy connectivity to major city hubs

AREA STATEMENT

Shop No.	Super B/up Area
G-01	1588.415 Sq. Ft.





FIRST FLOOR PLAN



AREA STATEMENT

Shop No.	Super B/up Area
101	2186.411 Sq. Ft.



Highlight Features

- Prime Location Benefits
- Limited inventory – one flat per floor
- Premium residential demand
- High return commercial opportunity
- Strong resale & rental value

AREA STATEMENT

Flat No.	Super B/up Area
201 To 701	2165.878 Sq. Ft.



TYPICAL 2ND TO 7TH FLOOR PLAN

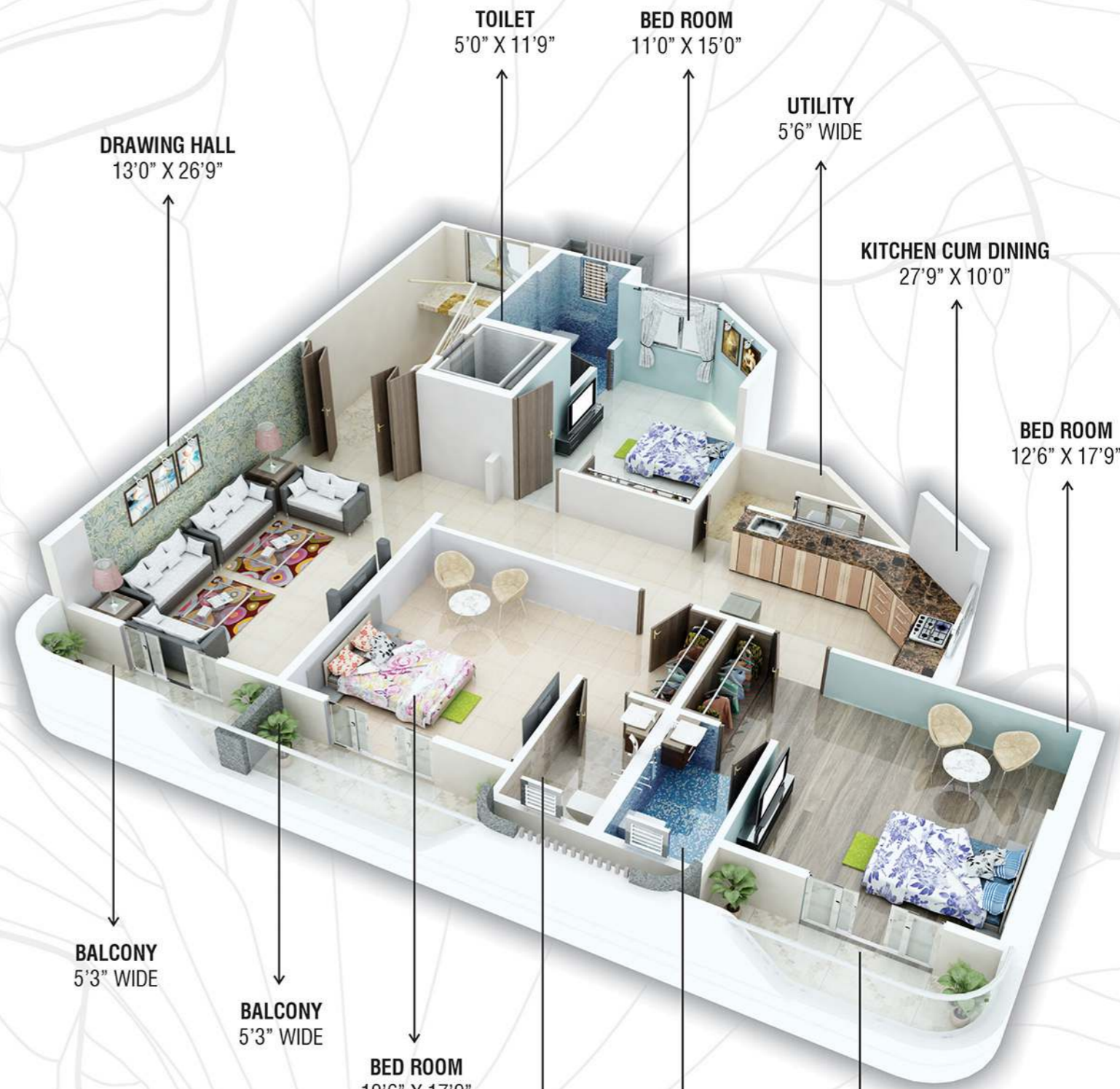

3 BHK Premium Flat

Images used for representation purpose only.



SPECIFICATION

- **BUILDING STRUCTURE**
R.C.C. frame structure. Earthquake resistant design and premium quality construction.
- **WALLS**
External walls 150 mm thick. Internal walls 115 mm thick.
- **PLASTER**
Internal walls with 12mm fanti plaster.
External walls with 20mm sand face plaster.
- **DOORS**
Veneer Mica on Main Door. Rest of the doors shall be flush doors with R.C.C. door frames.
- **WINDOWS**
Powder coated aluminium French Window.
- **TILES**
Vitrified tile of 2' x 4' size flooring in all rooms.
Anti-skid tiles flooring in bathrooms.
Wooden pattern tiles flooring in balconies.
- **POP (FALSE CEILING)**
Modular POP with LED lights in all Bedrooms and Bathroom.
- **PAINTING FINISHES**
Internal walls to be painted in distemper.
External walls to be painted in Weather proof Ultima paint.
- **KITCHEN**
Modular kitchen with stainless steel sink and dado up to lintel level.
- **ELECTRICAL**
Polycab wires with 4.5 points in all Rooms.
Inverter point and A.C. point is provided.
- **TOILETS**
Jaquar or equivalent bath fittings in bathroom.
Indian & European WC with premium quality fittings.
Internal plumbing pipes of CK Birla group.
- **WATER SUPPLY**
24 X 7 water supply through corporation and Borewell.
- **LIFT**
Johnson lift 6 to 8 passengers with Generator backup.

NOTE

Registration, Stamp Duty charges extra as applicable. Documents preparation charges extra as applicable. Extra charges 30,000/- for MSEB Meter & Water Charges. Extra work to be done with extra payment in advance. GST and any other Govt. taxes, if applicable will be charge extra.

OUR COMPLETED & ON-GOING PROJECTS



Dream Palacia
Bhupesh Nagar, Nagpur.

Dream Mansion
Sadiqabad Colony, Nagpur.

Dream Elite
Gokul Housing Society, Nagpur.

Dream Orbit
Godhani Main Road, Nagpur.

Dream Royal
RMS Colony, Nagpur.

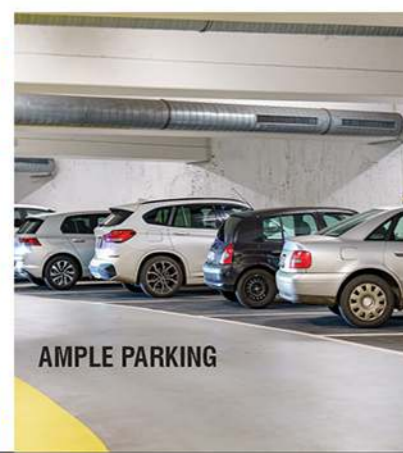
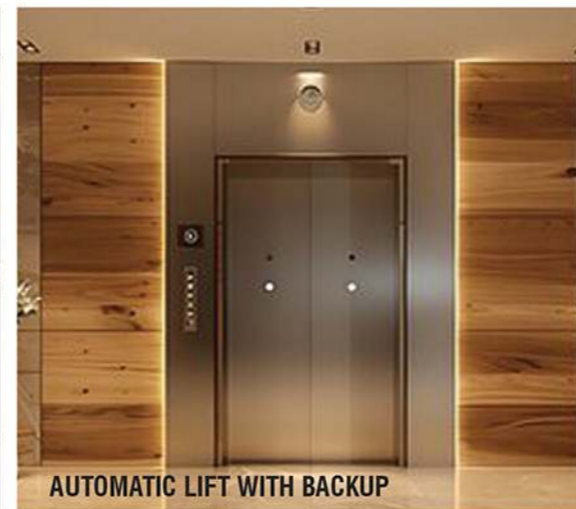

Dream Classic
Manish Nagar, Nagpur.



Dream Serene
Awasthi Nagar, Nagpur.



Dream Galaxy
Jaripatka, Nagpur.



Dream Arcade
Awasthi Chowk, Nagpur.



Dream Height
Jafar Nagar, Nagpur.



Dream Paradise
Behind shyam Lawn, Nagpur.

LOCATION PLAN



Scan QR For Location

Site Address : Plot No. 22 A,
Sharamik Sahakari Sanstha, Ring Road, Dhaba, Nagpur.

A Project By



MFHS INFRA

PROJECT PRIVATE LIMITED

(A Group Company of Silver City Builders & Developers)

Call : 90962 26669 / 97661 48066

OFFICE : Plot No. 10, Utkarsh G.N.S.S., Awasthi Nagar, Nagpur. Web : www.mfhsinfra.com

Architect

Ar. Mohsin Sheikh : 8087810902

Structural Designer

Ashish Soni

Legal Advisor

Adv. Chetan Sawalkar : 9096690652

This brochure is only a conceptual presentation of the project & not a legal offering. The promoters reserve the rights to add, delete or alter the above specification & plans as deemed fit. Images used are for representation purpose only.

