

PROPOSED LAY OUT PLAN OF  
" SHREE RAM VIHAR "

AT VILLAGE- MANPUR TILAWALA,DIGGI MALPURA ROAD,  
TEH. SANGANER, JAIPUR  
Under:- HARI NAGAR GRAH NIRMAN SAHAKARI SAMITY  
LTD. JAIPUR      REGISTRATION NO.- L/2724

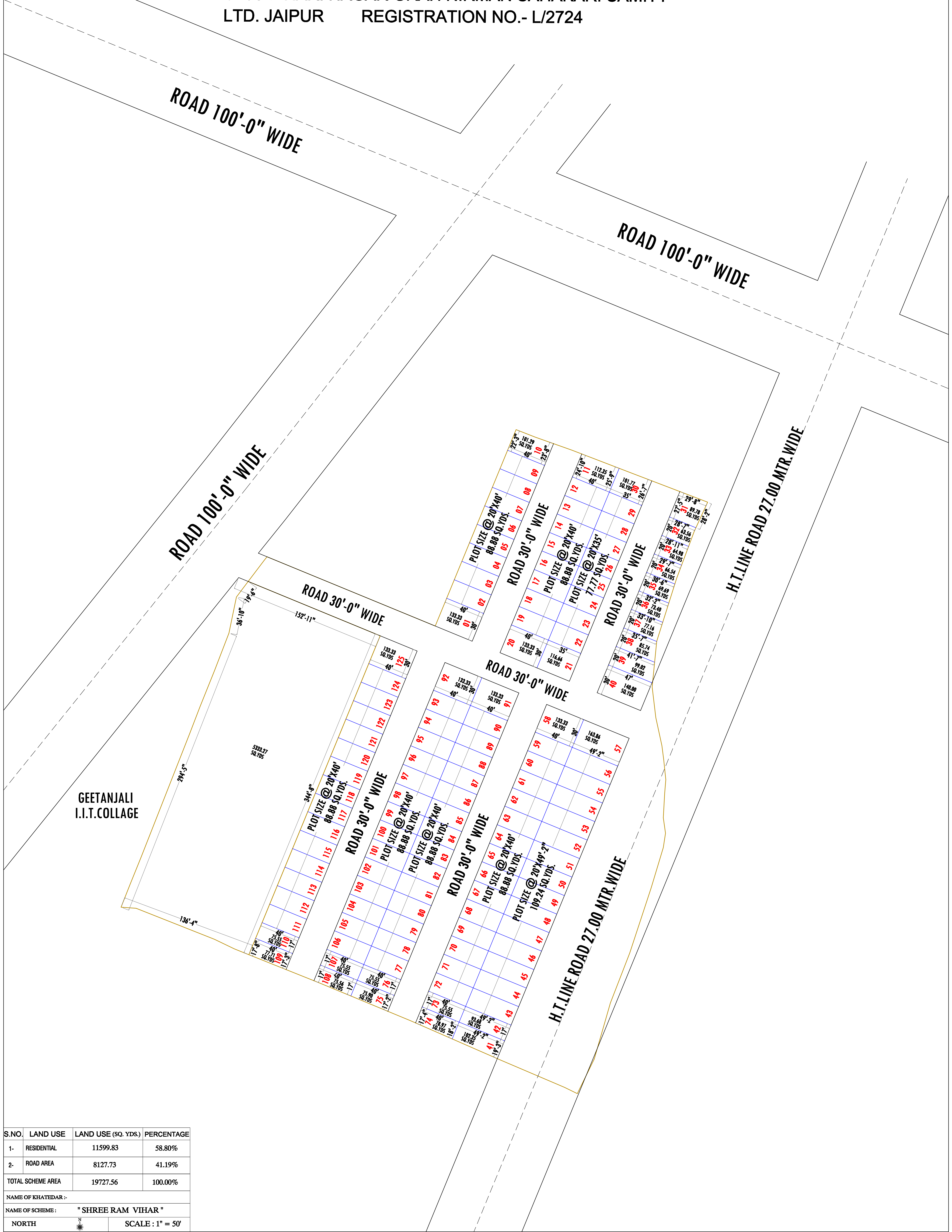
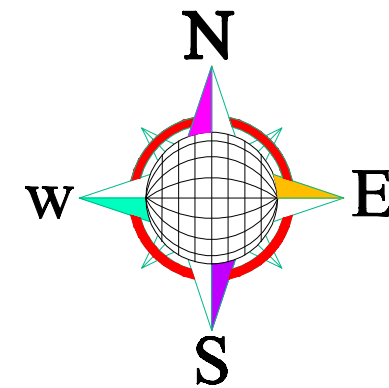

S.NO.	LAND USE	LAND USE (SQ. YDS.)	PERCENTAGE
1-	RESIDENTIAL	11599.83	58.80%
2-	ROAD AREA	8127.73	41.19%
TOTAL SCHEME AREA		19727.56	100.00%
NAME OF KHATEDAR :-			
NAME OF SCHEME : " SHREE RAM VIHAR "			
NORTH		SCALE : 1" = 50'	