

A Project By:



www.shreedaan.com

 [shreedangroups](#)  [shreedangroup](#)

 [shreedangroup](#)  [shreedangroup](#)

www.eyecdesign.in

Green
Leaves

A NEW DIRECTION IN LUXURY

Green Leaves

A NEW DIRECTION IN LUXURY

A Luxurious Home is a DREAM you live for lives.

With Green Leaves experience a new direction in luxury with stylish amenities and ample parking. It is conveniently located near Railway Station in Chala, Vapi with close proximity to KHOJA SOCIETY, educational institutions & Hospitals. Green Leaves, A Project by Shreedaan Developers offers you a new qualitative lifestyle at an affordable price.

This is the prestigious project by India's biggest Celebrity Architect – Ar. Reza Kabul. He is better known for the WORLDS BEST ARCHITECTURE PLANNING.



ASSOCIATES IN OUR VISION

Architect Reza Kabul is a 30 year old institution in the design world. It is a comprehensive global design studio that has worked on some of the most iconic landmarks in India and abroad, with offices in San Francisco, Mumbai and Pune. The firm has an impressive list of clients from around the world.

Green Leaves is the perfect manifestation of their philosophy of creating spaces that gives a sense of tradition in favour of Modernity & Luxury.



Ground Floor Plan

- LEGEND**
- 01 ENTRANCE GATE
 - 02 SECURITY CABIN
 - 03 CLUB ENTRANCE
 - 04 HOME THEATER
 - 05 MALE TOILET
 - 06 FEMALE TOILET
 - 07 MULTIPURPOSE ROOM
 - 08 SERVICE AREA
 - 09 DECK
 - 10 WATER BODY
 - 11 SITTING
 - 12 CHILDREN PLAY AREA
 - 13 D.G SET
 - 14 PATHWAY
 - 15 GARDEN
 - 16 SWING
 - 17 VILLA
 - 18 PARKING

SHOP	SQ.FT	SHOP	SQ.FT	SHOP	SQ.FT
01	228.63	04	202.47	07	202.04
02	237.67	05	234.65	08	234.66
03	202.58	06	202.04	09	362.10

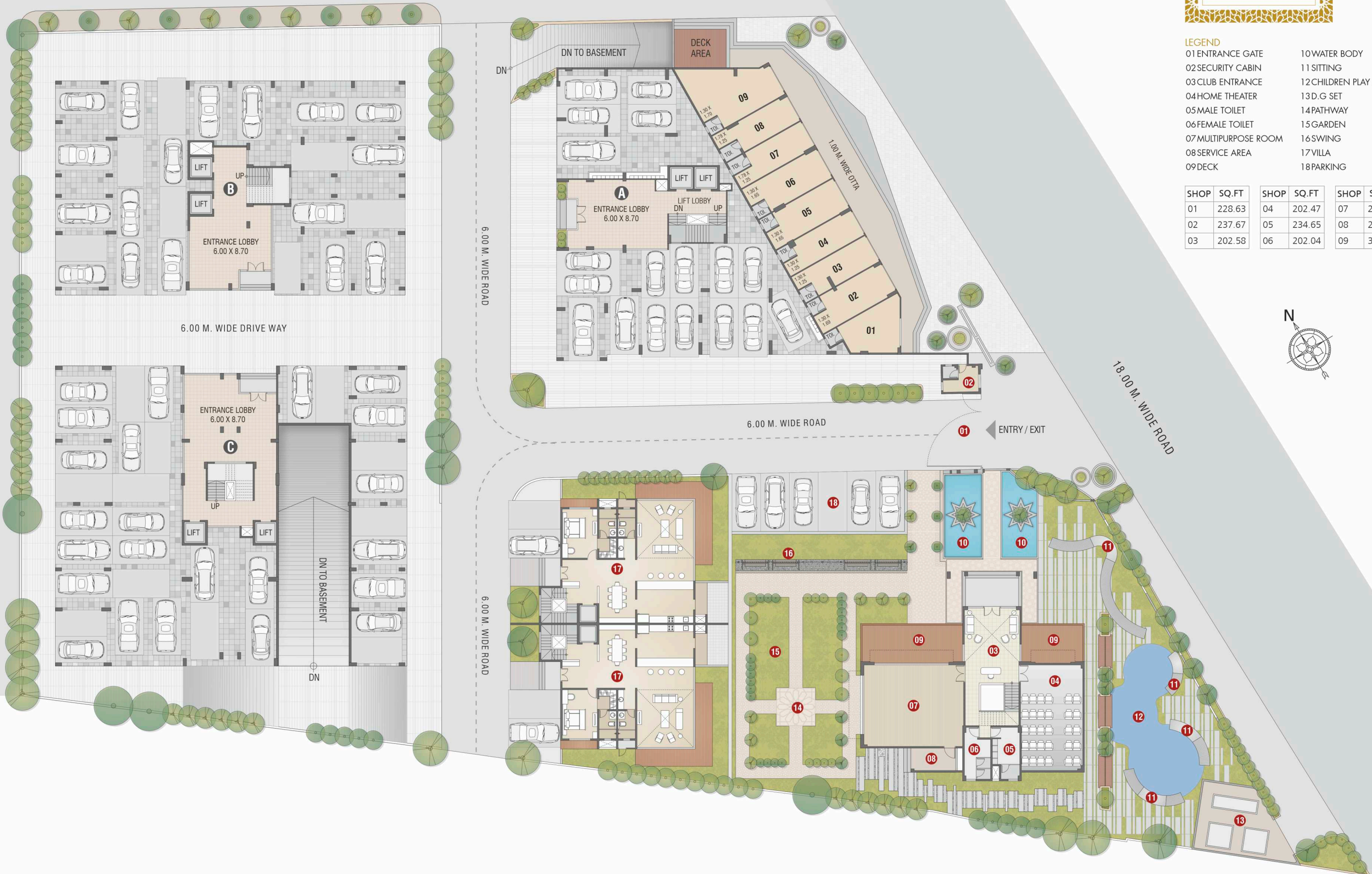
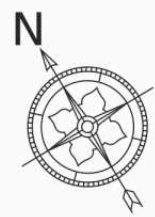



Amusement & Entertainment
with refreshing environments

Enjoy the new luxury by being a member of The Club House and unwinding yourself to the lush green garden. Be fit & relax while spending Quality Time in this fast-moving pace of life with your loved ones to enjoy their own space.





The Club House

MEMBER BENEFIT



Super Fun & Energy & Mind Boosting Indoor Game Equipments.



Gymnasium with quality Equipments.



Multi – Purpose Banquet Hall for events such as Parties, get-to-gather & Celebrations.



Theatre for Movie Watching with Family & Friends.



Landscape Garden with Children's Play Area.



Landscaped deck areas with deck furniture.





An Exquisite World of
Privileged Living

It is a cosy place to live-in for a lifetime
while infusing goodness and togetherness.

An Invitation to Live A Perfect Life

PROJECT FEATURES

G+ 7 Storied Residential + Commercial Complex

Aesthetically designed 2 BHK, 3 BHK, 3 BHK (LX),
4 BHK Flats, 5 BHK Villas & Shops

Earthquake resistant RCC Structure

Elegant & well designed entrance lobby

2 fully automatic high speed elevator

Generator backup for lift & common areas

Ground floor car parking spaces

Located Amidst The Serene Surroundings of Vapi





1st To 5th & 7th Floor Building - A





Typical Floor Plan

6th Floor Building - A

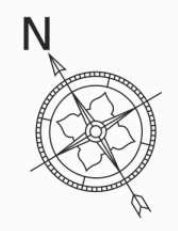



101. Mr. Adesh Patel	102. Mr. Kiran Patel
201. Mr. Ravi Soni	202. Mr. Pramod Tripathi
301. Mr. Anil Shah	302. Mr. Sagar Mishra
401. Mr. Avinash Sobani	402. Mr. Dhruv Mehta
501. Mr. Brijesh Soni	502. Mr. Rishi Patel
601. Mr. Ashay Patel	602. Mr. Ajit Mehta
701. Mr. Ashwin Gupta	702. Mr. Anil Kumar
801. Mr. Nikesh Tripathi	802. Mr. Naman Joshi
901. Mr. Anish Jain	902. Mr. Bharat Dave
1001. Mr. Rakesh Sharma	1002. Mr. Karishma Jain
1101. Mr. Yes Jain	1102. Mr. Aditya Ramesh
1201. Mr. Harsh Joshi	1202. Mr. Bhavik Jain
1301. Mr. Divyanshu Jain	1302. Mr. Manoj Soni

green
Leaves





Ground Floor Plan





First Floor Plan



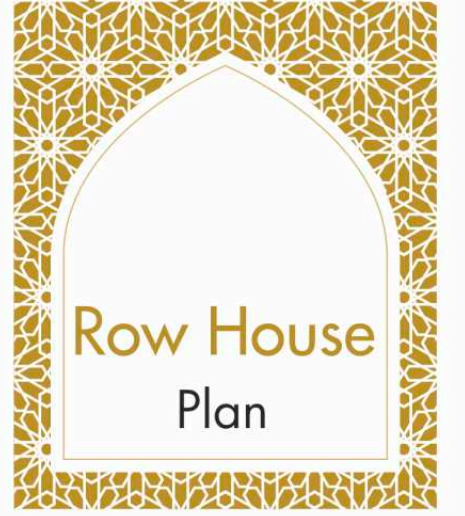

Second Floor Plan



All That your Heart
Desires is Here





3 BHK
Unit Plan

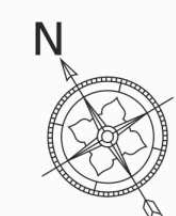

Building - B

3 BHK
Unit Plan



Building - B

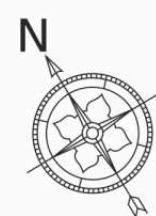

4 BHK
Unit Plan

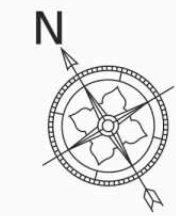

Building - C

3 BHK LX
Unit Plan

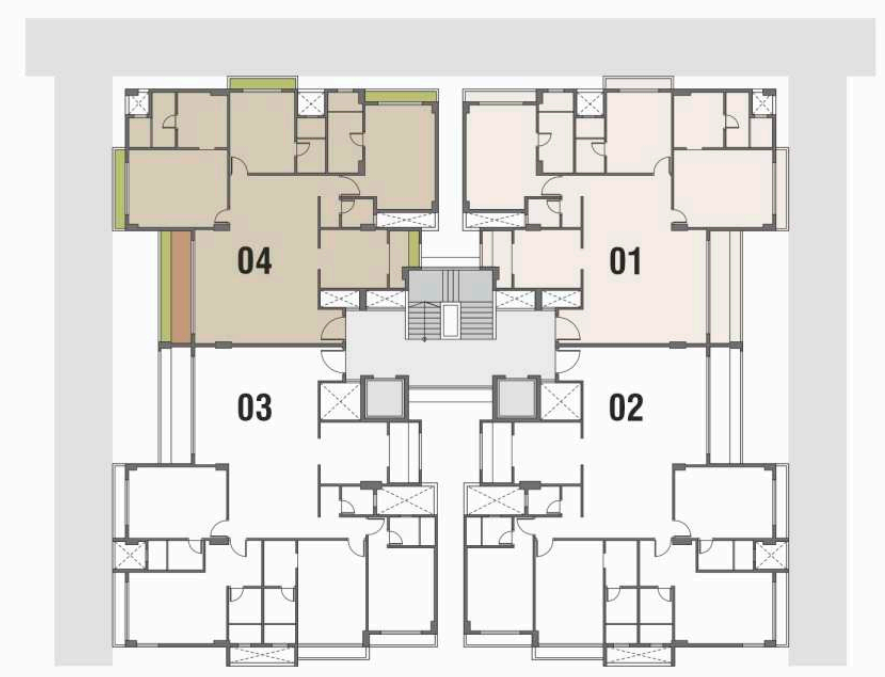
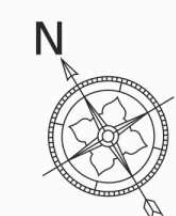

Building - C

Basement Plan

Building - A & B,C

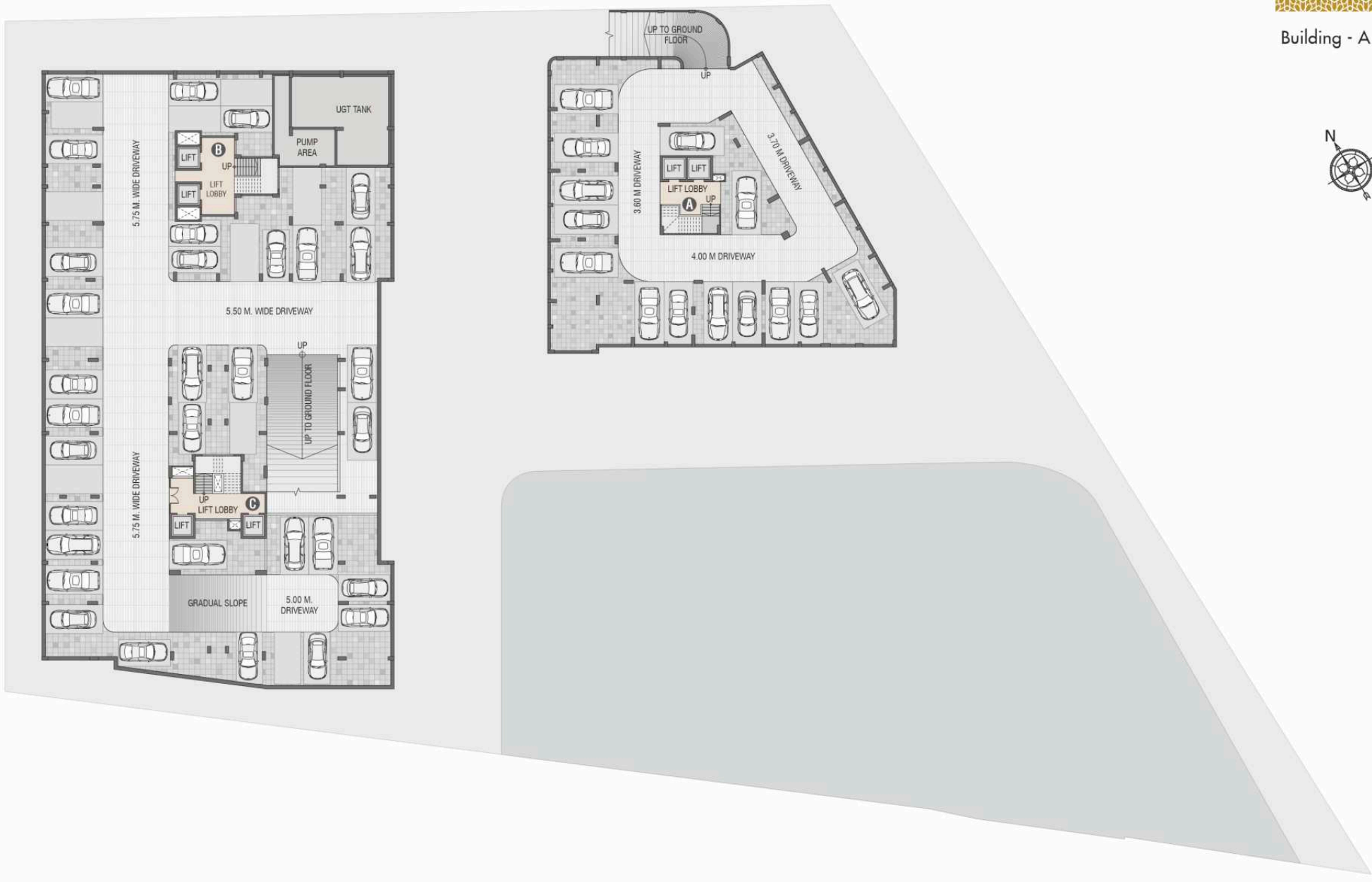

Typical Floor Plan

- LEGEND**
- 01 GAME ROOM
 - 02 MALE TOILET
 - 03 FEMALE TOILET
 - 04 GYM



Project Features & Amenities

- Entrance Foyer:**
 - Elegant & Spacious Entrance foyer for each building.
 - Waiting Lounge in each building.
- Elevators:**
 - Dedicated High Quality Two Elevators in Each Building.
 - Designer Elevator Cab Interior.
- Security System:**
 - 24*7 Fire Safety Provision
 - CCTV Surveillance with Night Vision within the Campus
 - Video door phone system for each flat.
- Lightning Design:**
 - Dynamic Lightning Design by professional lightning consultant & designer.
- Exterior Surfaces:**
 - Texture/ Weather proof Paints on Outside Wall surface.
- Interior Wall Finishes:**
 - Plaster with wall putty.
- Power:**
 - DG Backup for elevator, water pumps, common area lighting.
- Flooring & Railing:**
 - Premium Finished Superior Vitrified Flooring.
 - Natural Granite Platform in Kitchen.
 - All Bathrooms & Kitchen finished with superior Quality Tiles with lintel level.
 - Exterior Tuffen Glass Railing.
- Electrification:**
 - Single / Three Phase Power Connection.
 - Quality electrical fittings, concealed copper wiring with ample light & power points.
- Plumbing:**
 - Concealed Toilet Fittings & Sanitary Ware of Jaguar, Roca, Hindware or equivalent brand.
- Parking:**
 - Ground floor & Basement Parking Facility.
 - Electrical Car Charging Point.

Disclaimer: Any amendments in rules & regulations by any authority will be bound to all members. All expenses of legal document, GEB, extra stamp duty, GST(if applicable), society maintenance will be borne by member • External changes shall not be allowed • Internal changes will be permitted with permission and extra cost. Before possession, execution of sale deed is compulsory • Members are bound to pay installments regularly and irregularity in payment may cause cancellation of booking • Developer reserves the right of any changes in the scheme & it shall be bound to all member • Developers holds the terrace rights • This brochure is only for private circulation for general information to the member & shall not form a part of any agreement • Dimensions shown in the unit plan are subject to variation and may vary upto 3% of the total RERA carpet area of the unit • The views shown in the brochure are artist's Impression only and not a legal offering and not will be part of the agreement.

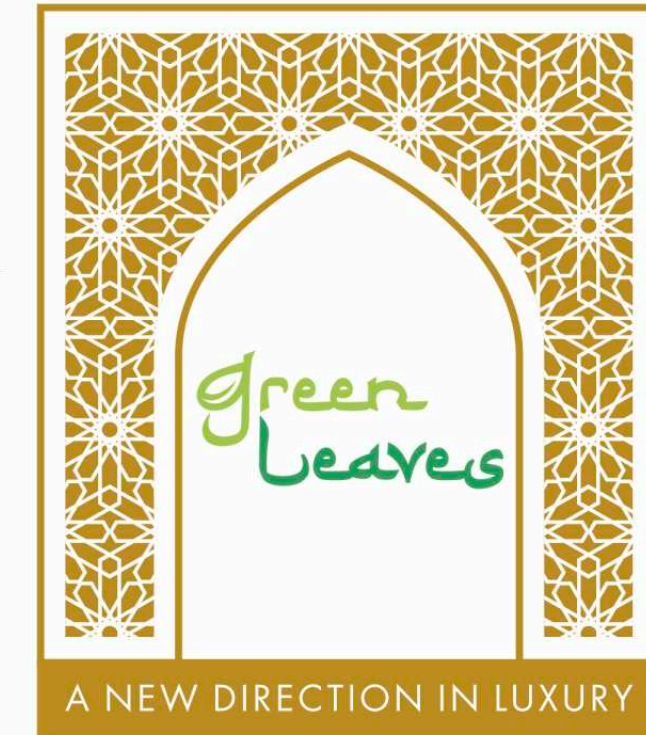

Address: GREEN LEAVES, Custom Road,
Opp. Khoja Society, Chala, Vapi – 396191.

Booking Contact:
99787 00060, 99799 56408

www.greenleavesvapi.in



Landscape Architect

TOPIO DESIGN STUDIO

RERA Reg. No.:
PR/GJ/VALSAD/PARDI/SUDA/MAA07902/120121

(www.gujrera.gujarat.gov.in)