



Live a celestial life, every minute, everyday.  
Live life the Chandra way.

chandra  
चंद्रा

रेसीडेन्सी | RESIDENCY  
MOLLAR \* CORLIM \* GOA





रेसीडेंसी | RESIDENCY  
MOLLAR \* CORLIM \* GOA

Welcome to the peace and quiet of the Chandra Residency, that which is a rarest commodity. If you always longed to live in the

countryside than this is it, this is it! The lush greens and the verdant browns and reds of the fragrant countryside will take you on a nostalgic trip back to your childhood, the sound of the sparrows and the koyals will make a poet of you. And if you gaze out of your window, you will find the stars and all the celestial beings just circling close by.

Away from the noise and clutter of the city, Chandra Residency has risen from the very same earth you dreamed of, lounging in a quite, peaceful location at Molar-Corlim, dotted with green trees and old country homes along the road that leads to it. Corlim village is minutes away from the World Heritage sites of Old Goa (erstwhile capital of the Portuguese in Goa). The apartments are centrally located near a small market, medical facilities, schools and other amenities.

Now, that would explain why even the celestial beings want to hang around Chandra Residency.



#### MODE OF PAYMENT ( Percentage to total cost)

1. On signing of AGREEMENT OF SALE -----30%
2. On completion of plinth level-----15%
3. On completion of first slab-----10%
4. On completion of masonry of respective floor--10%
5. On completion of roof slab-----10%
6. On completion of plastering work -----10%
7. On commencement of flooring work, doors & windows shutters etc.-----10%
8. On handing over possession of the apartment---5%



#### Amenities

- Spacious Hall cum Dining Room
- Stilted Car Parking *(with no extra cost)*
- Solar Water Heaters
- Non-Toxic Putty Finish
- Service Balcony for Kitchen
- Vetrified Flooring
- Lifts with Spacious Lobby
- Inverter Provision for each Flat

#### Chandra Residences Offers

- Two bedroom Apartments
- Three bedroom Apartments

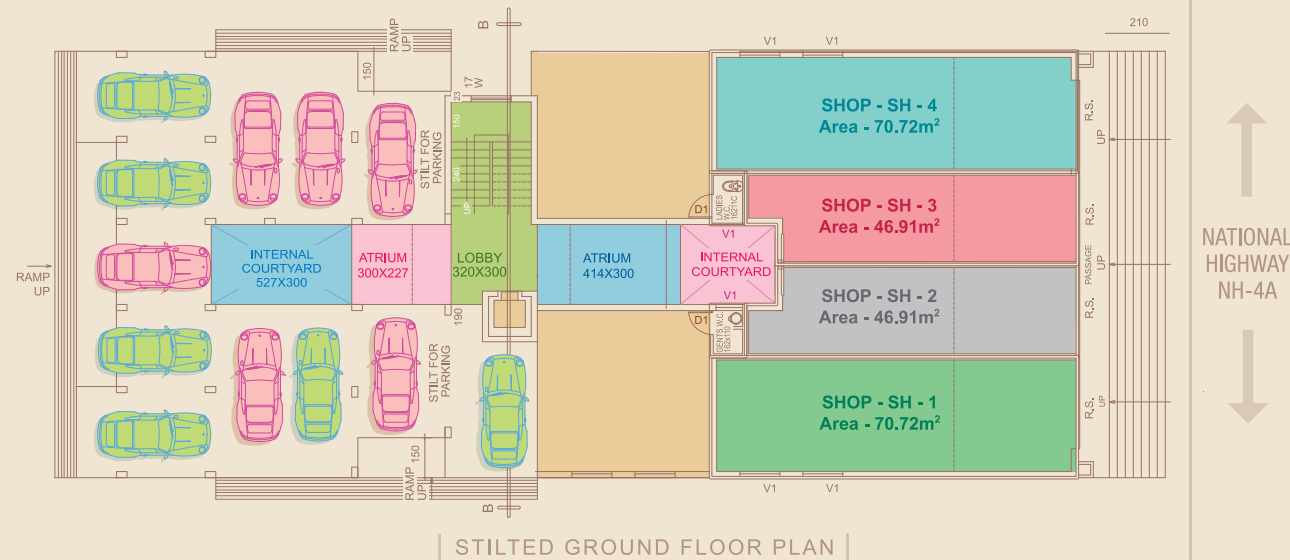

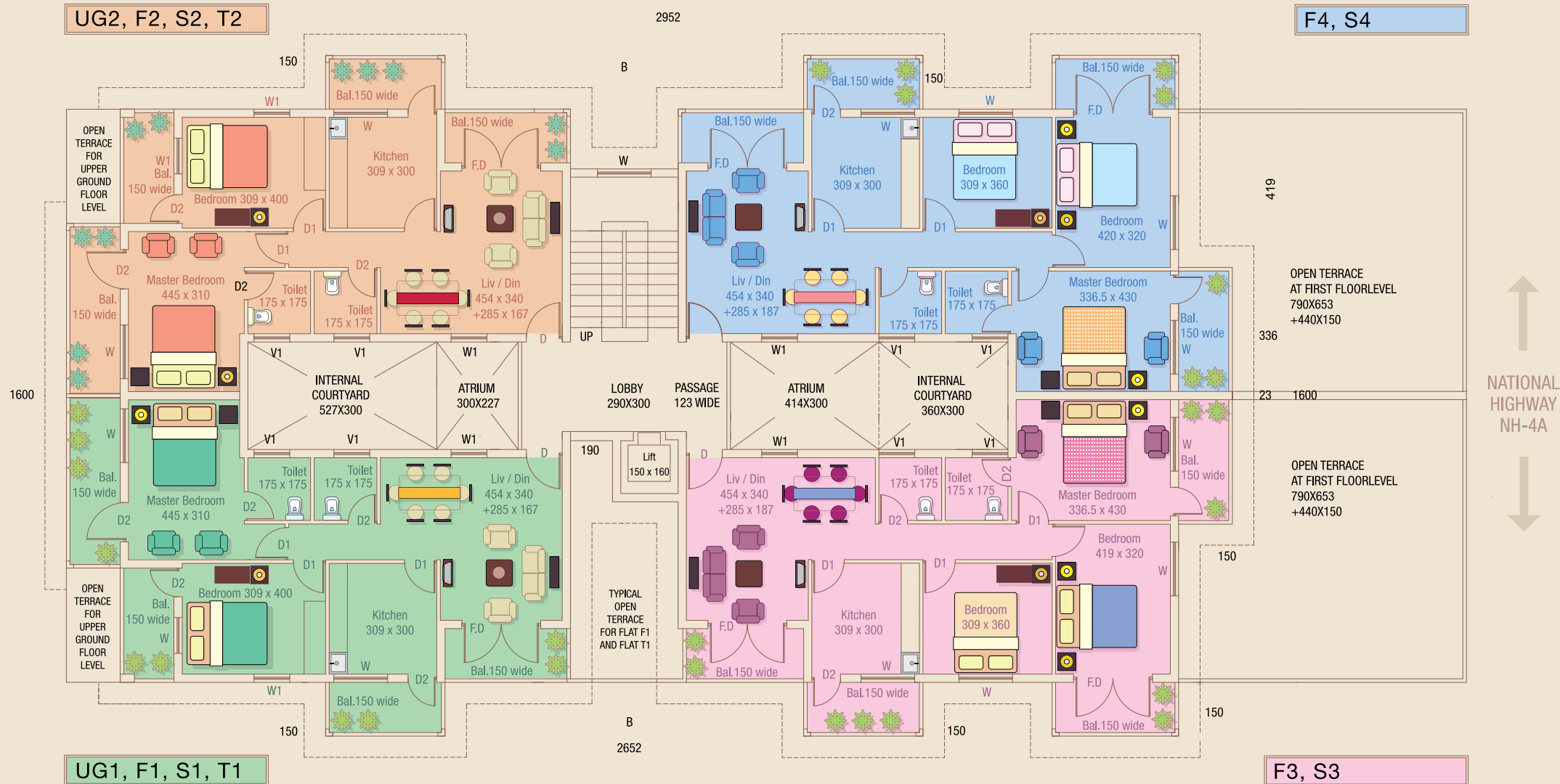

# Chandra Residency

Near Shristi Dulapkar Hospital, NH-4A, Mollar-Corlim

## TWO BEDROOM FLATS

FLAT NO.	AREA	OPEN TERRACE
UG1, UG2	110.03m <sup>2</sup>	4.79m <sup>2</sup>
F1	110.03m <sup>2</sup>	17.17m <sup>2</sup>
F2, S1, S2, T2	110.03m <sup>2</sup>	—
T1	110.03m <sup>2</sup>	17.70m <sup>2</sup>

## THREE BEDROOM FLATS

FLAT NO.	AREA	OPEN TERRACE
F3, F4	126.65m <sup>2</sup>	58.80m <sup>2</sup>
S3, S4	126.65m <sup>2</sup>	—

## BUILDING SPECIFICATIONS

**STRUCTURE** | The building will have R.C.C. framed structure. The roofs are either inclined or flat and will be waterproofed & covered with Mangalore tiles, if inclined. The external walls will be of laterite masonry and internal walls of single bricks masonry.

**PLASTER** | The internal cement plaster will be single coated with non toxic wall ready finish and external plaster will be in double coat, sand finish.

**CAR PARK** | Stilted reserved one car park at no extra cost.

**FLOORING** | The flooring will be of vetrified tiles edge cut all over, with matching skirting. Staircase steps will be in Khaddapa stone.

**DOORS & WINDOWS** | All the doors & windows will have Sal wood frames. The window shutters will be Aluminium openable type. All balcony doors will be factory made, flush doors with enamel paint. Main doors will be of Teakwood, polished & room doors will be factory made membrane door.

**KITCHEN** | The kitchen will have khaddapa platforms, finished with black granite top and stainless steel sink.

**INTERNAL DECORATION** | Internal painting will be acrylic distemper and doors & windows will be enamel painted.

**EXTERNAL DECORATION** | The external walls of the buildings will be in weather shield paint.

**WATER TANKS** | Common R.C.C. overhead water tanks & underground sumps will be provided.

**PLUMBING & SANITARY INSTALLATIONS** | Soil waste water pipes will be of PVC partially concealed and of approved quality which will be led to septic tanks. All sanitary fittings shall be of approved brands. The toilet shall have ceramic flooring, in colour glazed tiles and PVC door including frame.

**SOLAR HEATERS** | Solar water heaters will be provided.

**ELECTRIC INSTALLATIONS** | Electric installations will be concealed wires fixed in PVC pipes with CPL modular switches, inverter provision will be done. Lifts / Elevators are provided in the building.

**EXTRA ITEMS** | Any extra item will be executed at the specific written request of the financier of the flat. Additional charges for the same will be at the prevailing market rates.

**NOTE:** This brochure is purely conceptual and is subject to modification.



## Chandra Residency

SITE LOCATION PLAN  
Near Shristi Dulapkar Hospital  
NH-4A, Mollar-Corlim

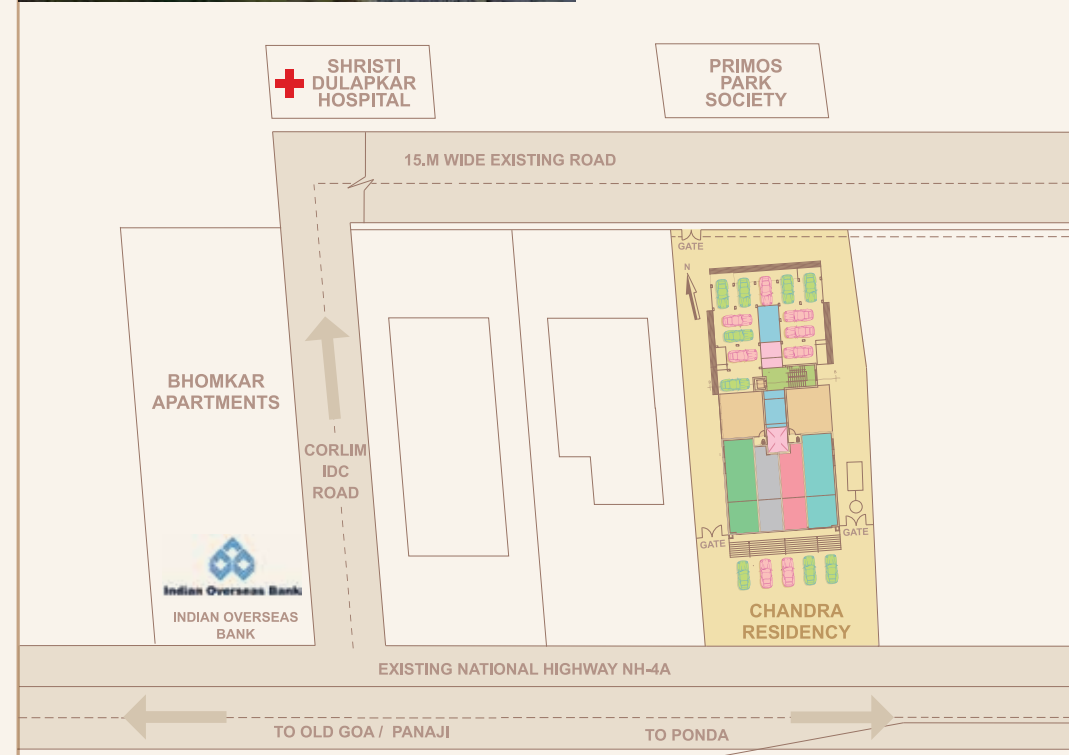

For Booking contact:

**C.V. Naik Constructions**  
**REAL ESTATE DEVELOPERS & BUILDERS**

*Creating Comfortable Country Lifestyles!*

Registered Office:

1st Floor, Excellsior Chambers, Opp. Neurecar Chambers  
Above Classic Business Centre, M.G. Rd., Panaji – Goa  
Tel. Off.: 0832-2224040

Mob.: 9822125789 (Sandesh)

Email: cvnaikconstructions@gmail.com



रेसीडेन्सी | RESIDENCY  
MOLLAR \* CORLIM \* GOA