

IT IS TIME TO
REIMAGINE

URBAN
LIVING

Kumar
PARC
RESIDENCES

MAGARPATTA ROAD

REPRESENTATIVE IMAGE

In the city, you need more than just a home. You need a lifestyle that works for you, so you can create the life you want for your loved ones.

*YOU NEED AN
URBAN OASIS*



YOU DON'T NEED TO CHOOSE ANYMORE...

Escape the chaos of city life without ever leaving the urban comforts.

Discover your own space that offers the perfect balance for every emotion. Whether you want to relax, socialize, or stay active.

Simply, have it all.





Maximum intercity connectivity, affordable luxury, steady growth in real estate market, surrounded by IT lifestyle, proposed international airport, metro and ring road projects - Hadapsar has all the potential to become India's next big real estate growth story.

THE FUTURE IS HERE

You've seen Hadapsar evolve, but the peak potential is just around the corner.

Now is the time you discover the true gem of

**HAPPENING
HADAPSAR**
CLOSER
TO LIFE

In the entire neighbourhood a single project stands out. Which has created waves of excitement among those seeking a premium lifestyle and is loved by those living here for the immense convenience it offer. You've heard about it for years in different identities.



Now finally, it is time to unveil...>>>

Claim your Private Retreat
Amidst the City's Vibrancy.

— INTRODUCING —
Kumar
PARC
RESIDENCES
— MAGARPATTA ROAD —

2 & 3 BHK HOMES

THE URBAN OASIS
YOU'VE BEEN WAITING FOR.

ARCHITECTURAL RENDITION





PROJECT LAYOUT

- 4 Towers
- Podium Level Access From Each Tower
- Multi-Level Covered Parking Space

ARCHITECTURAL RENDITION



REPRESENTATIVE IMAGE

Gymnasium



REPRESENTATIVE IMAGE

4 Guest Rooms



Mini Theatre

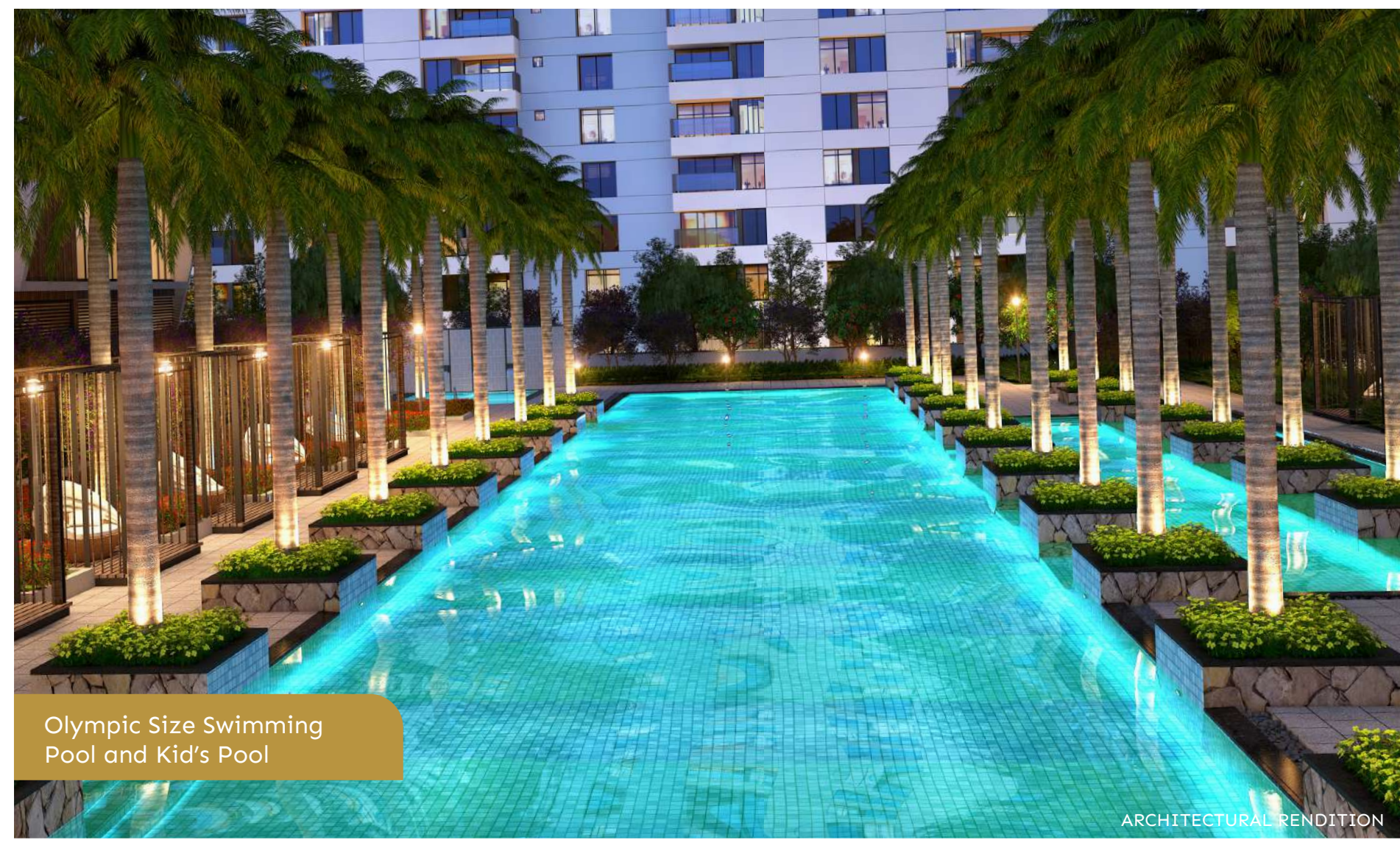

Olympic Size Swimming Pool and Kid's Pool

ARCHITECTURAL RENDITION













Yoga Lawn with Pavilion

REPRESENTATIVE IMAGE

REPRESENTATIVE IMAGE

GROUND LEVEL AMENITIES

 Outdoor Badminton Court*	 Pet Park with Pavilion*
 Outdoor Open Gym Stations	 Cricket Enclosures
 Community Organic Garden	 Senior's Sitout Area
 Futsal Court	 Skating Rink
 Multipurpose Court	 Giant Chess Board for Kids/Adults
 Open Café along with Business Centre*	 Walkway Path Covering Entire Site*
 Tennis Academy with 2 Tennis Courts & Support Office*	 Large Entry Gate with Feature Landscape at Project Entry



*Marked Amenities will be provided in Future Phase

REPRESENTATIVE IMAGE



REPRESENTATIVE IMAGE



Senior's Sitout Area



Skating Rink



ARCHITECTURAL RENDITION

Outdoor Badminton Court

Cricket Enclosures



REPRESENTATIVE IMAGE

Open Café along with Business Centre

REPRESENTATIVE IMAGE

SPECIFICATIONS

CONSTRUCTION

- A-class, Earthquake Resistant Construction with Aluform Technology

FLOORING / DADO

- 800 X 800 mm Size Vitrified Tile Flooring in Living, Kitchen And Dining
- Vitrified Tile Flooring having Wooden Strip Patern in Bedrooms
- Artificial / Vitrified Stone Slab in Toilets
- 7' Height Toilet Dado with large format Vitrified Tiles. (PGVT)
- Anti Skid Tiles of Terraces
- Vitrified PGVT Tiles for Kitchen Dado above counter

WALL AND CEILING

- Gypsum punning on Walls
- Superior OBD paint for Walls and Ceilings

WINDOWS

- UPVC windows with Invincible Grills only for Bedrooms

RAILING FOR ATTACHED TERRACES

- Glass Railing with Aluminum handrail for attached Terraces

DOORS

- Vinyl Skin premoulded Flush Door with SS fittings for Entrance Door
- HDF Skin moulded Flush Doors with SS fittings for Bedrooms and Toilets.

KITCHEN

- Artificial / Vitrified Stone Slab for Kitchen Counter
- Stainless Steel Sink with drain board
- Power Plug point for Water Purifier and electrical point for Exhaust Fan

ELECTRICAL

- Concealed Copper Wiring in the entire flat with ELCB and MCB
- Modular electrical Switch & Sockets
- Electric supply by way of 1 Phase / 3 Phase meter
- Adequate points for Lights, Fans and Tv
- Telephone points in the Living Room and Bedrooms
- Provision for Split Ac in Living Room and all Bedroom
- Power plug point for Cable Tv
- Provision for Invertor

PLUMBING, BATHROOM AND TOILETS

- Concealed Plumbing
- White/Coloured Ceramic Sanitary Wear of reputed brand
- Wall hung comode With Flush Tank
- Single Lever diverter in Shower areas along with Single Lever Basni Mixer for all Toilets.
- Provision for Boilers and Exhaust Fans in all Toilets

LIFTS

- Modern, automatic Lifts of reputed make

ENTRANCE LOBBY

- Designer finish Entrance Lobby

EXTERNAL FINISH

- Exterior grade Texture Paint

SAFETY

- Intercom Facility by way of MyGate mobile app or similar
- Access control main Entrance Lobby at ground floor with CCTV Camera
- Digital Lock

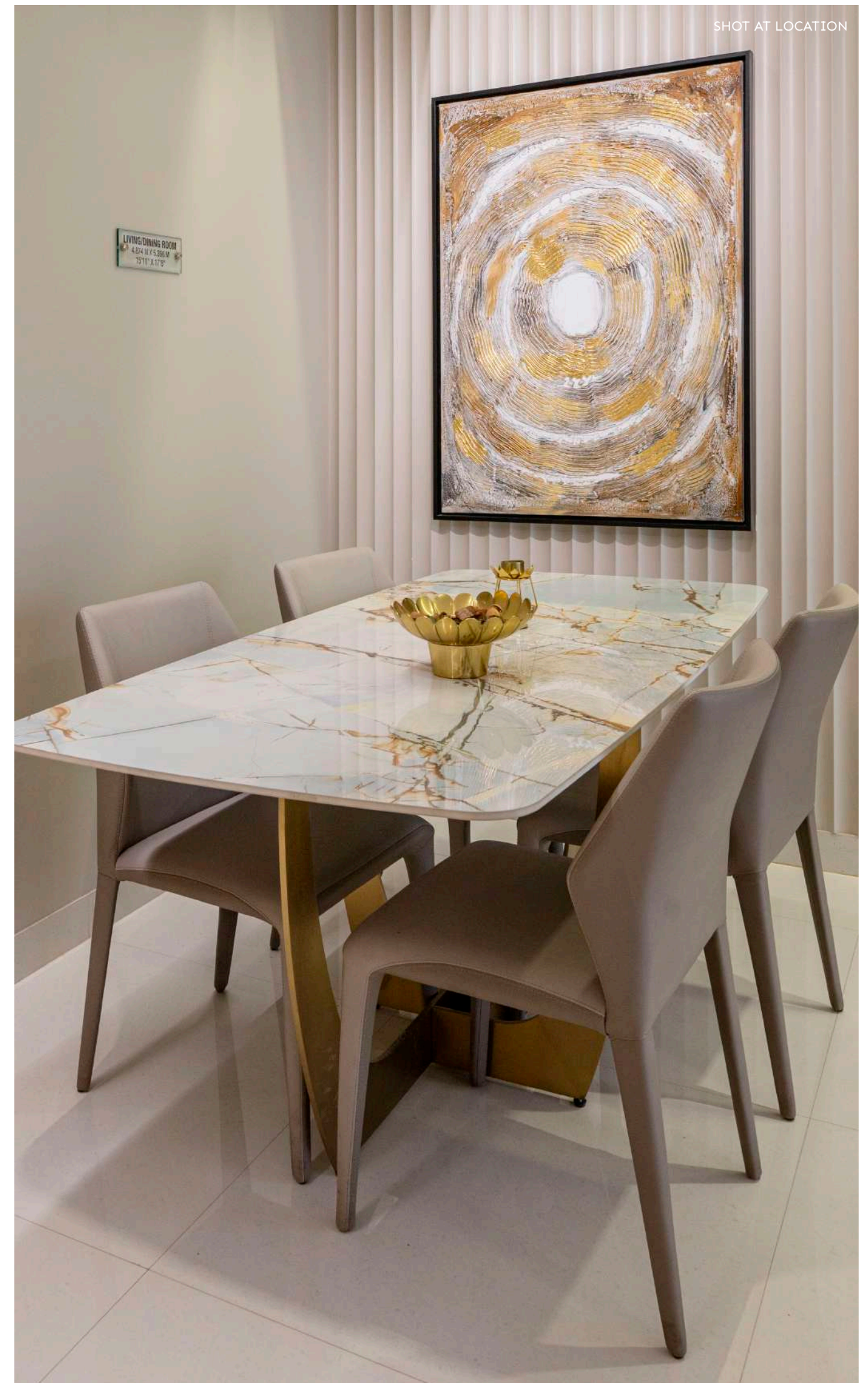

AN OASIS CONNECTED TO YOUR WORLD



CONNECTIVITY

Hadapsar Railway Station	5 min
Pune-Solapur Highway	7 min
Pune International Airport	20 min
Pune Railway Station	20 min

NEARBY HOSPITALS

Noble Hospital	5 min
Sahyadri Hospital	5 min
Manipal Hospital	15 min

NEARBY WORK SPACES

WeWork	1 min
Magarpatta City	3 min
Planet IT	5 min
SP Info City	15 min
EON IT Kharadi	20 min

NEARBY MALLS & LIFESTYLE HUBS

Amanora Mall	1 min
Seasons Mall	1 min
PVR Cinemas	1 min
INOX	1 min
Cult Fit, Gold's Gym	5 min

NEARBY SCHOOLS AND COLLEGES

Vibgyor High School	4 min
HDFC International School	4 min
Amanora School	5 min
Billabong	6 min

ARCHITECTURAL RENDITION



90,000 SQ.FT ELEVATED PODIUM FOR AMENITIES



Olympic Size Swimming Pool and Kid's Pool



Jogging Track with Sky Bridge Connectivity



Children Play Area & Pavilion



2 Large Function Halls



Amphitheatre Near Pool Deck with Sitting Pockets



2 Floors Club House



Pool Change Room



Yoga Lawn with Pavilion



Society Office



Party Lawn Area



Gymnasium



4 Guest Rooms



Mini Theatre



Gazebo

AN OASIS SPREAD ACROSS 8.5 ACRES

Where there's Something
for Every Age and All Occasions

1st, 3rd, 4th, 5th, 6th, 8th, 9th, 10th Floor Plan



BUILDING A2 - WING A (AREA IN SQ.M.)

FLAT NO.	CARPET	BALCONY
101, 301, 401, 501, 601, 801, 901, 1001	72.50	5.00
102, 103, 302, 303, 402, 403, 502, 503, 602, 603, 802, 803, 902, 903, 1002, 1003	73.00	5.00
104, 304, 404, 504, 604, 804, 904, 1004	103.50	5.00





BUILDING A2 - WING A (AREA IN SQ.M.)

FLAT NO.	CARPET	BALCONY
201	72.50	5.00
202, 203, 204	73.00	5.00



7th, 12th, 17th, 22nd & 27th Refuge Floor Plan



BUILDING A2 - WING A (AREA IN SQ.M.)

FLAT NO.	CARPET	BALCONY
701, 1201, 1701, 2201, 2701	72.50	5.00
702, 1202, 1702, 2202, 2702, 703, 1203, 1703, 2203, 2703	73.00	5.00
704, 1204, 1704, 2204, 2704	103.50	5.00

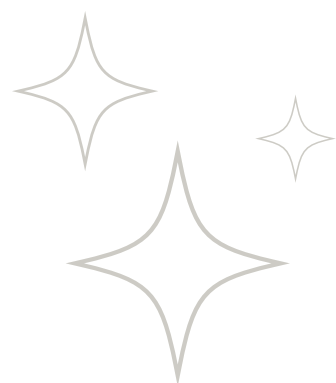

11th, 13th, 14th, 15th, 16th, 18th, 19th, 20th, 21st, 23rd, 24th, 25th, 26th, 28th, 29th & 30th Floor Plan



BUILDING A2 - WING A (AREA IN SQ.M.)

FLAT NO.	CARPET	BALCONY
1101, 1301, 1401, 1501, 1601, 1801, 1901, 2001, 2101, 2301, 2401, 2501, 2601, 2801, 2901, 3001	72.50	5.00
1102, 1302, 1402, 1502, 1602, 1802, 1902, 2002, 2102, 2302, 2402, 2502, 2602, 2802, 2902, 3002 1103, 1303, 1403, 1503, 1603, 1803, 1903, 2003, 2103, 2303, 2403, 2503, 2603, 2803, 2903, 3003	73.00	5.00
1104, 1304, 1404, 1504, 1604, 1804, 1904, 2004, 2104, 2304, 2404, 2504, 2604, 2804, 2904, 3004	103.50	5.00



1st, 3rd, 4th, 5th, 6th, 8th, 9th, 10th Floor Plan



BUILDING A2 - WING B (AREA IN SQ.M.)

FLAT NO.	CARPET	BALCONY
101, 301, 401, 501, 601, 801, 901, 1001	72.50	5.00
102, 103, 302, 303, 402, 403, 502, 503, 602, 603, 802, 803, 902, 903, 1002, 1003	73.00	5.00
104, 304, 404, 504, 604, 804, 904, 1004	103.50	5.00

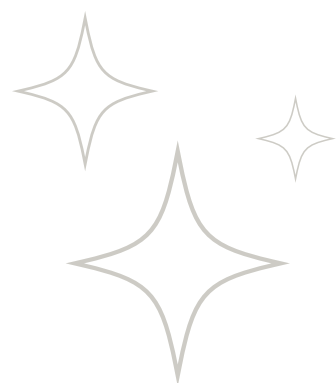



BUILDING A2 - WING B (AREA IN SQ.M.)

FLAT NO.	CARPET	BALCONY
201	72.50	5.00
202, 203, 204	73.00	5.00



7th, 12th, 17th, 22nd & 27th Refuge Floor Plan



BUILDING A2 - WING B (AREA IN SQ.M.)

FLAT NO.	CARPET	BALCONY
701, 1201, 1701, 2201, 2701	72.50	5.00
702, 1202, 1702, 2202, 2702, 703, 1203, 1703, 2203, 2703	73.00	5.00
704, 1204, 1704, 2204, 2704	103.50	5.00



11th, 13th, 14th, 15th, 16th, 18th, 19th, 20th, 21st, 23rd, 24th, 25th, 26th, 28th, 29th & 30th Floor Plan



BUILDING A2 - WING B (AREA IN SQ.M.)

FLAT NO.	CARPET	BALCONY
1101, 1301, 1401, 1501, 1601, 1801, 1901, 2001, 2101, 2301, 2401, 2501, 2601, 2801, 2901, 3001	72.50	5.00
1102, 1302, 1402, 1502, 1602, 1802, 1902, 2002, 2102, 2302, 2402, 2502, 2602, 2802, 2902, 3002 1103, 1303, 1403, 1503, 1603, 1803, 1903, 2003, 2103, 2303, 2403, 2503, 2603, 2803, 2903, 3003	73.00	5.00
1104, 1304, 1404, 1504, 1604, 1804, 1904, 2004, 2104, 2304, 2404, 2504, 2604, 2804, 2904, 3004	103.50	5.00



1st, 3rd, 4th, 5th, 6th, 8th, 9th, 10th Floor Plan



BUILDING A2 - WING C (AREA IN SQ.M.)

FLAT NO.	CARPET	BALCONY
101, 301, 401, 501, 601, 801, 901, 1001	72.50	5.00
102, 103, 302, 303, 402, 403, 502, 503, 602, 603, 802, 803, 902, 903, 1002, 1003	73.00	5.00
104, 304, 404, 504, 604, 804, 904, 1004	103.50	5.00

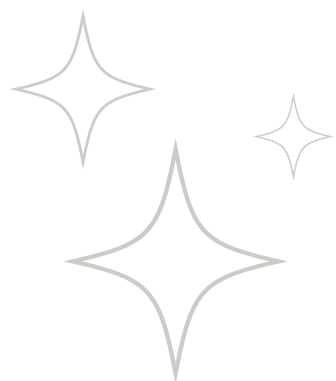



BUILDING A2 - WING C (AREA IN SQ.M.)

FLAT NO.	CARPET	BALCONY
201	72.50	5.00
202, 203, 204	73.00	5.00



7th, 12th, 17th, 22nd & 27th Refuge Floor Plan



BUILDING A2 - WING C (AREA IN SQ.M.)

FLAT NO.	CARPET	BALCONY
701, 1201, 1701, 2201, 2701	72.50	5.00
702, 1202, 1702, 2202, 2702, 703, 1203, 1703, 2203, 2703	73.00	5.00
704, 1204, 1704, 2204, 2704	103.50	5.00



11th, 13th, 14th, 15th, 16th, 18th, 19th, 20th, 21st, 23rd, 24th, 25th, 26th, 28th, 29th & 30th Floor Plan



BUILDING A2 - WING C (AREA IN SQ.M.)

FLAT NO.	CARPET	BALCONY
1101, 1301, 1401, 1501, 1601, 1801, 1901, 2001, 2101, 2301, 2401, 2501, 2601, 2801, 2901, 3001	72.50	5.00
1102, 1302, 1402, 1502, 1602, 1802, 1902, 2002, 2102, 2302, 2402, 2502, 2602, 2802, 2902, 3002 1103, 1303, 1403, 1503, 1603, 1803, 1903, 2003, 2103, 2303, 2403, 2503, 2603, 2803, 2903, 3003	73.00	5.00
1104, 1304, 1404, 1504, 1604, 1804, 1904, 2004, 2104, 2304, 2404, 2504, 2604, 2804, 2904, 3004	103.50	5.00



2 BHK Apartment - Building A2

Isometric View

- A** Entrance Lobby
- B** Living
- C** Kitchen
- D** Dining
- E** Bedroom 1
- F** Toilet
- G** Balcony
- H** Bedroom 2



3 BHK Apartment - Building A2

Isometric View

- A** Entrance Lobby
- B** Living
- C** Kitchen
- D** Dining
- E** Bedroom 1
- F** Toilet
- G** Balcony
- H** Bedroom 2
- I** Bedroom 3

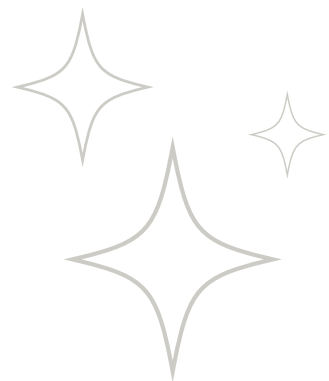



DISCOVER THE LEGACY OF A BRAND BUILT ON TRUST AND REFINED FINESSE.

For 58+ years Kumar Corp has transformed landscapes and lives to become a name synonymous with unparalleled excellence and enduring value.

We don't make just homes; we create masterpieces for living.



Glorious
legacy of over
58+ years



More than
36+ million sq.ft.
of development



Delighting
more than
42,000+ families



Over 140 projects
in Pune, Mumbai
& Bangalore

CREDITS

LIASON ARCHITECT

Jagdish P. Deshpande, Pune

STRUCTURAL DESIGN CONSULTANT

Sunil Mutalik & Associates, Pune

LANDSCAPE DESIGN

Element Design Studio Pte. Ltd.
(Gregory Kunak), Singapore

CLUB HOUSE DESIGN

DBTA International Pte.Ltd.
(David Tokiwa), Singapore

SAMPLE FLAT DESIGN

Arch Type (A.r Prakash Chandak), Pune

DEVELOPER

Kumar Properties Infratech
Developers Private Limited

Kumar
PARC
RESIDENCES



MahaRERA registration number
P5210005344
Building - A2
<https://maharera.maharashtra.gov.in>

SITE ADDRESS

Opp. to WeWork, nr. Season's Mall, Magarpatta,
Hadapsar, Pune, Maharashtra 411028

OFFICE ADDRESS

Kumar Capital, 2413, East Street, Camp, Pune - 411 001.

Tel: +91-20-67641661/662/663/635 & 3052 8888

Fax: +91-2635 3365

9595 110011 | 9595 660066

www.kumarworld.com

DISCLAIMER

This brochure is purely conceptual and points mentioned herein are not a legal offering not will be part of the agreement. Promoters reserve the right to amend the layout, plans, elevations, designs, specification, amenities etc. without prior notice.

 **Kumar**
CORP
A LIMITLESS SKY