

Shree RAM

---

Square

COMMERCIAL

Be at the centre of gainful opportunities

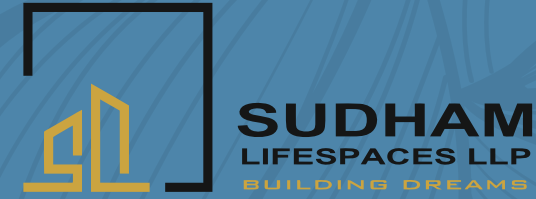

Sudham Lifespaces is a consolidated team of young professionals from the real estate industry. A collaboration of experienced practitioners in every phase of project development – from land acquisition to construction to marketing and sales – the new entrant in real estate business is all set to establish its footprint with its refreshing ideas and creative zeal. The company stakeholders, individually and collectively, enjoy years of goodwill and trust in the industry for their respective lines of work; and look forward to build upon that foundation a towering structure of dream, with their spirited maiden venture.

A dynamic trio of partners are leading the venture Pushkaraj Vikas Vartak, Mrugen Sunil Chorge and Divesh Sunil Succeriya who are all well versed and experienced in every nuance of real estate business.

Shree RAM  
*Square*  
COMMERCIAL

## Convert a business premise into a business promise

Shree Ram Square offers commercial spaces for retail shops and business establishments in the prime locality of Shree Ram Nagar in Virar West. A choice of flat slab, wide and deep shops without beams on the road facing ground floor of the corner plot. And spacious flat slab offices above, with flexible layout, self-contained toilets, separate lobby and twin service centres.

## A grandstand Ground + 22 floors tower of apartments, villas & commercial



# Exclusive advantages that make conducting business a pleasure



## Retail

Well planned and thoughtfully developed shops that maximise the utility of the available space and make the customer experience more enjoyable

- Large column spans create a whole new in-office space
- Flat slab with no beams give a sleek, smart look
- Wide and deep shops facilitate more area for doing business
- Wide veranda at shop front enables easy customer movement



## Office

Smart, flexible and dynamic offices that are in sync with the needs of modern business establishments and contemporary design curation

- Flat slab with no beams conform to today's open and transparent offices
- Flexibility of furniture layout enables companies fashion their customised interiors
- Self-contained toilets inside offices means every organisation has its individual privies
- Separate hygienic toilets for ladies & gents in the common area
- Flexible width between adjacent offices to suit the needs of every workplace

Two separate entrance lobby for easy access to the offices with dedicated service cores



Business in the surrounds of lifestyle, leisure & convenience



Cafeteria with sitting arrangement at both the levels



Special kiosk for serving food & beverage delights



Designated stilt parking & parking tower



Stationery outlet for ease of office documentation needs

# Innovative plans for convenient conduct of business

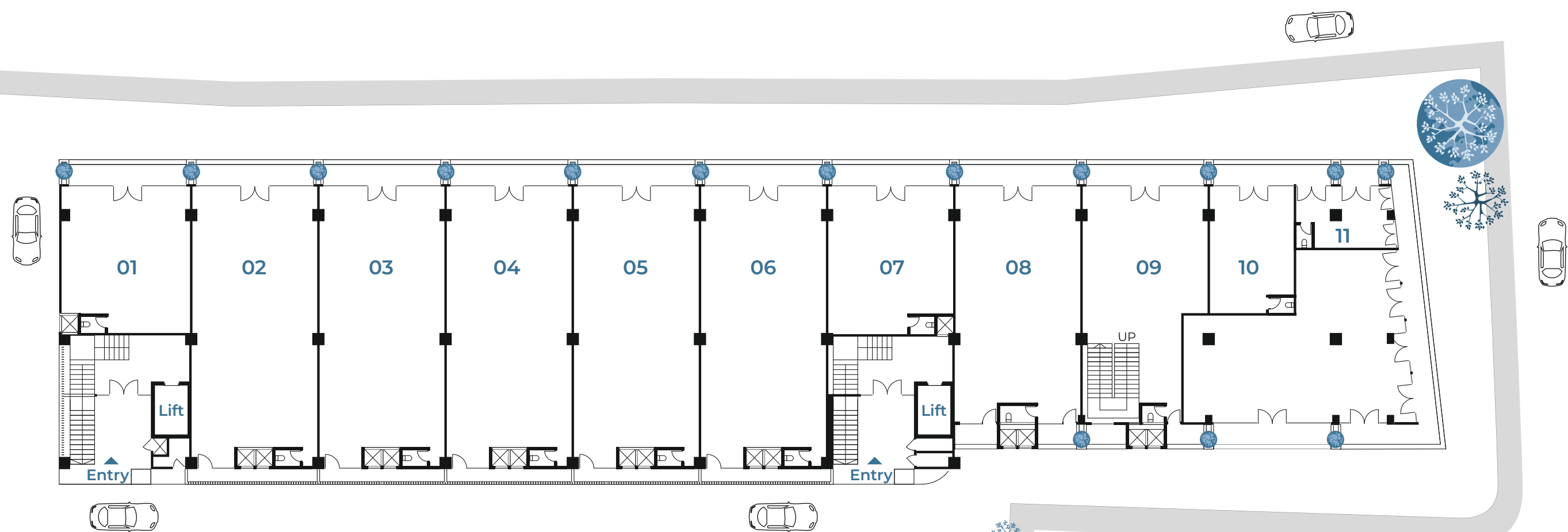

## G Floor



Shop	Size	RERA Carpet Area
01	25'9" x 29'9"	759 sq. ft.
02-06	25'0" x 60'0"	1402 sq. ft.
07	25'0" x 29'9"	737 sq. ft.
08	25'0" x 48'3"	1205 sq. ft.
09 Anchor	25'0" x 30'3" 19'6" x 18'3"	1101 sq. ft.
10	16'9" x 26'0"	509 sq. ft.
11	15'0" x 12'3"	251 sq. ft.

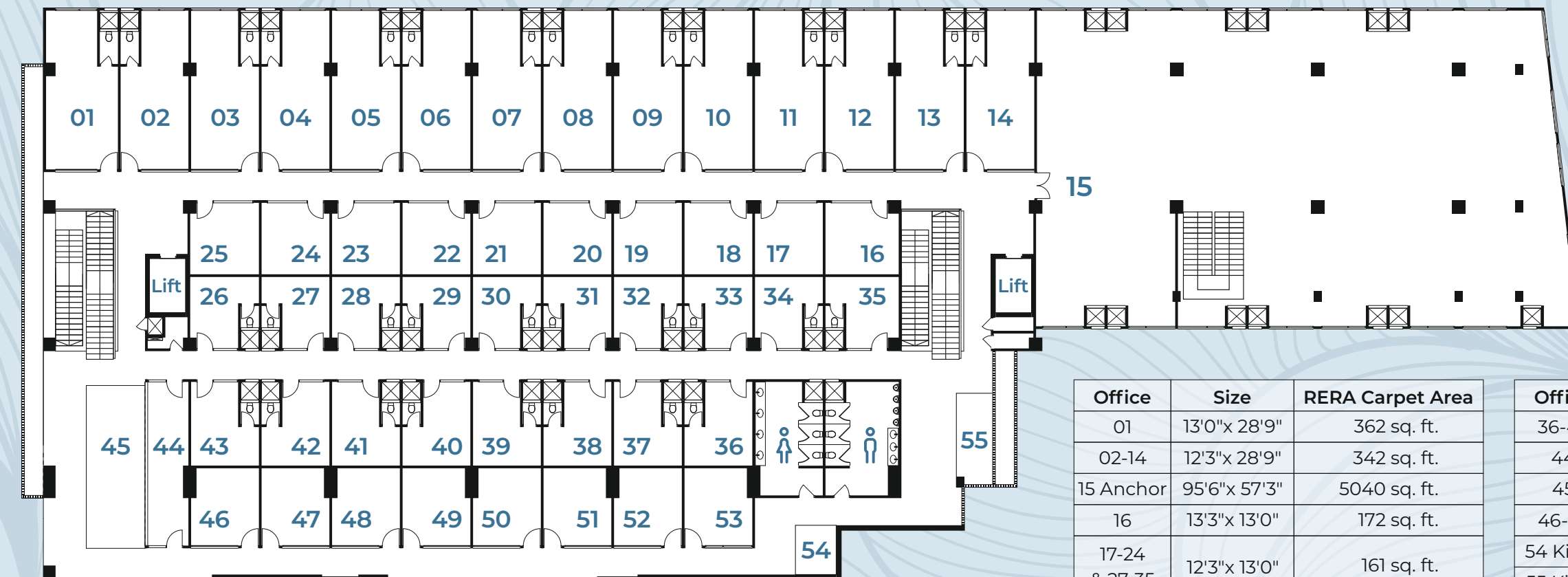

## 1st Floor

Office	Size	RERA Carpet Area
01	13'0" x 28'9"	362 sq. ft.
02-14	12'3" x 28'9"	342 sq. ft.
15 Anchor	95'6" x 57'3"	5040 sq. ft.
16	13'3" x 13'0"	172 sq. ft.
17-24 & 27-35	12'3" x 13'0"	161 sq. ft.
25 & 26	12'6" x 13'0"	162 sq. ft.

Office	Size	RERA Carpet Area
36-43	12'3" x 15'2"	173 sq. ft.
44	7'6" x 29'6"	222 sq. ft.
45	13'0" x 29'6"	378 sq. ft.
46-53	12'3" x 14'0"	174 sq. ft.
54 Kiosk	7'9" x 8'6"	67 sq. ft.
55 Kiosk	6'6" x 16'6"	107 sq. ft.

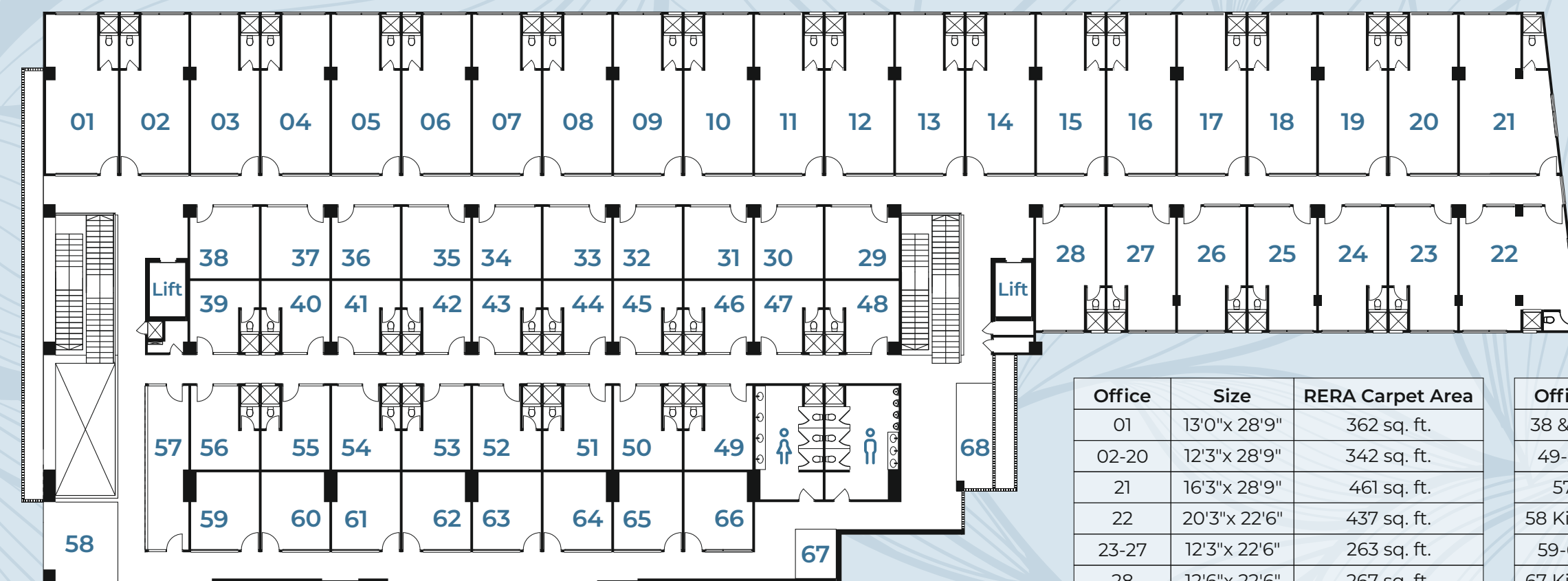

## 2nd Floor

Office	Size	RERA Carpet Area
01	13'0" x 28'9"	362 sq. ft.
02-20	12'3" x 28'9"	342 sq. ft.
21	16'3" x 28'9"	461 sq. ft.
22	20'3" x 22'6"	437 sq. ft.
23-27	12'3" x 22'6"	263 sq. ft.
28	12'6" x 22'6"	267 sq. ft.
29 & 48	13'3" x 13'0"	174 sq. ft.
30-37 & 40-47	12'3" x 13'0"	161 sq. ft.

Office	Size	RERA Carpet Area
38 & 39	12'6" x 13'0"	163 sq. ft.
49-56	12'3" x 15'2"	174 sq. ft.
57	7'6" x 29'6"	223 sq. ft.
58 Kiosk	12'3" x 15'6"	193 sq. ft.
59-66	12'3" x 14'0"	174 sq. ft.
67 Kiosk	7'9" x 8'6"	67 sq. ft.
68 Kiosk	6'6" x 19'0"	126 sq. ft.



# Shree RAM Square

COMMERCIAL

Shree Ram Square in Virar West is a strategic and prominent locality in close proximity to the Virar railway station and is well connected internally through road transport. For decades, Shree Ram Nagar has been a popular residential area and is increasingly hosting thousands of new families. Today, this area has become an epicentre of business opportunities with an ever rising demand of a variety of products and services, making it the perfect destination for business and trade.

### A short distance from

- Virar Railway Station
- Viva College
- Sanjivani Hospital
- Shopping Hubs
- Dining Delights
- Banking & Commerce
- Leisure & Lifestyle





MahaRERA Reg . No: P99000048744  
<http://maharera.mahaonline.gov.in>

Digital Strategist and Coordinator  
**Sana Mrugen Chorghe** (USA)

Urban Design  
**Darshana Pushkaraj Vartak** (UK)

Design Architect  
*Carmesi Casa* PVT. LTD.

Architect  
**Megha Urbanscapes**

RCC Consultant  
**Pragnesh Oza**

Advocate  
**Yogesh Virarkar**

Sustainability & Green Bldg. Design  
**SM Studios Inc.** (USA)

Architectural Presentation  
**Kuhu Arnalkar** (UK)

MEP  
**Hydraugic MEP Consultant**

Landscape Architect  
**Tasneem Badri Jaitly**

Shree RAM  
*Square*  
COMMERCIAL

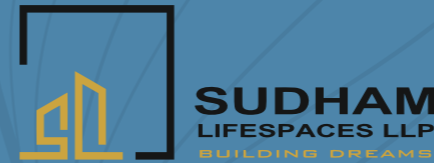

**Site Address**

Shree Ram Nagar Complex, Vartak Road  
Near Flyover, Virar West 401303  
Ph: +91-99706 99979

**Corporate Address**

Vartak House, Vartak Road  
Near Ram mandir  
Virar West 401303

Project Financed by



This brochure is conceptual and the architectural perspective, dimensions, drawings and other information in this brochure is only indicative.  
The developers reserve their rights to make additions / amendments as may be necessitated from time to time.