

A PROJECT BY



**REGISTERED OFFICE**

408, Blue Rose Industrial Estate, Near Metro Mall, W. E. Highway, Borivali East,  
Mumbai - 400066.

Office Contact : +91 9076004433 / 022 28542244

**SITE OFFICE**

Rajendra Nagar Shradha CHS. Plot bearing C.T.S. No. 88(pt.), 88/7 to 12, 88/23 to 38  
of village Magathane at Rajendra Nagar (old), Datta Pada Road, Borivali (East),  
Mumbai - 400066.

Sales Contact No : +91 9076004411, +91 9076004422

Email : [sales@apexinfratec.com](mailto:sales@apexinfratec.com) / [info@apexinfratec.com](mailto:info@apexinfratec.com)

Website : [www.apexinfratec.com](http://www.apexinfratec.com)

Developer : Apex Infratec

Architect / LS : 3 Dimensional Consultants LLP

R.c.c Consultant : Hiren M. Tanna

Mep Consultant : Mak Mep Consultants

Legal Advisor : Devang Mehta, Solicitor, M/s. SI Partners

Architectural Service Consultant : Devang Mody

Maha RERA Registration No. - Apex Green Wood : P51800047381

Project is approved by all leading Banks & Financial Institutions

Disclaimer: The Information depicted in this booklet viz. master plans, floor plans, furniture layout, fittings, illustrations, specifications, designs, dimensions, rendered views, colours, amenities and facilities etc. are subject to change without notifications as may be required by the relevant authorities or the developer's architect, and cannot form part of an offer or contract. Whilst every care is taken in providing this information, the Developer cannot be held liable for variations. All illustrations and pictures are artist's impression or stock images used for representative purpose only. The information is subject to variations, additions, deletions, substitutions and modifications as may be recommended by the company's architect and/or the relevant approving authorities. The Developer is wholly exempt from any liability on account of any claim in this regard. (1 square meter = 10.764 square feet). E & OE. All dimensions and calculations are done in metric systems (M/Sq. m), and Imperial system (F/Sq. ft) shown is for reference only.

**APEX  
GREEN  
WOOD**

The GREENWOOD life begins here....



## Enriching life, Enhancing lifestyles

---

The maxim of 'Enriching life, Enhancing lifestyles', which is our North Star, guides the entire Group to create benchmarks in real estate that will stand the test of time. We are on an ongoing mission to create dynamic and self-sustaining spaces that enhance lifestyles.

There are several ways we can describe ourselves. However, challenging the 'why' and the acumen to accomplish the 'why not', best defines us. The symbiosis of thoughtful engineering and thought leadership has enabled us to create dynamic and self-sustaining spaces that go the extra mile in terms of 'enriching life' and 'enhancing lifestyles'. Creating the bedrock for iconic structures that are redefining.



\* Artist's representation



\*Artist's representation

EXQUISITE

1<sup>BHK</sup>  
& 2<sup>BHK</sup>  
RESIDENCES

23  
STOREY  
LUXURIOUS  
TOWER

📍 BORIVALI EAST

Redefine  
Imagination

-----

Your search for your dream home ends at the brilliantly conceptualized and superbly developed residential project.

Apex Green Wood that offers luxurious living spaces, with well planned and magnificently designed to offer you the true essence of fine living in your own space. Every home is synonymous to lavishness, class and magnificence that upgrade your lifestyle in an unprecedented manner. Apex Green Wood is the best choice for those who seek an comfort life in ecstatic surroundings.



\*Artist's representation

## The Grand Lobby: The opening bars of the magnificent symphony

Entry to the residences is designed around a grand structure replete with technology and security to usher you in. Quite the signature lifestyle, comparable with world-best standards.



\*Artist's representation

## The Roof Top Garden: designed to delight!

-----  
0% Vehicle, 100% peace of mind

- 🌿 Entrance court
- 🌿 Elderly sitting
- 🌿 Fitness corner
- 🌿 Sitting area
- 🌿 Chess plaza
- 🌿 Kids play ground
- 🌿 Fragrance court
- 🌿 Yoga / meditation
- 🌿 Plantation



# Embrace an unparalleled lifestyle

Thoughtfully-integrated zones where there is something for everyone.





# Apex Green Wood: More than just a home!



High  
Speed  
Elevators



Three-tier  
security  
system



Proposed  
video  
door phones



Electric  
vehicle  
charging



Best-in-class  
firefighting  
systems

## EXCLUSIVE AMENITIES

- 🌿 Earthquake resistant R.C.C. frame structure
- 🌿 Stilt + 23 Storey Tower
- 🌿 Vitrified tiles flooring in entire flat
- 🌿 Premium electrical fittings, plumbing & sanitary wares
- 🌿 Grand double height entrance lobby
- 🌿 Multipurpose hall
- 🌿 Fitness centre & indoor games
- 🌿 Modern end elegant elevation
- 🌿 Ample of car parking
- 🌿 Branded high speed elevators
- 🌿 Beautifully landscaped roof top garden

\*T&C apply

Artist's representation



## WING-A

(2<sup>nd</sup> to 7<sup>th</sup>, 9<sup>th</sup> to 14<sup>th</sup>, 16<sup>th</sup> to 21<sup>st</sup>, 23<sup>rd</sup>)

## WING-B

(2<sup>nd</sup> to 7<sup>th</sup>, 9<sup>th</sup> to 14<sup>th</sup>, 16<sup>th</sup> to 21<sup>st</sup>, 23<sup>rd</sup>)

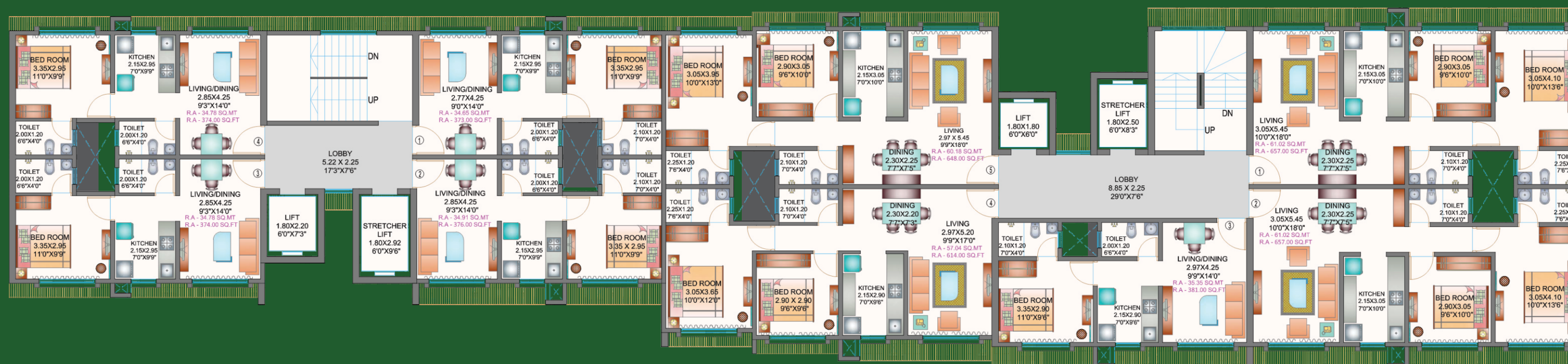

Typical Floor Plan





Wing A



Wing B

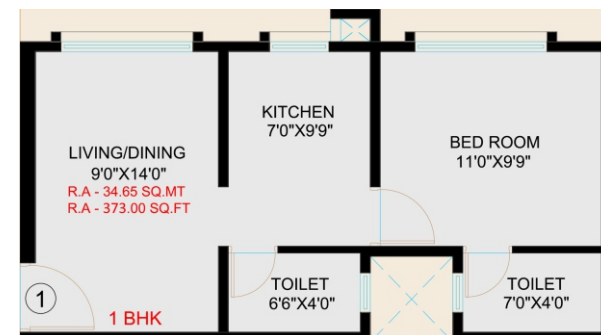



# APEX GREEN WOOD



\*Artist's representation



- Daily Market : 1 Min
- Hospital : 1 Min
- Hotel & Restaurant : 5 Mins
- School & College : 5 Mins
- Shopping Mall : 10 Mins
- Airport : 25 Mins
- Railway Station : 5 Mins
- Magathane Metro Station : 9 Mins
- Devipada Metro Station : 9 Mins
- Western Express Highway : 6 Mins
- S. V. Road : 6 Mins
- Link Road : 3 Mins
- Sanjay Gandhi National Park : 5 Mins



Scan the QR code to see the location

## Seamlessly connected to your world

\*Indicative Map