

PRIDE OF THE EAST!



RAMKY ONE
GENEXT
TOWERS

GOOD LIFE. WITHIN REACH.

2 & 3 BHK APARTMENTS
AT UPPAL



RAMKY ONE
GENEXT
TOWERS
GOOD LIFE. WITHIN REACH.



POSITIVE ENERGY THE PRIDE OF RAMKY ONE GENEXT

Come invest in a home that reverberates with positive energy and emotions for a life time. From elders to middle age groups to teens to children, everyone can discover a meaningful relationship at Ramky One Genext. It is this multi age, cultural fit and effect that are so much like unity in diversity. It is where true bonds are built and happiness abounds. This is not just a well-planned and qualitative gated community but also a perfect antidote to stress. Happy moments to you always...!

PRIDE OF THE FUTURE RAMKY ONE GENEXT

Talk about the future and you have to invariably talk about Ramky One Genext's location: **Uppal**. Close to the Hyderabad Metro Rail and a host of conveniences like hospitals, schools, colleges, shopping and entertainment, life will be like a breeze out here. The eastern corridor where the project location is; is a major hub of industrial activity, businesses and SEZs! So that work and life can go hand-in-hand happily ever after. To say, this is the good life that you have always cherished for.





BUILDING SPACES FOR LIFE



PRIDE IN WHO WE ARE

Over the past 27 years, we at Ramky Estates have been busy building a reputation as a quality-conscious player in the realty business. Headquartered in Hyderabad, we have demonstrated our capabilities and established our leadership across Residential, Commercial, Integrated Townships and Retail Projects in Hyderabad, Chennai, Bangalore, Warangal and Visakhapatnam. Till date, we have successfully delivered over 9 million sq.ft., of residential and commercial projects, while 13 million sq.ft. is under various stages of construction and 8 million sq.ft. is ready for launch. All along, our focus has been to create projects that are self-sustaining, incorporate the finest architectural and design concepts and provide amenities that are contemporary and transcend expectations. This, we see as a challenge and a definitive aspect of our work ethic.

A work ethic that quite simply echoes the pride in who we are as a conglomerate that is setting standards in the realty business.



When Heart meets Smart, it creates innate trust which ignites relentless passion and commitment to unparalleled quality. Ramky Estates and Farms Ltd strived over 27 years to create spaces for life that embody warmth, comfort, and luxury. The open spaces, amenities, elegant designs combine perfectly with technology and innovation by building them with Heart and building it Smart.

-  INTUITIVE SPACES
-  TOMORROW'S TECHNOLOGY
-  WORRY-FREE JOURNEY
-  ENVIRONMENT CONSCIOUSNESS
-  SOCIAL CHANGE
-  INNOVATION



PROJECT OVERVIEW

- SPREAD OVER 5.7 ACRES
- 4 TOWERS
- 2 B + G + 14 FLOORS
- 596 UNITS
- 2 & 3 BHK APARTMENTS

Ramky One Genext Towers is a project that has been planned to provide a progressive lifestyle in a gated community. The project has been planned to cater to every individual's need. The most striking feature of the venture is its layout enabling a holistic lifestyle. All in all one can always have a Good Life, Within Reach.





PRIDE IN THE WAY WE PLAN THE AMENITIES

In order to ensure an environment that is well-planned, hospitable and serene, we have ensured that there is no compromise in the amenities offered at Ramky One Genext Towers. Right from the Pedestrian Friendly Podium, Security at the Entrance Plaza, everything has been planned to give the inhabitants of the community a feel of the good life. From ample playing areas for children, to Amphitheatre, Landscaped gardens, provision for a Car Wash, Laundry, a Reflexology Path and an Elders Community zone, it is an organized habitat. For those inclined to sport, Cricket Nets for practice, Tennis Court, an Outdoor Gym provide the opportunity to exercise and to excel.



PROJECT AMENITIES

-  Pedestrian Friendly Podium
-  Entrance Plaza with Security Post
-  Landscaped Gardens
-  Open Air Amphitheatre
-  Half Basketball Court
-  Provision for Laundry
-  Reflexology Path
-  Elders Community Zone
-  Tot Lot
-  Children Play Area
-  Provision for Car Wash
-  Tennis Court
-  Entry Lobbies for each block
-  Outdoor Gym



PRIDE IN CREATING A LUXURIOUS ENVIRONMENT

What is life without the luxury of entertaining and enjoying the company of family and friends? If that is the thought on your mind, let us tell you about the Clubhouse at Ramky One Genext Towers that is planned in a sprawling area of 26,000 Sq.ft. for you to revel, replenish and rejuvenate.

CLUBHOUSE AMENITIES

- | | |
|--------------------------------|-----------------------------------|
| Entrance Lounge - waiting area | Multi-purpose Hall |
| Provision for Pharmacy | Indoor Badminton Court |
| Indoor Games Room | Provision for Creche |
| Air-conditioned Gym | Aerobics & Yoga Room |
| Provision for SPA/Saloon | Guest Rooms |
| Association Office | Facility Manager's Office & Store |
| Business Lounge | Swimming Pool with Toddler's Pool |



AREA STATEMENT

TYPE	FACING	BHK TYPE	BALCONY AREA	UTILITY AREA	CARPET AREA	SALEABLE AREA
A	EAST	2 BHK	50.05	31.75	829.69	1310
B	WEST	2 BHK	46.82	38.64	825.92	1310
C	EAST	3 BHK	53.82	40.69	960.58	1505
D	WEST	3 BHK	53.82	39.40	961.98	1505
E	EAST	3 BHK	58.77	41.01	1216.55	1860
F	WEST	3 BHK	59.42	41.55	1214.50	1860
E1	EAST	3 BHK	58.77	41.01	1216.55	1860
F1	WEST	3 BHK	59.42	41.55	1214.50	1860

Areas in Sq.Ft

MASTER PLAN



PRIDE IN OUR ATTENTION TO DETAIL

At Ramky One Genext Towers, the word 'quality' reflects in every single detail. From the meticulously drawn out floor plans, to the materials used, everything is not just value for money but good value for money! Take a look at the master plan to get an idea of the way we have used space sensibly and created living spaces, tastefully.

LEGEND

01. Entry ramp with security cabin
02. Driveway
03. Drop off to lobby
04. Pedestrian path-2m wide
05. Peripheral planting
06. Informal seating
07. Hammock zone
08. Reflexology path with sensory garden
09. Deck with lounge seating
10. Mini golf
11. Butterfly garden
12. Outdoor gym
13. Kid's play area
14. Toddler's play area
15. Skating zone
16. Bicycle parking
17. Basketball practice hoop
18. Tennis court
19. Seating gallery
20. Multipurpose lawn
21. Cricket practice net
22. Landscaped Area
23. Kid's pool
24. Main pool
25. Pool deck with seating
26. Viewing deck
27. Meditation zone
28. Amphitheatre with stage
29. Exit ramp with security cabin



RAMK ONE
GENEXT
TOWERS
GOOD LIFE. WITHIN REACH.



PROJECT SPECIFICATIONS



Structure	R.C.C. framed structure
Super Structure	RCC Shear Walls
Entrance Lobby	Well planned lobbies and corridors
Doors/Windows & Ventilators	MAIN DOOR: Engineered wood/Hard wood frame with flush shutter fitted with Dorset/Godrej/Yale/equivalent make hardware
	INTERNAL DOORS: Engineered wood/Hard wood frame with flush shutter fitted with Dorset/Godrej/Yale/equivalent make hardware
	TOILET DOORS: Engineered wood/Hard wood frame with flush shutter fitted with Dorset/Godrej/Yale/equivalent make hardware
	FRENCH DOORS: UPVC door frames with sliding UPVC windows with Provision for Mosquito Mesh
Painting	Internal: Smooth putty finish with two coats of premium acrylic emulsion paint of Asian/Berger or equivalent
	External :Combination of texture and exterior emulsion paint of Asian/Berger or Equivalent
Flooring	Vitrified Tiles of reputed make for Living Room, Bedrooms & Kitchen
	Balcony/Toilets/Utility: Anti skid/ceramic tiles of RAK/SONORA/ equivalent make
	Corridors: Vitrified tiles
	STAIRCASE: Granite/Kota Flooring
Dado Works	BATHROOMS: Ceramic Tiles dado upto false ceiling height of RAK/SONORA/equivalent make
	DADO IN KITCHEN: Ceramic tiles dado up to 2'-0" height above kitchen platform of RAK/SONORA/equivalent make will be handed over at the time of handing over without installation
	UTILITY AREA: Ceramic tile dado upto 3'0" of RAK/SONORA/ equivalent make
Kitchen & Utility Areas	Granite platform with stainless steel sink with drain board will be handed over at the time of handing over without installation
	Provision of electrical points for Chimney, RO, HOB
	Utility: Provision for Washing Machine

Toilets	All toilets are fitted with wall mounted EWC with concealed flush valve of Cera/Parryware/Hindware/equivalent make
	All CP fittings & sanitary fixtures of Cera/Parryware/Hindware/equivalent make
	Single lever wall mixer with shower for all the bathrooms
	PVC Grid false ceiling for all the toilet
	Provision for Geysers in all Bathrooms
Electrical	Concealed Copper wiring of Havells/Polycab/equivalent make
	Power outlets for Air Conditioners in MBR, GBR and Living/Drawing Room
	Modular switches of Anchor/LeGrand/equivalent make
	Three phase power supply for each unit and individual Prepaid Energy Meters
Television	Provision for Cable Connection in Living Room/Drawing, Master bed room
Internet	Provision for internet connection in each Flat
Lifts	Lifts of Johnson/Otis/equivalent make
STP	Sewage Treatment Plant - Recycled water shall be used for flushing and landscaping works
WTP	Water treatment with softner
Water Supply	Supply through Gravity for Domestic Water and Hydro Pneumatic System for Flushing
Generator	100% DG back up for common areas and 750W for each flat
Security / BMS	Round-the-clock security system
	Solar fencing
	Boom barriers at Entry and Exit
	Surveillance cameras at designated locations
Fire & Safety	Fire sprinklers in Basements & wet risers in all floors Shaft & basements (As per Fire Authority regulations)
Garbage Disposal	Garbage Disposal System through Chute in each block
Car Charging Point	One Charging Point Provision for Each unit @ ₹ 50,000/- Extra Cost

*Note: Kitchen Counter - The granite platform and 2 feet height ceramic tile dado along with kitchen sink with drainboard will be provided to the customers without fixing at the time of handing over.

UNIT
TYPE A
2 BHK
EAST FACING
1310 SFT

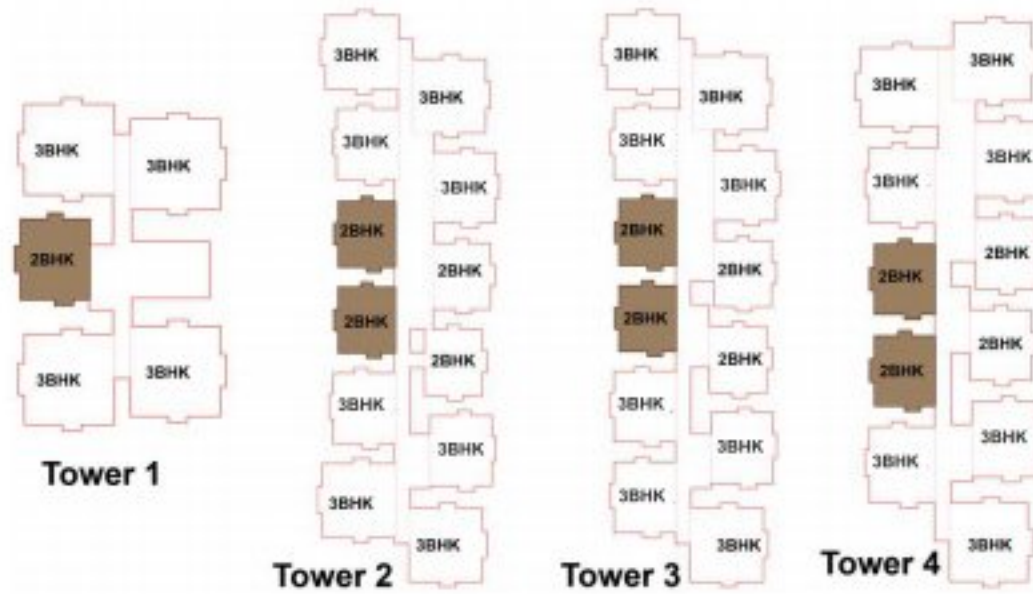

UNIT
TYPE B
2 BHK
WEST FACING
1310 SFT



UNIT

TYPE C
3 BHK
EAST FACING
1505 SFT



UNIT

TYPE D
3 BHK
WEST FACING
1505 SFT



UNIT

TYPE E
3 BHK
EAST FACING
1860 SFT



UNIT

TYPE E1
3 BHK
EAST FACING
1860 SFT

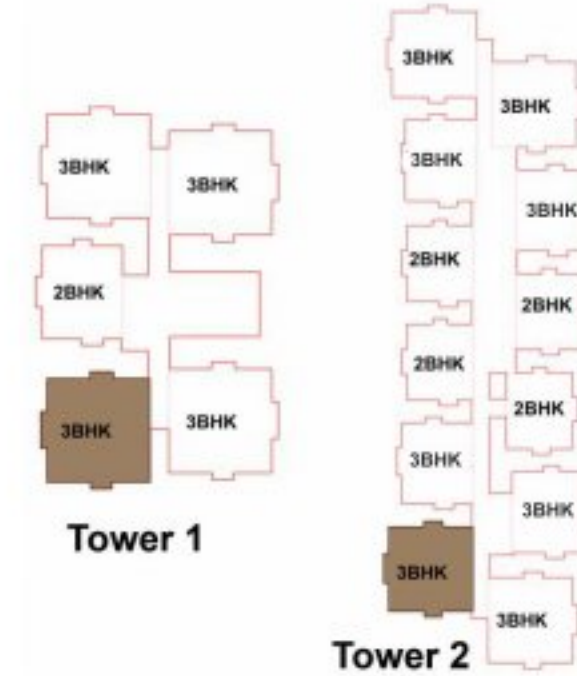

UNIT
TYPE F
3 BHK
WEST FACING
1860 SFT

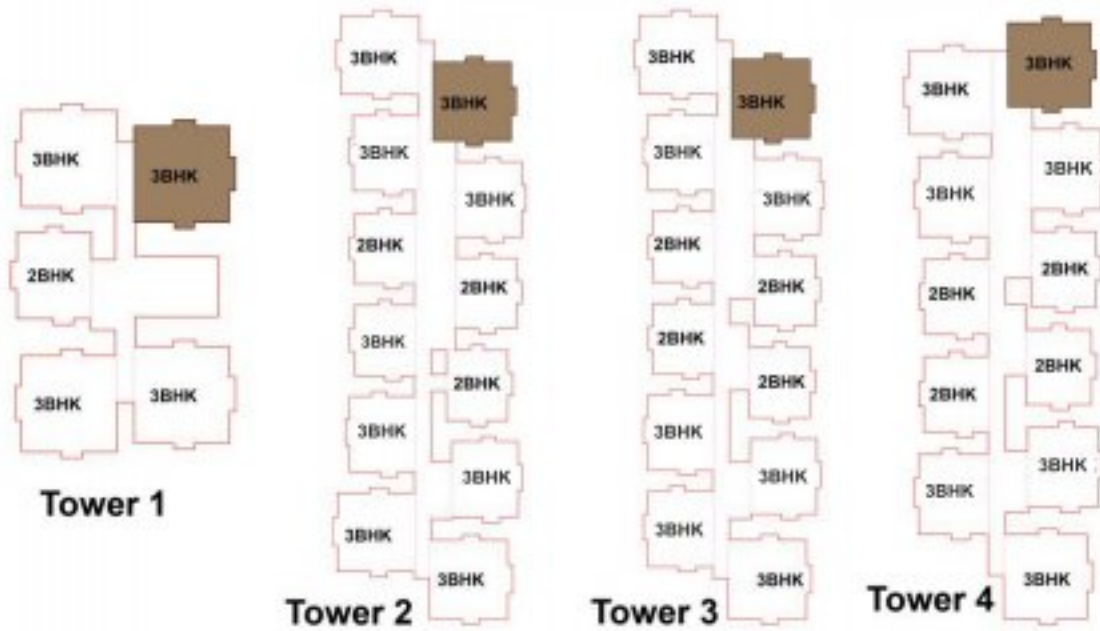

UNIT
TYPE F1
3 BHK
WEST FACING
1860 SFT

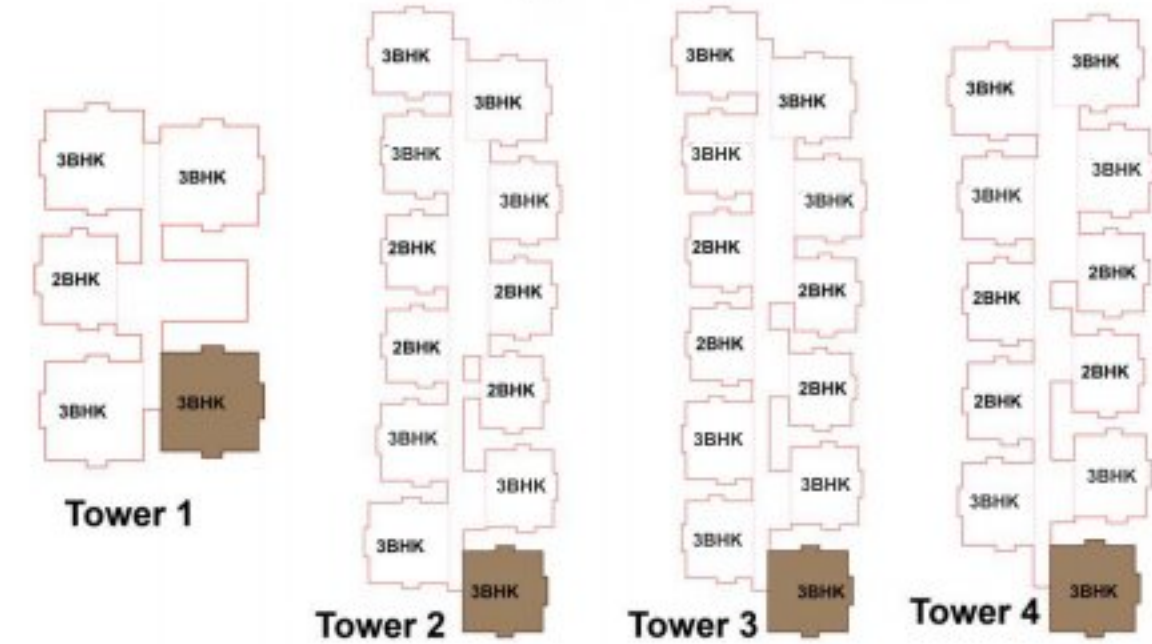

TOWER 1



TOWER 2



TOWER 3



TOWER 4





LOCATION MAP

NOT TO SCALE

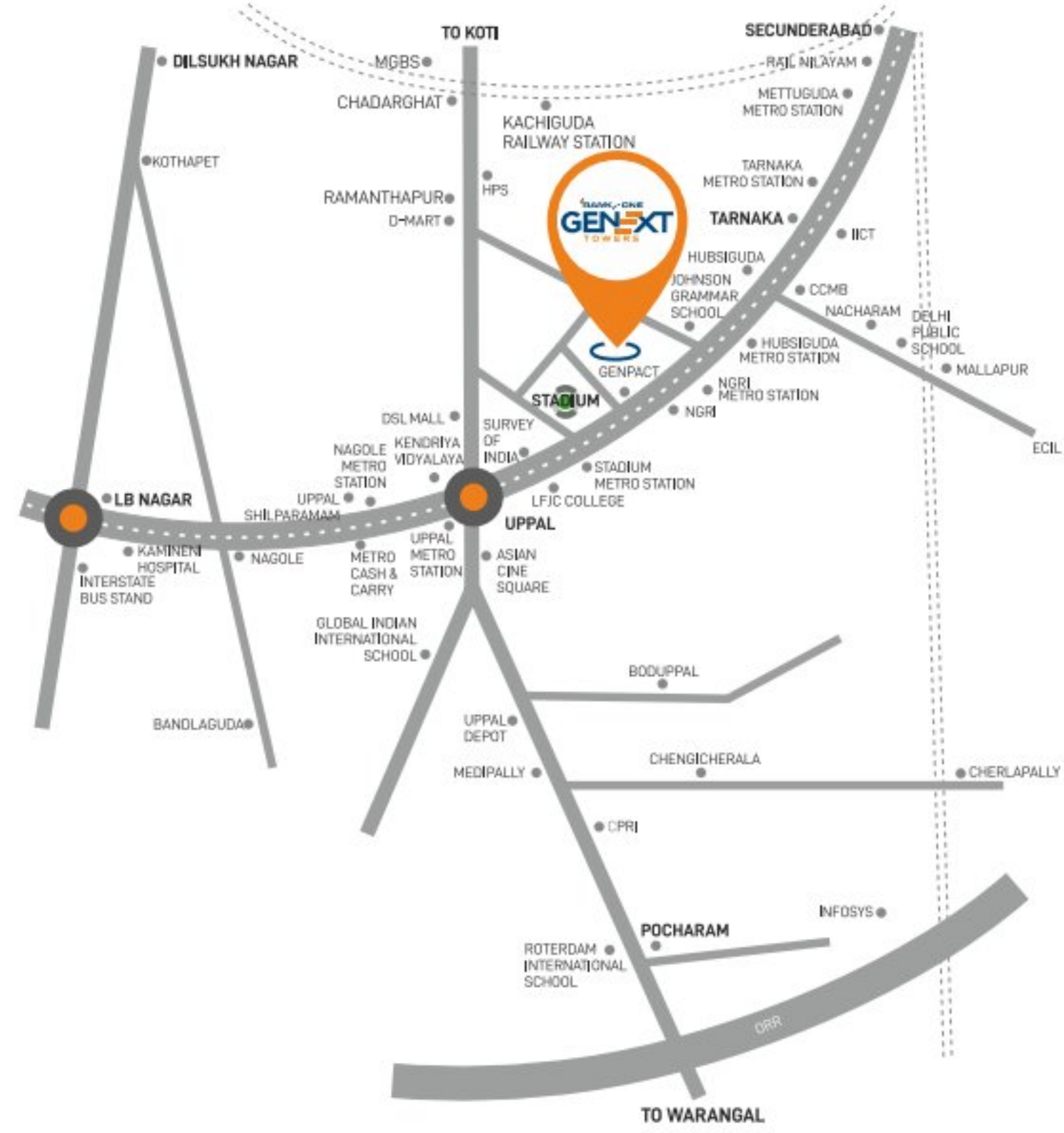

SCHOOLS

- ▶ Kendriya Vidyalaya
- ▶ Hyderabad Public School
- ▶ Johnson Grammar School
- ▶ Global Indian International
- ▶ Little Flower Jr. College

SHOPPING

- ▶ Metro Cash N Carry
- ▶ Spar
- ▶ D-Mart
- ▶ Vishal Mart
- ▶ Big Bazaar

HOTELS

- ▶ Swagat Grand
- ▶ Blue Orchids
- ▶ 78 Degrees
- ▶ Suprabath Hotel
- ▶ Chef Portico

HOSPITALS

- ▶ Matrix Hospital
- ▶ Aditya Hospital
- ▶ Kamineni Hospital
- ▶ Apollo Hospital
- ▶ Yashoda Hospital

DISTANCES FROM RAMKY ONE GENEXT :

NGRI Metro Station - 1 min | Secunderabad Railway Station - 15 mins | Hyderabad International Airport - 45 mins
 Well connected to all major landmarks of the city through Metro Rail (max in 30 Mins)

RAMKY ONE
GENEXT
 TOWERS
 GOOD LIFE. WITHIN REACH.