

Project by



CHORDIA'S
EXPECT MORE

Marketed by



Shyamashish
GROUP
RAJ/A/2023/8815



CHORDIA'S
KOSMOS

YOUR LUXURIOUS UNIVERSE
SHOWROOMS | OFFICES

RERA NO. RAJ/P/2024/2985

RERA NO. RAJ/P/2024/3222

<https://rera.rajasthan.gov.in/>

AT MAIN GOPALPURA BYPASS ROAD



Your Business Universe - Smarter Larger & Better

**BUILD TO UNCOMPROMISING STANDARDS OF DESIGN
CHORDIAS KOSMOS IS AN EXEMPLARY CREATION OF
LUXURY AT IT'S FINEST**

THE FINEST QUALITY OF LIFE WITH ACCELERATED GROWTH

PROJECT HIGHLIGHTS

- Drive Way
- Wet Points
- CCTV Camera
- Boundary Wall
- Safety & Security
- Copper Piping for AC
- Tractor Emulsion Paint
- Optical Fibre Conectivity
- Intercom with Instrument
- 2' X 4' Vitrified Tile Flooring
- Modular Electrical Switches
- Rain Water Harvesting System
- Power Backup in Common Areas
- Valet Parking During Business Hours
- Toughened Glass Door Entry Gate for Office

PROPOSED CAFÉ / RESTAURANT AT ROOFTOP

Excellent connectivity playing Vital role in business growth



CHORDIA'S
KOSMOS
YOUR LUXURIOUS UNIVERSE

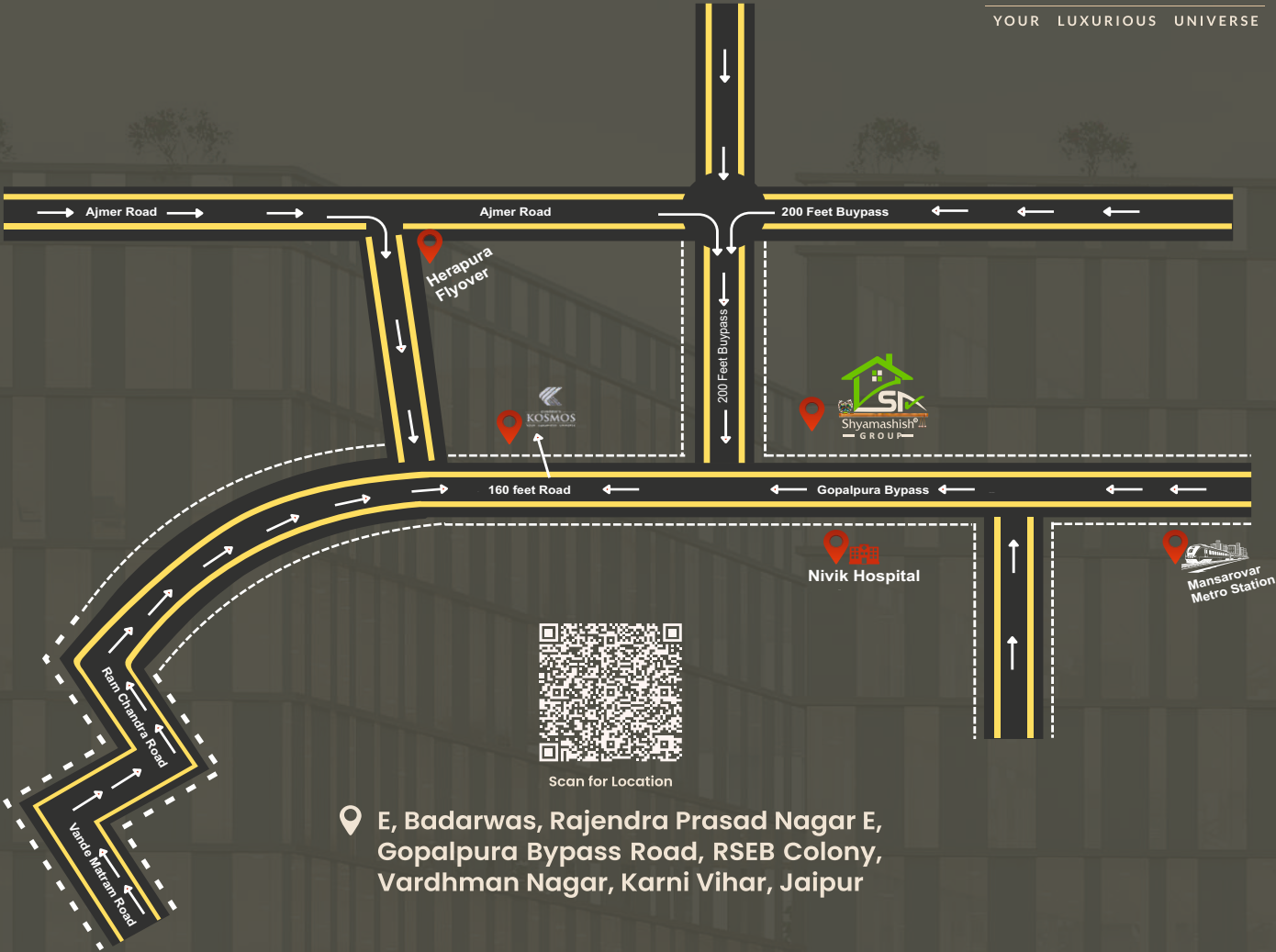

Commercial Centers

■ New Aatish Market	2.4 kms
■ Elements Mall	2.6 kms
■ WTP, Jaipur	8.9 kms
■ GT, Jaipur	8.6 kms
■ Crystal Court Mall	8.6 kms



Connectivity

■ Airport	11 kms
■ Railway Station	9.3 kms
■ Mansarovar Metro Station	1.6 kms
■ 200 Feet Bypass Road	900 mtrs
■ Delhi - Ajmer Expressway 48	1.3 kms



Hospitals

■ Nivik Hospital	1.1 kms
■ CK Birla Hospital	6.2 kms
■ Bhandari Hospital	6.8 kms
■ Somani Hospital	4.3 kms
■ Rukmani Birla Hospital	6.3 kms



Hotels

■ Highway King	1 kms
■ Grand Safari	3.9 kms
■ Ginger Jaipur	7 kms
■ Hilton Jaipur	6.8 kms
■ Holiday Inn Express	3.6 kms

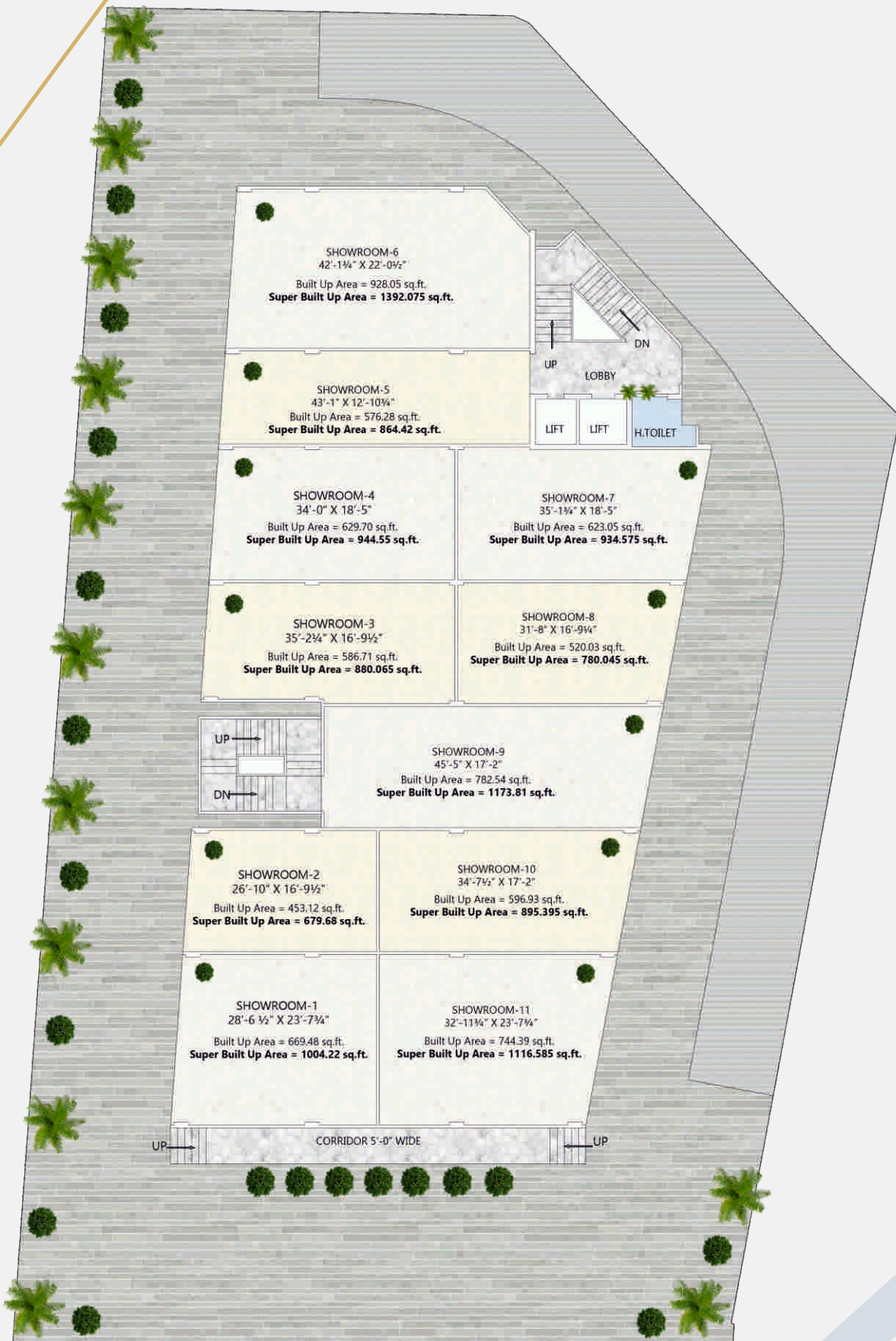

TOWER A – GROUND FLOOR PLAN (SHOWROOMS)



TOWER A – FIRST FLOOR PLAN (SHOWROOMS)



TOWER A – SECOND TO FIFTH FLOOR PLAN (OFFICES)



TOWER B – GROUND FLOOR PLAN (SHOWROOMS)



TOWER B – FIRST FLOOR PLAN (SHOWROOMS)



TOWER B – SECOND TO FIFTH FLOOR PLAN (OFFICES)



PRIME VILLE

3/4 BHK Villas,
Ajmer Road

90 UNITS



PRIME VILLE CLASSIC

3/4 BHK Villas,
Ajmer Road

47 UNITS



THE MARBELLA

3/4 BHK Villas,
Ajmer Road

35 UNITS



THE CROWN

3/4 BHK Apartments,
Tonk Road

252 UNITS



CHORDIA'S SHAGUN

2/3 BHK Apartments,
VT Road, Mansarovar

71 UNITS



WONDER HOMES

2/3 BHK Apartments,
Ajmer Road

120 UNITS



CHORDIA'S ATULYA

1/2/3 BHK Apartments,
Ajmer Road

340 UNITS



CHORDIA'S G4

2/3 BHK Apartments,
Ajmer Road

108 UNITS



CHORDIA'S UTSAV

2/3 BHK Apartments,
Mansarovar Extension

226 UNITS



CHORDIA'S AASHIYANA

2/3 BHK Apartments,
Kalwar Road

252 UNITS



TERRAZA GREENS

2/3/4 BHK Residences & 5 BHK
Duplexes, Mansarovar Extension

337 UNITS

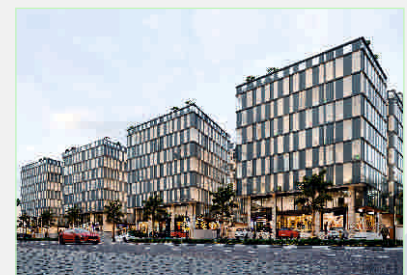

CHORDIA'S KOSMOS

Showrooms & Offices
Gopalpura Bypass

COMMERCIAL

**A 35 LACS+ Sq. Ft.
CONSTRUCTION
DONE SO FAR**

**50+ HIGHLY
SKILLED SALES
TEAM MEMBERS**

**2500+
SATISFIED CLIENT
ASSOCIATIONS**

**500+ ONSITE
MANPOWER
RESOURCES**

Marketed by



- Corporate Office -

Near Mansarovar Metro Pillar No. 01, Plot No. 41,
Nagaur Nagar, Gopalpura Bypass, Jaipur-302019
www.shyamashish.com

Project by



CHORDIA'S
EXPECT MORE

- Corporate Office -

Chordia Enclave
29, Janpath, Shyam Nagar, Jaipur - 302019
www.shyamashish.com

For more details, Call

