



SAVALI PARADISE

2BHK LUXURY APARTMENTS

YOUR NEW
ADDRESS OF *Flappiness*

A PROJECT BY
SAVALI GROUP & ELITE HOUSING CORP



SAVALI
PARADISE



Where

Serenity Beats Commotion !

As you place your first step at the entrance, a gush of serenity will engulf you. Driven by the overwhelming feeling of happiness, as you advance further inside, a rather spectacular site of the building will leave you spellbound. You will feel as if you have been transported to a different world.

Savali Paradise has all it takes to be a perfect dream-come-true place to live in. It exudes an aura of an ultimate, plush lifestyle that you will love to live in. It is a thoughtful and creative blend of luxury and leisure. It is an ultimate combination of comfort and convenience.

From systematically planned floor plans to selective choice of swish interiors, Savali Paradise has achieved a milestone in budgeted residential properties. Every house of the building has optimal spacing, impeccable styling and luxurious finishing.

It is one of the finest and tranquil destination located amidst all the commotion and hue and cry typical to Pune city. We are determined to redefine the concept of a "peaceful life" in this hustling-bustling city.





SAVALI
PARADISE



Life at

Savali Paradise

The amenities at Savali Paradise have been crafted to cater your recreational, fitness, social status and togetherness needs.

We have considered the wind and sunlight directions while planning the project, so that every home receives excellent ventilation and abundant natural light. We have also designed spaces to avoid congestion and provide you with ample spaces.

Is located in one of the most happening neighborhoods' of the city, right amidst the buzz. The convenience of having the best malls, school, hospitals and entertainment destinations a couple of minutes away, add to the charm of this great life style project.

Our life revolves around our family. We do our best to ensure that our loved once live a secured and comfortable life. And you tend to focus better on your professional front when you are assured of their safety and wellness. Savali Paradise offers that best in class safety features to make certain that your life stays relaxed and tension free.



TECHINICAL SPECIFICATIONS



Structure

- RCC framed structure conforming to latest Indian standard code of earthquake resistance.
- AAC block walls externally & internally or 6" thick brick masonry.
- Plaster of paris / gypsum finish to all internal walls.
- MS fabricated railing.
- Sand finished plaster for external surface.



Doors & Windows

- Decorative entrance doors with good quality fittings and fixtures.
- Both side laminated bedroom doors with frame & quality fittings and fixtures.
- Granite door frames with both side laminated door shutter to toilets.
- Good quality stainless steel fitting for doors.
- Powder coated aluminium sliding doors to attached balcony.
- Powder coated aluminium sliding windows with mosquito net and MS safety grill.
- Powder coated aluminium windows with exhaust fan provision for toilets.
- Granite / Marble sills to window bottom.



Electrification & Cabling

- Concealed fire resistance copper wiring with high quality modular switches in entire flat.
- Fire retardant ISI marked copper wiring.
- Telephone & television points in living room, master bedrooms & provision for other bedrooms.
- Provision for inverter for each flat.
- Split AC provision in master bedroom.



Bathroom & Toilets

- Concealed plumbing with stainless-steel finish fittings of exclusive quality.
- Hot & cold mixing units in toilets.
- Coloured glazed dado tiles in toilets up to lintel level (7ft height).
- Solar water provision in master bedroom bathroom.
- Provision for exhaust fan.



Kitchen & Dry Balcony

- Granite kitchen platform with stainless steel sink & outlets for water purifier.
- Coloured glazed dado tiles above kitchen platform up to lintel level.
- In dry balcony provision for washing machine.
- Provision for exhaust fan.



Flooring

- 600mm X 600mm high quality vitrified flooring for entire flat.
- Matt finished ceramic flooring to balcony, dry balcony and toilets.
- Glazed / ceramic tiles for toilet dado up to lintel height.



Painting

- Good quality acrylic oil bond for internal walls and ceiling.
- Good quality 100% acrylic paint for external walls.
- Oil paint for MS grill and railing.



DESIGN

- Designed For Better Light & Ventilation
- Optimum Use Of Space
- Designed To Fit All Furniture Properly



ECO-FRIENDLY INITIATIVES

- STP
- OWC Machine To Recycle Wer Waste
- 100% Dg Backup For All Common
- Lights & Lifts



SECURITY One Bathroom

- CCTV Cameras Security System
- Access Control To All Building At Ground & Basement
- Video Door Phone



COMFORT & CONVENIENCE

- AC Points in All Bedrooms
- Telephone Point In Living Room
- Common Satelite Cable TV Wiring in Living Room





2 BHK
Cut Section



2 BHK
Cut Section



AMENITIES



Reserved Parking



Children's Play Area
Indoor Games



Senior Citizen Sit Out



Solar Water Heater



Fire Hydrant and Sprinkler
System at Parking Level



Organic Waste Converter



100% DG Backup for Lift
and Common Area



Rainwater Harvesting
Vermiculture



Yoga & Meditation Space

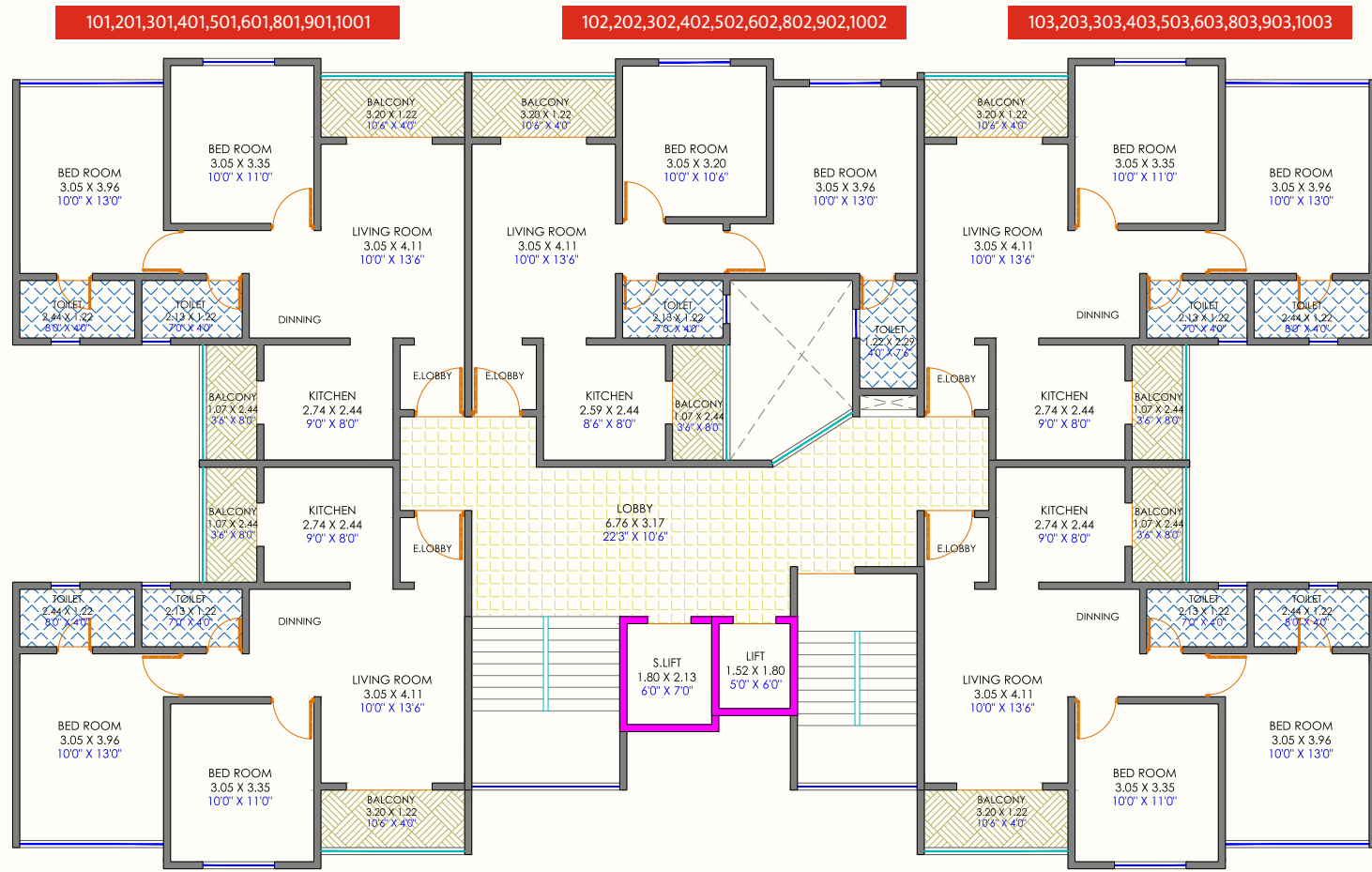

Typical Floor Plan
A & B Building

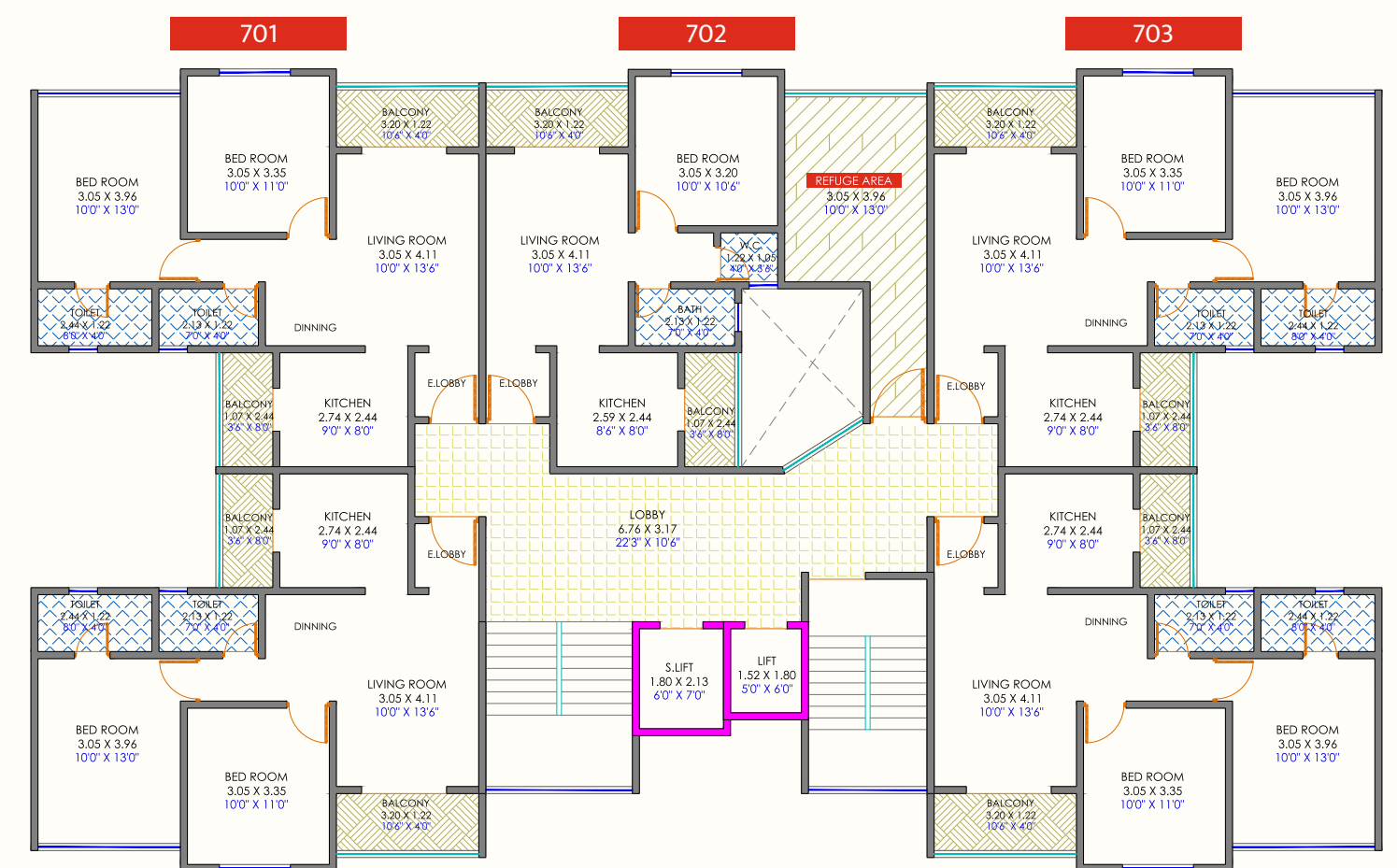

7th Floor Plan
A & B Building

FLAT NO	FLAT TYPE	CARPET AREA	BALCONY AREA	TOTAL CARPET	SALEABLE AREA (SQ. FT. 1.35%)
101,201,301,401,501,601,801,901,1001	2 BHK	698.50	000	698.50	943
102,202,302,402,502,602,802,902,1002	2 BHK	666.60	000	666.60	900
103,203,303,403,503,603,803,903,1003	2 BHK	698.50	000	698.50	943
104,204,304,404,504,604,804,904,1004	2 BHK	698.50	000	698.50	943
105,205,305,405,505,605,805,905,1005	2 BHK	698.50	000	698.50	943

FLAT NO.	FLAT TYPE	CARPET AREA	BALCONY AREA	TOTAL CARPET	SALEABLE AREA (SQ. FT. 1.35%)
701	2 BHK	698.50	000	698.50	943
702	1 BHK	497.40	000	497.40	671
703	2 BHK	698.50	000	698.50	943
704	2 BHK	698.50	000	698.50	943
705	2 BHK	698.50	000	698.50	943



Enjoy your *Lifestyle*





SAVALI PARADISE

Ongoing Projets

SAVALI PARADISE

Site Address :

Sai Nagar, Opp. Khetmala Hospital,
Salave Garden, Gangadham - Shatrunjay Road,
Kondhwa Budruk, Pune, Maharashtra - 411046

Contact : +91 8484 83 8231 / 8484 83 8271

Email : savaliparadise@gmail.com

Architect
Dd architects
Devendra Dhere

RCC
Ms. Shankar Bade
& Associates

Legal Advisor
Adv. Vijay Nalawade

Completed Projets



Savali Heights

Sairaj Nagar, Katraj, Pune - 411046



Savali Enclave

Varkhade Nagar, Katraj, Pune - 411046



Savali Heritage

Jadhav Nagar, Gujarwadi Phata,
Katraj, Pune - 411046



Key Distances

Katraj Chowk : 3.2 km
Market Yard : 3.5 km

Khadi Machine Chowk : 3.0 km
Bharti Vidyapeeth : 3.5 km

Katraj Snake Park : 4.0 km
D Mart : 2.0 km

Kumar Pacific Mall : 5.0 km
Iskcon Temple : 1.0 km
Shatrunjay Temple : 1.0 km



Site Address :

Sai Nagar, Opp. Khetmala Hospital,
Salave Garden, Gangadham - Shatrunjay Road,
Kondhwa Budruk, Pune, Maharashtra - 411046

Contact : +91 8484 83 8231 / 8484838060

Email : savaliparadise@gmail.com

Project Approved Banks :

