



# PRAKRIT

*Exclusive* 3 BHK INDEPENDENT VILLAS

A HOUSE FOR GENERATIONS



## SUSTAINABLE HOMES AMIDST *nature's embrace*

Nestled amidst lush greenery and serene landscapes, Our project is a visionary & Luxury Villa project that stands as a testament to harmonious living with nature. Situated in the heart of Zirakpur in most green vicinity, this innovative development offers a sustainable and eco-friendly lifestyle that redefines modern living. The concept behind our luxury villa project was born out of a deep-rooted desire to create a residential haven where residents could escape the hustle and bustle of urban life and embrace a more balanced, expandable, sustainable, and healthier way of living. With a focus on preserving the natural beauty of the surroundings, the project aims to strike a seamless balance between need of the hour for and environmental consciousness.

*Exclusive* **3 BHK VILLAS**

**EXPANDABLE TO 5 BHK**

# LOCATION map



# LOCATION *advantage*

CONVENIENTLY LOCATED ON  
CHANDIGARH-PATIALA HIGHWAY (NH-64)

*2 Min.*

- Mohali City Square
- Gopal Sweets

*3 Min.*

- HP Petrol Pump
- Holy Convent School
- Radisson Hotel

*5 Min.*

- Bus Stop
- MCD/KFC/Burger King
- Amcare Hospital
- Decathlon
- PVR Cinema
- HLP Social Square

*15 Min.*

- Best Price & Metro
- Upcoming Metro Station
- International Airport
- IT City & AERO City
- Elante Mall
- ST. Xavier's School
- Railway Station
- Amity University

High Ground Road, Patiala Rd, Zirakpur – Punjab

# SITE *Plan*



## Conceptual Plan

Subject to final approvals & amendments as per Authority.

# PROJECT *amenities*



BASKETBALL COURT



KIDS PLAY ZONE



POLLUTION FREE ENVIRONMENT



RAIN WATER HARVESTING



UNDERGROUND WIRING



CCTV SURVEILLANCE



GATED TOWNSHIP WITH 24X7 SECURITY



GREEN PARK FOR YOGA AND MEDITATION



WIFI CONNECTIVITY

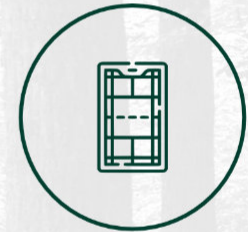

BADMINTON COURT



GYMNASIUM



POWER BACKUP



MULTIPURPOSE PARTY HALL



24X7 WATER SUPPLY

# TECHNICAL *Specifications*



## LIVING/DINING ROOM

- Vitrified/ceramic Tiles
- Long-lasting Emulsion Walls
- Branded UPVC Windows
- Secure Mortise Locks
- Premium Modular Switches
- Copper Wiring for AC
- 8 feet High Flush Doors
- Designer Wallpaper



## MASTER BEDROOM

- Vitrified,/Ceramic Tiles
- Long-lasting Emulsion Walls
- Branded UPVC Windows
- 8 feet High Flush Doors
- Secure Mortise Locks
- Premium Modular Switches
- Copper Wiring for AC
- Designer Wallpaper



## KITCHEN

- Modular Kitchen
- Granite Counter Top
- Double Bowl SS sink
- Branded Faucet
- Provision for under sink RO
- Branded Chimney
- HOB



## TOILETS

- Anti-skid Ceramic Tiles
- Designer Ceramic Tiles
- 8 feet High Flush Doors
- Secure Mortise Locks
- Premium Modular Switches
- Branded Bath Fittings
- Branded CPVC Fittings



## OTHER ROOMS

- Vitrified,/Ceramic Tiles
- Long-lasting Emulsion Walls
- Branded UPVC Windows
- 8 feet High Flush Doors
- Secure Mortise Locks
- Premium Modular Switches
- Copper Wiring for AC
- Designer Wallpaper



## STANDARD FEATURES

- Power Backup
- Wiring as per IGBC Standards
- Table Tennis
- 24x7 security
- Earthquake Resistant Structure





# CLUB *house*

CLUBHOUSE FACILITIES AS NEVER BEFORE

- Multipurpose Party Hall
- Recreation Room
- Billiards Room
- Table Tennis
- Gymnasium
- Badminton Court
- Basketball Court & many more...





# FLOOR *Plan*

## EXCLUSIVE 3 BHK VILLAS

### GROUND FLOOR



# FLOOR *Plan*

## EXCLUSIVE 3 BHK VILLAS

### FIRST FLOOR



# FLOOR *Plan*

## EXCLUSIVE 3 BHK VILLAS

### TERRACE FLOOR

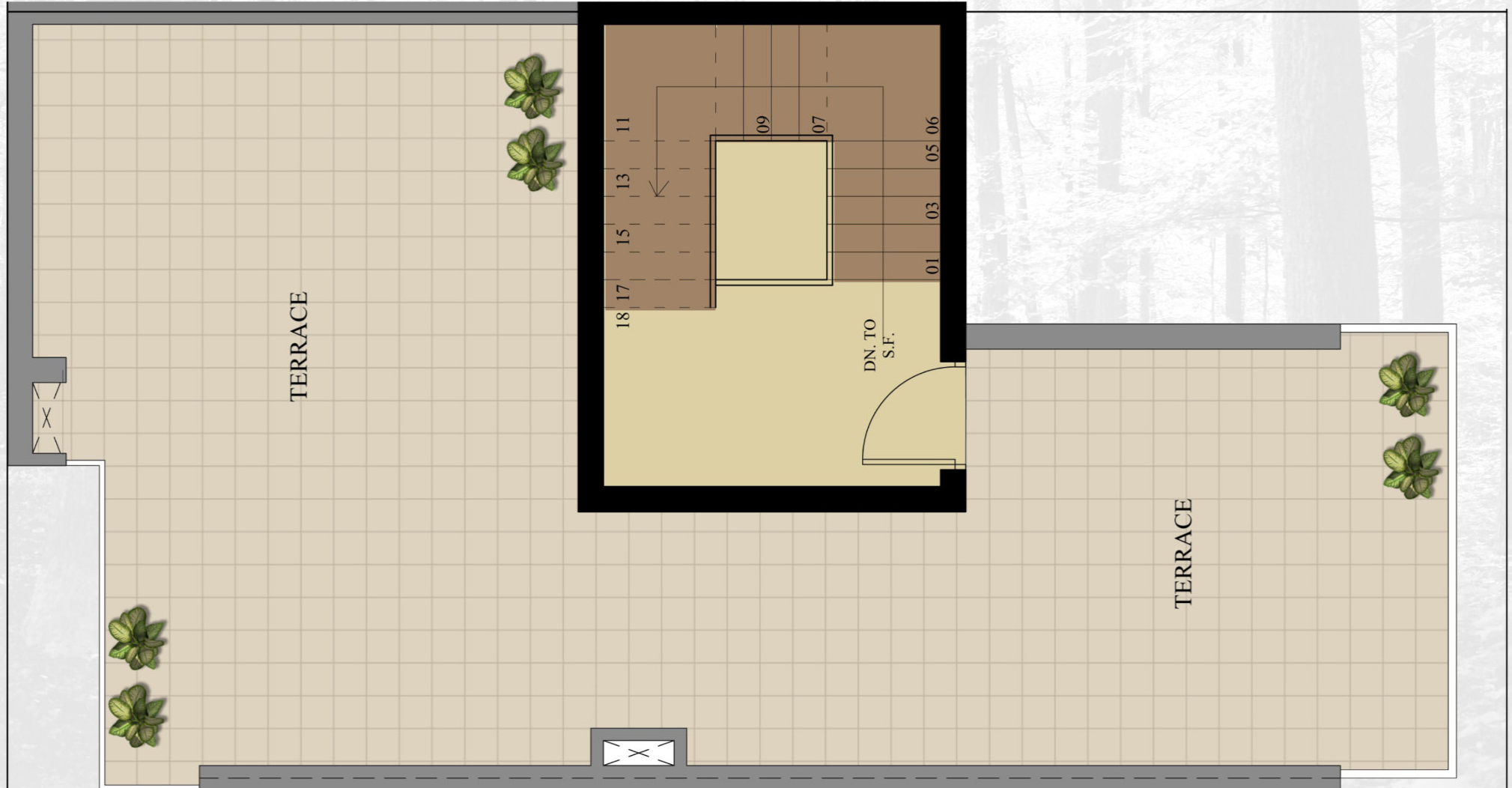

# CONCEPTUAL PROJECT *image*



# CONCEPTUAL PROJECT *image*



Disclaimer: This document is a conceptual draft of a future villa project, and is created for internal use only.

# CONCEPTUAL PROJECT *image*



# CONCEPTUAL PROJECT *image*



Disclaimer: This document is a conceptual draft of a future villa project, and is created for internal use only.

# CONCEPTUAL PROJECT *image*



Disclaimer: This document is a conceptual draft of a future villa project, and is created for internal use only.



# CONCEPTUAL PROJECT *image*



Disclaimer: This document is a conceptual draft of a future villa project, and is created for internal use only.

# CONCEPTUAL PROJECT *image*



Disclaimer: This document is a conceptual draft of a future villa project, and is created for internal use only.

# CONCEPTUAL PROJECT *image*



Disclaimer: This document is a conceptual draft of a future villa project, and is created for internal use only.



EXPERIENCE THE ENCHANTING SYMPHONY OF NATURE  
NESTLED AMIDST TOWERING TREES AND

*Flourishing greenery*