

CODENAME

# ETERNAL

MARINE LINES



Artist's Impression

WHERE TRADITIONAL CHARM MEETS MODERN  
LIVING IN THE HEART OF SOUTH MUMBAI

URBAN 2 BHK RESIDENCES

**SEJAL**  
REALTY



“ Experience life at Marine Lines, where the charm of the past dances with the vibrancy of the present, crafting an eternal masterpiece of living. ”

# WHERE HERITAGE MEETS CONTEMPORARY LUXURY.

Eternity offers an array of 1 & 2 BHK luxury residences that seamlessly blend classic charm with contemporary style. Each living space is a testament to the enduring values of tradition harmonizing with the conveniences of modern living, ensuring you live a life that's truly eternal.



Luxurious  
1&2 BHK Homes



15+ Lifestyle  
Amenities



Gated  
Community



Enchanting  
Cityscape View



# ELEVATE YOUR LIFESTYLE WITH UNMATCHED AMENITIES

At "Eternal," we offer a suite of **15+ luxurious Amenities** that perfectly complement your lifestyle. From modern comforts to timeless indulgences, your journey in Marine Lines will be nothing short of spectacular.



Artist's Impression

Open Party Zone



Artist's Impression

Fitness Centre



Artist's Impression

Jogging



Artist's Impression

Prayer Room

- Infinity Swimming Pool,
- Fitness Centre,
- Indoor play area,
- Crèche,
- Jogging/ Walking Path,
- Star Gazing Deck,
- Juice Bar,
- Open Party Zone,
- Pool-side Deck,
- Party Hall,
- Barbeque Zone

# WHERE CONVENIENCE MEETS CONNECTIVITY

In the heart of South Mumbai lies Marine Lines, a place where the old-world charm of the city meets modernity. With its rich history, proximity to iconic landmarks, and excellent connectivity, Marine Lines is a testament to Mumbai's enduring spirit.



## CONNECTIVITY

- Marine Lines Station - 1.9km / 8 mins
- Eastern Freeway - 1.9km / 8 mins
- CST Station - 2.1km / 14 mins
- Bandra Worli Sea Link - 15.2km / 35 mins
- Chhatrapati Shivaji Maharaj International Airport - 22.3km / 44 mins

## EDUCATION

- Our Lady of Dolours School - 1.8km / 7 mins
- St. Xavier's College - 1.6km / 11 mins
- HR College - 3.6km / 14 mins
- Grant Medical College - 2.4km / 15 mins
- Champion School - 4.2km / 16 mins
- KC College - 4.5km / 17 mins
- G.D. Somani School - 6.8km / 25 mins

## LEISURE

- Chowpatty - 2.1km / 9 mins
- Hindu Gymkhana - 3.5km / 12 mins
- Pizza by the Bay - 3.5km / 13 mins
- Gateway of India - 3.7km / 15 mins
- The Oberoi - 3.8km / 16 mins
- The Trident - 3.7km / 16 mins
- The Taj Mahal Palace Hotel - 4.2km / 17 mins
- Hanging Garden - 5.6km / 19 mins
- Colaba Causeway - 5.5km / 19 mins

## COMMERCIAL HUBS

- Nariman Point - 4.6km / 16 mins
- Lower Parel - 8.4km / 29 mins
- Chembur - 18.2km / 41 mins
- BKC - 20km / 42 mins
- Andheri MIDC - 26.1km / 55 mins

## HEALTHCARE

- Suryakant Wagal Maternity Hospital - 0.2km / 2 mins
- Saifee Hospital - 1km / 7 mins
- Sir H.N. Reliance Foundation Hospital - 1.7km / 11 mins
- Bombay Hospital - 1.9km / 13 mins
- J J Hospital Mumbai - 2.5km / 16 mins

# FLOOR PLANS

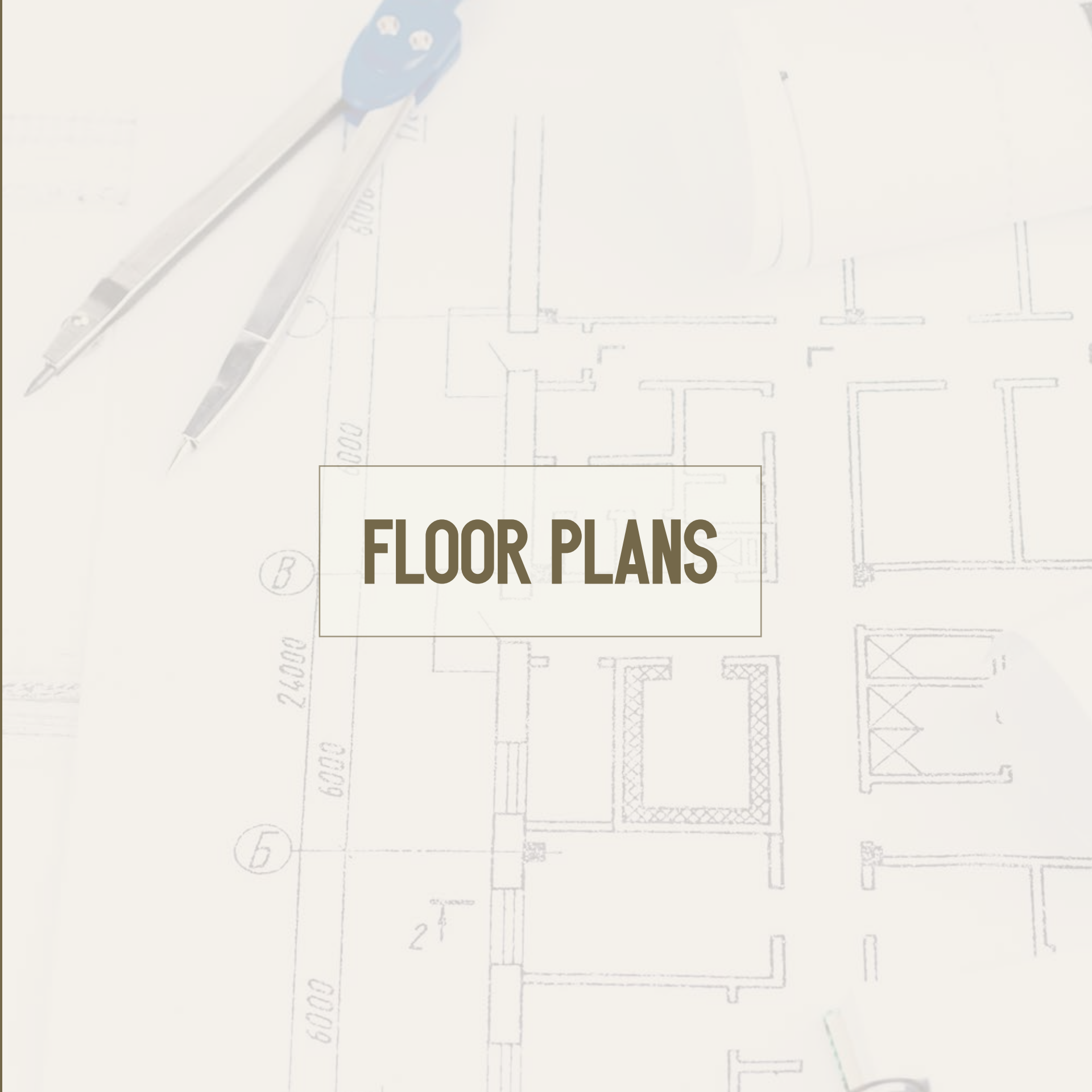



## ABOUT US

Transforming hand-picked locations into coveted destinations, Sejal Developers are building a reputation for excellence and elevated lifestyles across Mumbai. Every icon from the Sejal Group is shaped by high quality construction, modern technology and premium finishes. Creating landmarks that redefine the landscape and reimagine the living experience. We are proud that residences from the Sejal Group stand the test of time, while they also stay ahead of the luxury lifestyle curve, with exemplary amenities and privileges.

**10+ YEARS**  
of experience

**5+ LAKH SQ.FT**  
Of development executed

**2+ MILLION SQ.FT.**  
of development undertaken



VISTAAR APAAR  
DEVELOPERS PVT LTD

## ABOUT US

Driven by the vision of delivering beyond expectations, Vistaar Developers is known for a hands-on approach and meticulous attention to detail. The company has an enviable track record in project management, as it has the expertise to offer design inputs and engineering solutions as well as significant project management and co-ordination skills. With a clear communication approach towards all stakeholders, strict supervision and quality control and timely delivery, the company has earned its stature in Mumbai's real estate and construction sector

CODENAME

**ETERNAL**  
MARINE LINES



Sales Lounge Kansara Trust Building, Dadiseth Agiyari Lane, Navi Wadi, Marine Lines, Mumbai - 400 002

**8169400138**

The project has been registered via MahaRERA Registration No. P51900047328 is available on the website maharera.mahaonline.gov.in under registered projects. The project name is Sejal Aquarius and is marketed as Passcode Sea & Believe.

# GROUND FLOOR



# 22<sup>ND</sup> FLOOR AMENITIES



1. SOCIETY OFFICE -  
VITRIFIED TILES  
4150 x 4850  
20 SQ.M  
215 SQ.FT

2. INDOOR GAMES PARTY HALL -  
WOODEN FLOORING  
11300 x 6000  
63.50 M  
684 SQ.FT

3. FITNESS CENTER -  
RUBBER FLOORING  
14950 x 5950  
79.40 SQ. M  
854.65 SQ.FT

4. RECEPTION/  
ENTRANCE LOBBY  
4100 x 3600  
10.65 SQ.M  
114 SQ.FT

5. CRECHE -  
VINYL  
3050 x 6050  
18.50 SQ.M  
200 SQ.FT

6. READING  
CORNER WITH  
SPILL OVER  
AREA  
3150 x 4700  
17.95 SQ.M  
193 SQ.FT

7. SPILL  
OUT  
AREA

# TERRACE PLAN

