

# Provident Sunworth City, Off Mysore Road, Bengaluru

## 1. Google Location

<https://maps.app.goo.gl/L6UKtjTFUDrmH7us5>

## 2. Land Sketch:



## 3. Elevation: (actual photo of completed phase)





Actual photo of completed phase 2



#### 4. Project Feature:

- Largest township in South Bengaluru, sprawling over ~60 acres
- 5 mins from Challaghatta Metro Station & Mysore Road; 10 mins from NICE Junction and Kengeri Bus Terminal
- 19 acres of dedicated green covers with 7000+ trees & plants
- 50+ lifestyle amenities
- MIVAN Construction Technology
- Only project to have a School and Retail-Commercial space, Convenience Center, BMTC Bus Stop and a Shuttle service for Metro
- Unit Sizes:
  - 2 BHK: 883 sq.ft.
  - 3 BHK: 1082 sq.ft.

#### TYPICAL FLOOR PLAN

Wing - K, L, M

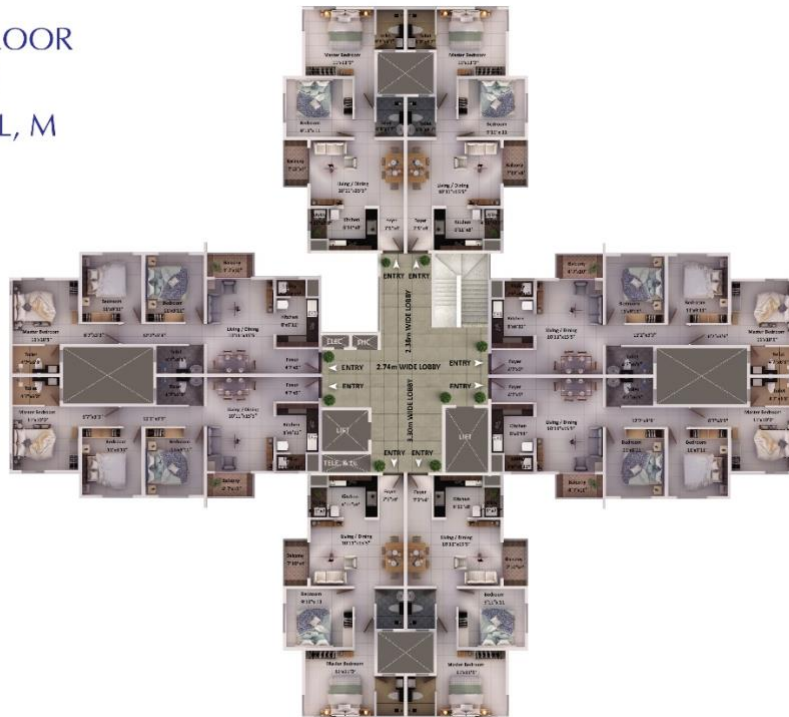

TYPICAL  
UNIT PLAN  
2 BHK



TYPICAL  
UNIT PLAN  
3 BHK



## 5. Key Amenities

- Viewing Deck
- Forest Walk
- Yoga Pavilion
- Paw Park
- Community Lawn
- Kids Play Area
- Badminton court
- Multipurpose Hall
- Basketball Court
- Tennis Court
- Cricket Net
- Play Lawn
- Jogging Track
- Skating Rink
- Tree House
- Mini Bridge
- Kid's Play Area

## 6. Location Highlights:

- Challaghatta Metro Station - 1.8 km
- Kengeri Metro Station - 4.6 km
- Kengeri Railway Station - 5.6 km
- Bidadi Industrial Estate - 18 km
- Global Village Tech park - 7 km
- Raja Rajeshwari Medical College and Hospitals - 1 km
- Raja-Rajeshwari Dental College and Hospitals - 4 km
- BGS Hospital - 6 km
- Good Earth Eco Tourism - 3 km
- Grips Gokarting and Clubbing - 3 km
- Decathlon - 4 km

- Marigold International School - 5 km
- Gurukula Vidya Peetha School - 6 km
- Gopalan National School - 6 km
- ACS College of Engineering - 2 km
- RR College of Engineering - 5 km
- RV College of Engineering - 9 km
- Bangalore University - 11 km

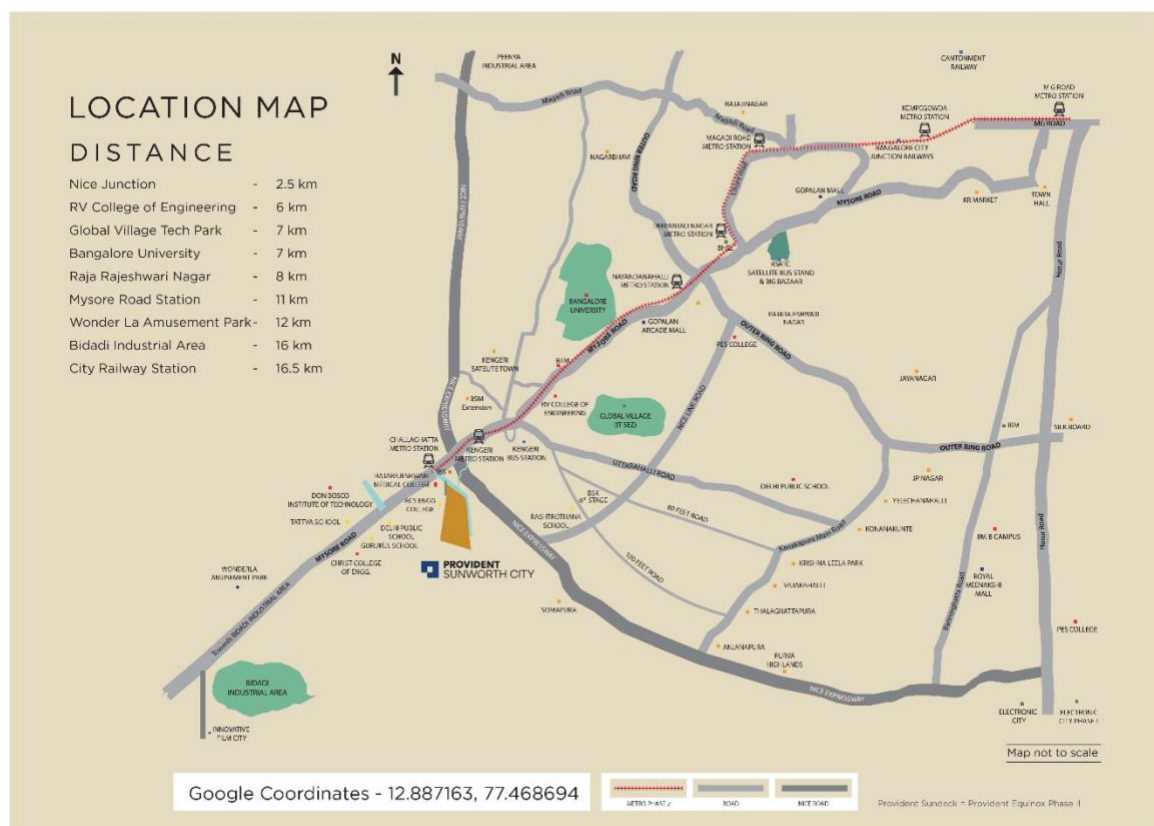

Contact Details:

DEVARU HEGDE

Reachmaxx Business Boosters

1<sup>st</sup> Floor, Netravati Square, Shirur Park Main Road, Hubballi – 580021

9900263823 / 7353311107