

AKRAYA
Residency

Sail Into Your New Home...

**A Luxury Apartment
@ Padmasri Hills, Bandlaguda Jagir**

**A PERFECT
COMBINATION**



Welcome fresh air and natural light for the rest of your life!

Note : This brochure is only a conceptual presentation of the project and not a legal offering. The promoters reserve the right to alter and make changes in elevation, specifications and plan as deemed fit.



AKRAYA Residency

Sail Into Your New Home...

Akraya residence a premium two and three bed room luxury apartment complex crated to match the today's modern lifestyle. At Akraya your home is not just a destination it is total experience. A place that makes your dreams come true. Added to this is the unique ambience of a masterly architectural design that life.

A - Astonishing

K - Kick Start

R - Royal

A - Authentic

Y - Youth

A - Adorable

A beautiful & spacious home is like, no other Place in the world. That is the reason why buying a home is the single most important decision that you make.

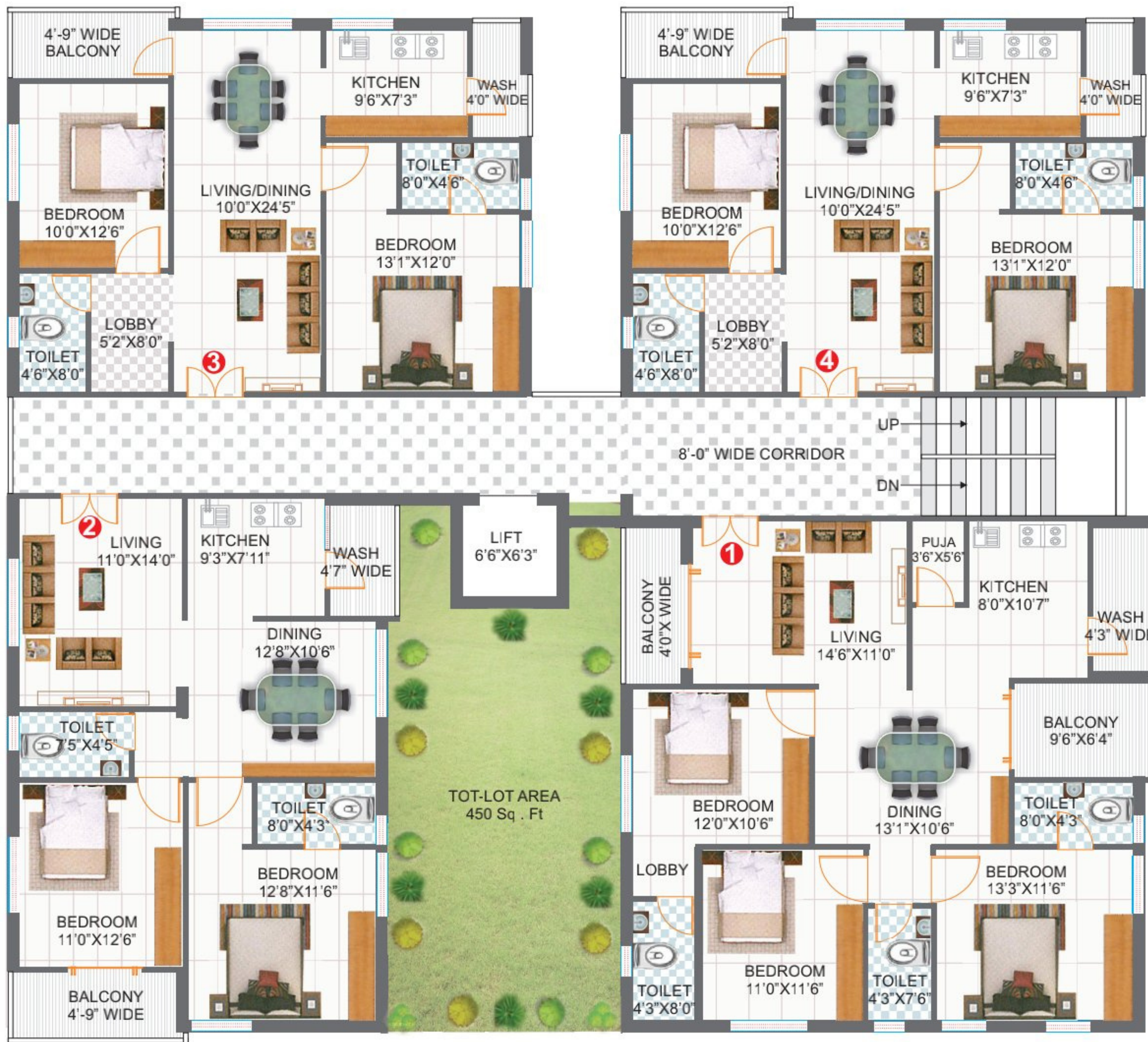

40' WIDE ROAD

Typical Floor Plan

Area Statement

Flat No	Area In Sft
1	1600
2	1220
3	1180
4	1180

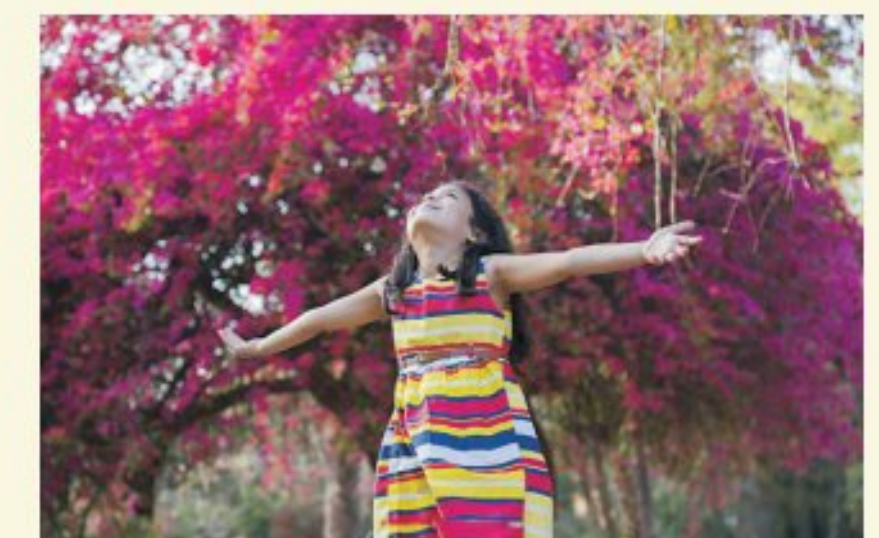
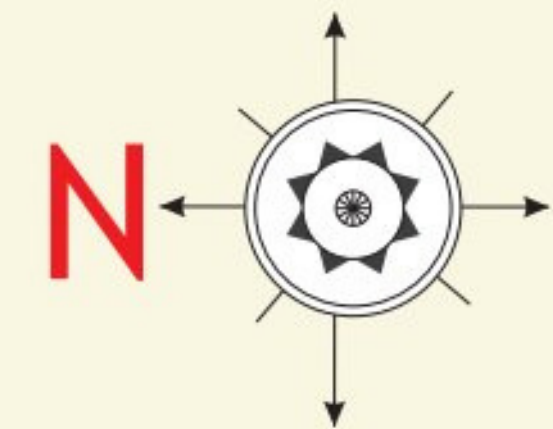

Car Parking

AKRAYA Residency

Sail Into Your New Home...

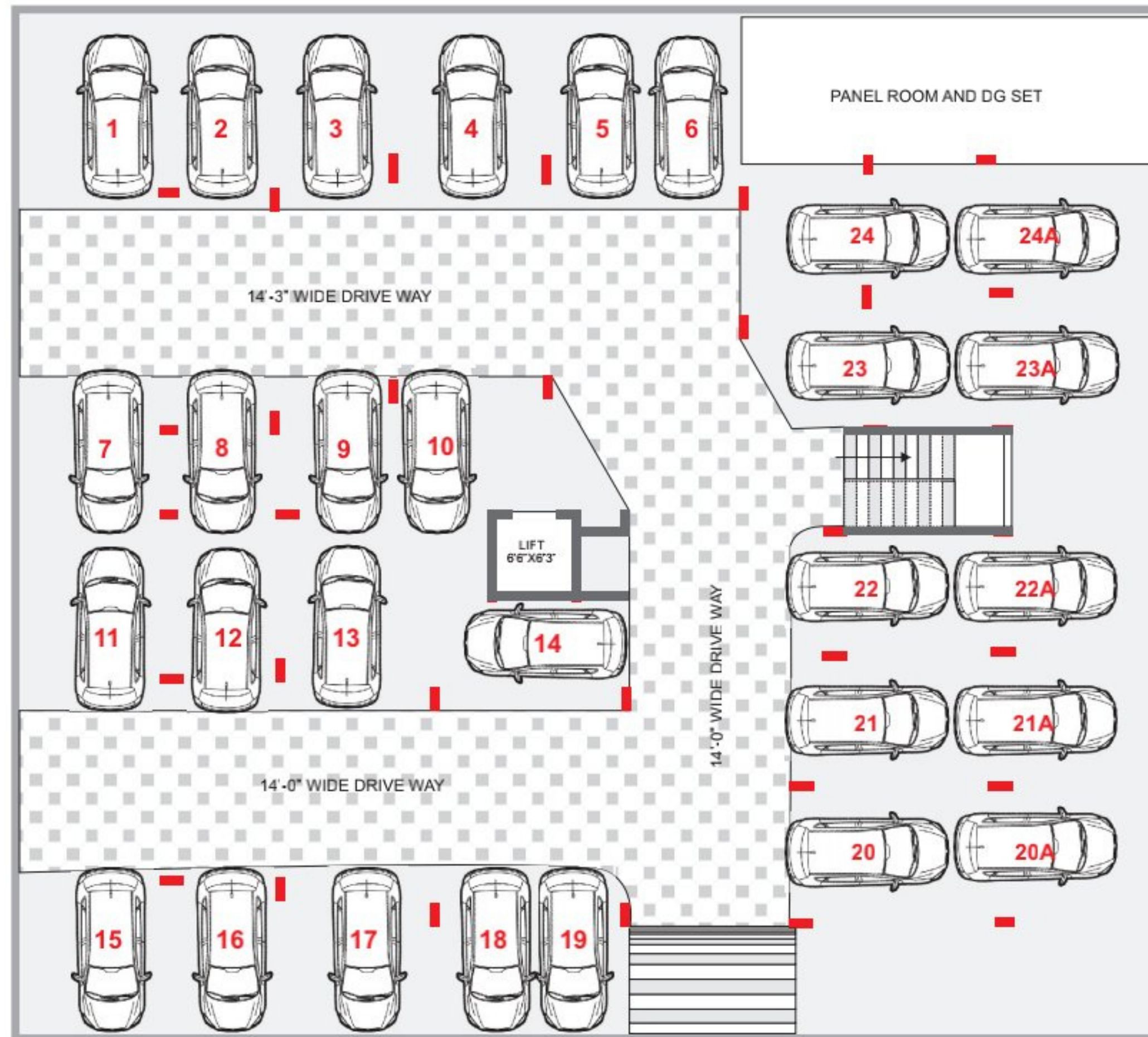

R O A D



STRUCTURE

R.C.C. Framed Structure.



WALLS

Red Burnt Bricks walls in CM with Outer walls 9" Internal walls 4 1/2"



PLASTERING

Two coats of plastering with sponge finish



MAIN DOOR

Teak wood frame with Veneer Finishing door



INTERNAL DOORS

Teak wood Frames With Best Quality Flush Doors along with necessary hardware fittings



WINDOWS

UPVC windows with Mosquito mesh and safety Grills and sides are Granite finishing



FLOORING

Vitrified Tiles of 2'X2' size



TOILETS

Ceramic tile cladding up to 7' height, best quality sanitary fittings (CERA) Flooring with Anti-Skid ceramic tiles, One commode European and Indian Style (Orissa Pan)



Amenities

100% Vaastu

Pleasant Elevation

User Friendly Floor Plans

Premium Quality Construction

Rain Water Harvesting

Provision For HMWS & SB Water

CC Camera Security

DG Back Up only common area



SPECIFICATIONS & DETAILS

KITCHEN

Polished Granite Platform With Steel Sink And 4' Dadoing With Glazed Tiles.

PAINTING

Premium Emulsion&Birla putty/Lata finish/External as per elevation (Asian Paints)

ELECTRICAL

Concealed PVC pipes and copper wiring with branded. modular switches (Havells), Included TV and Telephone, Geyser and AC points.

WATER SUPPLY

Bore water for General purpose will be supplied through sump and over head tank Provision for manjeera water supply for drinking purpose

GENERATOR

Back up with Generator lift, Common Area Lighting and in each 2 Bhk 3 points, 3 Bhk 4 points

LIFT

Six Passengers capacity of standard make 2 no's lift's and two stair cases

SECURITY

CC Cameras Providing to Parking area only

EXTRAS

Registration , GST, Car Parking, Lift, Generator, and Electricity, drainage system and all taxes to be borne by the purchaser

AKRAYA Residency

Sail Into Your New Home...