

created for a divine life



DIVINE
—SPACE—

LIVING DELIGHTFUL

RERA NO : P01100005787

@ TELLAPUR-OSMAN NAGAR ROAD

divine perfection is our mission

Divine Space is a premium offering from a company that has taken perfection to new levels – Divine Homes. Driven by the passion to create something new for the city's elite, Divine Homes presents a full-scale premium gated community of 9 stunning blocks on 8 acres of landscaped magic.

Divine Space in the future-ready locale of Tellapur-Osman Nagar Road is a world you should call your own.



a divine space is
designed for

good life

Every apartment in Divine Space speaks of luxury. The ambience is warm and inviting, so each family member enjoys privacy as well as togetherness. The charming bedrooms, the sun-kissed kitchen and the lavish balconies blend in seamlessly, turning the indoor and outdoor into a complete experience.

DIVINE
—SPACE—

a divine space is
the finest designing



**DIVINE**
—SPACE—

7.7
ACRES

876
UNITS

2&3 PREMIUM
RESIDENCES
1230-2195SQ.FT

9 BLOCKS

2 BASEMENTS
GROUND +
12 FLOORS

LAVISH
CLUBHOUSE

DISABLED'S
FRIENDLY
ACCESS RAMPS

VISITOR'S
WAITING
LOUNGE
AT EVERY BLOCK

VAASTU
COMPLAINT
UNITS

DOMESTIC
WATER
AVAILABLE
THROUGH A WATER
SOFTENING PLANT

SAFETY &
SECURITY

CCTV
SURVEILLANCE,
SOLAR FENCING,
AUTOMATIC ENTRY
AND EXIT SYSTEMS
(BOOM BARRIER)

CAR WASH
LAUNDRY
ROOM

DRIVER WAITING
LOUNGE
DRIVER &
MAID TOILETS



a divine space is
a state of bliss

The stunning facade is an interesting work of art.
The towers stand tall on meticulously
landscaped grounds. There is a lavish spread of greenery
and walking tracks where residents can enjoy
the breeze and the company of friends.
The idea is to create happy spaces all around.

65%
OPEN SPACES

DESIGNER LANDSCAPE

WALKING/JOGGING PATH

a divine space is
an open, green, beautiful world

DIVINE
—SPACE—



a divine space
pampers you with

joys

Sometimes, a splash in our outdoor swimming pool is the best way to wash away the stress of everyday life. Head to the pool with the children and have the time of your lives. It can be equally entertaining from the deck side seating, so grab lemonade and watch the action.

DIVINE
—SPACE—

a divine space is 40,000 sft
Clubhouse

DIVINE
— SPACE —
CLUB DIVINE



MINI THEATER



a divine space is
luxuries filled
lifestyle at your
doorstep

INDOOR GAMES

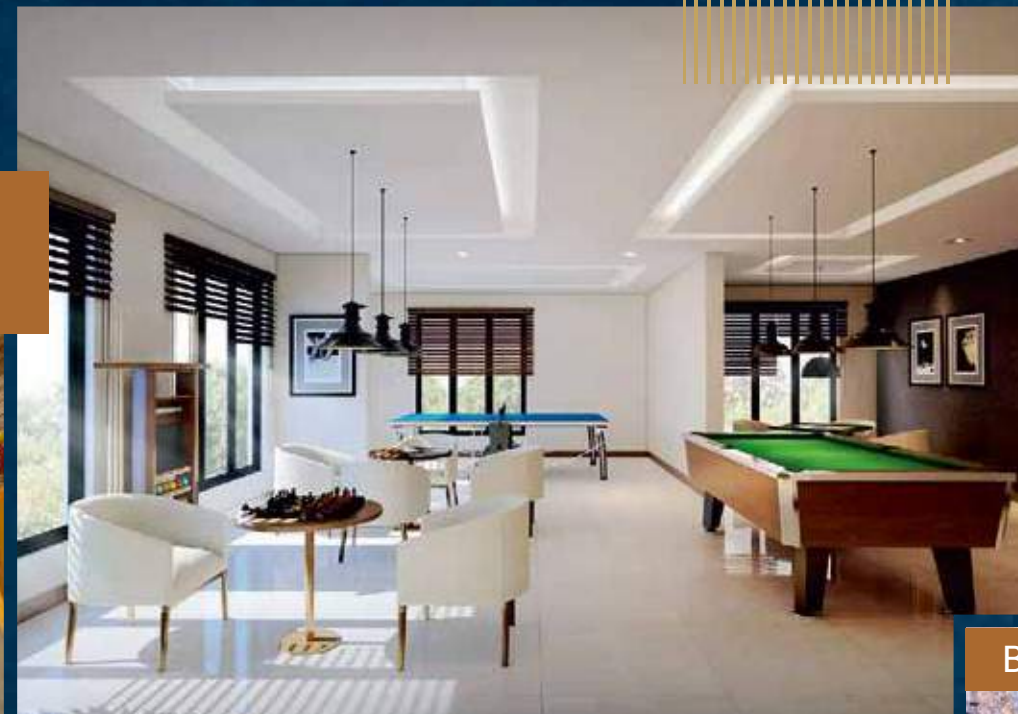

INDOOR BADMINTON COURT



CRECHE

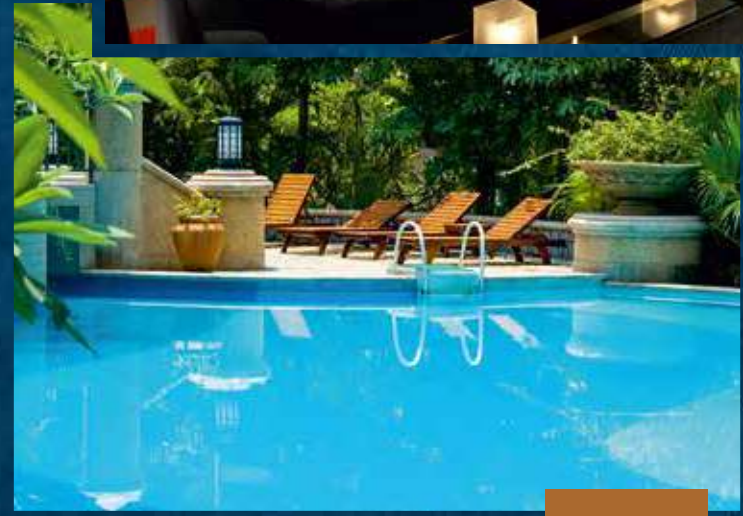

FAMILY SWIMMING POOL
WITH SEATING DECK

GUEST ROOMS



COFFEE SHOP



BANQUET HALL



WELCOME LOUNGE



INDOOR GYM

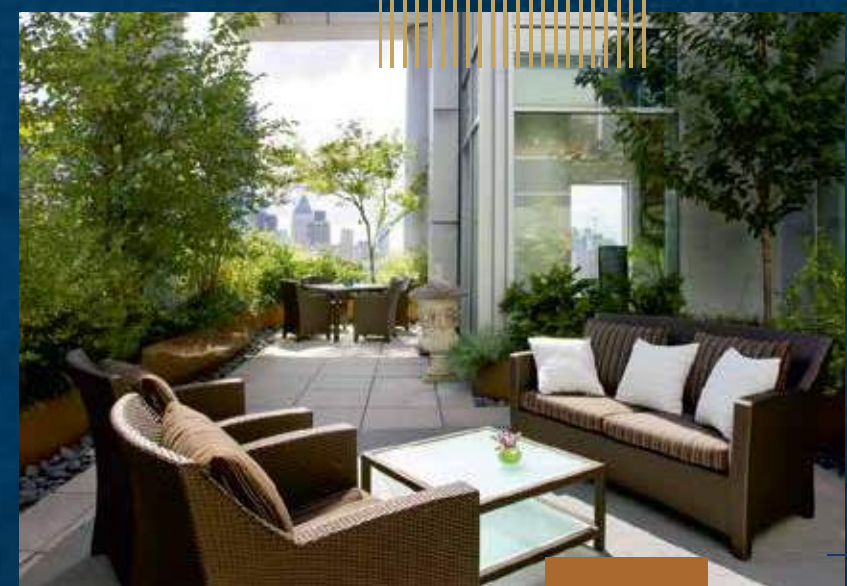

OUT DOOR SEATING



SQUASH COURT



YOGA/MEDITATION



a divine space is
a space to activate
your energies

**DIVINE**
— SPACE —



BASKET
BALL COURT



KIDS PLAY AREA



TENNIS COURT



OUTDOOR GYM



electric charging
Electric car charging point, for a fuel-efficient tomorrow



pet park
A Well equipped dedicated pet park for free space to pets



energy efficiency
Designed to reduce energy consumption



water-efficiency
The plumbing system is designed to reduce water consumption



ventilation
Designed to maximise natural ventilation

a divine space is
a safe and secured
kidsworld



a divine space is
living open & healthy



DIVINE
— SPACE —

a divine space is
designed by nature

Our architects and designers are inspired by the elegance of nature, and have turned Divine Space into a gorgeous blend of modern architecture and bountiful greenery. The towers are defined by sleek lines, and surrounded by open space and the skies above. It's the perfect setting for a divine life.



a divine space is
future ready homes

master plan

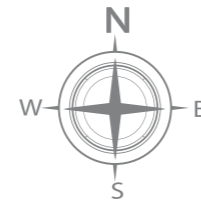

legend

- ① Entrance/Exit
- ② Service Entry
- ③ Entrance Flooring Plaza
- ④ OAT
- ⑤ Pet Park
- ⑥ Halfbasketball Court
- ⑦ Cricket Pitch (Practice)
- ⑧ Tennis Play Court
- ⑨ Children's Play Area
- ⑩ Open Fitness
- ⑪ Senior Citizen Area Under Pergola
- ⑫ Pergola
- ⑬ Party Lawn
- ⑭ Water Features
- ⑮ Jogging Track
- ⑯ Driveway



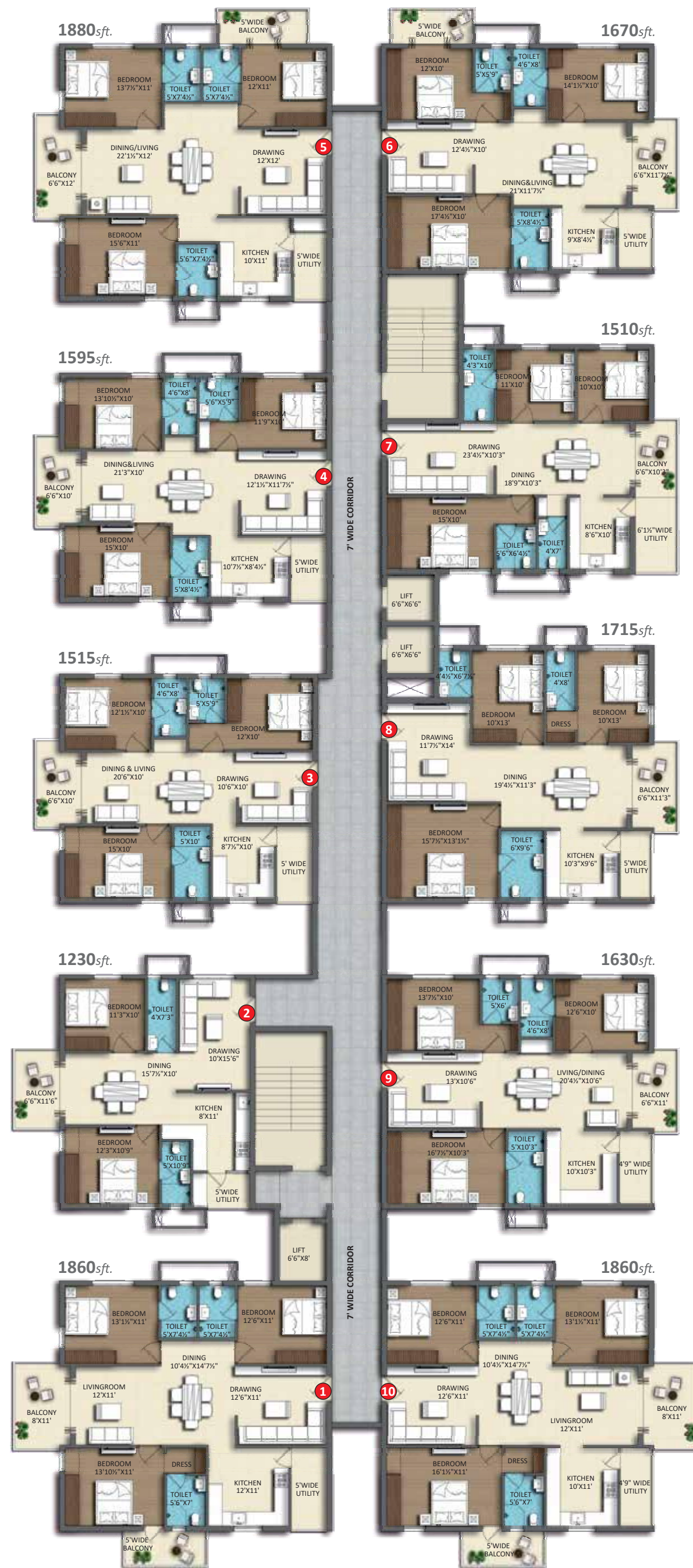

DIVINE
SPACE

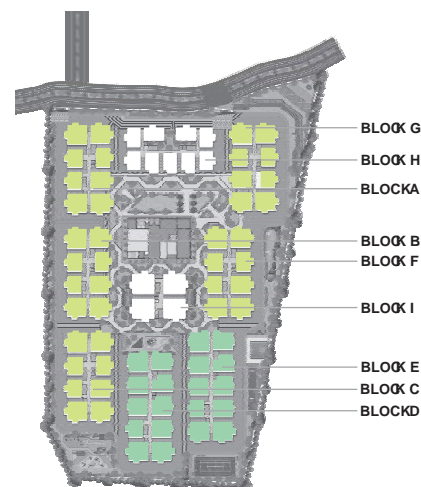
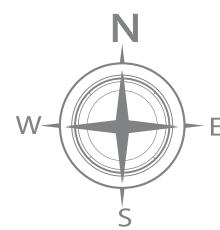

TYPICAL FLOOR PLAN
AIBICIF&G BLOCKS

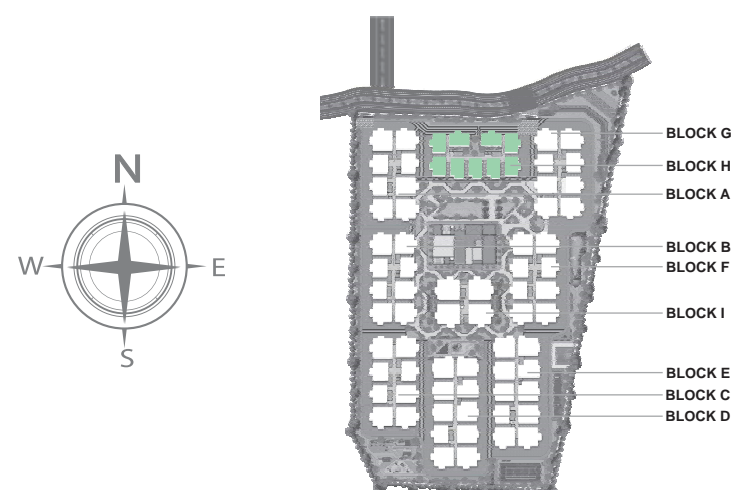

TYPICAL FLOOR PLAN
D&E BLOCKS



TYPICAL FLOOR PLAN
H BLOCK

specifications



TYPICAL FLOOR PLAN
I BLOCK

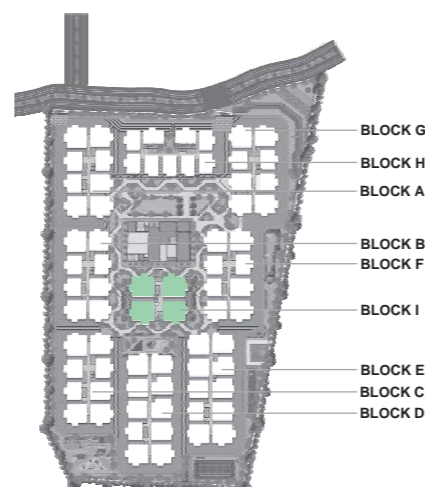

FOUNDATION : RCC Structure to withstand wind & Seismic loads.

SUPER STRUCTURE : 9" thick cement solid brick blocks for external walls & 4½" thick concrete blocks for internal walls.

PLASTERING : External and Internal walls double coat cement plaster with smooth finish.

DOORS
Main Door : 7'6" high with Engineered wood / Teak wood frame & teak veneered shutter, aesthetically designed and finished with melamine polish and fixed with hardware of reputed brand.
Internal Doors : 7'6" high with Engineered wood / Teak wood frame & flush shutters, aesthetically designed and fixed with hardware of reputed brand.
French Doors : 7'6" high, elegant uPVC/High-end door frames with glass paneled sliding shutters and with extra track provision for mosquito mesh.

Windows : uPVC/High-end window system with glass and with mosquito mesh. Aesthetically designed, Mild steel (MS) grills.

PAINTING/CLADDING
External : Textured finish and two coats of exterior emulsion paint, over a coat of primer of reputed brand.
Internal : Smooth finish with two coats of putty, two coats of acrylic emulsion paint, over a coat of primer of reputed brand.

FLOORING
Living, Drawing & Dining : 800x800mm size double charged vitrified tiles of Kajaria/Rak or equivalent..
Bedroom : Kajaria/Rak or equivalent wooden color flooring tiles.
Kitchen : Cladding upto 2' height above the platform with wall tiles of reputed make.
Utility : 2'X2' rustic - finish premium vitrified tiles of reputed make.
Balcony & Sit-out area : 2'X2' rustic-finish premium vitrified tiles of reputed make.
Bathrooms : Acid resistant, anti-skid ceramic tiles of reputed make.
Corridors : Pre-polished granite flooring.
Staircase : Granite/Natural Stone.

TILE CLADDING
Bathrooms : Up to 7' door height with premium digital printed ceramic tiles Kajaria/Rak or equivalent brand
Utilities area : Up to 3' height with ceramic tiles of reputed make.

KITCHEN
 • Individual Tap for cooking, washing and other purpose.
 • Separate Municipal Water tap for drinking water.
 • Provision for Dish washer & washing Machine in the Utility area.
 • Piped Gas with prepaid meters.

BATHROOMS :
 • Washbasin of premium brands like Roca/Kohler/Toto Queo or equivalent brand.
 • Wall hung EWC of Kohler/Roca/Duravit/Toto.
 • Concealed flush tank or flush realer. Single lever diverter of Kohler/Jaquar/Queo/Toto or equivalent make for mixing of hot and cold water.
 • Provision for geysers in all bathrooms.
 • All CP fittings are chrome plated of
 • Kohler/Jaquar/Queo/Toto or equivalent make.

ELECTRICAL :
 • Concealed copper wiring of Havells/Finolex/Rr Kabel/Polycab or equivalent make.
 • Power outlets for geysers in all bathrooms. Power plug cooking range, chimney, refrigerator, microwave ovens, mixer/grinders in kitchen, washing machine & dish washer in utility area.

- Plug points for TV with data cable in all bedrooms and living room.
- 3-Phase power supply for each unit with prepaid meters.
- Miniature Circuit Breakers (MCB) for each distribution boards of Legrand/Havells/Schneider or equivalent make.
- Elegant designer modular electrical switches of Legrand/Havells/Schneider or equivalent make.
- Led lightings for all common areas including indoors and outdoors.

CABLE TV :
 Provision for cable connection in master bedroom & living room in each apartment.

INTERNET : Internet wiring provision in dining and master bedroom.

WTP & STP
 • Domestic use water is made available through an exclusive water softening plant (Not RO plant)
 • Municipal Water and bore-well Water will be supplied to the kitchen by separate lines. A sewage treatment plant of requisite capacity will be installed as per norms including the project premises and the treated water will be used for the landscaping & flushing purposes.

POWER BACKUP
 • 1KVA power backup for each flat.
 • Facility for lights and common areas
 • Generator of AMF, Kirloskar Cummins or equivalent make provided.

SECURITY / BMS :
 • Sophisticated round-the-clock security / surveillance systems.
 • Solar power fencing all-round the compound wall and security screening of visitors.
 • Surveillance corners at the main security and entrance of each block to monitor.
 • Reticulated gas supply to every units kitchen connected to the control manifold.

CENTRALIZED WATER SUPPLY
 • A centralized underground sump will be provided for the entire community.
 • Water supply to every unit by hydro-pneumatic pressurized system.

MAIN LANDSCAPING WORKS
 Beautiful and utility designed landscaping with footpath, designed activity areas, sitting areas, lighting, children's play area etc., provided for the community.

LIFTS
 8 passengers lift shall be provided of KONE/JOHNSONS/OTIS or equivalent make (SS cabin and automatic doors).

PARKING MANAGEMENT
 Entire parking is well designed to accommodate all the unit's cards. separate entrance, exit, parking signage, driveways, equipment etc., are installed to ease parking and departures.

FIRE SAFETY
 Fire hydrant and fire sprinkler system in all floors and basements as per government norms being provided. Fire alarms and Public address system in all floors and parking areas (basements) will be installed with control panels at the Main security rooms.

Note: Attaching external safety grills will not be allowed on the balconies of any floor.

a divine space is central to life

Located around Kollur and amazingly close to the ORR and financial district, Divine Space is well connected to the IT hub and new NEOPOLIS SEZ. As well as other important parts of the city. With academic institutions, workspaces and world-class medical hubs at a stone's throw, this is an area set to escalate in value by leaps and bounds.

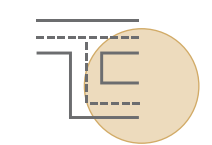
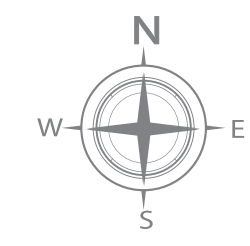

CONNECTIVITY

- ORR Access - 10 Mins
- Nagulapalli MMTS Station - 8 Mins
- Velimela - 10Mins
- Tellapur - 14Mins
- Kokapet - 20 Mins
- Financial District - 20Mins
- Muthangi Junction - 20Mins
- Kondapur - 30Mins
- Hitech City - 32 Mins
- RGI Airport - 40 Mins



IT PARKS

- Franklin Templeton
- Capgemini
- CA Technologies
- Wipro Campus
- Microsoft Campus
- Infosys Campus
- TCS, Wave Rock
- Amazon
- Honeywell
- Google



HEALTH AND HOSPITALS

- Citizen Hospital
- Continental Hospital
- Care Hospital
- Sunshine Hospital
- AIG Hospital
- Apollo Hospital
- TIMS
- Aparna Hospitals
- Medicover
- Aos Hospital



RECREATION

- Sky Zone
- Lahari Resorts
- Golkonda Resorts
- Gandipet lake
- Pragati Resorts



EDUCATIONAL INSTITUTIONS

- Meru International School
- Delhi Public School -
- Oakridge Int. School
- Open Minds - A Birla School
- Manthan International School
- Samashti Int. School
- The Gaudium School
- ISB Campus
- Indus Int. School
- ICFAI Business School
- CBIT
- Vista International School