

THE  
**ANTALYAS**  
LIFE EXTRAORDINAIRE



NAVRAJ INFRA TECH PRIVATE LIMITED

614-616, 6th Floor, Tower 4, DLF Corporate Greens, Sector-74A, Gurugram (HR)-122004

Tel.: 0124-5180996 | [www.navrajindia.com](http://www.navrajindia.com)





## It's all about well-thought space in life.

We at Navraj Infratech understand the importance of well-thought space in life and have been providing our customers with quality living spaces that are designed, putting intense thought on the utility for the customers making their everyday life easy and delightful, in the cosmopolitan city of the National Capital Region, Gurugram.

We consider the entire length and breadth of the city as a canvas which can be painted with many ideas when it comes to creating bigger residential and commercial spaces at competitive costs.

With robust experience in land-aggregation and construction of judiciously-designed residential projects in the secondary market of Gurugram, we have now stepped into the primary market of Gurugram with focus on life-based residential projects to begin-with. Our approach is based on our belief that our customers deserve bigger ideas and bigger spaces that they can call home.



THE  
**ANTALYAS**  
LIFE EXTRAORDINAIRE

True to the meaning of our name - **BREAK OF THE DAY** - we offer respite, rejuvenation and relaxation from the mundanity of everyday life by offering exceptionally well-crafted spaces that become your own personal majestic abode. By filtering the first dew drops of the morning on your terrace, to composing bird song at your window, to bringing to life nature's paradise - we offer a lifestyle that is well crafted with a vision and evokes a sense of belongingness in you and then in your corresponding surroundings.

# Etched in Gold, The blueprint of luxury

Artistic Impression.



# The Confluence of Modern Design & Timeless Architecture

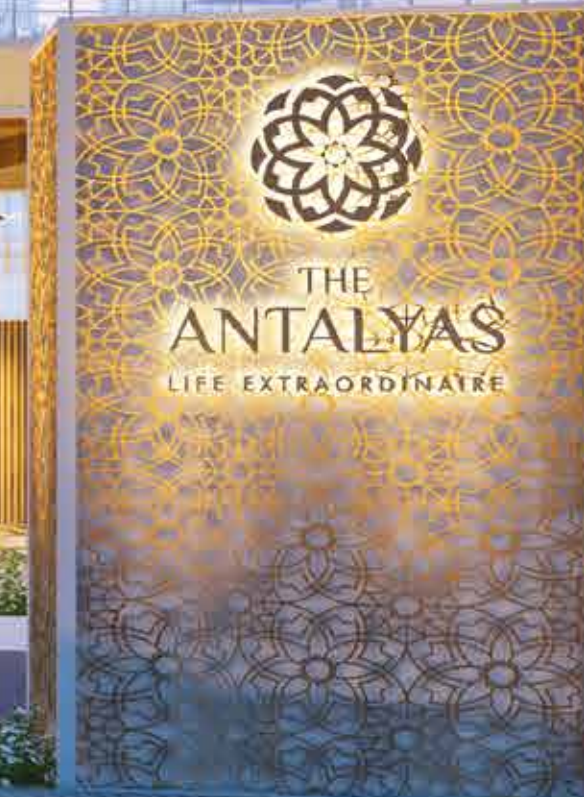
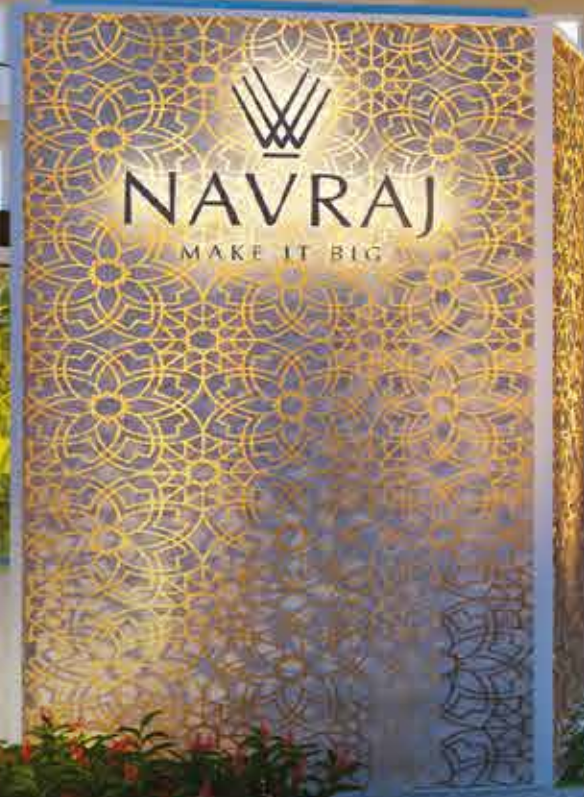

Artistic Impression.



# Synchronized Planning, Outstanding Designs



Artistic Impression.



## Location Map - The Antalyas

LEGEND	DISTANCE (Approx)
NH 48	4.5 Kms
IGI Airport	21 Kms
Cybercity	17 Kms
Dwarka	15 Kms
IFFCO Chowk	15 Kms
NPR (Dwarka Expressway)	0.5 Kms
MG Road	15 Kms
Hero Honda Chowk	6 Kms
Rajiv Chowk	9 Kms

Artistic Impression.





## Site landscape layout: The Antalyas, Sector 37D, Gurugram.



### LEGEND

- |                              |                             |                           |                       |                       |
|------------------------------|-----------------------------|---------------------------|-----------------------|-----------------------|
| 1. ENTRANCE GATEWAY          | 7. STAGE                    | 13. SKATE PARK            | 19. YOGA/MEDITATION   | 25. OUTDOOR PLAY LAWN |
| 2. ENTRANCE WATER FEATURE    | 8. ELEVATED DECK            | 14. CRICKET PITCH         | 20. ELDERLY GARDEN    | 26. BUFFER PLANTING   |
| 3. WALKWAY CUM JOGGING TRACK | 9. BOUNDARY PLANTATION      | 15. BADMINTON COURT       | 21. SEATING PLAZA     | 27. LOBBY DROPOFF     |
| 4. DRIVEWAY                  | 10. PALM GROVE              | 16. HALF BASKETBALL COURT | 22. EVENT LAWN        | 28. RAISED PLANTER    |
| 5. DRIVEOVER LANDSCAPE       | 11. AMPHITHEATER WITH STAGE | 17. PET PARK              | 23. FITNESS STATION   | 29. CLUB              |
| 6. PARTY LAWN                | 12. KIDS PLAY AREA          | 18. SEATING AREA          | 24. TODDLER PLAY AREA |                       |

**CLUB AMENITIES:** Squash Court, Gaming Zone, Reception, Commercial, Restaurant, Banquet Hall, Gymnasium, Bar & Swimming Pool



Artistic Impression.

# FLOOR PLAN

## 3 BHK + Utility

Balcony Area:  
350 Sq.Ft.

Carpet Area:  
1421 Sq.Ft.

Super Area:  
2250 Sq.Ft.

\*All sizes in approx.



Artistic Impression.

## 3 BHK

Balcony Area:  
313 Sq.Ft.

Carpet Area:  
1276 Sq.Ft.

Super Area:  
2071 Sq.Ft.

# FLOOR PLAN

## 4 BHK + Utility

Balcony Area:  
461 Sq.Ft.

Carpet Area:  
1600 Sq.Ft.

Super Area:  
2553 Sq.Ft.

\*All sizes in approx.



Artistic Impression.

## 4 BHK

Balcony Area:  
445 Sq.Ft.

Carpet Area:  
1397 Sq.Ft.

Super Area:  
2390 Sq.Ft.

## The Aureate Lobby



Artistic Impression.

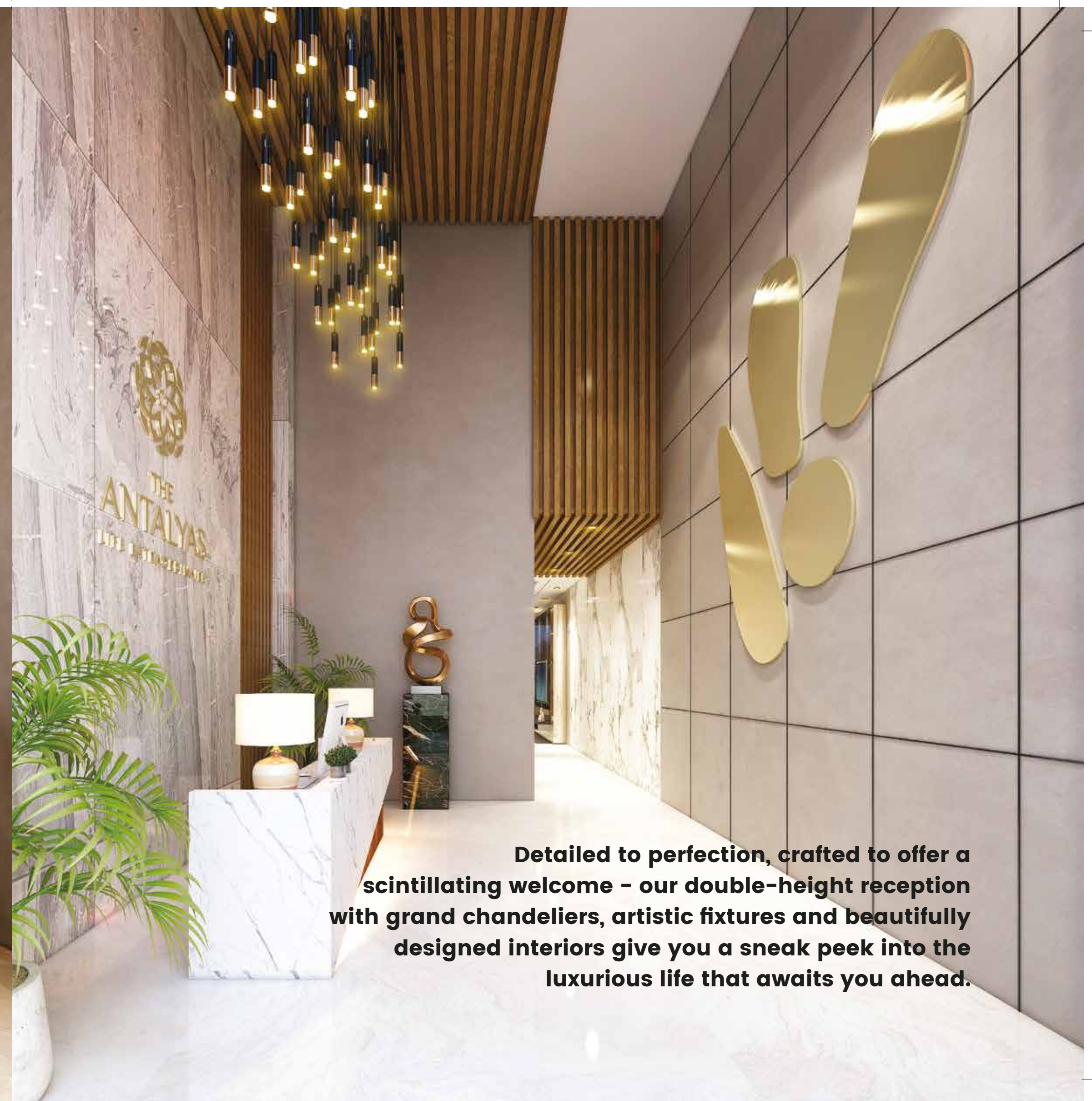

**Detailed to perfection, crafted to offer a scintillating welcome - our double-height reception with grand chandeliers, artistic fixtures and beautifully designed interiors give you a sneak peek into the luxurious life that awaits you ahead.**

# Upscale Reception Lounge

Artistic Impression.

**Connections & interactions at our luxurious lounge where beautiful moments & heartfelt memories are made.**



## Lavish Living Room

The plush interiors and the posh outdoor views of the living room make it an ideal space where everyday life becomes special because of its vivid decor, and tastefully done setup.

Artistic Impression.

## The Dinette

Artistic Impression.

**A dining space that is spacious and comfortable - laced with the comforting aromas of homeliness and offers a rejoicing food experience with friends and family.**





## The Grand Chamber

Functionally spacious bedrooms that welcome the morning sun rays through unobstructed windows and offer a luxurious and restorative resting experience for the mind & body with meticulously chosen interiors and colour palettes.

Artistic Impression.

# The Cooking Gallery

Artistic Impression.

**Sleek, modern & minimalist - our perfectly designed kitchen is made keeping in mind its extreme utility, it has a layout that brings it in focus while providing ample storage space. It is sure to become the energetic hub of your household.**

## Luxe Dressing Chamber

Artistic Impression.

Enjoy privacy, comfort & luxury in your very own dressing room that is stylishly made to offer you a space that lets you get ready more glamorously.

# The Elite Study

Artistic Impression.

Take your productivity level to a new high with our well-designed study room that can be used as an office as well. By offering ultimate comfort, a quaint atmosphere and a well-lit space, it becomes a high-functional place for you to achieve your goals.

# Jogger's Trail

Artistic Impression.

Lush acres of sprawling jogging track  
running through thickets of plantation.



## Serenity Boundary

Artistic Impression.

Luxuriant & varied flora decorates the periphery of the project to offer sublimity to the eyes and rejuvenation to the mind.

# Nirvana Yoga



Artistic Impression.

Dedicated area for mindful meditation  
in a serene & green atmosphere.

# The Kids Ville

Artistic Impression.

**Sprawling recreational area for robust activities  
planned to bring different creative minds together.**



# Perennial Convenience Park

Artistic Impression.

Connections, convenience & comfort laid out for senior citizens in the form of an elderly park.

# Level Up Gymnasium



Artistic Impression.

Taking athleticism a step forward with a state-of-the-art gymnasium, equipped with the best training equipment.

## The Powerful Smash



Artistic Impression.

**A high-intensity game of squash awaits you in a state-of-the-art, squash court where you and your opponent will hold challenges and serve to win big.**

# The Long Shot

Artistic Impression.

**State-of-the-art lawn tennis court,  
offers best-in-class playing experience.**

## The Best Serve

Ready to accommodate fast smashes & a high-paced game, this best-in-class badminton court offers cushioning and comfort to the players.

Artistic Impression.

# Basketball Arena



Artistic Impression.

Made to perfection, the basketball court is an attraction that is sure to lure basketball enthusiasts towards it.

# The Perfect Innings

Artistic Impression.

A perfect pitch for  
budding cricket enthusiasts.

## An Exhilarating Ride

**A heaven for adventure enthusiasts, the skate-park will sweep you off your feet with its steep and beginner-friendly decks.**

Artistic Impression.



# The Colossal Theatre

An open-air arcadia made for entertainment,  
recreation & performances.

Artistic Impression.

# Azure De Flowers

**A beautiful open-air space customised to accommodate parties, events & functions, beautifully lined by flowers and lush green carpets of grass.**

Artistic Impression.



# The Pawwfect Park



Artistic Impression.

Off-the-leash pet ground where canines and pooches meet each other and interact with human beings while enjoying a large open area where they can play.

# The Majesty Falls

**Picturesque as a painting and majestic like royalty, stands Majesty Falls - a fountain crafted to perfection that welcomes the residents at the gate.**

Artistic Impression.

# The Imperial Driveway

Artistic Impression.

A contemporary driveway that welcomes you with imperial air and valet services.



# Gastronomical Soiree

Artistic Impression.

Indulgent dishes handpicked from across the globe to decorate your platter and entice your tastebuds with scrumptious cuisines while offering you an ambrosial experience like never before.

# The Galactic Galleria

Artistic Impression.

An indoor, luxurious banquet hall for happy events & joyful times of life. Decorated intricately to accommodate your taste.

# The Dream Deck

**An ethereal swimming deck with azure blue water and a setting that offers infinite views of the beautiful skies above and the glistening city in front. Here you can take as many laps as your heart desires and swim all that you wish.**

Artistic Impression.



# The Lavish Heights

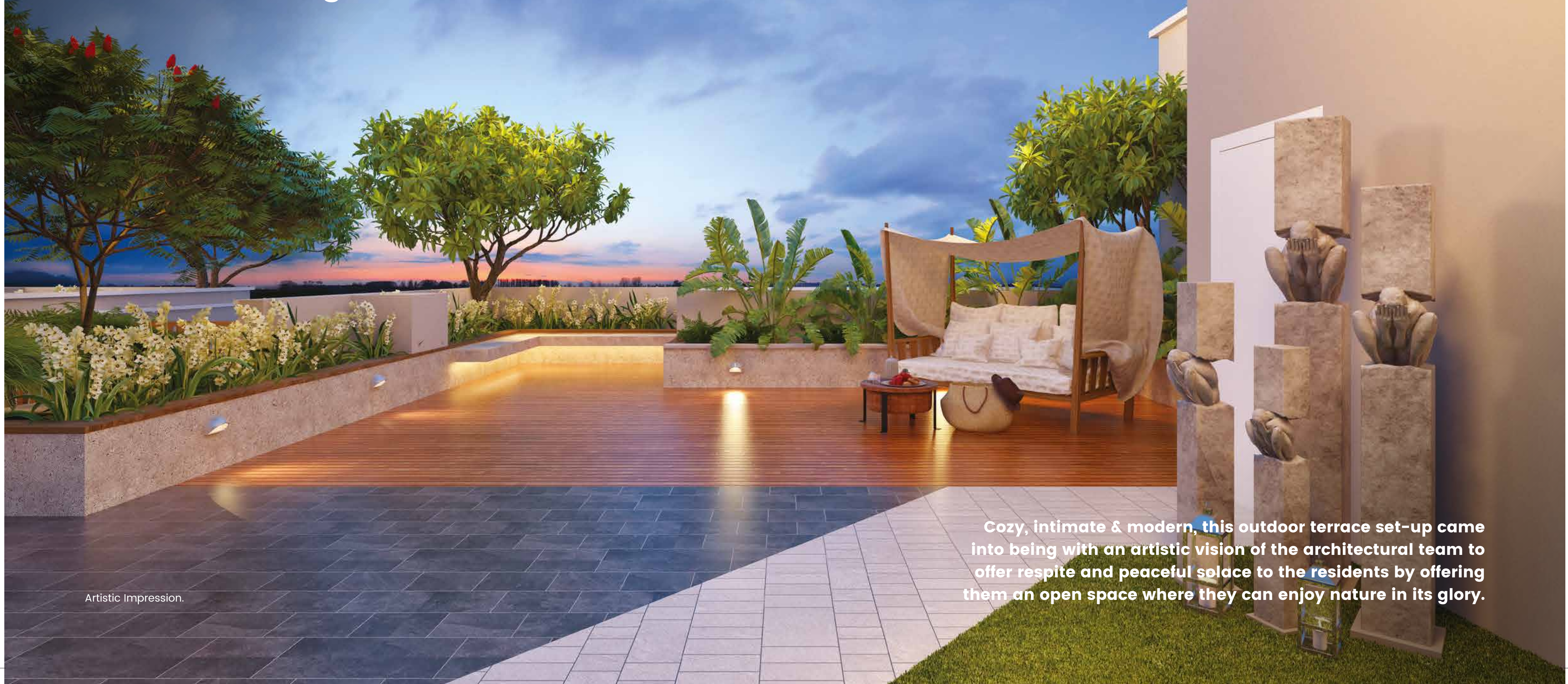

**Cozy, intimate & modern, this outdoor terrace set-up came into being with an artistic vision of the architectural team to offer respite and peaceful solace to the residents by offering them an open space where they can enjoy nature in its glory.**

Artistic Impression.

# Safe & Secure Entrance

Security-controlled, CCTV-monitored entrance points for a safe and comfortable stay.

Artistic Impression.



