



Corporate office

3rd & 4th floor, Shyam Chambers,
Hirapur Road, Mohba Bazar
Raipur (C.G.), 492001
Ph : 0771-2262421, 2262621, Fax : 0771-2263821
E-mail : singhaniabuildcon@rediffmail.com
Web : www.singhaniabuildcon.com

Architect

Sandeep Neena + Associates
Ph : 0771-4207966, 4207900, 4207999
Mob. : 93002 27999, 98271 88030

Legal Advisor

Sudhir Agrawal
B-172-73 See-5, Devendra Nagar.
Ph : 0771-4009001, Mob : 9669222296.

For more business details , call : 92292 62103, 4, 5, 9, 10, 18

Note: This brochure is only a conceptual presentation of the project and not a legal offering. The promoters reserve the right to make changes in the elevation, plans and specifications as deemed fit.

www.RAM.org (ref:104642471)



Welcome to Harshit Corporate, commercial office space at Raipur, North India's evolving business hub. This exclusive address offers you the ideal venue for your corporate enterprise, BPO or industry headquarters, as its plush ambience perfectly answers your need for cutting edge design and construction.

Harshit Corporate's location in Raipur provides a definitive advantage, as Raipur is capital of Chhattisgarh, a state that is growing in wealth and

AT THE CONFLUENCE OF DEVELOPMENT

Prominence owing to its rich reserves of minerals, ores and coal. As the saying goes, the lights never go off in Raipur as Chhattisgarh is also a power hub where electricity is a surplus commodity. Chhattisgarh has also recorded the highest industrial growth rate and is known as the Rice Bowl of India. Needless to say, Raipur has become the new commercial destination for people eager to share in its growth and development plans.

Harshit Corporate is built according to modern industry requirements, international style architecture, world class facilities and with state of the art infrastructure.



GEM OF A CONSTRUCTION
TO COMPLEMENT YOUR IMAGE



STRATEGIC LOCATION INSPIRED BY PROGRESS

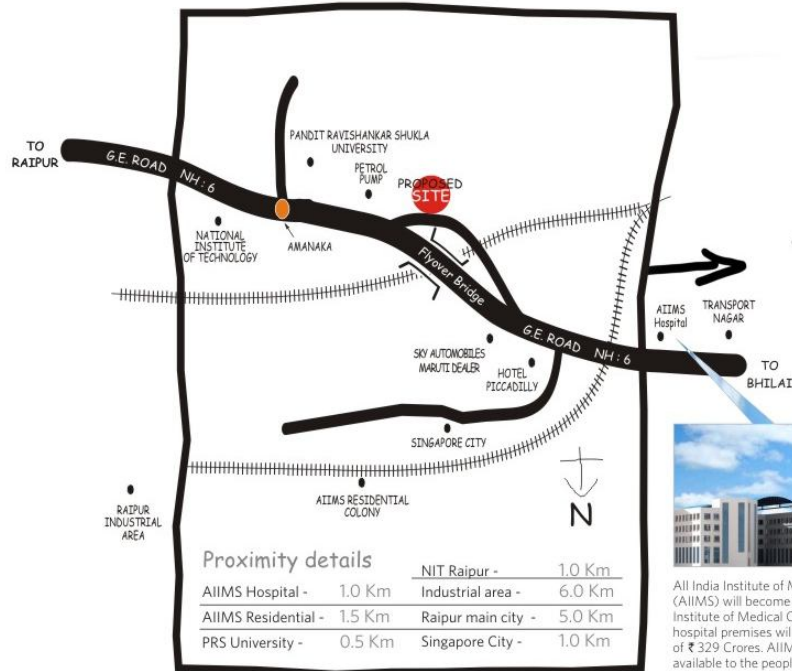

All India Institute of Medical Sciences (AIIMS) will become functional in Raipur. The Institute of Medical College, hostel and hospital premises will be developed at a cost of ₹ 329 Crores. AIIMS project will make available to the people of Raipur a 960 bedded super specialty Hospital facilities.



→ WORK → ₹



Harshit Corporate rises tall amidst a sea of commercial activity. Not just a major landmark but also a milestone in Raipur's journey into a new era of heightened development.

The venture offers a multitude of locational advantages:

Situated in a key area of G.E. Road

In close proximity to NIT Science College, Ayurvedic College and Sanskrit Mahavidyalaya

Within easy reach of Industrial Area and Transport Nagar

In the vicinity of Singapore City and AIIMS Residential Colony and AIIMS Hospital

Connected to Ring Road

Hub for financial & banking institutions



EVERY FACILITY YOU
COULD EVER NEED

Harshit
CORPORATE

Harshit Corporate gives you the benefit of superior construction and exceptional features, incorporating a high level of comfort and an infrastructure that answers every day to day requirement.

- Ultra modern exterior and interiors
- Vastu based east and west facing offices
- Natural light
- Rooftop Cafeteria
- Conference Hall

At Harshit Corporate, a number of well planned advantages ensure unfettered convenience every day:

100% power back up for all common areas

Modern fire-fighting and detection system as per the latest fire norms

Basement and complete ground floor parking

Public address system and piped music areas

Optimized space management

Gated security access controlled from security gate at the entrance

Provision for wi-fi system, TV cable and telephone lines

Maximum visibility of Offices from the main road and atrium

Excellent frontage

WHERE SPACE EXTENDS TO
ENCOMPASS YOUR NEEDS

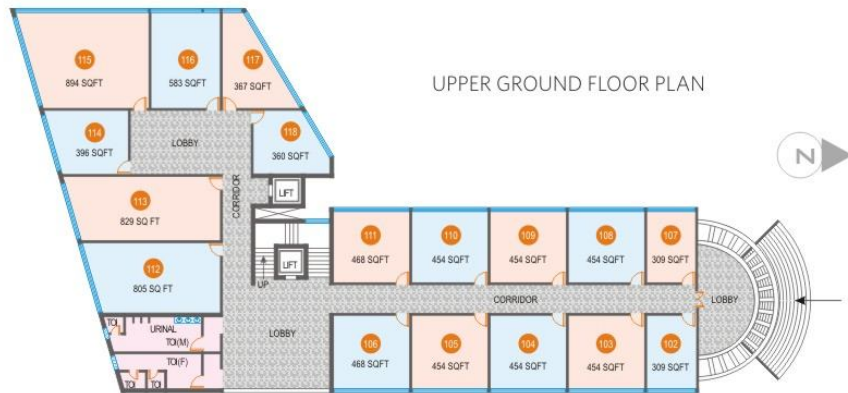

At Harshit Corporate you also have a unique 'Flexible Space Option' which gives you the freedom to choose as much space as you require for your needs. Therefore you can take a whole floor or even half a floor ranging from 300sqft to 4000sqft depending on your office requirements.



FEATURES TO ADD CONVENIENCE TO EACH DAY



A LAYOUT
THAT CATERS TO
YOUR COMFORT



Premium specifications

Exterior finish :
Façade will consist of a combination of glass, aluminum sheet and stone cladding.

Offices will have 12m thick toughened glass installed in powder coated aluminum jumbo section with the provision of swing glass door.

Interior finish :
Lobby staircase corridor will have a combination of granite, marble or any other quality stones.

Flooring inside commercial units will be of 24"x24" vitrified tiles

Staircase and corridor railing will be of stainless steel with a combination of glass.

Elevators :
Passengers lifts with ARD systems of reputed make.

Public Services :
Provision of common toilet block on each floor for men and women

Airconditioning :
Inside ducting and AHU to be installed by the purchaser at his own cost but at the specified places.

Electricity and power backup :
Three phase connection with isolator will be provided in each commercial unit. Further internal wiring and installation of electrical fitting will be done by the purchaser at his own cost

At Harshit Corporate, visitors have the convenience of extensive and exclusive parking space to add to the experience. Just our way of saying we care for your comfort at every level.



Providing a new dimension to Raipur

Founded on the vision of the company's Chairman and Managing Director, Mr. Subodh Singhania, Singhania Buildcon is a force to be reckoned with in the field of real estate today. Over the last 18 years, the Company has not only carved a niche for itself, but emerged at the forefront of the field, achieving iconic status as a corporate entity that has paved the way for towns to expand and cities to become mega cities. In fact Singhania Buildcon has shown a more than impressive growth rate, accelerating its pace with each successive year, and aiming to more than triple its pace in the months ahead. Already on par with the best, Singhania is poised for a swift elevation to the top of the Construction segment in North India, an aspiration that the team works towards with dedicated passion and integrity.

Singhania Buildcon's success is not only due to the work ethic of the team, but also because of the versatility displayed through a wide plethora of projects that span everything from the residential to the commercial sector proving the Company's expertise and finesse when it comes to interpreting requirements into structures that will stand the test of time. Testimony to the Company's standing is the ISO 9001-2008 certification it enjoys, as it continues to maintain its track record of quality construction and transfer of titles within stipulated time schedules.



Shri Subodh Singhania
Chairman & Managing Director



Singapore City - A new international living experience

Amongst the Company's premier development projects is Singapore City, bringing an international ambience to Raipur. Singapore City caters to the City's growth and awareness of international lifestyle trends, and is a tribute to the average customer's demand for elevated living standards. Singapore City is the first of its kind in Raipur offering a full fledged Club with facilities like a gym, spa, swimming pool, convenience store, outdoor and indoor games and more. Singapore City's Club Marina is the largest such Club House in Central India with an elaborate lobby and Banquet Hall, temperature controlled rooftop swimming pool, children's paddling pool, Sauna, Projection Room, Guest Rooms, etc.



Achieving iconic status in just a few years

Whether it is a residential building or a commercial complex, Singhania Buildcon's expertise is apparent in every detail. Over the past 18 years since its inception the company has consistently harnessed current technology so as to meet its aspirations for world class excellence. The company's signature style and stamp of class is accompanied by a passion to reach unprecedented heights - accelerating its growth rate to crown current achievements with future breakthroughs.