



**RERA REGISTRATION NO. : PR/GJ/VALSAD/UMERGAON/OTHERS/MAA07554/191020**

**REMARKS**

Developers reserve all rights to make any changes in the specifications, plans, features or any specified details mentioned in the brochure without any prior notice and such changes would be binding to all the perspective purchasers. ✨ This brochure is just an easy presentation of the project and should not be treated as a legal document and / or consumer contract. ✨ Any changes in rules & regulation shall be binding to all purchasers. ✨ No external changes are allowed except internal changes if permissible would be carried out and charge extra in advance. ✨ Legal documentation charges, stamp duty for registration, Water / Drainage expenses, G.E.B. installation and Electric meter charges, SMC taxes or any kind of Govt. taxes, Service tax, VAT/ GST (if applicable) Maintenance deposits shall be born and paid by the perspective members. ✨ Possession of the units shall be delivered only after full payment. ✨ Any additional charges or duties enforced during or after the completion shall have to be born and paid by purchaser.



**DEVELOPERS**  
**SHREEJI DEVELOPERS**  
 MUMBAI  
 E MAIL : shreejidevelopers7582@gmail.com

**ENGINEER & DESIGNER'S**  
**RAJ & ASSOCIATES**  
 Heena Arcade,  
 G.I.D.C. Char Rasta,  
 Vapi.

**LEGAL ADVISER**  
**VINAY B. SAGAR**  
 G.I.D.C. 3 Rasta,  
 Umer Gaon,  
 Dist - Valsad.

**BOOKING CONTACT**  
 + 91 98204 78982  
 + 91 77385 68777  
 + 91 93759 66579

**SITE ADDRESS**  
 New S.r.no 1171, Opp  
 Sundarvan, Near Akra Maruti  
 Lake, Station Road,  
 Umergaon,  
 Dist, Valsad Gujrat

# Cad Tech +91 98257 66930





# Layout Plan

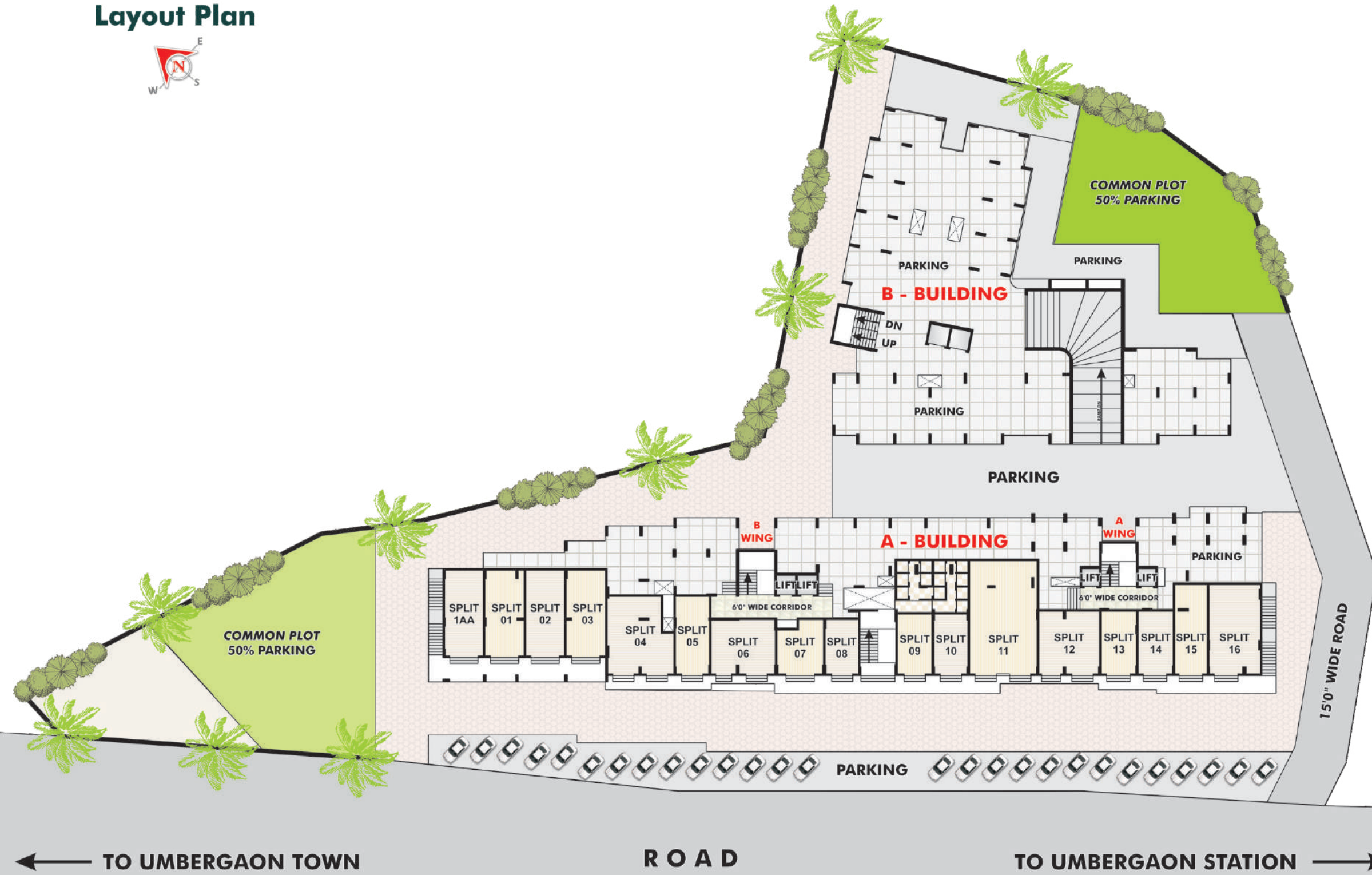



**A - BUILDING**  
(2nd. TO 7th FLOOR)



**AMENITIES**



**FLOORING**  
Good Quality 24" X 24" Vitrified Tiles Flooring.



**DOOR**  
Decorative Main Entrance Door With Wooden Frame And All Other Internal Flush Doors. P.V.C. Laminated Toilet Doors.



**ELECTRIFICATION**  
Concealed Copper Wiring Of I.S.I Make With Sufficient Light Point. TV & Telephone Point In Living Room. Electrical Switches Of ISI Make.



**WATER SUPPLY**  
24 Hour Water Supply Through & Overhead Water Tank & Bore Well.



**LIFT**  
Automatic 2 Lift Of Standard Quality In Each Building.



**KITCHEN**  
Granite Top Platform With S.S Sink. Decorative Glazed Tiles Dado Up To Lintel Level.



**WINDOW**  
Powder Coted Windows With Granite Sill.



**COLOUR**  
Internal Wall Mala Plaster With Putti Finish. External Weather Proof Paint Of Apex Or ITL Equivalent.



**TOILETS**  
Decorative Glazed Tiles Dado Up To Lintel Level. Anti Skid Tiles In Flooring. Concealed CPVC Pipe Fitting Of I.S.I. Make. Good Quality Bath Fitting & Sanitary Ware.



## B - BUILDING ( TYPICAL FLOOR PLAN )



### CAMPUS FEATURES

- 🌀 Earthquake R.C.C. Frame Structure With Brick / Block Masonry Wall.
- 🌀 Exclusive Elevation Of Building Designed To Give Modern Look.
- 🌀 Well Planned Flats With Proper Ventilation And Lighting.
- 🌀 Entrance Lobby.
- 🌀 Campus Surrounded With Well Designed Compound Wall And Elegant Main Gate.
- 🌀 Security Cabin With Round The Clock Security.
- 🌀 CCTV Camera & Live Display In Lobby.
- 🌀 Facility Of Intercom Connection For Each Flat.
- 🌀 Good Quality Paver Block In Open Areas.
- 🌀 Garden With Children Play Area And Temple In C.O.P.
- 🌀 Ample Parking Facility.
- 🌀 Fire Safety.
- 🌀 D.G. Backup For Lift & Common Lighting.
- 🌀 China Mosaic Tiles Flooring With Waterproofing Treatment On Terrace.

