

LOCATION MAP



REGISTERED OFFICE

26, 1st Floor, Pusa Road, Adjacent to Karol Bagh Metro Station, New Delhi - 110005 | **Tel.:** 011-30170000 (100 Lines)

CORPORATE OFFICE

A-1, C & D, Sector - 16, Near Metro Station, Noida - 201301, U.P. | **Tel.:** 0120-3990300 (200 Lines)

Site Address

Plot No. 12, Sec. 1, Noida Extension, Greater Noida, U.P.

E: info@earthinfra.com | **W:** www.earthinfra.com

IT Parks ★ Hotels ★ Residential ★ Commercial Space ★ Shopping Malls

Note: Visual representations shown in this brochure are purely conceptual. All plans, specifications, layout plans etc. are tentative and subject to variations and modifications by the company or the competent authorities and the company does not bear any legal consequences for it.



EARTH
GRACIA
Lifestyle apartments



SURPASS YOUR IMAGINATION

It's hard to beat imagination and when you beat it, you create something that sets new benchmark for others to follow. We follow same imagination in creation of **EARTH GRACIA** which will become a symbol of lifestyle statement in near future.

We have conceptualized the paradise of modern living keeping the hard core sensibility in mind that we are modern and we like the contemporary art of living.



ARCHITECTURAL RENDERING @ ITS BEST

- Lush **Green** Landscapes, **Water** Bodies and Beautiful **Boulevards**
- 70% wide** open area with **Splendid** Fountains, Walkways with Trellis & Seating
- Enhanced** cross **ventilation** to reduce the temperature and the use of AC's
- Jogging** tracks surrounded by lush **Green Trees**, Outdoor Exercise Station
- Eco-friendly**, **Vaastu** friendly and **Earthquake** Resistant Structure
- Gated** Community System & **Paver** Block Roads
- Swimming** Pools & Gazebo
- Dry** Balcony & **Lily** Ponds

Engineered Green

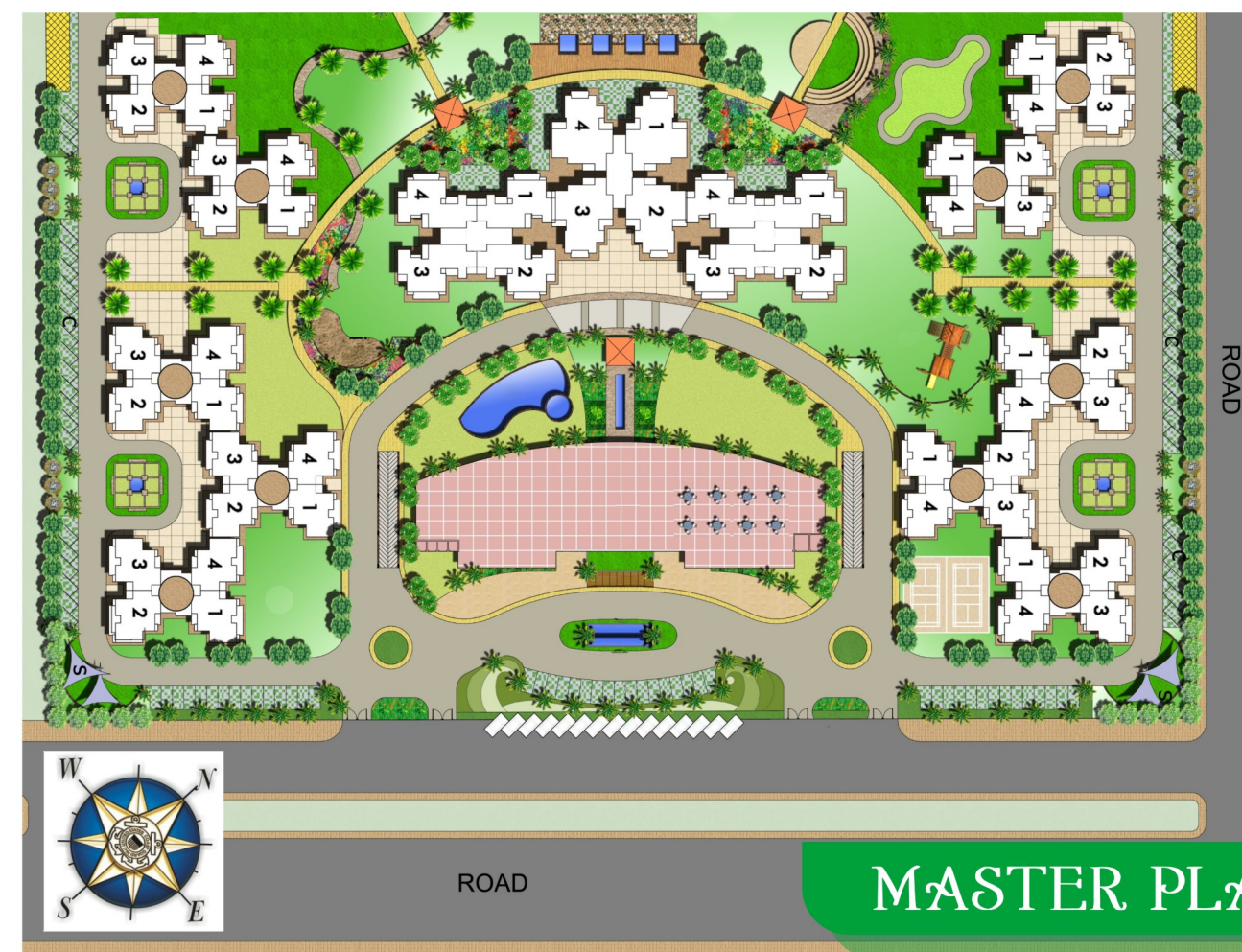

MASTER PLAN

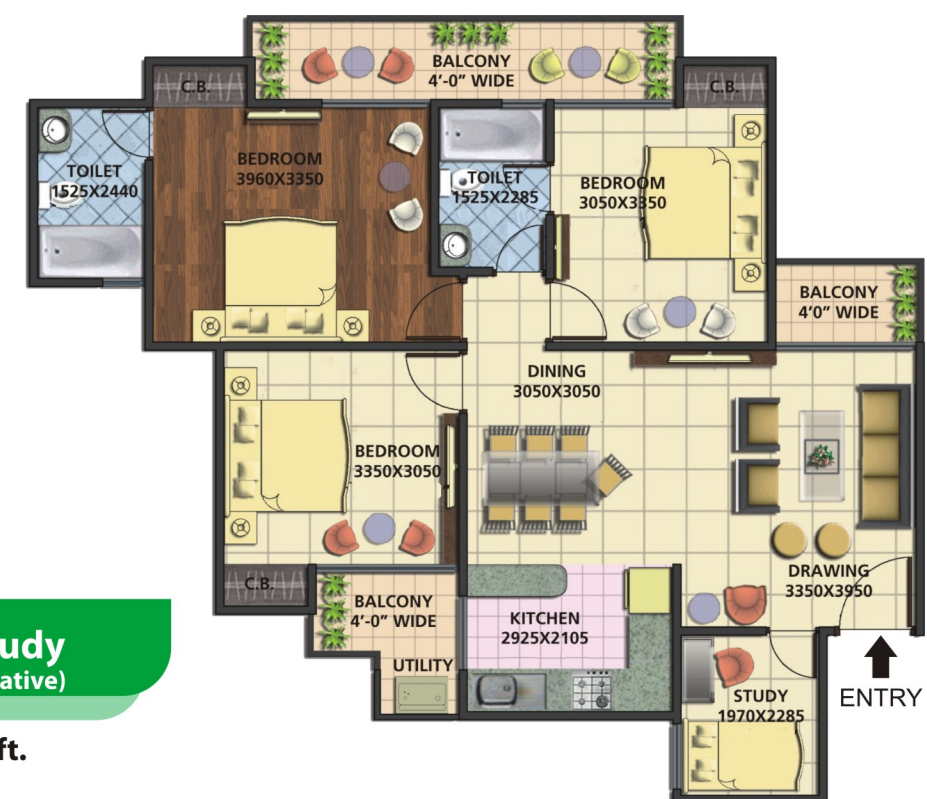

3 BHK + 2 Toilet + Study
(Tentative)

Super Area : 1525 sq. ft.

3 BHK + 2Toilet + Study | Size-1525 sq. ft.

Down Payment Plan @ ₹ 2950/- per sq. ft.

At the time of booking	10%		
Within 30 days of booking	85% + Other Charges	On offer of Possession	05%

Construction Linked Plan @ ₹ 3250/- per sq. ft.

At the time of booking	10%	6 th Installment on start of 5th floor roof casting	10% + 25% of (Other Charges + PLC)
1 st Installment within 45 days	10%	7 th Installment on start of 8th floor roof casting	5%
2 nd Installment at start of excavation	10%	8 th Installment on start of 10th floor roof casting	5%
3 rd Installment on start of basement roof casting	10% + 50% of (Other Charges + PLC)	9 th Installment on start of 13th floor roof casting	5%
4 th Installment on start of 1st floor roof casting	10%	10 th Installment on start of 16th floor roof casting	5% + 25% of (Other Charges + PLC)
5 th Installment on start of 3rd floor roof casting	10%	11 th Installment on start of 19th floor roof casting	5%
		12 th Installment at time of possession	5%
		Total	100%

Preferential Location Charges (PLC)

Floor PLC	₹ /- Per sq. ft.	Floor PLC	₹ /- Per sq. ft.
Ground Floor	150/-	6 th & 19 th Floor	90/-
1 st Floor	140/-	7 th & 18 th Floor	80/-
2 nd Floor	130/-	8 th & 17 th Floor	70/-
3 rd Floor	120/-	9 th & 16 th Floor	60/-
4 th Floor	110/-	10 th - 15 th Floor	50/-
5 th & 20 th Floor Onwards	100/-		

Location PLC	₹ /- Per sq. ft.
Park Facing	75/-
Road Facing	50/-
Corner Facing	75/-

Development Charges
₹ 150/- per sq. ft.

Lease Rent - ₹ 100/- per sq. ft.

EEC+FFC - ₹ 85/- per sq. ft.

IFMS - ₹ 40/- per sq. ft.

CAR PARKING : ₹ 2.5 LACS | CLUB MEMBERSHIP : ₹ 1.5 LACS | Back up DG power extra @ ₹ 20,000/- per KVA

All payment should be made in favour of "Earth Gracia Buildcon Pvt. Ltd." payable at New Delhi.

Note : Developer reserve the right to change the price.

S No. _____

Provisional Booking Form

I /We is /are interested in booking a

Commercial ☐ Residential ☐

Sole / First Applicant

Please fill in block letters

1. Full Name Mr. / Ms. _____

2. Father / Husband's Name / Guardian Name

Full Name Mr. / Ms. _____

3. Date of Birth _____

4. Occupation ☐ Employed ☐ Self-Employed

☐ Housewife ☐ Student

☐ Others _____

5. Profession / Name of Business _____

6. PAN No. _____

7. Permanent Address _____

8. Correspondence Address (for Sole / First Applicant) _____

9. Phone with STD Code (Home) _____

(Work) _____ Mobile _____

Fax _____ E-mail _____

Affix
Self Signed
Photograph

Joint / Second Applicant

Please fill in block letters

1. Full Name Mr. / Ms. _____

2. Relation to the First Applicant (Only for joint Applicant)

3. Father / Husband's Name / Guardian Name

Full Name Mr. / Ms. _____

4. Date of Birth _____

5. Occupation ☐ Employed ☐ Self-Employed

☐ Housewife ☐ Student

☐ Others _____

6. Profession / Name of Business _____

7. PAN No. _____

8. Permanent Address _____

9. Correspondence Address (for Sole / First Applicant) _____

10. Phone with STD Code (Home) _____

(Work) _____ Mobile _____

Fax _____ E-mail _____

Please find enclosed Cheque No. _____ of Amount _____

Dated _____ Drawn on _____ Bank as booking amount.

Name of Earth Signatory

Full Signature of
Sole/First Applicant

Full Signature of
Second Applicant

AEC : _____

Signature : _____

Date _____

Date _____

Affix
Self Signed
Photograph



CUSTOMER INFORMATION FORM

Regd. Office:

26, 1st Floor, Pusa Road, Adjacent to Karol Bagh Metro Station,
New Delhi-110 005 | Tel.: 011 - 30170000 (100 Lines)

Gurgaon Office:

1501-1503, 15th Floor, Tower-A, Signature Tower, Gurgaon,
Haryana-122 001 | Tel.: 0124 3877000 (60 Lines)

Corp. Office:

A-1, C & D, Sector 16, Near Metro Station, Noida,
Uttar Pradesh-201 301 | Tel.: 0120 - 3990300 (200 Lines)

Noida Office:

A-110, Sector - 4, Noida, Uttar Pradesh - 201 301

E-mail: info@earthinfra.com | **Web.:** www.earthinfra.com | **SMS 'EIL' TO 53030**