



# ECO STAY

20, Goses Lane, Bally





# RISE TO THE WORLD OF GOOD LIVING

Step into Eco Stay and watch the doors of a holistic lifestyle open up in front of you! Designed for the urban at heart, this project brings the best aspects of city life to you. Come and experience a home beyond compare!

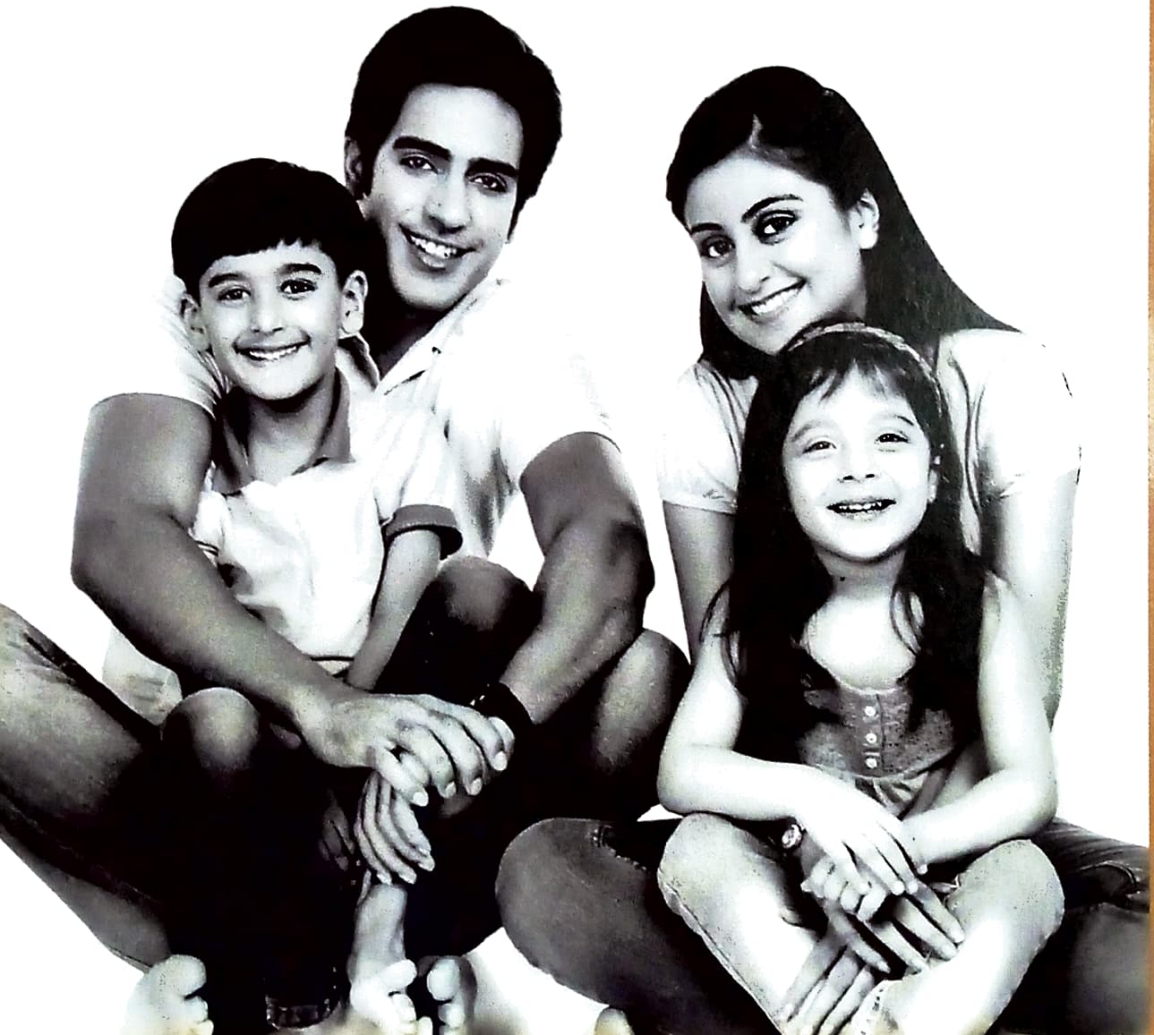



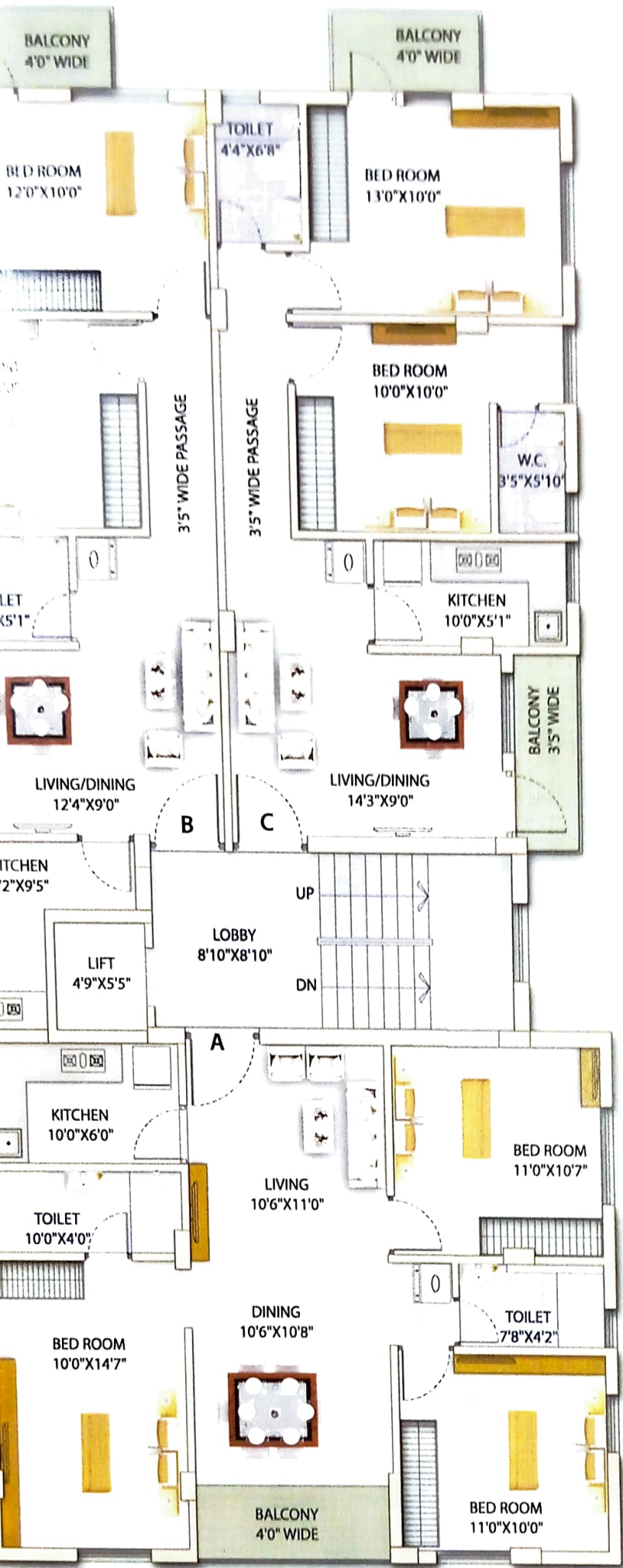



### STRUCTURE

R.C.C Framed with earthquake resisting structure with in fill brick wall.

### ELEVATORS

Provision of proper lift quality of reputed make like Thyssenkrupp/Kone/Otis /Adams or equivalent make.

### BUILDING

A block of G+4 consisting of residential apartments.

### WINDOW

Sliding aluminium glass windows with grill for providing safety & security.

### KITCHEN

Slab to be finished in granites and claddings with ceramic tiles up to two feet above counter stainless steel sink of reputed brand.

Aquaguard power points.

### BATHROOMS

All floors will have anti-skid tiles and walls with standard tiles up to 6 feet high . CP & sanitaryfittings will be of super quality of make Hindustan/Hindware/ Parryware/Cera or equivalent.

### Doors

All doors are flush doors.

### PLUMBING

Concealed high quality plumbing lines with PPR/UPVC/CPVC or equivalent pipe and related fittings

### WATER

Adequate storage of water in overhead reservoir provision for deep tube well for continuous water supply

### INTERIOR WALL FINISH

Inside wall finished with putty.

### EXTERIOR WALL FINISH

Exterior wall finished putty & exterior type emulsion paints to withstand all weather conditions

### FLOORING

All rooms will have vitrified tiles. Staircase and lobbies will be finished with Kota Stone/Marble/Tile as specified by the architect.

### BALCONIES

Balconies finished by the vitrified.

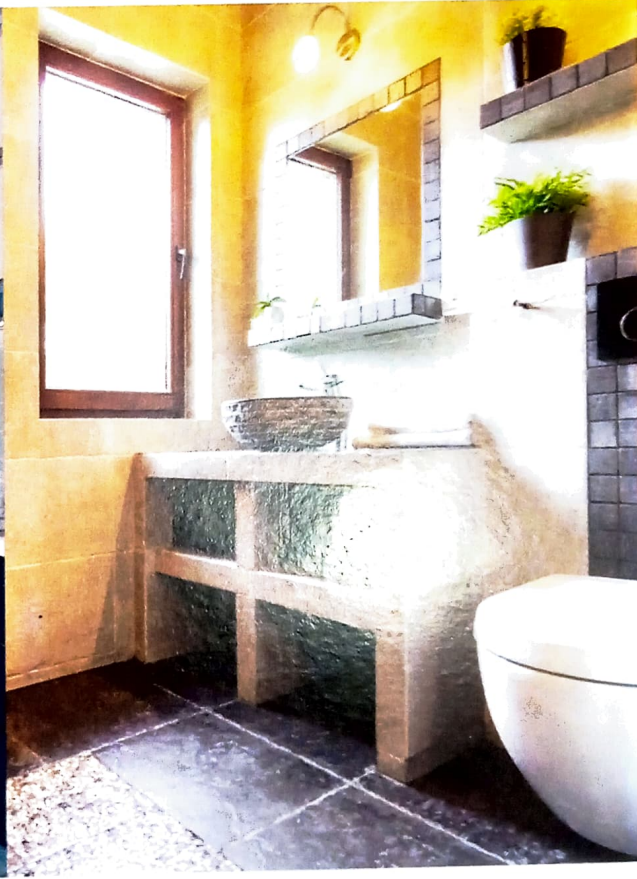

### EXTRA CHARGEABLE

Sinking fund/electricity load, security, installation of supply line Meter Security, etc / 1st year maintenance Charges / Security Deposit / Documentation Charges / Registration Charges of Flats / Legal Charges / Applicable Taxes, Fees HMC Holding Charges, etc wherever applicable will be charged extra

### ELECTRICAL FACILITIES

Concealed copper wiring of KDR / Mescab / Anchor or equivalent make with ISI marked good quality modular switches of anchor / preetam / Philips or equivalent make and accessories with safety equipments (i.e MCB) with adequate Electrical points in all areas.

# LOCATION MAP

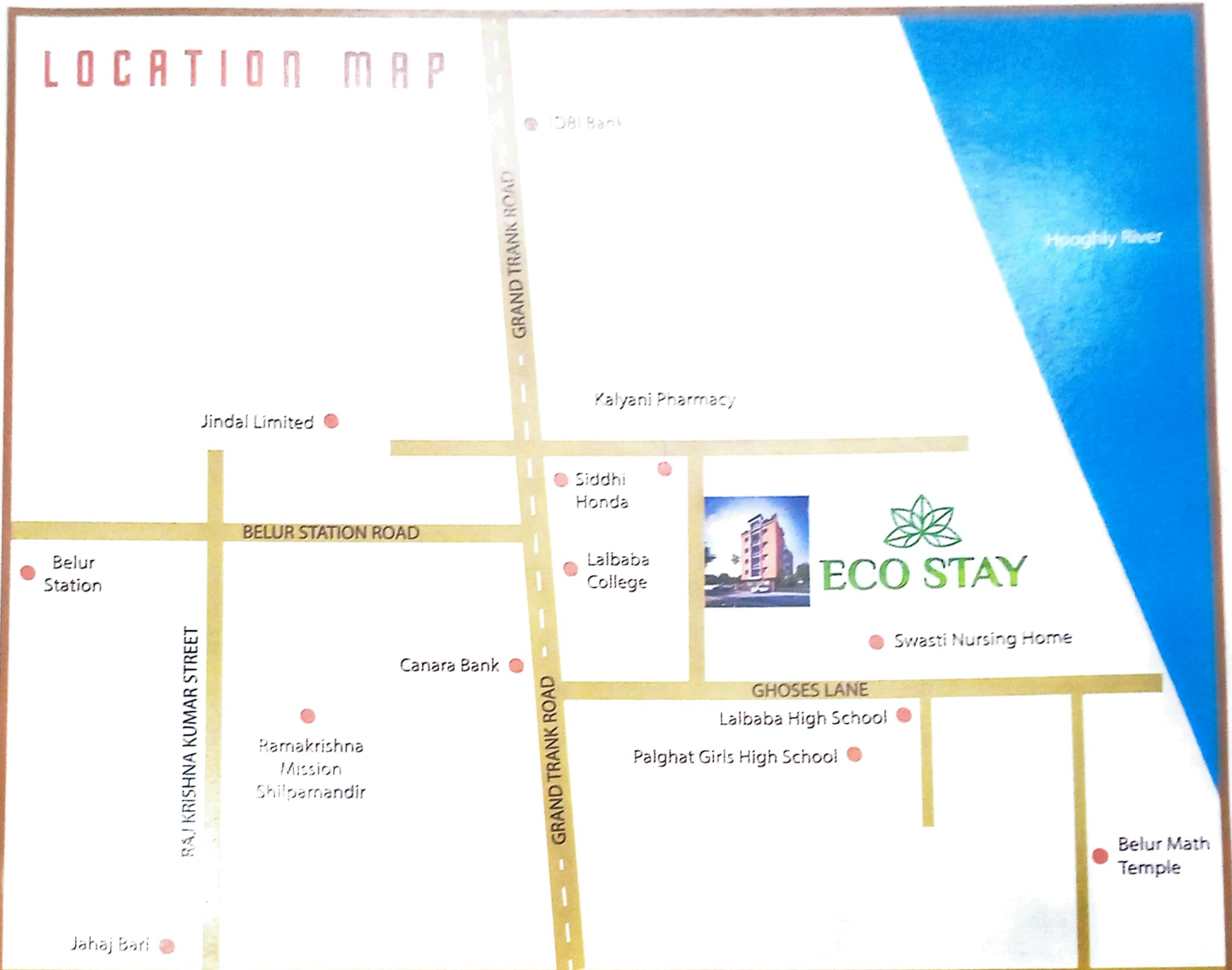

Lalbaba College - 240 M  
Swasti Nursing Home - 220 M  
Lalbaba High School - 220 M  
Palghat Girls High School - 190 M  
Canara Bank - 270 M  
River - 350 M

GT Road - 200 M  
Ramakrishna Mission Shilpamandir - 750 M  
Belur Math Temple - 850 M  
Jindal Limited - 400 M  
IDBI Bank - 500 M  
Belur Station - 1.4 Km