

ALOHA

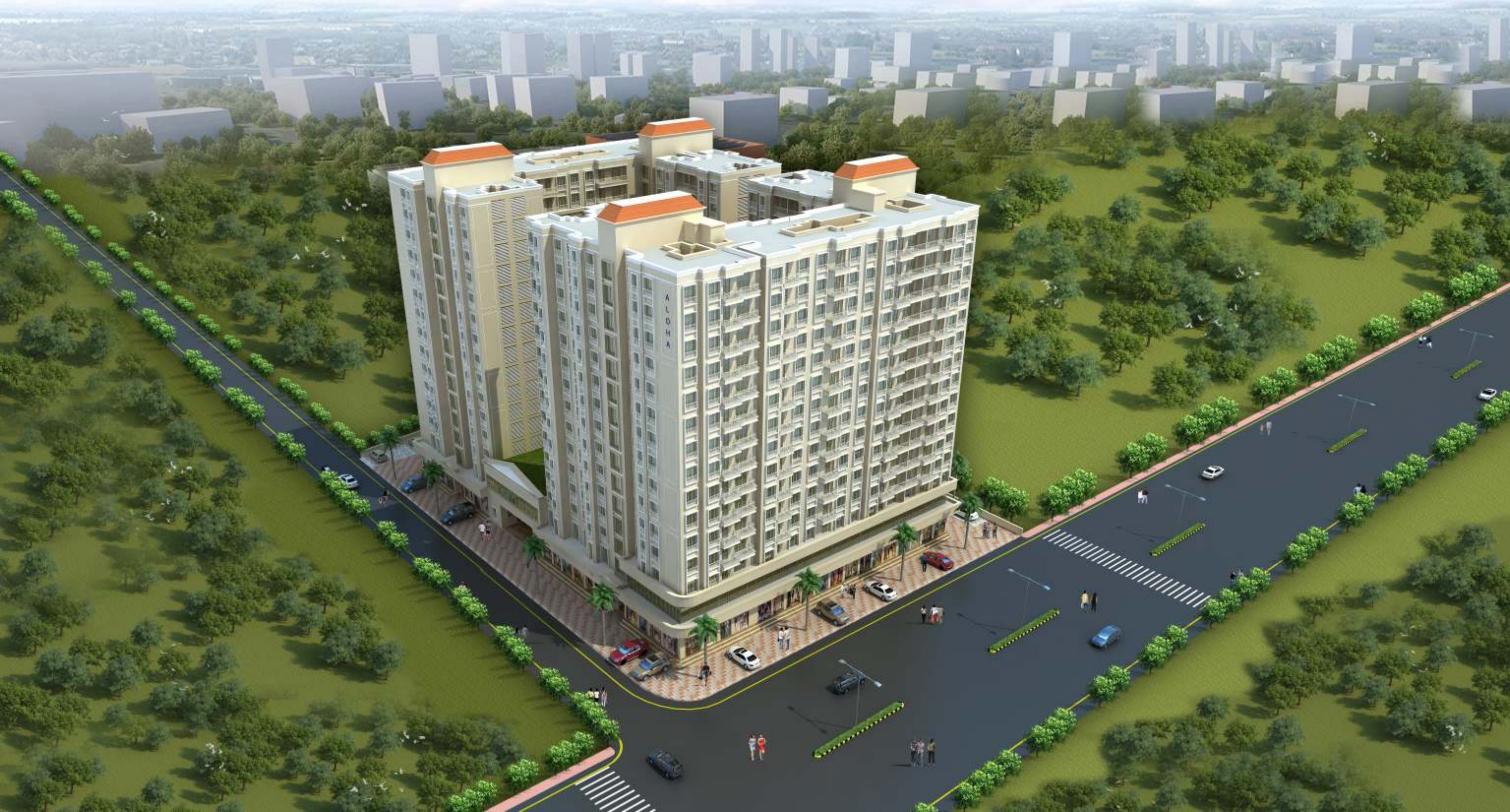

SEA
CRESTS
BUILDCON LLP



Aloha

is opulent and unique.

An ultra-modern, plush, luxurious, sophisticated apartment project that offers a break from the city just as much as it is a part of it. ALOHA offers thoughtfully designed homes that look out at uninterrupted open views of hills and lush greenery. With our long list of lifestyle amenities there is as much to do at home as there is in the city.

The serene ambience of ALOHA blended with contemporary design not only enhances your lifestyle but also lends peace and tranquillity in your life.

It is our vision to make luxury and lifestyle projects accessible for families of all income groups.

We believe in quality work, timely completion of our projects and fulfilling our commitments. We understand our customer's world and strive towards creating value for them.



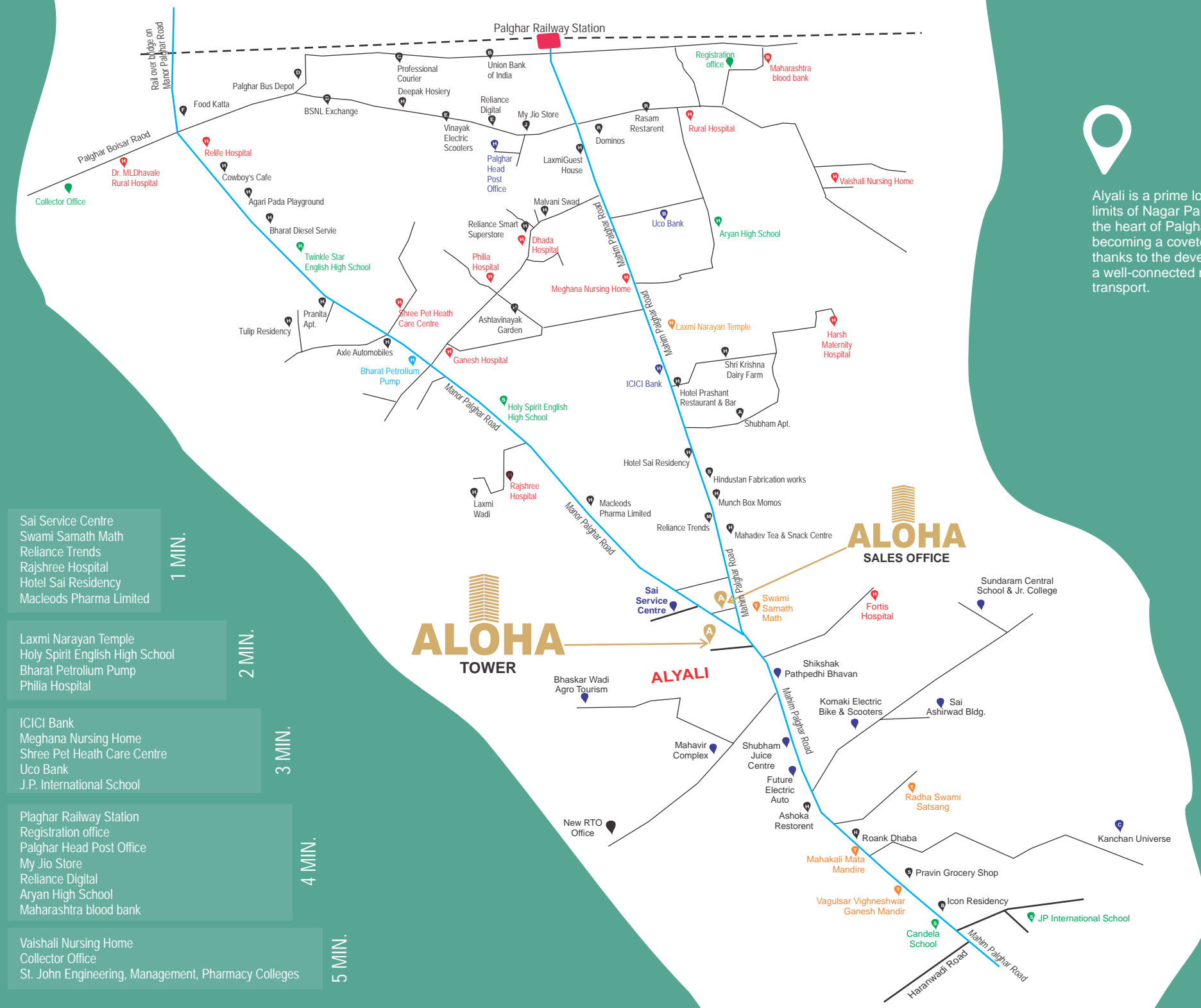

Alyali is a prime location within limits of Nagar Parishad and at the heart of Palghar. It is fast becoming a coveted address thanks to the development and a well-connected network of transport.



You are never too far



Aloha

offers homes with premium specifications & finishes, having large living areas with beautiful balconies complementing the well-designed spaces, full of natural light and cross ventilation.





Take a plunge

Rejuvenate in the atmosphere of luxury and purity by being close to nature.

Ground Level

Multipurpose court

Toddler's play area

Kid's play area

Adventure wall

Elder's park

Ample parking space

Podium Level

Surrealistic swimming pool

Club house

Open-to-sky party lawn

Meditation & yoga room

Peace zone

Gymnasium





ALO

HI





Aloha

Soak up the luxury in our beautifully designed living rooms. A well-lit, spacious area overlooking the greenery where living becomes extraordinary.

Our well planned bedrooms ensure zero wastage of space and offer ultimate comfort making you feel at home.

Experience the fun of cooking in our sleek yet straightforward kitchens, designed to make your cooking experience hassle free.

Discover exquisitely designed bathrooms to help you shower away your stress and soak your senses in the moment.



At your service

Palghar

Being a district of Maharashtra, State Government showing immanence efforts by announcing facilities of Airport, Bullet Train, Coastal Road, brought Palghar in MMR and many other development plans in short. Thus Palghar is a growing residential and commercial area near the heart of the economic capital, giving it as advantage of connectivity.

As a result ALOHA offers perfect blend of quiet atmosphere within the two kilometers radius of City center, Hospitals, Educational Institutes, Business Center, Railway Station, Banks etc. Provide great proximity from project. ALOHA located on 24 Mtrs. DP road making project a hotspot for investments.

Yet ALOHA offers a uninterrupted view of 4.5 acres Mango farm adjacent to North boundary and in the South & East are blessed with two Reserved Public Garden marked in development plan offering a neat, clean and green environment.



Stay well connected



Aloha

Come, experience the true sense of Aloha among smartly designed 1 and 2 BHK homes accompanied by a multitude of exclusive amenities.

4 towers with 14 residential floors.

Podium swimming pool, club house, gym.

Dedicated Meditation Area.

2 high speed elevators in each tower for ultra-comfort.

Retail + Commercial spaces for better convenience.





ALOHA

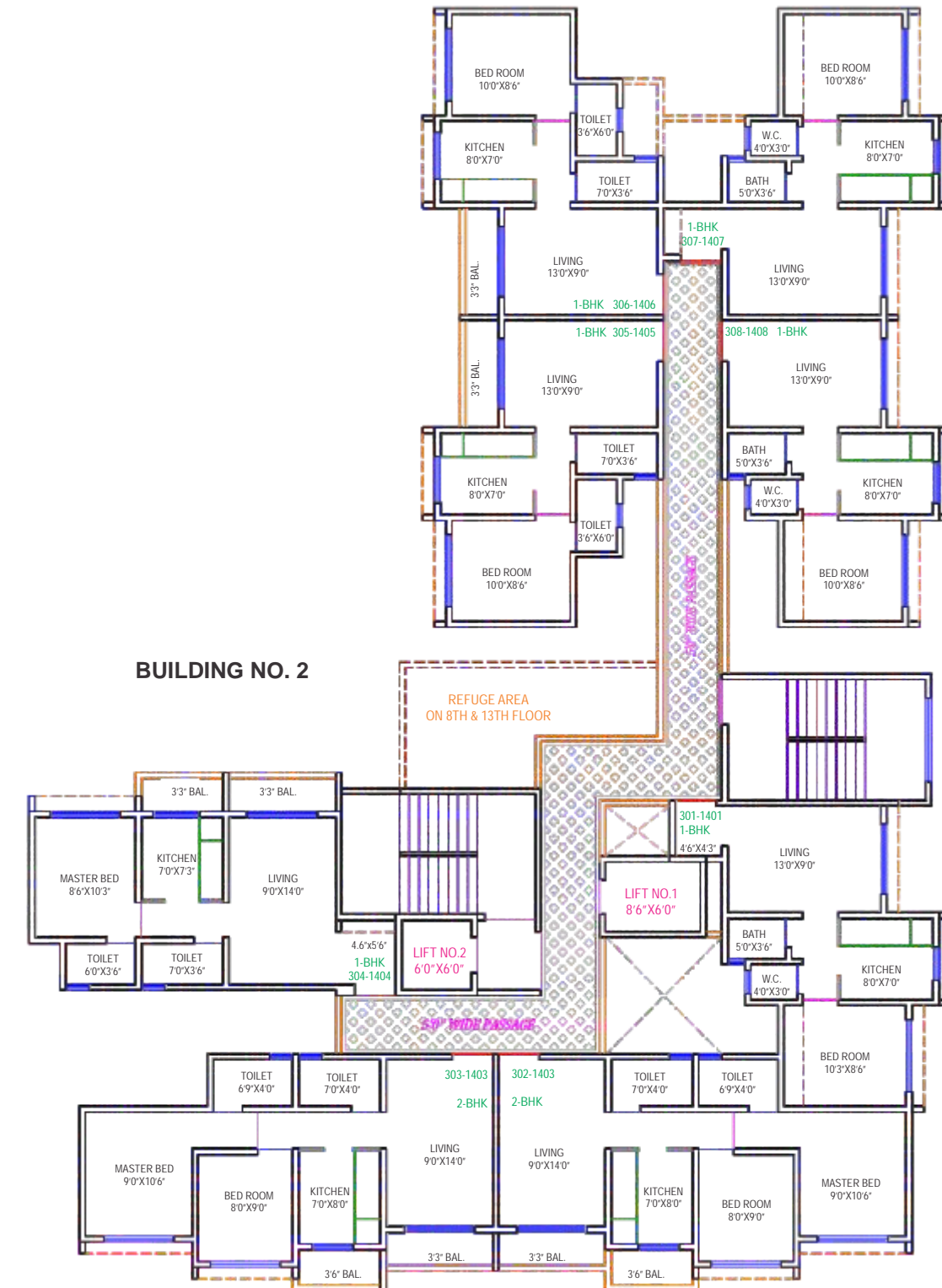
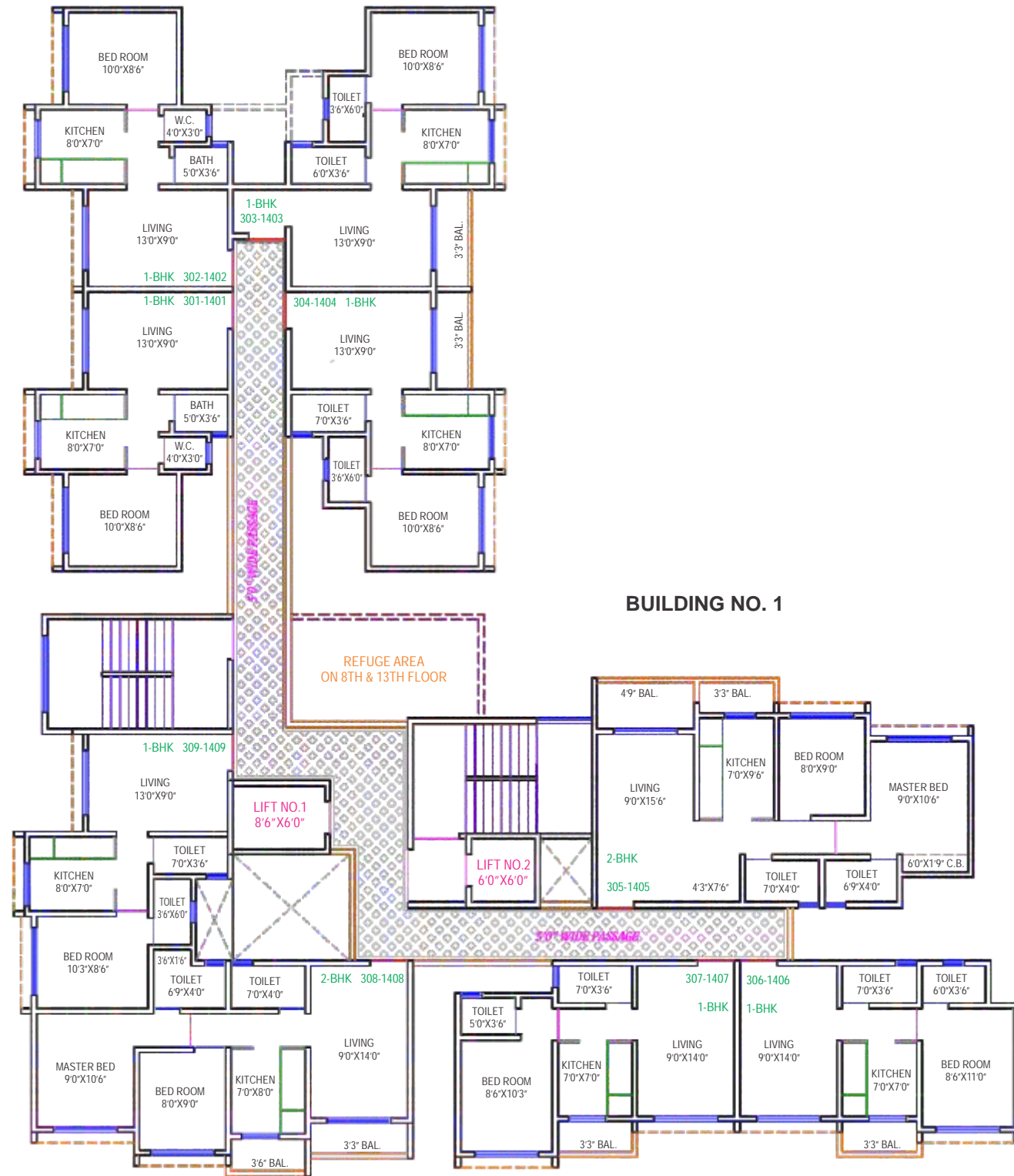



Enjoy the nature with all the ease

Convenient Lifestyle

INTERNAL AMENITIES

Doors
Wooden frames
Wooden flush shutters

Windows
Branded anodised french window with tinted glass and mosquito net.

Flooring
Vitrified tiles in Living, Dining, Master bedroom and passage

Kitchen
Floor - Vitrified tiles
Semi Modular Kitchen
Counter tops - Granite with steel sink
Designer Ceramic tiles on wall up-to beam height

Bathroom
Designer Ceramic tiles on wall up-to full height and anti skid tiles on floor.

CP and Sanitary fixtures
High-quality sanitary fixtures.

Electrical
Superior quality concealed copper wiring, latest modular switches and miniature circuit breakers.
Adequate points for TV and other electrical appliances.

EXTERNAL AMENITIES

Exterior finish
Gothic elevation
Branded exterior paint

Lobbies
Ceiling - Gypsum/Grid false ceiling
Lift fascia - Granite/Marble
Wall cladding - Combination of tiles, marble and paint

Elevator
Two high speed automatic Elevator of branded company, (one regular and goods/stretcher) in each tower.

Power backup
Back-up generator (DG) for elevators, water pumps and lighting in common area.

Fire compliance
Fire safety feature like fire escape, fire fitting equipments, and fire alarm as per regulation.

Society Rooms
Society Office, Driver's Room, Security Cabins, Round the clock security

Rain water harvesting

RCC frame structure designed for stability.

Grand Entrance, Club House with open to sky party-lawn, Meditation Center, Pool table, Swimming Pool with pool deck and changing rooms, Multipurpose Court, toddler & Kids Play Area, Indoor Games, Senior Citizen Corner and many more

A PROJECT BY:



Regd. Office : P-005, Silent Park, Near Golden Nest Circle,
Mira Bhayandar Road, Bhayandar (E), Mumbai - 401 105.
Email : seacrestsbuidcon@gmail.com

ODYSSEY
ARCHITECT & ASSOCIATES
PALGHAR WEST.

Site Address: Survey No. 273, Allyali, Off. Mahim Road,
Near Swatantra Veer Savarkar Marg, Valan Naka,
Palghar West, Pin : 401 404.

RCC CONSULTANT
DARSH CONSULT
MIRA ROAD EAST.

Site Office : Shop No. 2, 3 and 7, Elegance Building,
Opp. Swami Samarth Math, Mahim Road, Palghar (W) : 401 404.
Email : aloha.palghar@gmail.com



CREDAI - MCHI



www.alohapalghar.com

Disclaimer : The specification, images and other details here in are only indicative and imaginary and the developer reserves the right to change all or any of these in the development.
This brochure does not constitute an offer or contract of any type between the developer and the recipient. Any purchase of this development shall be governed by the terms and conditions
mentioned in the agreement for same between the developer and the buyer.