



SAYBA
RESIDENCY



Welcome to Sayba Residency

A world of luxurious 1, 2 & 3 BHK residences,

Sayba Residency offers a lifestyle that's class apart.

Laden with best-in-class amenities and superior it's your ideal dwelling abode.



Teardrop Swing

Sitting Area

Sitting Area

Terrace Garden Plan



Jogging Track

Children Play Area



AMENITIES:

- Anodized aluminum sliding windows
- Granite kitchen platform with S.S. sink
- Glazed tiles dado up to the ceiling
- Designer vitrified flooring
- Designer tiles in toilets up to full height

- Concealed plumbing with exclusive fittings & fixtures
- Concealed copper wiring with adequate electrical points

TERRACE AMENITIES:

- Well equipped kids play area
- Jogging track
- Sitting area



1st Floor Plan



Wing - "A"

| Flat No | RERA "Carpet Area" |
|---------|--------------------|
| 1 | 539.49 Sq.Ft. |
| 2 | 539.49 Sq.Ft. |
| 3 | 543.04 Sq.Ft. |
| 4 | 540.67 Sq.Ft. |
| 5 | 539.49 Sq.Ft. |
| 6 | 539.60 Sq.Ft. |

Wing - "B"

| Flat No | RERA "Carpet Area" |
|---------|--------------------|
| 1 | 563.50 Sq.Ft. |
| 2 | 441.22 Sq.Ft. |
| 3 | 441.22 Sq.Ft. |
| 4 | 447.89 Sq.Ft. |
| 5 | 441.22 Sq.Ft. |
| 6 | 441.22 Sq.Ft. |

Wing - "C"

| Flat No | RERA "Carpet Area" |
|---------|--------------------|
| 1 | 563.50 Sq.Ft. |
| 2 | 817.63 Sq.Ft. |
| 3 | 447.89 Sq.Ft. |
| 4 | 441.22 Sq.Ft. |
| 5 | 441.22 Sq.Ft. |

Typical Floor Plan

2nd, 3rd, 4th, 5th, 6th, 7th, 8th, 10th, 11th, 12th, 13th, 14th, 15th & 17th Floor

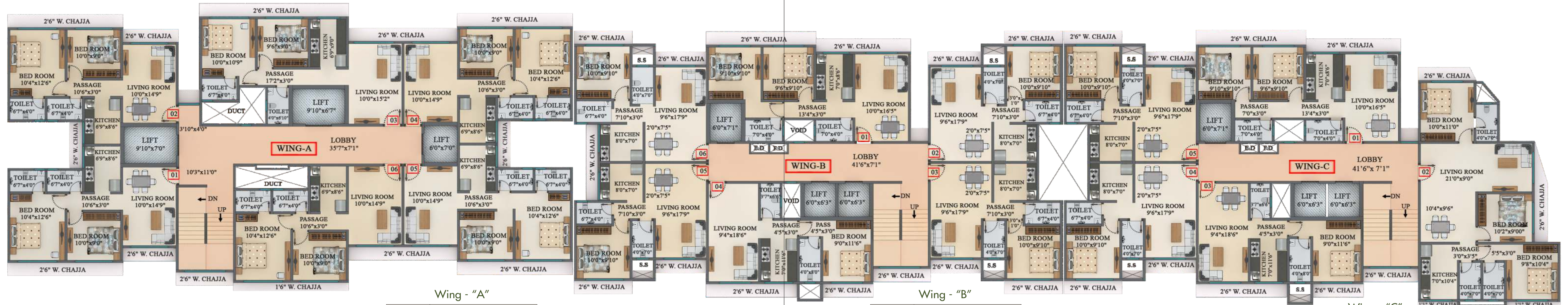

Wing - "A"

| Flat No | RERA "Carpet Area" |
|---------|--------------------|
| 1 | 539.49 Sq.Ft. |
| 2 | 539.49 Sq.Ft. |
| 3 | 543.04 Sq.Ft. |
| 4 | 540.67 Sq.Ft. |
| 5 | 539.49 Sq.Ft. |
| 6 | 539.60 Sq.Ft. |

Wing - "B"

| Flat No | RERA "Carpet Area" |
|---------|--------------------|
| 1 | 563.50 Sq.Ft. |
| 2 | 441.22 Sq.Ft. |
| 3 | 441.22 Sq.Ft. |
| 4 | 447.89 Sq.Ft. |
| 5 | 441.22 Sq.Ft. |
| 6 | 441.22 Sq.Ft. |

Wing - "C"

| Flat No | RERA "Carpet Area" |
|---------|--------------------|
| 1 | 563.50 Sq.Ft. |
| 2 | 817.63 Sq.Ft. |
| 3 | 447.89 Sq.Ft. |
| 4 | 441.22 Sq.Ft. |
| 5 | 441.22 Sq.Ft. |



Wing - "A"

| Flat No | RERA "Carpet Area" |
|---------|--------------------|
| 1 | 539.49 Sq.Ft. |
| 2 | 539.49 Sq.Ft. |
| 3 | 543.04 Sq.Ft. |
| 4 | 790.62 Sq.Ft. |

Wing - "B"

| Flat No | RERA "Carpet Area" |
|---------|--------------------|
| 1 | 563.50 Sq.Ft. |
| 2 | 441.22 Sq.Ft. |
| 3 | 441.22 Sq.Ft. |
| 6 | 516.56 Sq.Ft. |

Wing - "C"

| Flat No | RERA "Carpet Area" |
|---------|--------------------|
| 1 | 563.50 Sq.Ft. |
| 2 | 817.63 Sq.Ft. |
| 5 | 534.32 Sq.Ft. |

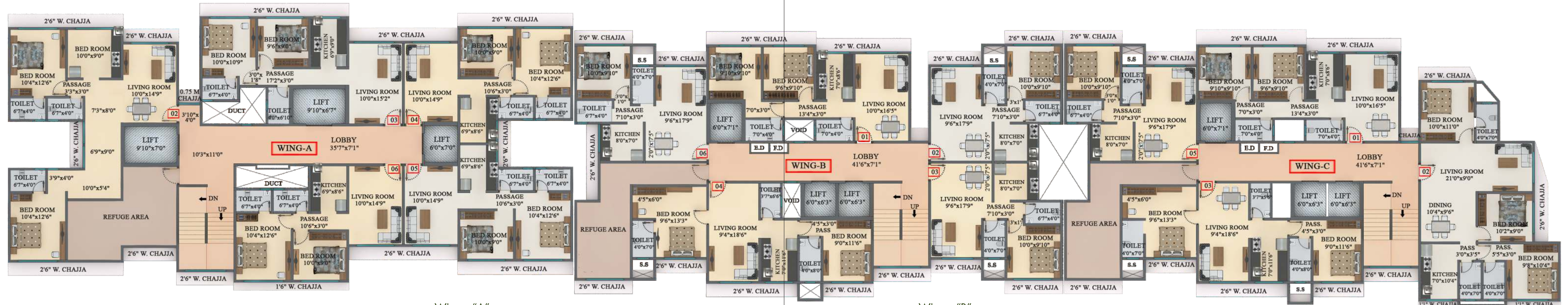

Wing - "A"

| Flat No | RERA "Carpet Area" |
|---------|--------------------|
| 2 | 803.96 Sq.Ft. |
| 3 | 543.04 Sq.Ft. |
| 4 | 540.67 Sq.Ft. |
| 5 | 539.49 Sq.Ft. |
| 6 | 539.60 Sq.Ft. |

Wing - "B"

| Flat No | RERA "Carpet Area" |
|---------|--------------------|
| 1 | 563.50 Sq.Ft. |
| 2 | 441.22 Sq.Ft. |
| 3 | 441.22 Sq.Ft. |
| 4 | 639.70 Sq.Ft. |
| 6 | 441.22 Sq.Ft. |

Wing - "C"

| Flat No | RERA "Carpet Area" |
|---------|--------------------|
| 1 | 563.50 Sq.Ft. |
| 2 | 817.63 Sq.Ft. |
| 3 | 639.70 Sq.Ft. |
| 5 | 441.22 Sq.Ft. |



Seamlessly Connected To All Key Locations In Vicinity.



Near By



Railway Station



Mosque



Bus-stop



Bank



Hospital



Highway Connectivity



SAYBA

R E S I D E N C Y

Developer: Star Rise

For Bookings Contact : +91 86574 50670 / +91 86574 50668 / +91 86574 50677

Site Address: Building No. 89 & 90, Now Known As Nehru Nagar Shree Krupa CHS LTD. On Plot Bearing Cts No.6(FT),
Village Kurla Part III, At Nehru Nagar Mhada Layout, Mother Dairy Road, Kurla East, Mumbai - 400 024.

Email: saybagroup2020@gmail.com • Web : www.saybagroup.com

ARCHITECT
Ellora Project Consultants Pvt. Ltd.

R.C.C. CONSULTANT
Ellora Project Consultancy Services

LEGAL ADVISOR
Pandya & Poonawala Advocate & Solicitor

Project Registered Under MAHARera No.: P51800027913