



CAPITAL PARADISE

Life beyond Imagination *2&3 BHK Luxury Apartments*



FASHION

FASHION

EMPORIO

GABBAAN

FASHION

CLOTHES

PRADA

EMPORIO

EMPORIO



Doon Buildcon is a name of trust, that resonates among the prominent residential developers in Dehradun. We have delivered promising homes to our previous family members (Capital Homes, Capital Residency & Capital Heights).

Our ability to deliver on-time luxurious housing projects in Dehradun has ensured a continual interest from our customers. Our expertise in acquisition of land, appointment of architects and designers, construction, sales to after sales service, has helped us to be counted among Dehradun's forerunners in real estate development.



Lifestyle

Lifestyle find yet another destination in Capital Paradise at Dehradun. Where homes mirror the taste of the affluent class and cater to all the needs of modern living in a seamless manner.

With premium specifications, quality construction and prime location in Dehradun, Capital Paradise is designed to be one of the most sought after living option. Unmatched amenities are also leaves nothing to be desired. In a nutshell, the finest of homes in the best location of Dehradun.





Architecture

With its futuristic architectural design Capital Paradise will epitomize your approach to the new millennium – Impressive, Innovative, Interactive.

Structures and materials that combine technology with luxury form with function and efficiency with elegance.

Capital Paradise will create a new paradigm in terms of design, lifestyle aesthetics and international standards of security.



Environment

The melodies of nature, the purity of breeze, the aura of greenery, are all out to capture the heart and soul of the urban dwellers. Away from noise, pollution, clutter and stress of cramped up lifestyle of over populated metropolitan, Capital Paradise – Apartments comes as a breath of freshness. The mood enhancing, heartwarming, soul-lifting ambience is the very first gift of Capital Paradise to its potential residents.

Well designed walkways, jogging tracks, sitting areas to enjoy the lush green landscape and play areas for kids to have all been taken into consideration.





Interior

We believe where you live say a lot about who you are. Every apartment at Capital Paradise makes you feel special. A great sense of personal space, combined with an abundance of natural light and fresh air permeates every square foot of every room.

Outstanding quality of fit and finish is given and fits perfectly within the concept of modern home.



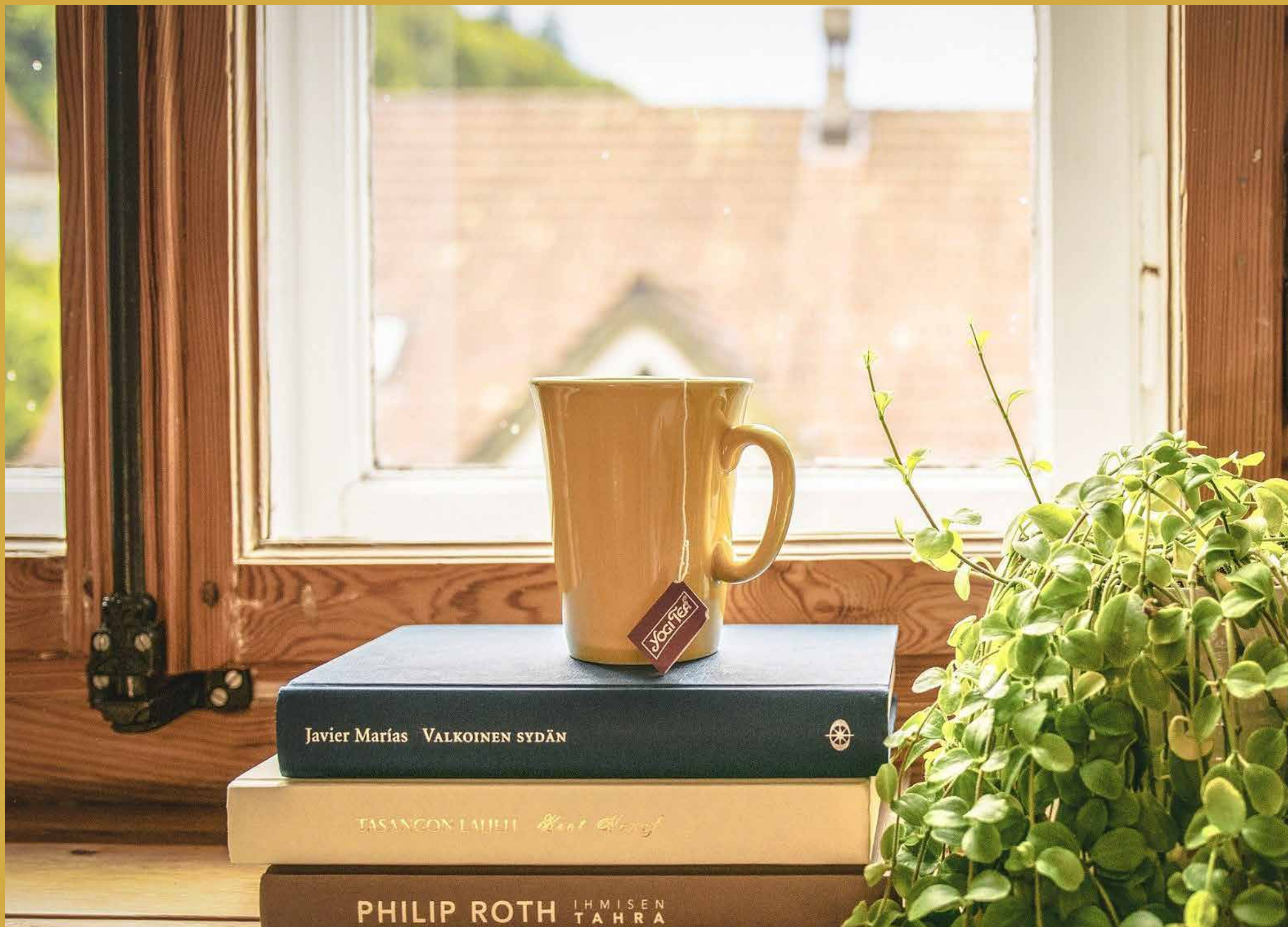

Javier Marías VALKOINEN SYDÄN

TASANGON LAJIET *Heart Strings*

PHILIP ROTH IHMISEN TAHRA

Community Centre

Integrated in the very fabric of the lifestyle at Capital Paradise is the Community Centre for group activities, social support, public information, Basic fitness, Yoga and other purposes. Because life deserve happiness at every moment. Play Area for kids is always an beauty.





Features

- Futuristic architectural design.
 - Impressive, Innovative, Interactive approach.
 - Luxury lifestyle aesthetics.
 - Lush green landscape/green areas.
 - International security standards.
 - Video calling facility from main gate.
 - Surrounded with natural great mountain views to enjoy beauty of nature.
 - Great ambience for great people like you.
- 24x7 Security
 - 24x7 Power Backup
 - CCTV Cameras
 - Video Calling
 - Community Centre Service
 - Local Shops

CAPITAL PARADISE

Life beyond Imagination 2&3 BHK Luxury Apartments



3 BHK APARTMENT Type-1: Floor plan

Total Super Area: 2260 sqft.
3B + 1DD + 1 K + 3T + 3Bal + 1S

CAPITAL PARADISE

Life beyond Imagination 2&3 BHK Luxury Apartments



3 BHK APARTMENT

Type-2: floor plan

Total Super Area: 2050 sqft.
 3B + 1DD + 1 K + 3T + 3Bal

Abbreviations: B = Bedroom; DD = Drawing+Dining; K = Kitchen; T = Toilet; Bal = Balconies

CAPITAL PARADISE

Life beyond Imagination **2&3 BHK Luxury Apartments**



2 BHK APARTMENT

Type-3: Floor plan

Total Super Area: 1485 sqft.
 2B + 1DD + 1 K + 2T + 3Bal + 1S

Abbreviations: B = Bedroom; DD = Drawing+Dining; K = Kitchen; T = Toilet; Bal = Balconies; S=Store

Specifications

LIVING ROOM/DINNING

- **Walls:** POP Punning with Acrylic Emulsion Paint.
- **Ceiling:** False Ceiling Acrylic Emulsion Paint.
- **Floors:** Large Size branded Vitrified Tiles.
- **Doors:** Main Doors- Hard Wood/ Veneer with Teak Polish Frame.
- **Windows:** UPVC/Wooden/Aluminum Powder Coated with Glass & Fly net.
- **Electrical:** Concealed Copper Wiring, Modular Switches.

MASTER BED ROOMS

- **Walls:** POP Punning with Acrylic Emulsion Paint/Wallpaper.
- **Ceiling:** False Ceiling Acrylic Emulsion Paint.
- **Floors:** Laminated Wooden Tiles.
- **Doors:** Main Doors- Hard Wood/ Veneer with Teak Polish Frame.
- **Windows:** UPVC/Wooden/Aluminum Powder Coated with Glass & Fly net.
- **Cupboard:** Will be provided.
- **Electrical:** Concealed Copper Wiring, Modular Switches and provision of AC Point with wiring.

OTHER BEDROOM (s)

- **Walls:** POP Punning with Acrylic Emulsion Paint/Wallpaper.

- **Ceiling:** False Ceiling with Acrylic Emulsion Paint.
- **Floors:** Branded Vitrified Tiles.
- **Doors:** Laminated Flush Doors with Teak Polish Frame.
- **Windows:** UPVC/Wooden/Aluminum Powder Coated with Glass & Fly net.
- **Cupboard:** Will be provided.
- **Electrical:** Concealed Copper Wiring, Modular Switches and provision of AC Point with wiring.

KITCHEN

- **Walls:** POP Punning with Acrylic Emulsion Paint.
- **Ceiling:** False Ceiling with Acrylic Emulsion Paint.
- **Floors:** Anti-Skid Tiles.
- **Windows:** UPVC/Wooden/Aluminum Powder Coated with Glass & Fly net.
- **Cupboard:** Modular Kitchen with Chimney.
- **Electrical:** Concealed Copper Wiring, Modular Switches.
- **Sanitary:** SS Sink with CP Fitting.

BALCONIES

- **Walls:** POP Punning with Acrylic Emulsion Paint.
- **Ceiling:** Acrylic Emulsion Paint.
- **Floors:** Anti-Skid Tiles.
- **Railing:** MS Railling.

- **Sanitary:** Wet Point & Drain Point for Washing Machine.

MASTER TOILET

- **Walls:** Designer Glazed Tiles dado upto7'-6" Heights.
- **Ceiling:** Acrylic Emulsion Paint.
- **Floors:** Anti-Skid Tiles.
- **Doors:** Flush Doors with Teak Polish Frame.
- **Windows:** UPVC/Wooden.
- **Electrical:** Concealed Copper Wiring, Modular Switches.
- **Sanitary:** Branded Sanitary Fixtures & CP Fittings, Wall Hung Western W.C.

OTHER TOILET

- **Walls:** Designer Glazed Tiles dado upto7'-6" Heights.
- **Ceiling:** Acrylic Emulsion Paint.
- **Floors:** Anti-Skid Tiles.
- **Doors:** Flush Doors with Teak Polish Frame.
- **Windows:** UPVC/Wooden.
- **Electrical:** Concealed Copper Wiring, Modular Switches.
- **Sanitary:** Branded Sanitary Fixtures & CP Fittings, Wall Hung Western W.C.



Site Map

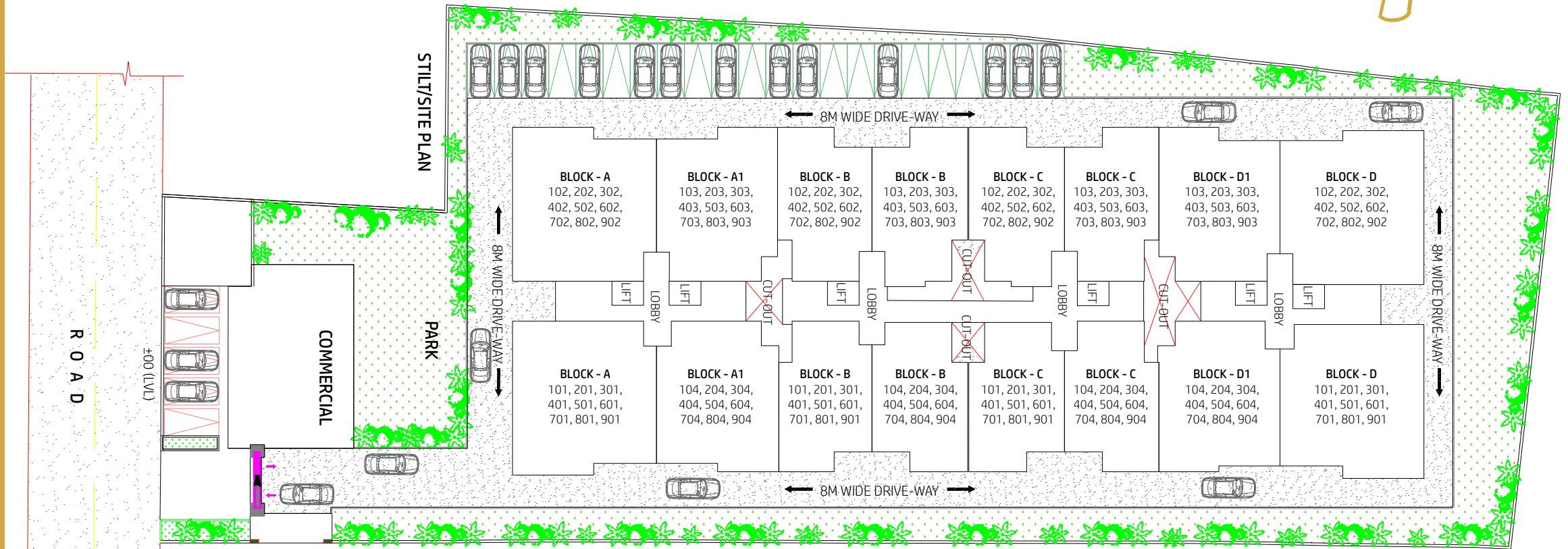

S. No.	Block	Flat No.	Unit Area
1	A	101, 201, 301, 401, 501, 601, 701, 801, 901	2260 Sqft
2	A	102, 202, 302, 402, 502, 602, 702, 802, 902	2260 Sqft
3	A1	104, 204, 304, 404, 504, 604, 704, 804, 904	2050 Sqft
4	A1	103, 203, 303, 403, 503, 603, 703, 803, 903	2050 Sqft
5	B	101, 201, 301, 401, 501, 601, 701, 801, 901	1485 Sqft
6	B	102, 202, 302, 402, 502, 602, 702, 802, 902	1485 Sqft
7	B	104, 204, 304, 404, 504, 604, 704, 804, 904	1485 Sqft
8	B	103, 203, 303, 403, 503, 603, 703, 803, 903	1485 Sqft

S. No.	Block	Flat No.	Unit Area
9	C	101, 201, 301, 401, 501, 601, 701, 801, 901	1485 Sqft
10	C	102, 202, 302, 402, 502, 602, 702, 802, 902	1485 Sqft
11	C	104, 204, 304, 404, 504, 604, 704, 804, 904	1485 Sqft
12	C	103, 203, 303, 403, 503, 603, 703, 803, 903	1485 Sqft
13	D1	104, 204, 304, 404, 504, 604, 704, 804, 904	2050 Sqft
14	D1	103, 203, 303, 403, 503, 603, 703, 803, 903	2050 Sqft
15	D	101, 201, 301, 401, 501, 601, 701, 801, 901	2260 Sqft
16	D	102, 202, 302, 402, 502, 602, 702, 802, 902	2260 Sqft



Location

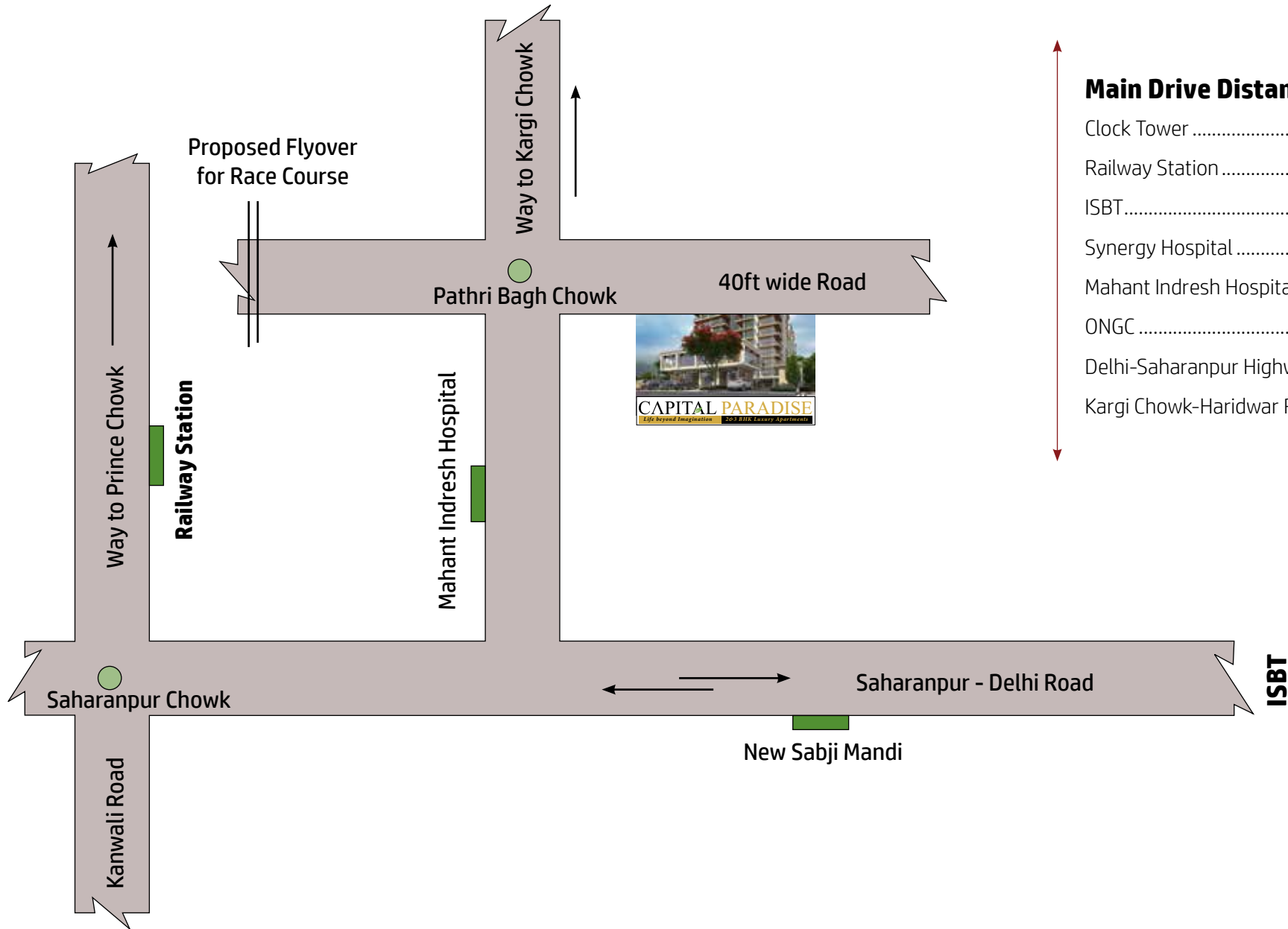

Main Drive Distances

Clock Tower	3 Km
Railway Station	2 Km
ISBT.....	3 Km
Synergy Hospital	4 Km
Mahant Indresh Hospital	0.5 Km
ONGC	5 km
Delhi-Saharanpur Highway.....	0.7 km
Kargi Chowk-Haridwar Road.....	0.8 km

MAP NOT TO SCALE

Projects Successfully Delivered with Commitment



Capital Homes

A first residential project situated at Turner Road Dehradun, started in end of 2012 and successfully completed and delivered to the buyers in Dec 2014.

We deliver commitment!



Capital Residency

A residential project situated at GMS Road Dehradun, successfully completed and delivered to the respective buyers in Dec 2016.

We deliver commitment!



Capital Height

A residential project situated at Niranjanpur Dehradun, successfully completed and delivered to the respective buyers in 2019.

We deliver commitment!



Capital Avenue

A freehold plotted residential gated society at Turner Road Dehradun. An on-going project. Many plot owners has been started construction of their dream home.

We deliver commitment!



CAPITAL PARADISE

Life beyond Imagination **2&3 BHK Luxury Apartments**

SITE OFFICE

Pathri Bagh Chowk, Near Mehant Indresh Hospital,
Dehrakhas, Dehradun, Uttarakhand 248001
Tel: +91-9760000050, 9927110005

HEAD OFFICE

Autocare, 1/6, Saharanpur Road,
Mata Wala Bagh, Dehradun - 248001
Tel: +91-9837050086, 9897391411, 9897731477
Email: info@doonbuildcon.com; Web: www.doonbuildcon.com

Disclaimer: The information and features outlined, privileges, benefits and facilities offered, contents and terms stated in the brochure/publication are purely conceptual and not a legal offering and the same are for preliminary purposes only and imply no commitment or warranty of whatsoever kind. All rights to revise number of floors, units, amend layout position, plans, elevation, design and to make additions, deletions etc. without any previous intimation are hereby reserved by Doon Buildcon Pvt. Ltd. All images of the property and services depicted here are indicative and the same are subject to change without prior notification.

FINANCING PARTNERS

