



**WESTBAY**  
— BANDRA (W) —



INTRODUCING  
THE BEST OF BANDRA WEST



# WESTBAY

3 BED SEA & LAKE VIEW RESIDENCES  
PART OC RECEIVED



Welcome to a lifestyle that offers you the **Best of the West**. Be it the locality, the enriching views or the people you live with, everything you experience here is top-notch. Exclusively curated lifestyle amenities to provide only the best moments. Come and experience the best of modern living with your loved ones.

22 STOREY BUILDING | 4 RESIDENCES PER FLOOR  
4 HIGH SPEED ELEVATORS



# UNINTERRUPTED VIEWS OF THE ARABIAN SEA AS ENCHANTING AS YOU ARE

---

The good old Bombay life starts here at Bandra. From rich socializing avenues to the richest in town, from buzzing cafes & restaurants to the latest trend in town, you are sure to witness only the best here.

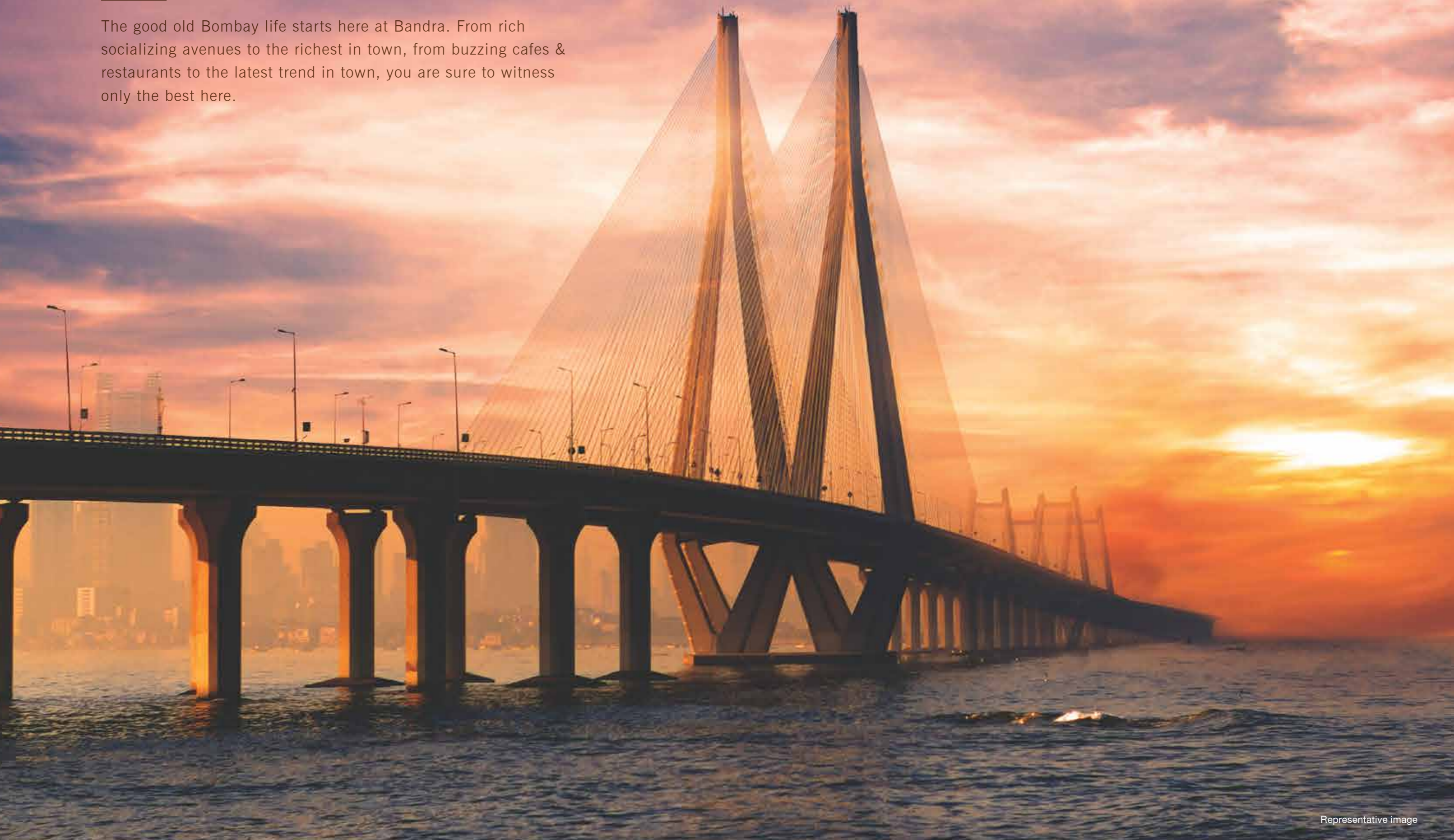



# CHERISH ONLY THE BEST VIEWS FOR THE REST OF YOUR LIFE!

---

From the Bandra Talao on one side to the bay view on the other, live a breezy life in the middle of the bustle with luxurious apartments at Westbay.





## A STATUS SYMBOL AS ICONIC AS YOU ARE!

---

The good old Bombay life starts here at Bandra. From rich socializing avenues to trendy cafes & restaurants, you are sure to witness only the best here.



# AN UPSCALE LOCALE WITH ACCESSIBILITY AS SUPERIOR AS YOU ARE.

A handpicked location dotted with civic facilities and easy accessibility. Here, you live at the center of everything, be it education, healthcare or retail, for you to have a lifestyle that is truly a class apart.



## CONNECTIVITY

- Western Express Highway – 1 km
- Bandra Station – 1.1 km
- Kurla Station – 7.5 km
- BKC Connector – 10 km
- Lower Parel – 7.5 km
- Worli – 8.5 km



## HEALTHCARE

- Lilavati Hospital – 1.9 km
- Holy Family Hospital – 2 km
- S L Raheja Hospital – 3.3 km
- Hinduja Hospital – 4 km
- Asian Heart Hospital – 5 km



## EDUCATIONAL INSTITUTES

- Dhirubai Ambani International School – 6.5 km
- Ascend International School – 5 km
- Mount Litera School – 5.7 km
- Podar International School – 3.3 km
- American School Of Bombay – 6.4 km



## RETAIL STORES

- Shoppers Stop – 650 m
- Elco Market – 850 m
- Marks & Spencer – 800 m
- Nature's Basket – 1 km
- Foodhall – 2.4 km
- Phoenix Market City – 9.4 km



## ENTERTAINMENT & LEISURE

- Otters Club – 2.3 km
- Bandra Gymkhana – 1.7 km
- Taj Lands End – 3.4 km
- MCA Club – 5.5 km
- PVR – 900 m



# WHEN YOU ARE ABOVE THE REST YOU DESERVE ONLY THE BEST

---

Here, every day will be full of excitement with indulgences as rare as you are. Every amenity is thoughtfully designed so that you cherish the best. From the luxurious infinity pool to the lavish clubhouse and from the grand entrance lobby to your stylish living area, you will experience the best craftsmanship with attention to detail.

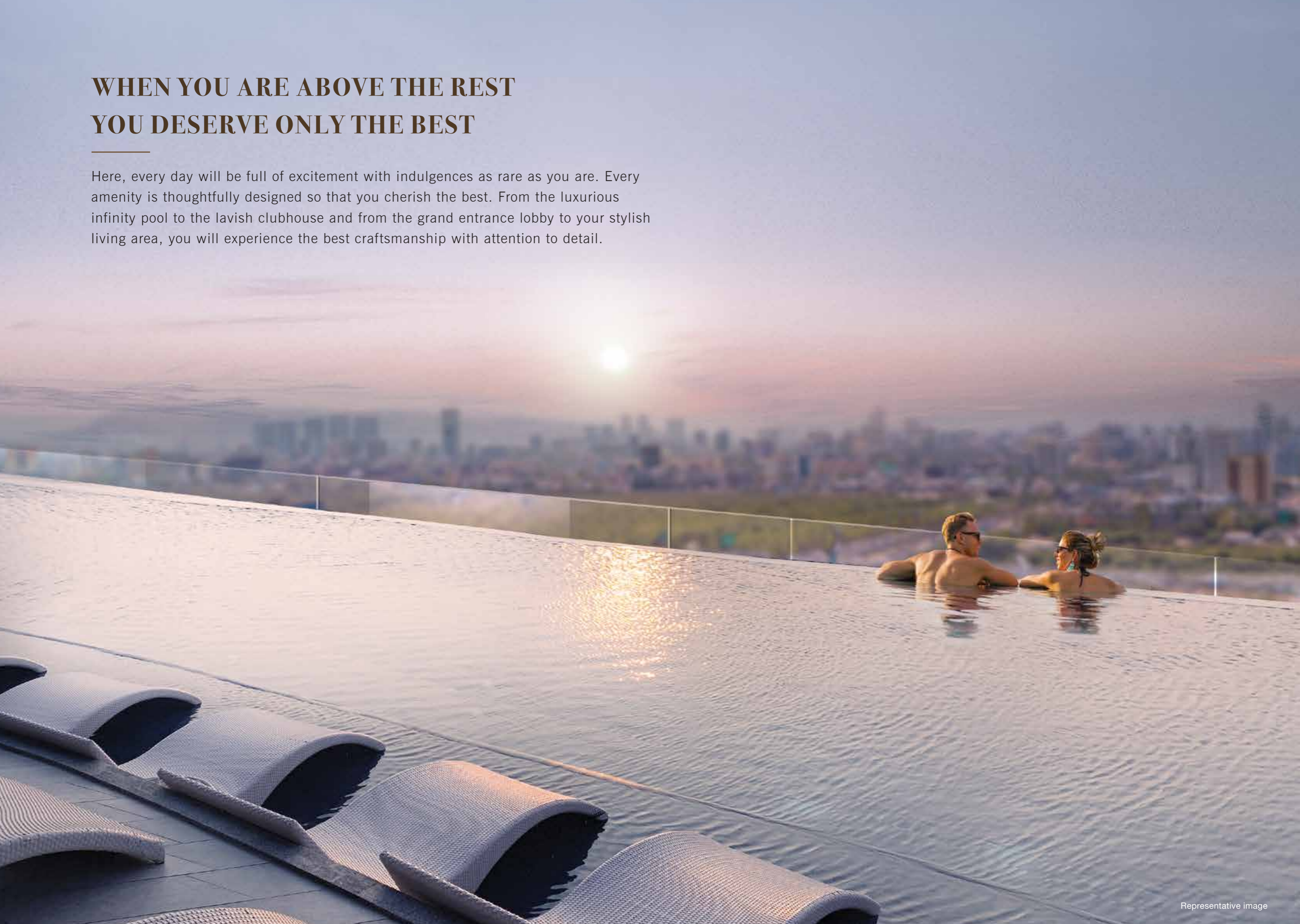



ENJOY A LIFESTYLE  
AS ACTIVE AS YOU ARE!

Fully Equipped Gymnasium





**EVERY ARRIVAL HERE WILL BE  
AS STYLISH AS YOU ARE!**

**Elegant Driveway**







**EVERY MOVE YOU MAKE WILL BE  
AS GRAND AS YOU ARE!**

Entrance Lobby



# FILL YOUR LIFE WITH ELEMENTS AS EXQUISITE AS YOU ARE!

---

Every moment spent in these intricately designed residences is nothing short of a dream. Thoughtful layouts and intelligent design will ensure that every moment is a golden memory.





**MAKE EVERY MOMENT  
AS IMPRESSIVE AS YOU ARE!**

BEDROOM





**PLANNING AS  
INTELLIGENT AS  
YOU ARE!**

**MASTER LAYOUT PLAN**

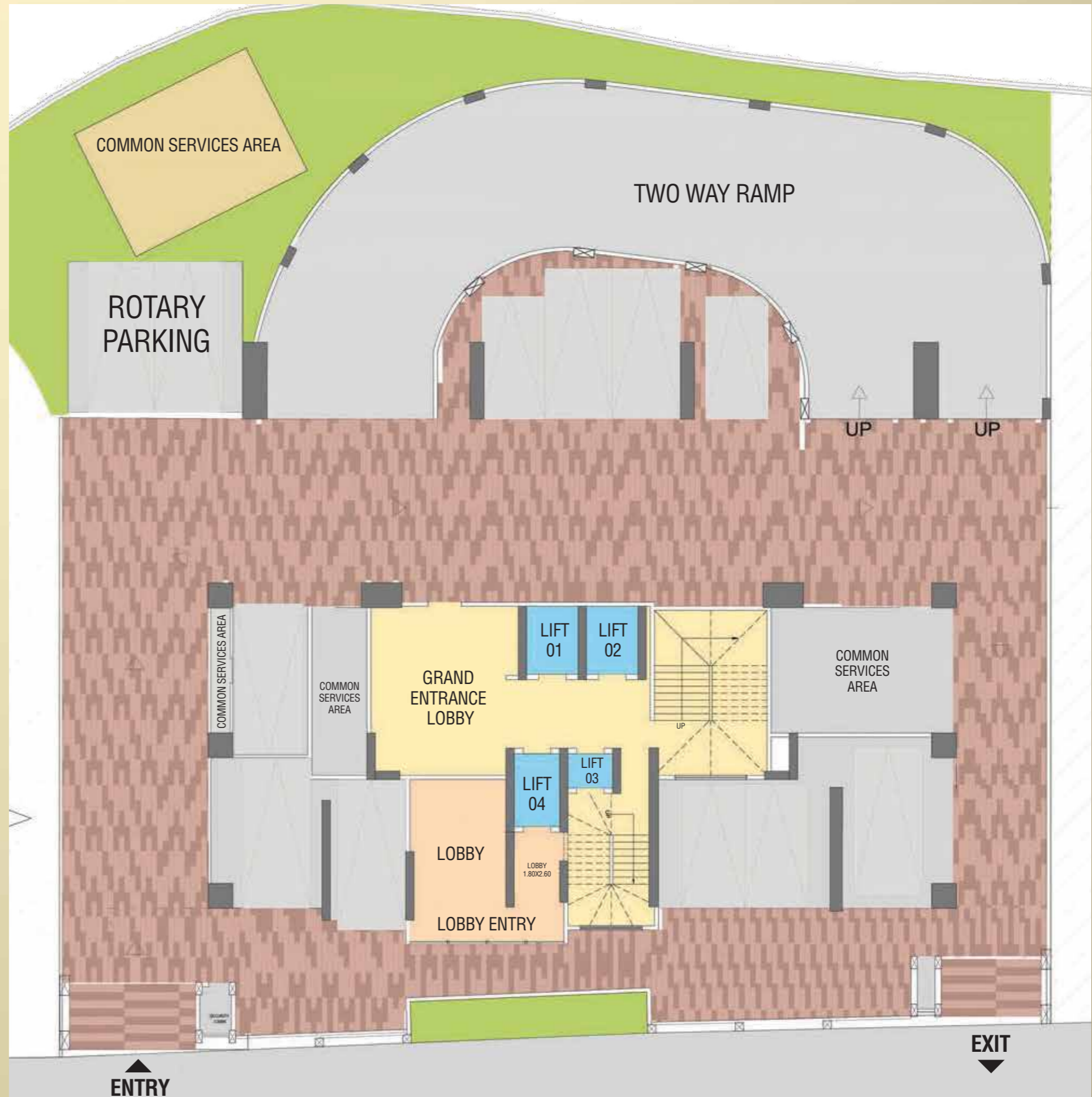



TYPICAL FLOOR PLAN





UNIT 1 - 1166 SQ.FT.



UNIT 3 - 1265 SQ.FT.



UNIT 2 - 1175 SQ.FT.



UNIT 4 - 1265 SQ.FT.







**Sales Lounge: Westbay, Off SV Road, Opp Bandra Talao, Bandra West, Mumbai, Maharashtra 400050.**

 This project has been registered under MahaRERA: RERA NO. P51800001494 is available on the website <https://maharera.mahaonline.gov.in> under registered projects.

Disclaimer: The information, plans, specifications, images, configuration, dimensions, facilities and other details contained herein are indicative of the kind of development that is proposed by the Promoter and the intended recipient/reader/viewer/interested party should note that these are to be treated as purely provisional and informative and as such only tentative subject to approval of authorities or otherwise and the Promoter reserves the right to make changes and alterations at its sole discretion. None of the images, material, stock photography, projections, elevations, details, descriptions and other information that are displayed/contained herein, should be deemed to be or constitute advertisements, solicitations, marketing, offer for sale, invitation to offer, invitation to acquire, including within the purview of the Real Estate (Development and Regulation) Act, 2016 ("RERA"). This advertisement is purely conceptual and purchase in this Project shall be governed by the terms and conditions of the Agreement for Sale. While every reasonable care has been taken in fashioning this advertisement, Any intended recipient/reader/viewer/interested party should verify all the information with the Promoter prior to purchase in the project, the Promoter cannot be held responsible for any inaccuracies or omissions. The Promoter shall not be responsible for any action taken by the intended recipient/reader/viewer/interested party relying on such material /information on the Website and brochures and any information provided by Real Estate Agent /Broker/ Channel Partner without independently verifying with the Promoter.