

*Open spaces for an open  
Lifestyle*



The  
**park**







## About RLF

Real Estate project begins with courage and conviction, to challenge the conventional wisdom and balance the same with excellence and expertise. It was this forethought that laid the foundation and genesis of the RLF Infratech Private Limited. RLF constructs residential and commercial properties in Gurgaon, Bhiwadi and NCR region.

Since our inception, the group has come a long way in redefining the cityscape of Bhiwadi, and our new residential project here is a one of the milestones achieved. As a young and dynamic organization, we believe that progressive thinking plays a huge role in ever-changing real estate sector. We believe in adapting our policies and approach with time. Hence we are able to construct what we call as the 'Intelligent Living Space'.

We are committed to deliver comprehensive, integrated, value-generating assets to address the modern property needs. Immaculate homes are what we desire to deliver. 'Maintenance is a Constant Reaction' is the motto of our support team, and hassle-free possession is our ultimate promise.



# The Ultimate Growth Area of Delhi-NCR (Bhiwadi)



25000+ Companies....

- ✈ Bhiwadi is the 3rd Largest Growing Industrial Town of India
- ✈ Govt. Approved Cargo Airport
- 👤 GD Goenka Public School with in campus
- 🏪 More than 200 Retails Brands in Shopping Malls in Vicinity
- 💻 DMIC-(Delhi Mumbai Industrial Corridor) & DFC-(Dedicated Freight Corridor)-\$100 Billion Project
- 🚗 A Close Connectivity to NH-8- Delhi/Jaipur
- 🏠 More than 2500 Operation Industrial & preferred Destination for MNC's
- 🚑 Leading hospitals in the neighborhood



# AMENITIES AT RLF “THE PARK CLUB HOUSE”

## *G.D.Goenka Public School*



Actual Site Photograph



Kids Play Area



Jogging Track



Badminton Court



Commercial Plaza



Swimming Pool



Table Tennis

- 24 Hour Water Supply
- 100% Power Backup
- Party Lounge
- Vaastu Friendly Layout Design
- Complete wood work



Cards Room



Gym



3 Tier Security System

# Dive in to An Extensive Menu of Relaxing And Reviving Options

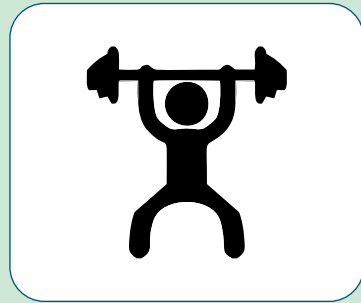

Gymnasium



Jogging Track



Kids Play Area

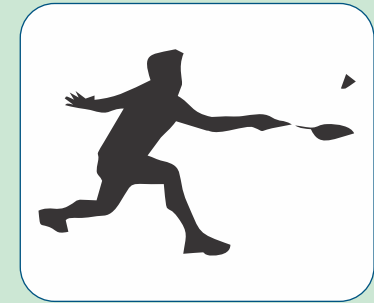

Badminton Court



3-Tier Security System

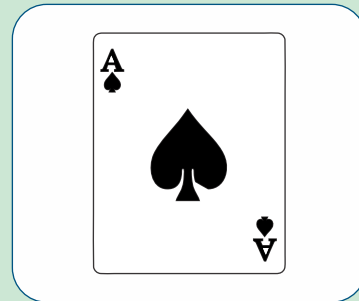

Cards Room

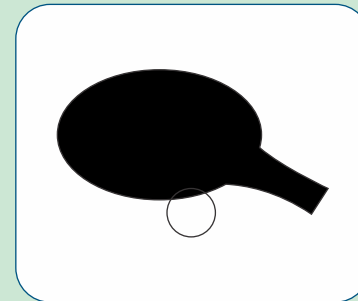

T.T. Room

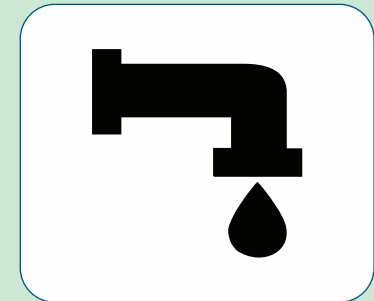

24 Hour Water Supply

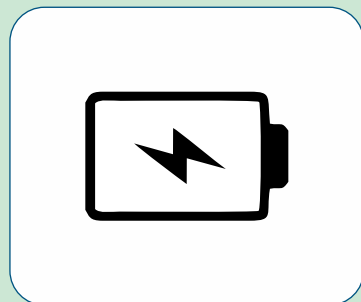

Power Backup



Party Lounge



Commercial Plaza



Vaastu Friendly Layout



# Construction As on Date



# Construction In Full Swing



# RLF The Park - Everything Else is Beneath You !





# Experience Living Spaces that Live Up to A Fantasy



Sample Flat Images

## 2BHK (125SQ.YRD.) Semi Furnished

- Provision for A/C in All Rooms
- Under Counter Kitchen Cupboard
- Wooden Cup Board in All Bed Rooms

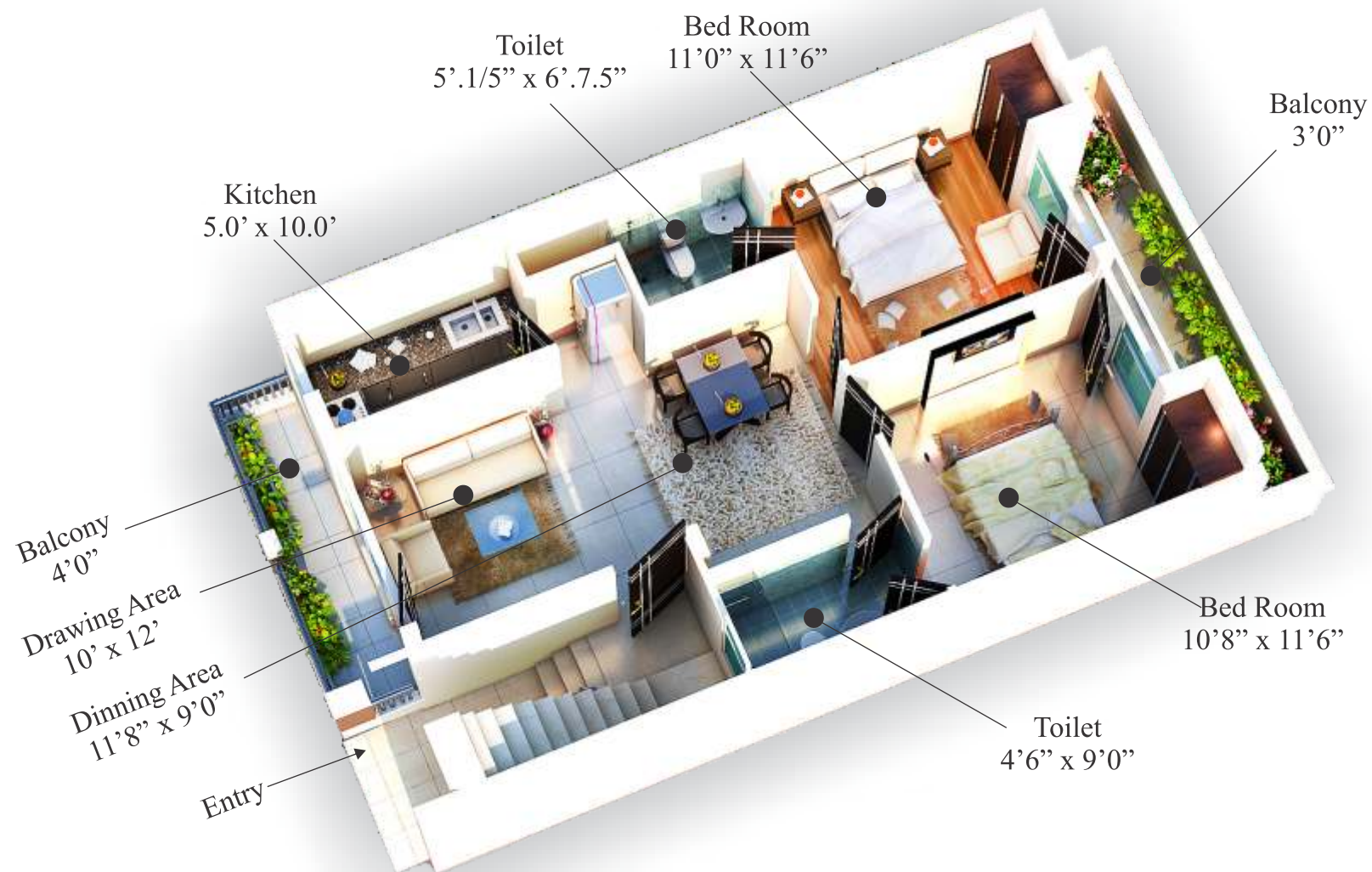

**Super Area :** 125 Sq. Yrd.

**Unit Plan :** ( 2 Bed+2Toilet+2Balcony+Living/Dinning Room)

**Built Up Area :** 955 Sq.Ft.

**Carpet Area :** 740 Sq.Ft. ( Including Balcony Area)

## Floor Plans



### 3BHK (170SQ.YRD.) Semi Furnished

- Provision for A/C in All Rooms
- Under Counter Kitchen Cupboard
- Wooden Cup Board in All Bed Rooms



**Super Area :** 170 Sq. Yrd.

**Unit Plan :** ( 3 Bed+2Toilet+2Balcony+Living/Dinning Room)

**Built Up Area :** 1235 Sq.Ft.

**Carpet Area :** 996 Sq.Ft. ( Including Balcony Area)

## Floor Plans

# LOCATION MAP





<b>STRUCTURE</b>	Earthquake Resistance RCC Frame Structure as per the design of the Structural Consultant.
<b>WALL FINISH</b> Interior  Exterior	Acrylic Emulsion of a reputed brand in pleasing shades as per the architect's suggested colour palette. Exquisitely designed exteriors finished in acrylic paint of a reputed brand.
<b>FLOORINGS</b> Drawing/Dining Bedrooms Balconies	Vitrified Tiles Wooden Flooring in Master Bedroom, Vitrified tiles in supplementary bedrooms. Anti Skid Ceramic Tiles
<b>TOILETS</b> Walls Flooring Fittings/Fixtures	Ceramic Tiles up to roof height Ceramic Tiles Sanitary ware fittings & fixtures of reputed company, mirror, towel rail.
<b>KITCHEN</b> Flooring Platform Wall	Ceramic Tiles Granite platform with Stainless steel sink with drain board 2ft Ceramic tiles dado above platform & acrylic emulsion of a reputed brand in a pleasing shade as per the architect's suggested colour palette.
<b>WINDOWS</b>	Wooden windows with clear float glass
<b>DOORS</b> Main Door Other Doors	Flush Door/Skin door with solid wooden frame, Lock, Premium handle Flush Door/Skin door with solid wooden frame with Premium handle
<b>ELECTRICAL</b> Fittings  Wiring	Convenient provision & distribution of light & power plugs, provision for electrical chimney above platform and water purifier point in kitchen. All electrical wiring in concealed conduits with Copper wires.
<b>WATER SUPPLY</b>	24 X 7 Water supply
<b>GENERATOR</b>	100% Power backup
<b>TELEPHONE/TV/WIFI</b>	Connection point will be provided in living/dining and all bedrooms.
<b>AIR- CONDITIONING</b>	Provision for A/C in all bed rooms and living room.
<b>WOOD WORK</b>	Wooden Almirah in all the Bedrooms and Under counter Kitchen Cup-boards.

## MASTER LAYOUT PLAN OF RLF “THE PARK”



### LEGEND

- 1 Entry/Exit
- 2 Commercial-1
- 3 Commercial-2
- 4 A-Block
- 5 B-Block
- 6 C-Block
- 7 D-Block
- 8 E-Block
- 9 Club House
- 10 Park
- 11 G.D. Goenka Public School







भू-उपयोग-2031



As approved with Govt. Modification No.

**Dated:**

RAJASTHAN





**Project Approved By Leading Banks**



## **RLF Infratech Pvt. Ltd.**

B-543, Spaze I-Tech Park, 5th Floor, Sec-49, Sohna Road, Gurgaon - 122002

E-mail : [info@rlfgroup.in](mailto:info@rlfgroup.in) | Web : [www.rlfgroup.in](http://www.rlfgroup.in)

Phone : +91-124-4241927, 4361888 | Sales Helpline No. : 80-8805-8805

| RERA REGISTERED NO. RAJ/P/2017/458

Disclaimer: Visual Representation Shown in this brochure is Purely conceptual and not a legal offering. all Layout plan are tentative and subject to variation and modification by company & all competent authorities sanctioning plans.