



PASSION AT WORK

SOBHA  
**ATLANTIS**  
Pearl of the Arabian Sea  
Vyttila, Kochi



FLOOR PLANS

OFFICE ADDRESS  
SOBHA LIMITED  
5th Floor, West Wing,  
Jomer Symphony, Chalickavattom,  
Vyttila, Kochi - 682019

T 96 33 00 80 80  
E [salescochin@sobha.com](mailto:salescochin@sobha.com)  
W [www.sobha.com](http://www.sobha.com)



- LEGEND :**
- 1 ENTRANCE PLAZA
  - 2 ENTRANCE ARCH
  - 3 DG YARD
  - 4 VISITORS CARPARKS
  - 5 TWO-WHEELER PARKING
  - 6 RMU PANEL (OPEN TEMPORARY STRUCTURE)
  - 7 ORGANIC WASTE CONVERTER
  - 8 NATURE TRAIL
  - 9 LAKEFRONT PLAZA
  - 10 BIO-SWALE
  - 11 PALM GROVE PLAZA
  - 12 BOTANICAL GARDEN
  - 13 KIDS PLAY AREA
  - 14 PODIUM LEVEL
  - 15 COURTYARDS
  - 16 SWIMMING POOL @ CLUBHOUSE
  - 17 BEACH VOLLEYBALL
  - 18 MULTI COURT
  - 19 BEACH DECK
  - 20 BEACH POOL
  - 21 SEWAGE TREATMENT PLANT





**TYPE C**  
3 BHK  
SBA - 2692 SQ.FT

**FLOOR PLANS**



All dimensions in mm  
SBA rounded upto nearest whole number

Key plan

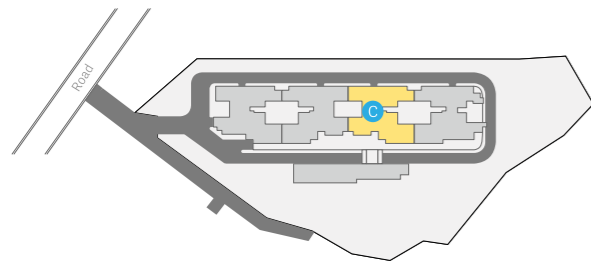

Ground Floor

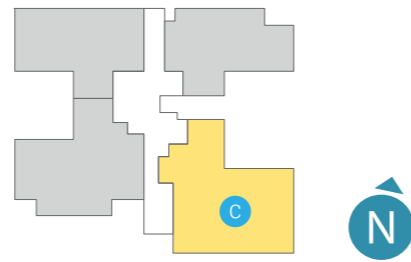

**TYPE C1**  
3 BHK  
SBA - 1850 SQ.FT

**FLOOR PLANS**



All dimensions in mm  
SBA rounded upto nearest whole number

Key plan

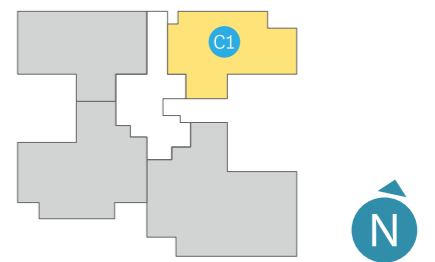
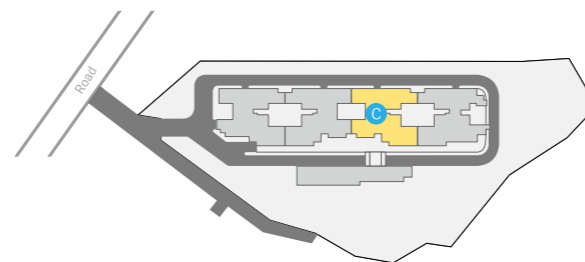

**TYPE C2**  
**3 BHK**  
**SBA - 1964 SQ.FT**

**FLOOR PLANS**



All dimensions in mm  
 SBA rounded upto nearest whole number

**Key plan**

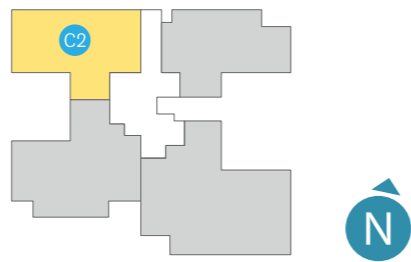
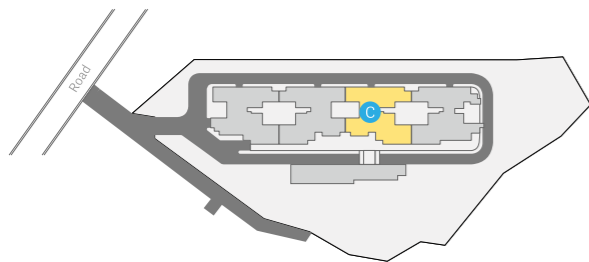

**TYPE C3**  
**3 BHK**  
**SBA - 2349 SQ.FT**

**FLOOR PLANS**



All dimensions in mm  
 SBA rounded upto nearest whole number

**Key plan**

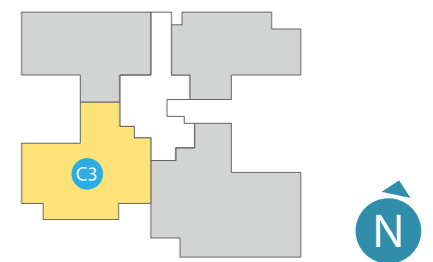
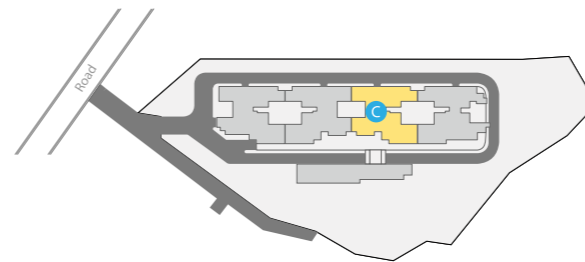

**TYPE C4**  
**4 BHK**  
**SBA - 3104 SQ.FT**

**FLOOR PLANS**



All dimensions in mm  
 SBA rounded upto nearest whole number

Key plan

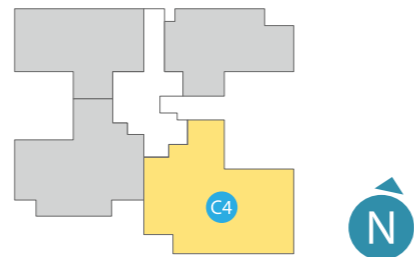
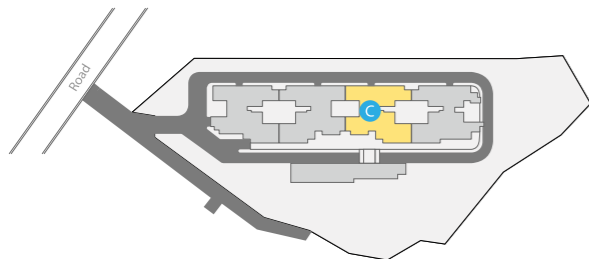

**TYPE D**  
**3 BHK**  
**SBA - 2705 SQ.FT**

**FLOOR PLANS**



All dimensions in mm  
 SBA rounded upto nearest whole number

Key plan

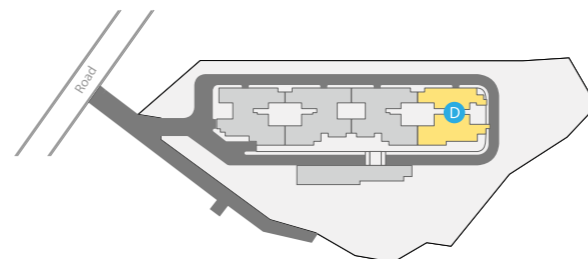

Ground Floor

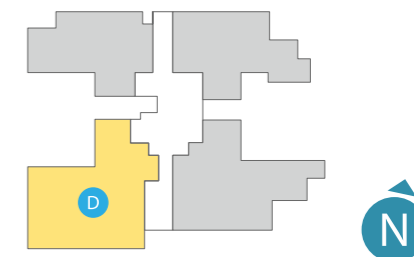



**TYPE D1**  
**3 BHK**  
**SBA - 1859 SQ.FT**

**FLOOR PLANS**

**TYPE D2**  
**3 BHK**  
**SBA - 1933 SQ.FT**

**FLOOR PLANS**



All dimensions in mm

SBA rounded upto nearest whole number

All dimensions in mm

SBA rounded upto nearest whole number

Key plan

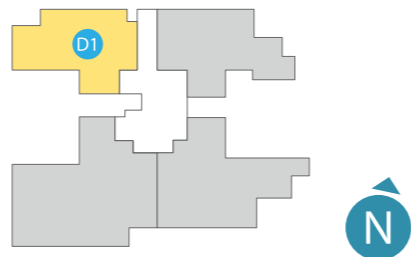
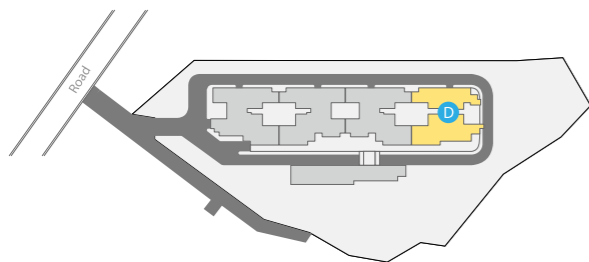

Key plan

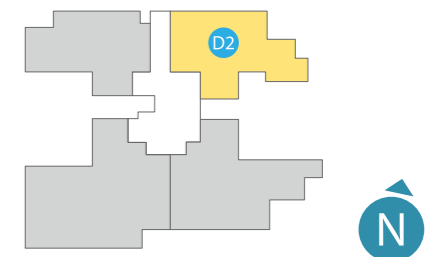
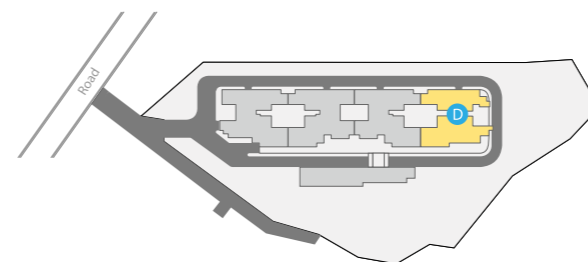

**TYPE D3**  
**3 BHK**  
**SBA - 2390 SQ.FT**

**FLOOR PLANS**



All dimensions in mm  
 SBA rounded upto nearest whole number

Key plan

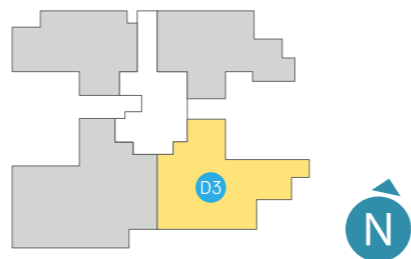
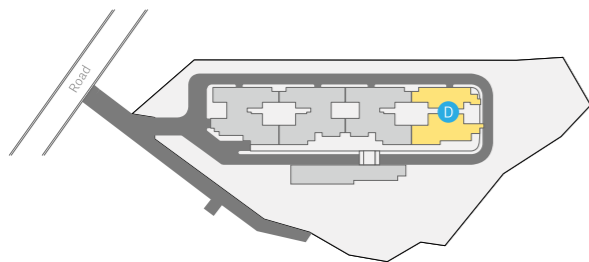

**TYPE D4**  
**4 BHK**  
**SBA - 3118 SQ.FT**

**FLOOR PLANS**



All dimensions in mm  
 SBA rounded upto nearest whole number

Key plan

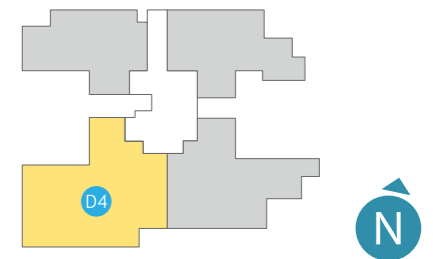
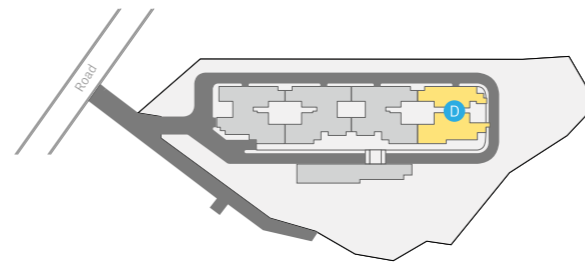

# SPECIFICATIONS

## STRUCTURE

- 4 stilts plus 24 storied structure with RCC walls.
- Covered car parks in Stilt-1, Stilt-2, Stilt-3 & Stilt-4.  
Open car parks at ground level.

## FOYER/LIVING/DINING

- Natural / Engineered stone flooring and skirting.
- Plastic emulsion paint for walls and ceiling.

## BEDROOM

- All bedrooms – Superior quality vitrified tile flooring and skirting.
- Plastic emulsion paint for walls and ceiling.

## TOILETS

- Superior quality ceramic tile flooring.
- Superior quality ceramic wall tiling up to false ceiling.
- False ceiling with grid panels
- Granite vanity counters in all toilets except maid's toilet.

## KITCHEN

- Superior quality ceramic tile flooring.
- Superior quality ceramic wall tiling upto ceiling.
- Plastic emulsion paint for ceiling.

## BALCONIES/UTILITIES

- Superior quality ceramic tile flooring and skirting.
- Parapet/MS/Glass railing as per design
- Plastic emulsion paint for ceiling.
- All walls painted in textured paint.

## UTILITY ROOM

- Ceramic tile flooring and skirting.
- Plastic emulsion paint for walls & ceiling.

## JOINERY

Main Door/ Bedroom Doors

- Frame – Timber
- Architrave - Timber
- Shutters – with both side masonite skin.

Toilet Doors

- Frame – Timber
- Architrave – Timber
- Shutters –with outside masonite and inside laminate

All other external doors/servant toilet door to be manufactured in specially designed heavy-duty powder coated aluminium extruded frames.

Windows/Ventilators

- Heavy-duty powder coated aluminium glazed sliding windows made from specially designed and manufactured sections.

## COMMON AREAS

- Granite/superior quality Vitrified tile flooring.
- Superior quality ceramic tile cladding upto ceiling/false ceiling.
- Plastic emulsion paint for ceiling.
- MS handrail as per design.

## STAIRCASE

- Cement concrete for treads & Risers
- MS handrail.
- Textured Paint for Walls.
- Plastic emulsion paint for ceiling.

## LIFTS

- Total 3 no. of lifts of reputed make per block.
- Capacity - 1 no 15 passenger & 2 no 8 passenger lift.

## LANDSCAPE

- Designer landscaping.

## COMMON FACILITIES

- Well-equipped clubhouse.
- Kids play area.
- Swimming pool.



## SOBHA LIMITED

Headquartered in Bangalore, Sobha Limited is a Rs. 28 billion business conglomerate and one of the largest and the only full-fledged backward integrated real estate player in the country.

Benchmark quality processes, customer centric approaches, robust engineering, in-house research, uncompromising business ethics, and transparency in all spheres of business conduct, have made Sobha India's most admired builder and the most liked real estate brand on social media.

As of June 30th, 2018, SOBHA has completed real estate projects and contractual projects covering about 96.48 million square feet of area. The Company currently has ongoing real estate projects aggregating to 38.48 million square feet of developable area and 26.20 million square feet of saleable area, and ongoing contractual projects aggregating to 9.08 million square feet under various stages of construction.

The Company has a real estate presence in 9 cities, viz. Bangalore, Gurgaon, Chennai, Pune, Coimbatore, Thrissur, Calicut, Cochin and Mysore. Overall, SOBHA has footprint in 26 cities and 13 states across India. Its residential projects include presidential villas, row houses, luxury and super luxury apartments, plotted development and aspirational homes complete with foremost amenities. Among Sobha's corporate clients are Infosys, Taj Group, Dell, HP, Timken, Biocon, Institute of Public Enterprises (IPE), Bosch, Hotel Leela Ventures etc.

Sobha was amongst the first companies in the industry to obtain the ISO 9001 certification. It has also received the OHSAS 18001:2007 and ISO 14001:2004 certifications for Environmental, Health and Safety Management Systems.

### KEY DIFFERENTIATORS

- Backward integration for consistent quality
- In house capabilities that include architectural, mechanical, electrical expertise etc.
- Interior design studio
- Legal support
- Skilled manpower from Sobha Academy trained by German Experts
- Unique pre-handover checks
- Pre-construction study of eco-system for weather friendly design and construction

## INDIA'S MOST CELEBRATED BUILDER

With over 170 prestigious Awards By various reputed institutions.

- 2018 - Asia Real Estate Excellence Award
- Best Real Estate Developer in India
- 2017 - Top Honours in India's First Ever Real Estate Best Practices Audit Report
- 2016 - TMA-HLL CSR Award 2016
- 2015 - No.1 National Realty Brand Across Asset Classes
- 2015 - No.1 Ranked Company in Public Perception
- 2014 - India's Most Admired Builder
- 2014 - Achievement Award For Best Professionally Managed Company
- 2014 - Real Estate Company of The Year
- 2014 - Global Growth Company
- 2013 - India's Builder of The Year
- 2013 - No.1 Realty Brand in Super Luxury Housing Segment
- 2013 - No.1 Realty Brand in Residential Segment
- 2012 - Most Reliable Real Estate Developer
- 2012 - Most Reliable Real Estate Developer