

Rediscover Living at  
**ADVANCE LEGACY**

DOMBIVALI (E)  
JUNCTION OF  
MANPADA & KALYAN  
SHIL ROAD.



RERA REGISTRATION No.  
**P51700021688**  
<http://maharera.mahaonline.gov.in>

**WORK IN FULL SWING**

**KDMC  
AUTHORISED  
SANCTION  
PLAN**



Artistic Impression Image

**PROJECT ADD : ADVANCE LEGACY, SURVEY NO. 65/5A, NEAR VIDYANIKETAN SCHOOL, VILLAGE: MANGAON,  
OFF. UMBARLI ROAD, DOMBIVLI (EAST), TAL.: KALYAN, DIST: THANE.**



**AVAIL PMAY SUBSIDY  
UPTO Rs. 2.67L FOR FIRST  
TIME HOME BUYERS**

**FULLY-RESIDENCIAL PROJECT WITH MORE THAN  
18 LIFESTYLE AMENITIES & FACILITIES**

**1RK, 1BHK, 1BHK+T  
& 2BHK FLATS AVAILABLE**

# PROJECT HIGHLIGHTS



ROOFTOP CLUB AREA



GYM FITNESS

GYMNASIUM



YOGA SPACE



ROOFTOP SITTING AREA



AMPHITHEATER IN GARDEN



GAZEBO STYLE SITTING AREA



CHILDREN PLAY AREA



INTERCOM FACILITY



CCTV SECURITY



REFLEXOLOGY PATHWAY



GENERATOR BACKUP FOR COMMON AREA



OUTDOOR GAMES

• ALL BASIC NEEDS WITHIN 5MINS PROXIMITY LIKE MARKET, SCHOOL, COLLEGE, HOSPITAL, PETROL STATION, BUS STAND, ETC.

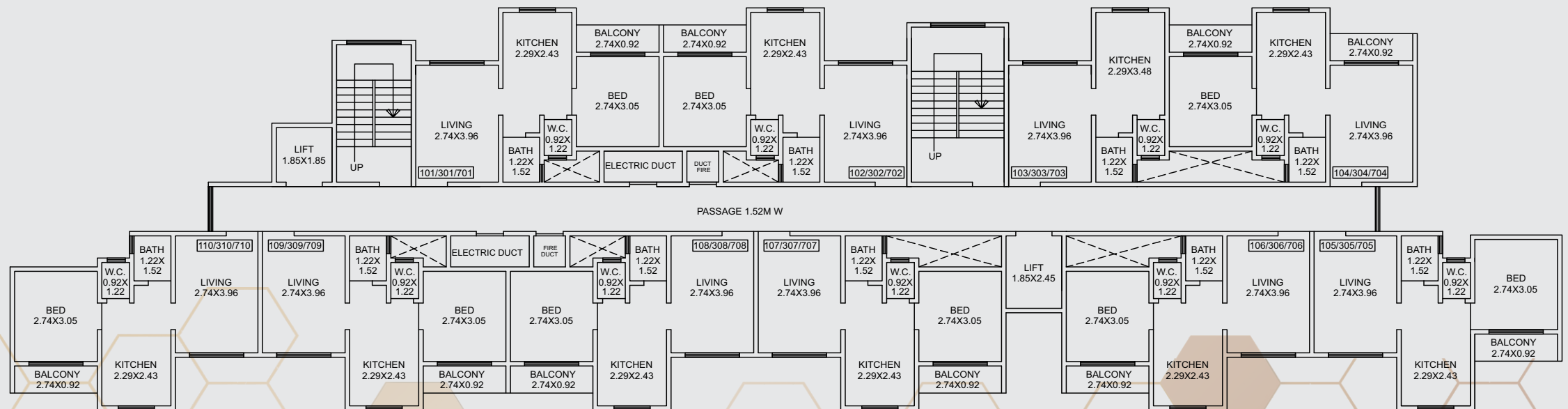

**B Wing - FIRST/THIRD/SEVENTH FLOOR PLAN**

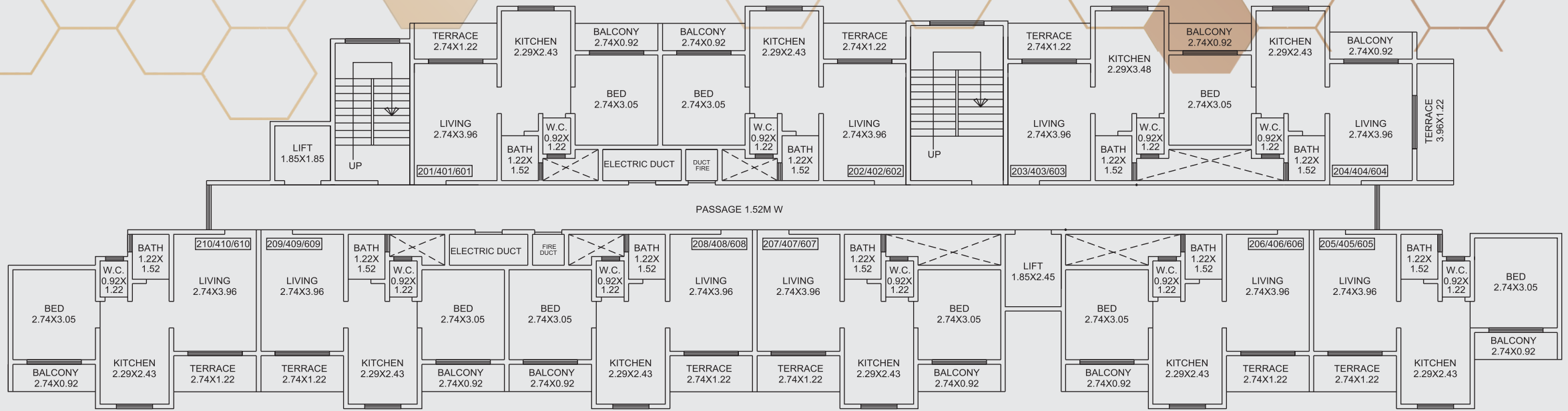

**B Wing - SECOND/FOURTH/SIXTH FLOOR PLAN**

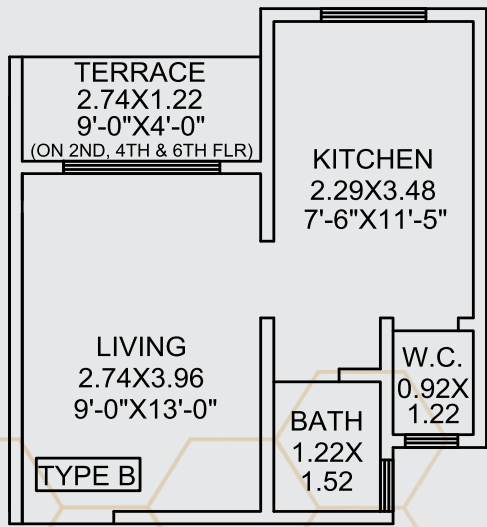

**1RK - STUDIO**

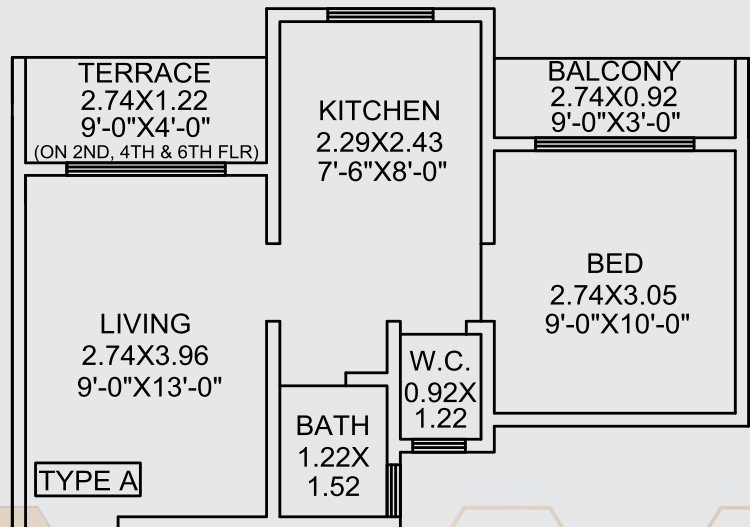

**1BHK - SPACIO**

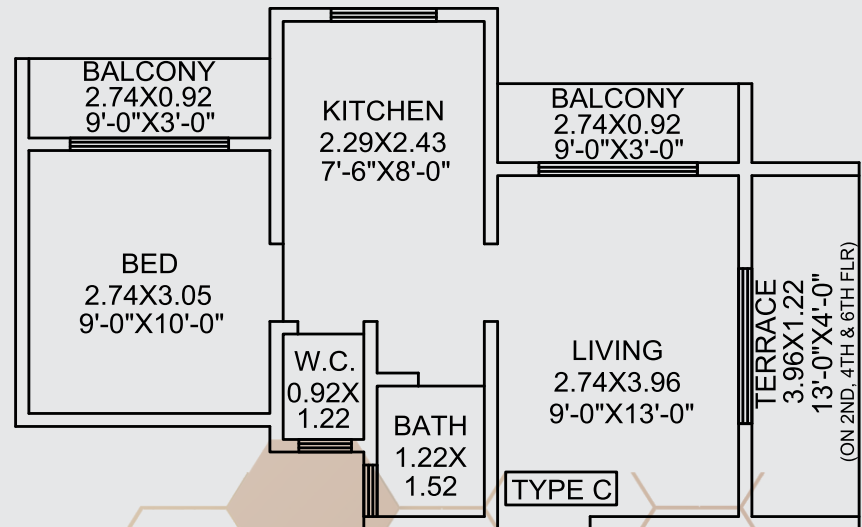

**1BHK - LUXURY**

# AMENITIES & FACILITIES

## FLOORING

24"\*24" Vitrified Flooring In Entire Flat.  
12"\*12" Anti Skid Flooring in Bathroom & W.C.

## KITCHEN

Granite platform with Stainless Steel Sink & Ceramic Tiles Dado in Kitchen.

## DOORS & WINDOWS

Laminated Flush Door with Elegant Handles & locks. WC / Bathroom Doors With Marble Frames & All Other Doors With Wooden Frames  
Powder Coated Aluminium Sliding  
Marble Windows Sills.

## WATER

Under Ground and overhead water tank with water adequate storage capacity in Building

## BATH & WC

Wall Tiles In Bathroom/Toilet Up to Beam Level.  
Concealed Plumbing With good Quality CP Fittings.  
Provision For Hot Water Geyser Point In Bathroom.  
Good Quality C.P. & Sanitary Fittings of Reputed make.

## LIFT

Lift of Reputed Brand

## ELECTRIFICATION

Concealed Good Quality copper wiring with modular switches of ISI brand, TV & Telephone Points In Living Provisions For Refrigerator, Mixer, Aquaguard, Washing Machine & Exhaust Fan Points

## WALLS

Putty / Pop Finish Internal Walls With Acrylic Emulsion Paint. Good quality Paints to External Wall.

We Are Proud Members Of:



Marketed by



*Bricking • Transforming • Civilizing*

**ADVANCE HOME MAKERS PRIVATE LIMITED**

**RERA REGISTRATION NO. : A51700020090**

**Developer :**

**Mr. Ramesh D. Shah**

**Office Address**

108, Shreedhar Apartments,  
Maulana Azad Road, Dombivali (East),  
Thane - 421201.

**Architects & RCC Consultants :**

**M/s. Bhirud And Associates**

**Follow us around the web!**

 [facebook.com/advance.groups](https://facebook.com/advance.groups)

 [instagram.com/advance.groups](https://instagram.com/advance.groups)

**For Booking Contact**

**88988 18888**

**Web: [www.advancegroups.in](http://www.advancegroups.in)**

**E-mail: [sales@advancegroups.in](mailto:sales@advancegroups.in)**

**Disclaimer:** The pictures & information contained in this information memorandum could undergo a change if sanctioned plans and / or other circumstances change. For a detailed disclosure please visit the MAHARERA website under MAHARERA Registration no. P51700021688 and / or contact the sales team on Ph: 8898 818888 before taking final decision.