

*Experience the Goa's
country side*



Saldanha
Keshia Villas
ANJUNA - GOA



2 BHK Villas



Saldanha
Keshia Villas

Discover a charmed life in a lavish one level home, designed to make you feel like a royal.

Offering four exclusive designed single level detached/semidetached homes with luxurious interior and elegant exteriors in an quiet quaint village within Anjuna.

Saldanha
Keshia Villas
ANJUNA - GOA

Life is convenient at Keshia Villas, located at Oneachem Bhat, Anjuna. This new development is within 15 minutes of many conveniences, like Baga beach, Calangute beach, Morjim & Mapusa city. Included at no extra cost are premium flooring, stylish upgrades like Jaquar bathroom fittings etc. Keshia Villas infuse life with beauty and convenience and offer you exceptional value.

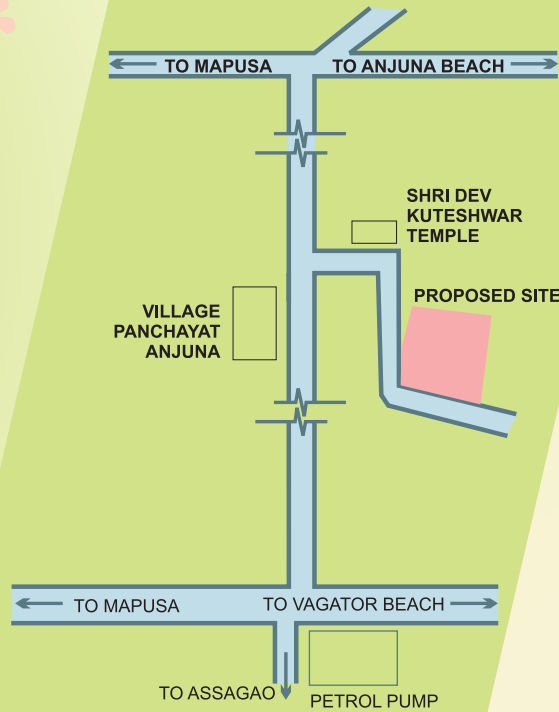

Distances from the Project :
To Anjuna Beach - 1.5 Km.
To Mapusa - 6 Kms.
To Panaji - 18 Kms.
To Thivim Rly Station - 9 Kms.
To Dabolim Airport - 40 Kms.



Enjoy beautiful Nature and breezy Cost

Features

- Conveniently located connecting Mapusa.
- Covered car parking.
- Vitrified flooring for all room, with Anti skid tiles for bathroom, with hot and cold water arrangements.
- Ceramic / Vitrified flooring.
- Marble sills.
- Designer tiles for bathrooms, coloured sanitaryware & hot/cold water arrangement.
- Granite kitchen platform with Stainless Steel Sink.
- Teak Wood pannelled main door with brass fittings, other doors to be of teak wood frame with marine ply panel, windows of teak wood / sliding Aluminium / UPVC.
- Concealed electrical conduits with necessary plug/power/AC points
- Cable T.V. provision.
- Interiors with acrylic distemper & Exteriors with weather protective Paints.
- CPVC Rust-free plumbing.

Amenities

- 24.Hrs. Security.
- Gated Complex.

Saldanha

Keshia Villas

Site Plan

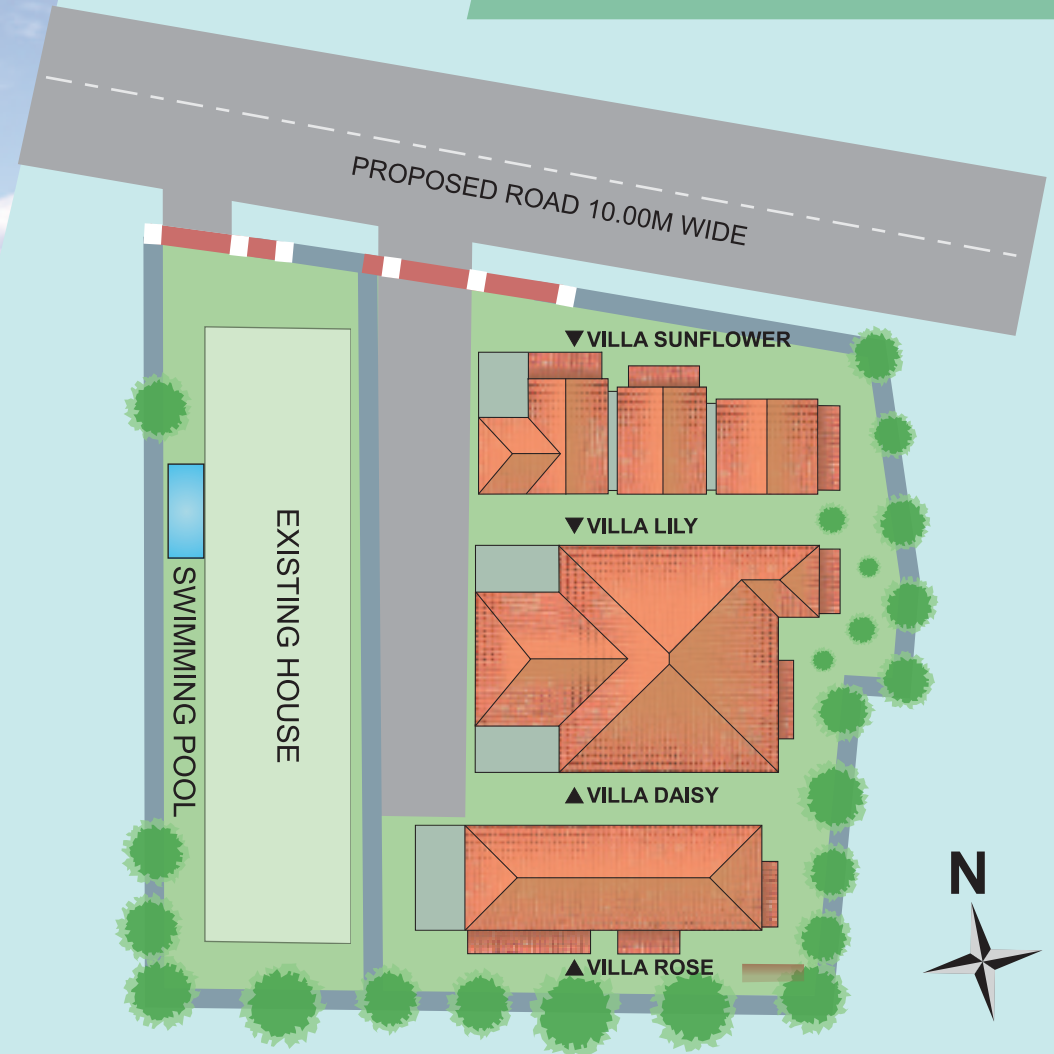

Villa - Lily & Daisy

| Unit No. | S. B. Area | Carpet Area | Patio |
|-------------|-------------|-------------|-----------|
| VILLA LILY | 102.87 Sqm. | 78.71 Sqm. | 5.36 Sqm. |
| VILLA DAISY | 91.70 Sqm. | 68.80 Sqm. | 6.37 Sqm. |

GROUND FLOOR

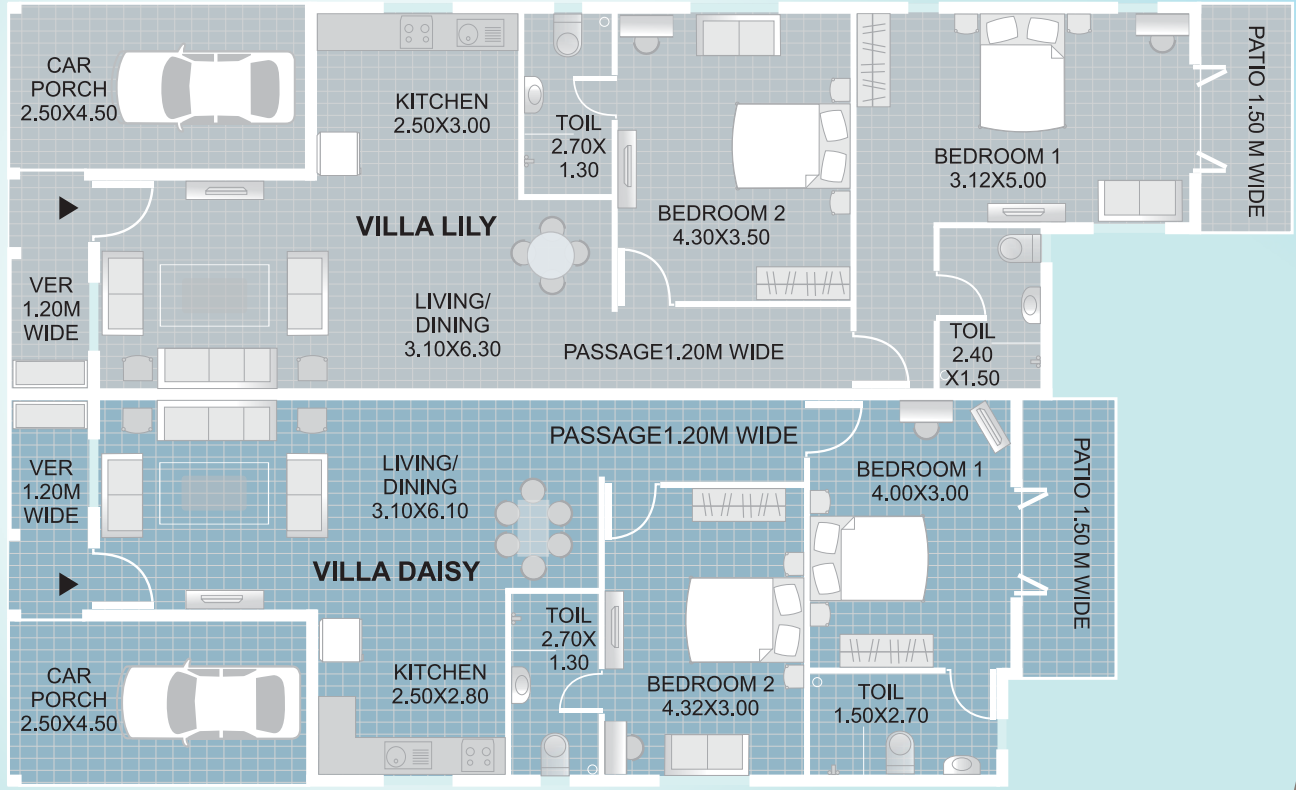

Villa Sunflower

S. B. Area

Carpet Area

Patio

94.69 Sqm.

72.07 Sqm.

17.87 Sqm.

GROUND FLOOR

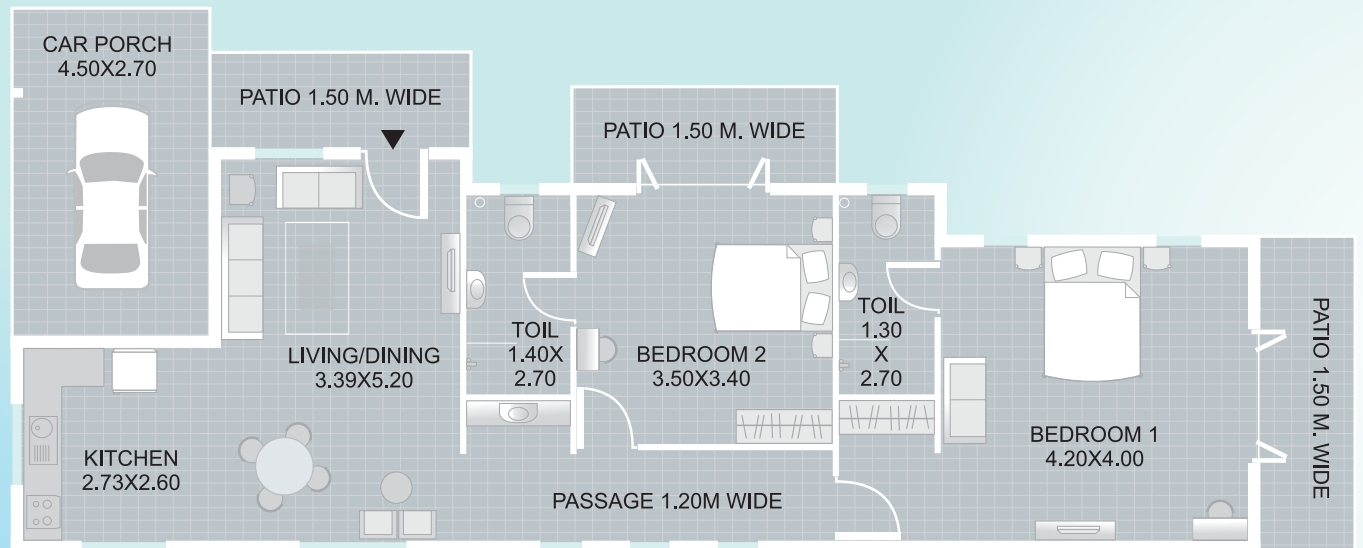

Villa Rose

| | | |
|------------|-------------|------------|
| S. B. Area | Carpet Area | Patio |
| 87.59 Sqm. | 62.53 Sqm. | 21.79 Sqm. |

GROUND FLOOR

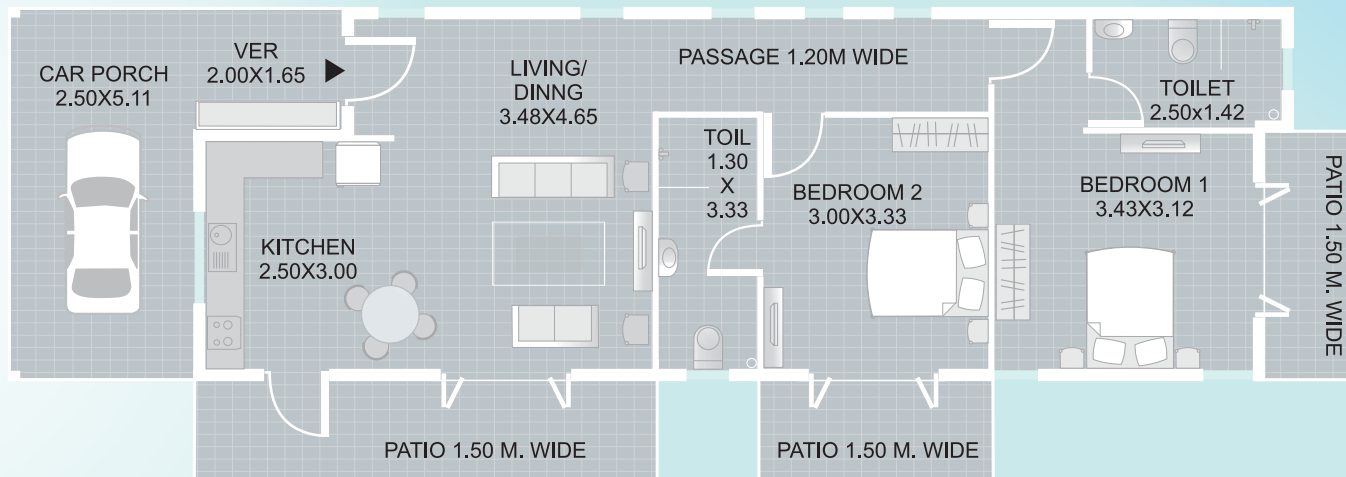

Saldanha
Keshia Villas





We invite you... call us today and reserve your private appointment for this exceptional new residential opportunity.

We take pride in providing a truly valuable real estate to be your next home, and we make it part of our commitment to provide sustainable real estate development, balancing development with environment care and social responsibility.



Head Office:

302, Mathias Plaza, 18th June Road, Panaji - 403 001, Goa, India
Tel: (0832) 2224485, 2220568 / 69
Mob: (91) 8888816923
E-mail : sales@saldanhagroup.com

DS - 1, 2, Pancharatna, Martires Dias Road Margao - 403 601, Goa, India
Tel : (0832) 2733576, 2737330
E-mail : margao.office@saldanhagroup.com

5/6, Pawan Palace, Sitladevi Temple Road, Mahim - 400 016, Mumbai
Tel : (022) 24314300 / 301
E-mail : mumbai.office@saldanhagroup.com

Web Site : www.saldanhagroup.com

Rera No. not applicable as total number of units are less than 8.



This is not a legal offering and all plans and visuals are an artists impression and subject to revision.

On Going Projects

