



ONE DREAM

ONE DREAM



6.50 M WIDE  
ENTRY/EXIT

**20.00 MT WIDE ROAD**

6.50 M WIDE  
ENTRY/EXIT

NOTE: ALL PLANS SHOWN ARE TENTATIVE AND ARE SUBJECT TO CHANGE AS PER PLANNING, STRUCTURAL FEASIBILITY & STATUTORY APPROVALS.

**CAR PARKS = 191**

**PROJECT**  
PLOT NO.D-225&D-226  
MIDC

**DEVELOPER**  
MR.DARPAN

**CONTENT**  
GROUND FLOOR PLAN

**DATE**  
26-07-2019  
**DRAWN BY** NISHA  
**CHKD BY** OMI

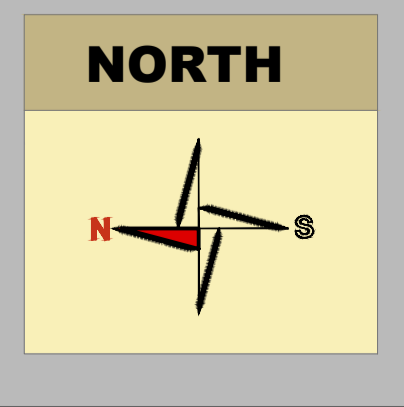

**stadi**  
soyuz talib architects  
1406, Kesar Solitaire, Palm Beach Road  
plot no. 5, sector 19, Sanpada, Navi Mumbai  
Ph. No. 27810762 / 63

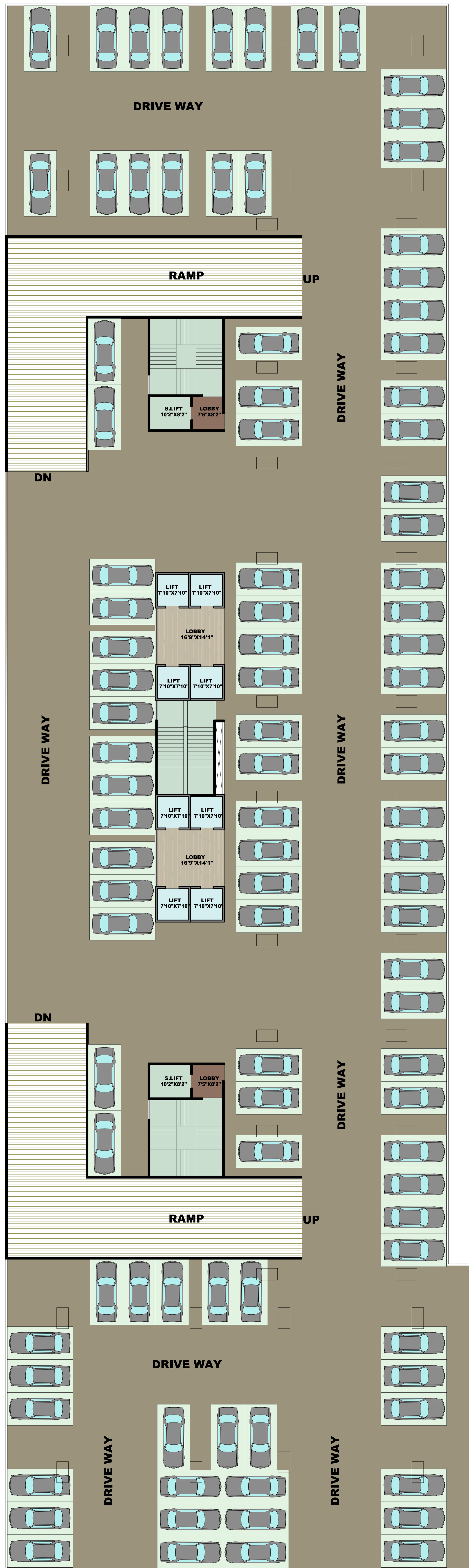

NOTE: ALL PLANS SHOWN ARE TENTATIVE AND ARE SUBJECT TO CHANGE AS PER PLANNING, STRUCTURAL FEASIBILITY & STATUTORY APPROVALS.

20.00 MT WIDE ROAD

CAR PARKS = 100x4 = 400

PROJECT

PLOT NO.D-225&D-226  
MIDC

DEVELOPER

MR.DARPAN

CONTENT

1ST,2ND,3RD&4TH FLOOR PLAN

DATE

26-07-2019

DRAWN BY CHKD BY

NISHA OMI

NORTH

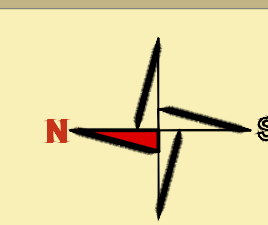

**stapl**

soyuz talib architects  
1406, Kesar Solitaire, Palm Beach Road  
plot no. 5, sector 19, Sanpada, Navi Mumbai  
Ph. No. 27810762 / 63

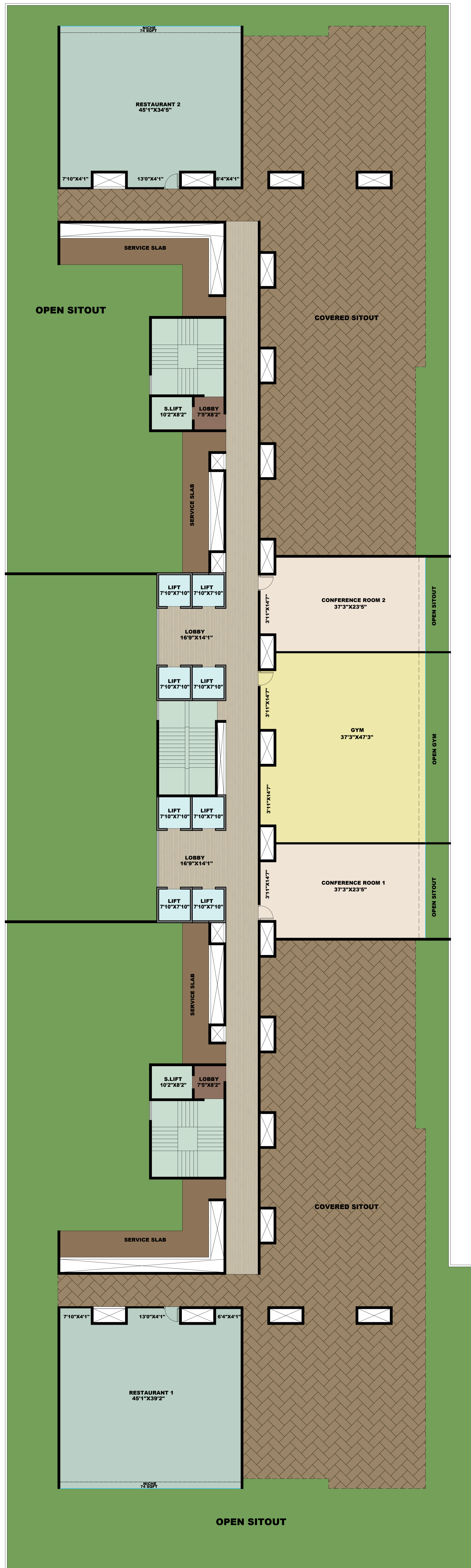

NOTE: ALL PLANS SHOWN ARE TENTATIVE AND ARE SUBJECT TO CHANGE AS PER PLANNING, STRUCTURAL FEASIBILITY & STATUTORY APPROVALS.

20.00 MT WIDE ROAD

**PROJECT**  
**PLOT NO.D-225&D-226**  
**MIDC**

**DATE**  
 22-07-2019  
**DEVELOPER**  
**MR.DARPAN**

**CONTENT**  
**5TH FLOOR PLAN**

**DRAWN BY**  
 NISHA  
**CHKD BY**  
 OMI



**stapl**  
**soyuz talib architects**  
 1406, Kesar Solitaire, Palm Beach Road  
 plot no. 5, sector 19, Sanpada, Navi Mumbai  
 Ph. No. 27810762 / 63



20.00 MT WIDE ROAD

NOTE: ALL PLANS SHOWN ARE TENTATIVE AND ARE SUBJECT TO CHANGE AS PER PLANNING, STRUCTURAL FEASIBILITY & STATUTORY APPROVALS.

<p><b>PROJECT</b> PLOT NO.D-225&amp;D-226 MIDC</p>	<p><b>DEVELOPER</b> MR.DARPAN</p>	<p><b>CONTENT</b> TYPICAL FLOOR PLAN 6,8,9,10,12,13,14,16,17,18,20&amp;21</p>	<p><b>DATE</b> 22-07-2019</p> <p><b>DRAWN BY</b> CHKD BY NISHA OMI</p>	<p><b>NORTH</b></p>	<p><b>stapl</b> soyuz talib architects 1406, Kesar Solitaire, Palm Beach Road plot no. 5, sector 19, Sanpada, Navi Mumbai Ph. No. 27810762 / 63</p>
--	---------------------------------------	---	--	---------------------	---



20.00 MT WIDE ROAD

NOTE: ALL PLANS SHOWN ARE TENTATIVE AND ARE SUBJECT TO CHANGE AS PER PLANNING, STRUCTURAL FEASIBILITY & STATUTORY APPROVALS.

<p><b>PROJECT</b> PLOT NO.D-225&amp;D-226 MIDC</p>	<p><b>DEVELOPER</b> MR.DARPAN</p>	<p><b>CONTENT</b> REFUGE FLOOR PLAN 7,11,15&amp;19</p>	<p><b>DATE</b> 22-07-2019</p> <p><b>DRAWN BY</b> CHKD BY NISHA OMI</p>	<p><b>NORTH</b></p>	<p><b>stapl</b> soyuz talib architects 1406, Kesar Solitaire, Palm Beach Road plot no. 5, sector 19, Sanpada, Navi Mumbai Ph. No. 27810762 / 63</p>
--	---------------------------------------	--	--	---------------------	---



NOTE: ALL PLANS SHOWN ARE TENTATIVE AND ARE SUBJECT TO CHANGE AS PER PLANNING, STRUCTURAL FEASIBILITY & STATUTORY APPROVALS.

20.00 MT WIDE ROAD

PROJECT

PLOT NO.D-225&D-226  
MIDC

DEVELOPER

MR.DARPAN

CONTENT

23RD FLOOR PLAN

DATE

22-07-2019

DRAWN BY CHKD BY

NISHA OMI

NORTH

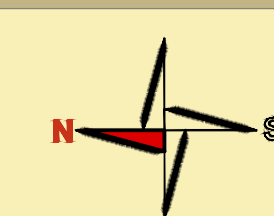

**stapl**  
soyuz talib architects  
1406, Kesar Solitaire, Palm Beach Road  
plot no. 5, sector 19, Sanpada, Navi Mumbai  
Ph. No. 27810762 / 63



20.00 MT WIDE ROAD

NOTE: ALL PLANS SHOWN ARE TENTATIVE AND ARE SUBJECT TO CHANGE AS PER PLANNING, STRUCTURAL FEASIBILITY & STATUTORY APPROVALS.

**PROJECT**  
PLOT NO.D-225&D-226  
MIDC

**DEVELOPER**  
MR.DARPAN

**CONTENT**  
22ND & 24TH FLOOR PLAN

**DATE**  
22-07-2019

**DRAWN BY** CHKD BY  
NISHA OMI

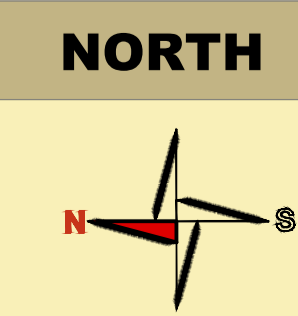

**stapl**  
soyuz talib architects  
1406, Kesar Solitaire, Palm Beach Road  
plot no. 5, sector 19, Sanpada, Navi Mumbai  
Ph. No. 27810762 / 63