

N Site Location Plan

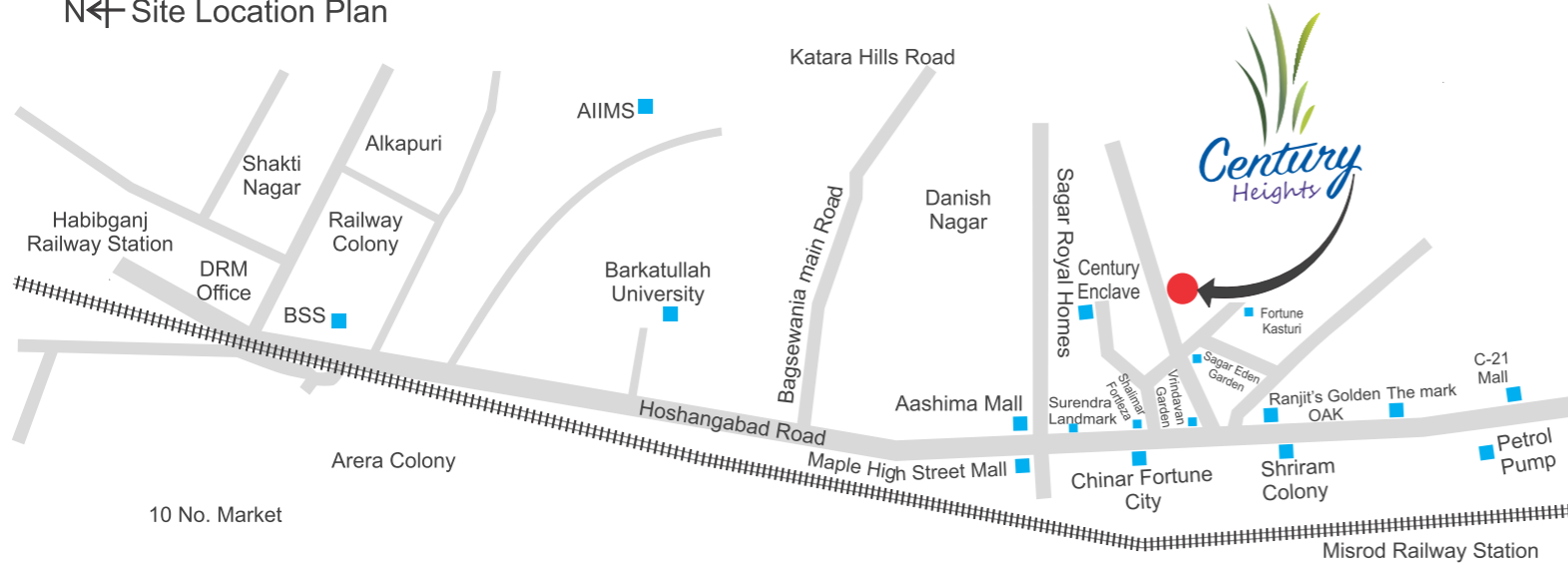

Architects:
J. Malkan
 Tel.: 2458349, 4289094

Structure by:
Apoorv Dhonde & Associates
 Cell.: +919826116636



M-2/1, Amber Complex, Zone-II, M.P. Nagar, Bhopal-462011(M.P) India
 Tel.: 0755-2574527, 2558584. Cell.: 83493 01200, 83493 01300
 www.centurybuildersbhopal.com • Email: centurybuildersbhopal@gmail.com

MP RERA No.: P-BPL-17-395

Khausa Creatives, 8518080050

Prepare for a better lifestyle



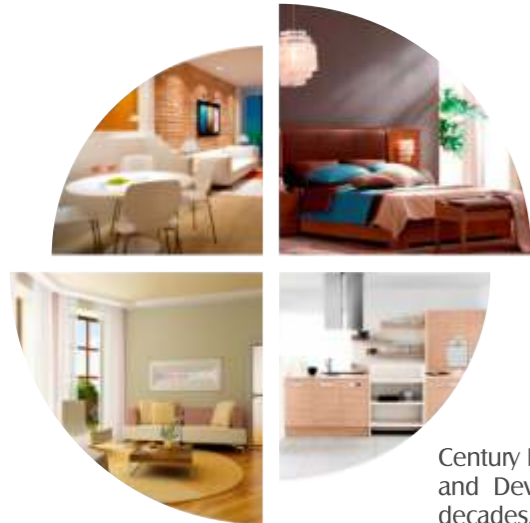

Century
Builders & Developers

Century Heights is brought to you by the reputed Century Builders and Developers, involved in the construction sector for more than two decades. Our projects are dedicated towards providing quality services to our customers.

Distinctive ideology, ingenious tactics, smart work and skilled workmanship are incorporated within our ideals that have won the confidence of customers and strengthened our bond of trust.

Century Builders & Developers have consistently received overwhelming response for all our projects which has inspired us to give your family our best work.

It is our assurance of professionalism, class construction and supreme value for your hard-earned money.

Century Heights is located in 10 minutes away from ISBT, Habibganj Railway Station and major commercial area of M.P. Nagar. In vicinity are Ashima mall, Maple Street Mall and Capital Mall.

Our Successfully Completed standing Band Marks

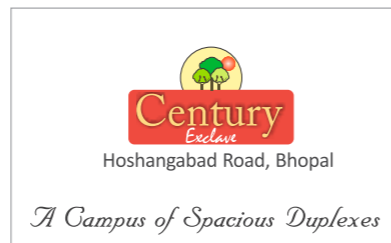

Century Heights is located at **Hoshangabad Road**, a very prime location and the hub of activities. Glorious neighbourhood with several residential project, education institutes, shopping malls, cineplexes, commercial complexes and restaurants existing nearby makes the project more convenient and exciting place to dwell. Being situated on a 80 feet wide road, provides convenient connectivity.

**Century Heights is a building like no other.
It is singular in terms of style,
architecture amenities and facilities.**

The ideal representation of contemporary living space, that offers ample of things to cherish, and compromises at nothing with. Here, at Century Heights every detail is crafted to enhance your lifestyle with modern amenities and to give you exalted feel of space and comfort. We invite you to live your dreams and make this space yours providing you with a varied choice of luxurious 3/4 BHK apartments, Triplex & Duplex Bungalows.



High Life Amenities

Every Flat is Corner Flat

- Freehold residential property.
- Ultra modern infrastructure development standards.
- Wide road/paving block and side drains.
- Underground cabling.
- Fire fighting system in each tower.
- Play area for children.
- CCTV surveillance system (24x7).
- Separate washroom for drivers and servants in apartment.
- Power backup for common areas.
- Convenient shopping.
- Landscaped campus with lush green developed gardens.
- Two Lifts in each tower with power backup.
- Health club with the latest state of art machines.



Club House

We have incorporated excellent amenities to make your everyday living special. Start your day with a range of physical activities at our AC gym, yoga and meditation centre and boost your energy for a busy day ahead. The beautiful covered Indoor games like pool and table tennis will definitely help you to live life exactly the way you want.



3 BHK Floor Plan



4 BHK Floor Plan

Specifications

STRUCTURE

Earthquake resistant RCC frame structure with isolated footing.

WALL FINISH/CEILING FINISH

Internal washable acrylic emulsion paint exterior weather proof paint, POP cornice.

KITCHEN

Granite platform with stainless steel sink, DADO ceramic tiles above platform upto 2'.

WINDOWS

Power coated sliding aluminum glazed windows with mosquito net & security.

INVERTER

Provision for exclusive electric circuit point for automatic power backup.

TV/TELEPHONE POINTS

TV/Telephone connection point in drawing room & all bedrooms.

OPTIONAL

Modular kitchen with overhead cabinet and chimney.

AC POINTS

Provision for AC point in bedrooms and drawing room.

WALLS

Quality bricks with plaster finish.

FLOORING

2'x2' vitrified tiles flooring in living areas & anti-skid ceramic tiles in toilets, balcony, wash.

TOILET

DADO ceramic glazed tiles full height, fine quality chrome plated fittings, ISI mark.

DOORS

Both side laminated flush door finish with lock & SS premium hardware. Provision for fly mesh shutter on the entrance door.

ELECTRICAL

Concealed copper electrical wiring for all lights & power points & ISI marked electrical fitting.

WATER SUPPLY

Concealed CPVC / UPVC / GI pipeline with a hot and cold mixer in toilets and wash basin and 1000 ltr. water tank on terrace for each unit.

UTILITY POINTS

Provision for microwave, fridge, food processor geyser power point.

Family Home within a gated community



Triplex Bungalows

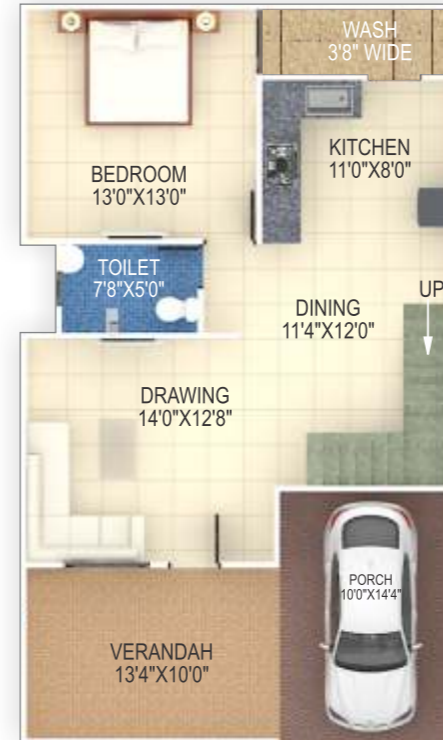

Ground Floor Plan



First Floor Plan



Second Floor Plan



It deserves a personal inspection to be fully appreciated



Duplex Bungalows

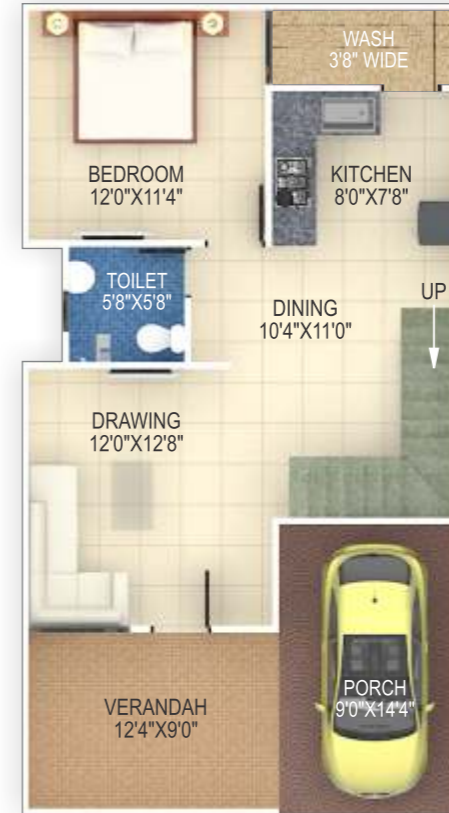

Ground Floor Plan



First Floor Plan

Elevation of Elegance

