





DSR
SUNRISE
TOWERS

SPACIOUS 3 BHK APARTMENTS @ HOPE FARM, WHITEFIELD, BENGALURU



an artistic impression of Sunrise Towers Gate view



WHERE STYLE,
SIMPLICITY
AND SPACIOUSNESS
COME STANDARD



The design and aesthetic appeal of DSR Sunrise Towers is matchless. Located at Whitefield, Bengaluru, it fully lives up to all your expectations. The strength of this upscale residential project lies in its practicality. It manages to create a fine balance between luxury and convenience so that the experience of living here is truly memorable. The warm ambience and attention to detail inside and the lively and pleasant ambience outdoors complete the picture-perfect setting.

SITE LAYOUT PLAN



WHERE TRUE LUXURY HEIGHTENS THE SENSE OF GRACE AND GRANDEUR



The inspiring concept of *Walk to Work* has resulted in the rise of DSR's Sunrise Towers. It's a perfect example of living ceremoniously amidst a setting that makes walking to work a reality, while cutting away long distance woes and snarling traffic problems. The project's contemporary design is awe-inspiring and creates an easy sense of belonging.

Sunrise Towers Community Features

- Total Area 2.9 Acres
- B+G+14 Upper Floors
- Total 228 Spacious Apartments in Four Blocks
- All 3BHK Apartments ranging from 1630 sq.ft to 2005 sq.ft
- Hi-Tech Video Door Phone with Intercom and guard phone
- Water Treatment Plant for Borewell Water
- Centralised Piped Gas System
- Laminated Wooden flooring in master Bedroom
- Generator Backup
- Water Cascade
- CC Camera Security Monitoring
- Excellent Landscaping
- Car Wash Area



an artistic impression of DSR Sunrise Towers areal view



VAST, WELCOMING EXPANSES OF NATURAL SPLENDOUR

75%
open
spaces

Shake off the concrete jungle concerns. With 75% of open spaces at DSR Sunrise, there are vast, welcoming expanses of natural splendour. The lush landscaping, in addition, gives growth to a new level of tranquillity. And if you are looking for good quality leisure time, worry not – there are many outdoor games to keep you blissfully occupied. With so much greenery to take nourishment from, the mere jogging too will be transformed into an everyday refreshing experience.



ISOMETRIC FLOOR PLAN



Wing-1 Flat 4 1645sft.

S.No	Description	Area
1	Vestibule	5'8"X8'0"
2	Living	11'2"X15'2"
3	Sit-Out	11'2"X7'4"
4	Dining	10'4"X10'0"
5	Kitchen	11'2"X9'10"
6	Utility	4'3"X7'6"
7	Toilet (LIV)	4'11"X11'0"
8	M. Bed Room	12'1"X14'6"
9	M.Toilet	4'11"X8'0"
10	Sit-Out	5'5"X6'0"
11	Bed Room-1	10'2"X12'2"
12	Bed Room-2	11'6"X12'2"
13	Toilet	5'0"X8'0"



ISOMETRIC FLOOR PLAN



Wing-1 Flat 4 2005sft.

S.No	Description	Area
1	Drawing	12'2"X11'4"
2	Living	19'2"X11'2"
3	Sit-Out	5'4"X11'4"
4	Dining	11'0"X11'10"
5	Kitchen	9'0"X11'6"
6	Utility	4'3"X 10'3"
7	M.Bed Room	14'8"X12'0"
8	M.Closet	4'10"X7'4"
9	M.Toilet	5'0"X8'6"
10	Sit-Out	7'2"X13'8"
11	Bed Room-1	13'0"X12'0"
12	Toilet	8'0"X5'0"
13	Bed Room-2	11'4"X14'0"
14	Toilet	5'0"X9'8"





an artistic impression of DSR Sunrise Towers areal view



CLUB HOUSE

Multipurpose Hall connected
With Outdoor Party Lawn

Swimming Pool

Gym

Children's Play Area

Jogging Track

Badminton Court

Tennis Court

Basketball Court

Indoor Games

Central Landscaping

Maintenance Office

AREA STATEMENT
(areas in sft)

	Wing 1	Wing 2	Wing 3	Wing 4
Flat # 1	1850	Flat # 1 1725	Flat # 1 1630	Flat # 1 2005
Flat # 2	1715	Flat # 2 1790	Flat # 2 1640	Flat # 2 2005
Flat # 3	2005	Flat # 3 1640	Flat # 3 1860	Flat # 3 1725
Flat # 4	2005	Flat # 4 1645		Flat # 4 1850
		Flat # 5 1705		

FIRST FLOOR PLAN

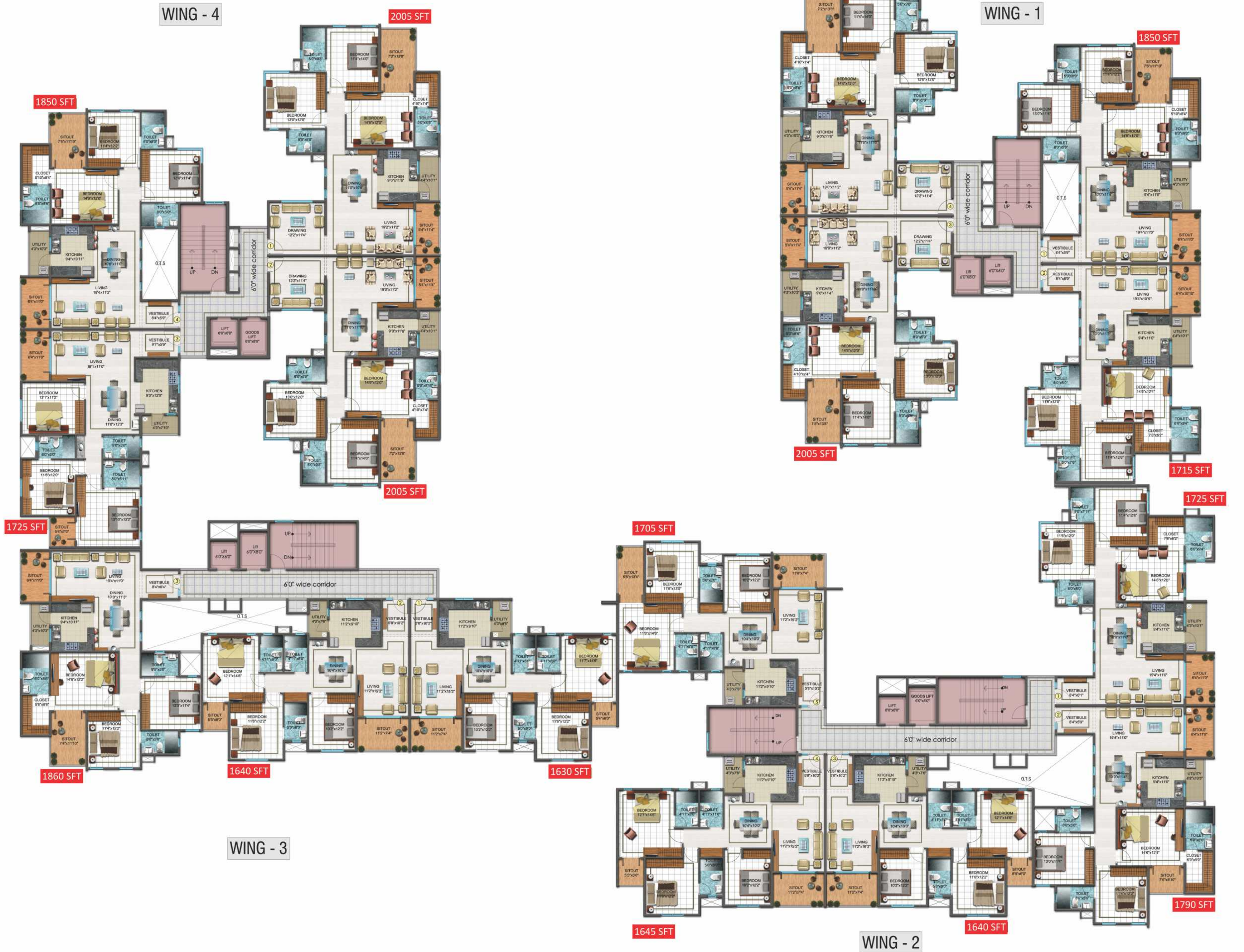

CLUB HOUSE (GROUND+ ONE FLOOR)



an artistic impression of DSR sunrise towers club house pool side view

**WHERE THE JOURNEY TO
RELAXATION BEGINS
EACH NEW DAY...**

Life's essence is in living it to its fullest. At DSR Sunrise Towers, living luxuriously is a way of life and the leisure facilities are replete with all the aspects of quality lifestyle. The clubhouse is one such exclusive space where you can bring out the socialite in you and meet and greet people who matter. You can also sweat it out at the ultra-modern gym, splash in the cool waters at the pool - simply savour a lifestyle that's characteristically yours.



CLUB HOUSE GROUND FLOOR PLAN



CLUB HOUSE FIRST FLOOR PLAN



WHERE THE ITPB IS JUST 5 MINUTES BUT A WORLD AWAY

"Bengaluru is the I.T capital of South India which has been a dream destination for all. Whitefield is Bengaluru's original I.T hub which houses some of the biggest names in the information technology world. Its home to techies from all over the world and that's one of the reasons for the overall development of whitefield area as the most favoured destination for residential space. While top I.T companies are just 5minute drive away at ITPB and others, top shopping malls, multiplexes for recreation, super specialty hospital and star hotels are also present here.



LOCATION MAP (NOT TO SCALE)



LOCATION ADVANTAGE

- 400 mtrs from Hope Farm Junction
- 2.2 KM from ITPL
- 2.5 km from Whitefield Railway Station
- 3.5 km from Shantiniketan Forum Mall
- 7 km Phoenix Market city
- 3 km from Forum Value Mall
- 3.5 km from Sri Satya sai super Speciality Hospital
- 4 km from Vydehi Hospital
- 100 mtrs from Whitefield Global School
- 8 km from Ryan International School

specifications

R.C.C. Framed Structure	:	To Withstand Wind & Seismic loads.
Super Structure	:	Solid Block Masonry in cement Mortar (1:6) prop.
Plastering	:	Two Coats of plastering with smooth finishing
Doors		
Main door	:	Teak Wood Frame & aesthetically designed shutter with melamine polishing and S.S. hardware of reputed make.
Internal Door	:	Moulded Acasia wood door frames (Engineered Wood) & both side Teak Veneer designed flush doors with melamine polishing and reputed make S.S. hardware fittings.
French Doors	:	U.P.V.C. Glass Sliding Door.
Windows	:	UPVC sliding with safety grills.
Painting		
External	:	One coat of texture Paint and two coats of Asian Apex / ICI Weather Shield or equivalent make.
Internal	:	Smooth Luppum finish with Acrylic emulsion paint over a coat of primer.
Flooring		
Master Bed Room	:	Laminated Wooden Flooring
Other Bedrooms, Living, Dining & Kitchen	:	Vitrified tiles (800x800) size
Bathrooms & Balcony	:	Acid resistant Anti-Skid Ceramics Tiles
Tiles Cladding & Dadoing		
Kitchen	:	Glazed Ceramics Tiles dado upto 2ft height above kitchen platform.
Bathroom	:	Glazed ceramic tiles (Tile size 12"X18") dado of reputed make up to door height for all toilets except master toilet (12"X24")
Utilities/Wash	:	Glazed ceramics tiles dado up to 3ft height.
Kitchen	:	Granite platform with Stainless steel sink with Softened treated water connection & provision for water purifier
Utilities/wash	:	Provision for washing machine, wet area for washing utensils etc.
Toilets	:	All Toilets will consist of KOHLER make or equivalent : <ul style="list-style-type: none"> ● Wash basin with half pedestal. ● Wall mounted Water closet with concealed tank ● Hot and Cold Single Lever diverter with head and hand shower for master toilet and single lever diverter with head shower for other toilets. ● Provision for geysers. ● All C.P. Fittings are chrome plated
Electrical	:	Concealed copper wiring through conduits for lights, fans, plug and power plug wherever necessary of Havells / Anchor or equivalent make. <ul style="list-style-type: none"> ● Power outlets for Air-Conditioners in all bedrooms. ● Power outlets for geysers in all Toilets. ● Power plug for cooking range chimney, refrigerator, micro wave oven, mixer / grinders in kitchen. ● Plug points for T.V. in Living and all the bed rooms. ● Miniature Circuit Breakers (MCB) & ELCB for each distribution boards of Havells or equivalent make. ● All electrical accessories / Switches of Schneider or equivalent make ● Telephone point in all the Bedrooms and living room ● Intercom facility to all the units connecting to security, clubhouse and other common areas.
Tele- Communication		
Piped Gas	:	Piped Gas facility to all apartments with Gas Bank
Cable T.V.	:	Provision for cable connection in Master Bedroom & Living room.
Lifts	:	Branded 8 /13 Passengers / Service lifts with entrance of Granite/Marble cladding.
Generator	:	Acoustic enclosed D.G. Set, back-up 100% for common areas, 1000 watts for each apartment.

Specification Disclaimer

- DSR Infrastructure Pvt. Ltd. Reserves the right to change specification without prior notice in the interest of quality.
- Please note that any changes made will not in any way be detrimental to the quality of the building.
- The furniture including woodwork are shown to indicate the space available.



CRAFTING PROPERTIES OF ARCHITECTURAL DISTINCTION IN SOUGHT-AFTER LOCATIONS

DSR Group Since 1988, has been crafting properties of architectural distinction in the sought-after locations, across South India. Owing to its initiatives, it has established a reputation for excellence and an inspiring portfolio of prestigious projects that are distinctly designed and ceremoniously crafted. DSR Group demonstrates the ability to craft homes that are in sync with the environment and perfectly meet the aspirations of the discerning clientele.



SPRING BEAUTY, BROOKEFIELDS, BENGALURU

A FEW COMPLETED PROJECTS

IMAGES SHOWN ARE SHOT AT LOCATION



ELITE, OFF. OUTER RING ROAD, BENGALURU



FORTUNE TOWERS, MADHAPUR, HYDERABAD



FORTUNE ENCLAVE, BANJARA HILLS, HYDERABAD

A FEW ONGOING PROJECTS



WOOD WINDS, SARJAPUR ROAD, BENGALURU



ULTIMA, OFF. SARJAPUR ROAD, BENGALURU

Do you want to leave behind the humdrum of city living?
Do you want distinctive style with down-to-earth simplicity?
Do you want to live the resort-like life at home?

At DSR Sunrise Towers
Whitefield, Bengaluru lie your answers !

a project of



INFRASTRUCTURE PVT. LTD.
Cementing Dreams Since 1988

AN ISO:9001:2008 CERTIFIED COMPANY

DSR Diya Arcade, # 220, 1st Floor, 9th Main, HRBR Layout
1st Block Extn., Kalyannagar, Bengaluru - 560 043.
Email: sales@dsrinfra.com, www.dsrinfra.com

Call : +91 80 4130 9797/93/94
+91 98458 66113 / 77609 69305

ARCHITECTS



GENESIS PLANNERS PVT. LTD.

Plot. No. 559, Road No. 92, Phase-III, Jubilee Hills, Hyderabad - 500 033, India.
Ph : +91 40 6697 7777, Fax : +91 40 2355 5549 E-mail : info@genesisplanners.in

LANDSCAPE ARCHITECTS



NAVEEN ASSOCIATES

8-2-270/C, Srinikethan Colony, Road No. 3, Banjara Hills, Hyderabad - 500 034, India.
Ph : +91 40 2354 6966, E-mail : naveen@naveenassociates.com

NOTE: This brochure is only a conceptual presentation and not a legal offering. The promoters reserve the right to make changes in elevation, plans and specifications as deemed fit.