

BHOOMI  
*Harmony*

Your world of graceful living is for the asking



Developers



**C. J. GROUP & GAJRA'S**

BHOOMI TOWER, SHOP NO. 1, PLOT NO. 28,  
SECTOR-4, KHARGHAR, NAVI MUMBAI. Tel.: 6522 4433

Architect  
TRIARCH

NOTE: \* The developers reserve the right to change plans, specifications and features without prior notice or obligation, at their sole discretion.  
\* Specification, write up, internal layout, pictures shown in this booklet are only indicative.



Happiness is nothing but harmony of the mind!  
Turn these pages to discover it!



Plot No. 17, Sector-35-I, Kharghar, Navi Mumbai



May the good lord shower his choicest blessing on you!



CENTRAL PARK

**CENTRAL PARK**

Central Park lives up to its name. It lies in the heart of Navi Mumbai and at the core of Kharghar. This vast expanse of picturesque space, resembling an international park, is a link between the hills surrounding Kharghar and the creek.

It also holds the prospects of being a vital link between you and a host of interesting outdoor activities. Some of them being joggers track, botanical garden, amphitheatre, theme park and a modern sports stadium.



KHARGHAR RAILWAY STATION



SHILP CHOWK

**EDUCATION WITHIN REACH**

Your children have the advantage of having, some of the most distinguished learning institutions in the vicinity. They comprise elite schools like Ryan International and Balbharati.

In addition, professional colleges devoted to various disciplines include Bharatiya Vidhyapeeth College of Engineering, National Institute of Fashion Technology, ITM, Yera Medical College and A.C. Patil college of Engineering.



TATA MEMORIAL HOSPITAL



UTSAV CHOWK



RYAN INTERNATIONAL SCHOOL



WORLD CLASS ROAD



NATIONAL INSTITUTE OF FASHION TECHNOLOGY

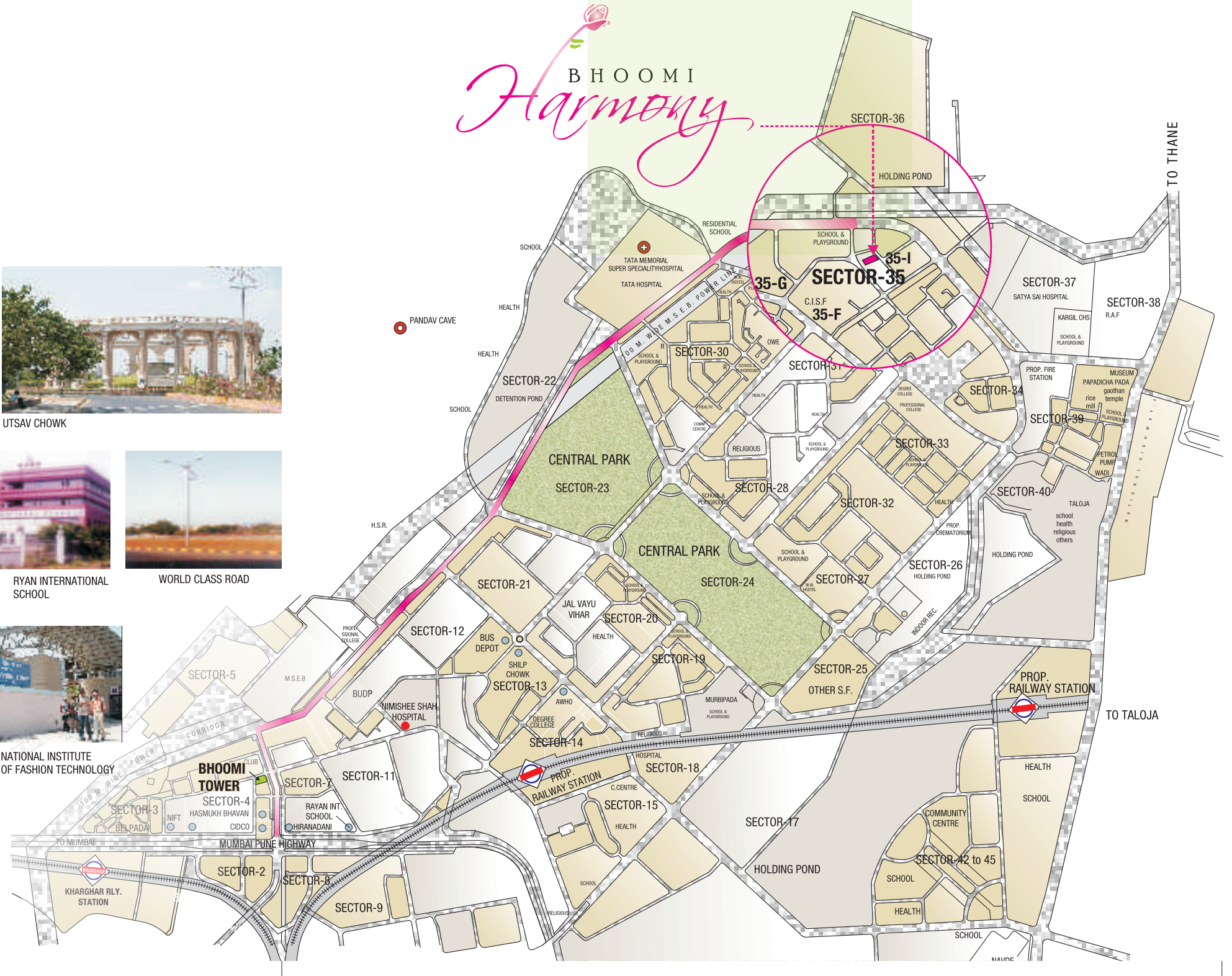

God blesses you in mysterious ways. Have you ever wondered that, one of his boons can be, a well-planned residential complex, set in verdant surroundings? Well, we urge you to take a fresh look at **BHOOMI HARMONY**, to understand this understated truth. So do not forgo an opportunity that comes once in a lifetime and changes your life forever!





BHOOMI  
*Harmony*

Harmonize the ambitions  
of the mind,  
with the aspirations of your  
heart. CELEBRATE!



**BHOOMI HARMONY** is not just a building, but an expression of thoughtfulness. Be it site, spaciousness, scenery or safety, it scores on all counts.

The earthquake proof building is situated in an exclusive demarcated residential zone, with its dedicated network of roads. It affords a breathtaking view of the mountains. The building comprises ground + 14 stories, built in accord with the highest architectural principles. Not only the spacious 2 BHK flats, but the entire structure makes an intelligent use of space, light and air.

May we remind you that it is a harmonious blend of beauty complemented by safety. After all it has a symbolic name - **BHOOMI HARMONY** - to live up to!



A TRIBUTE TO GRACIOUS LIVING



BHOOMI  
*Harmony*

A place after  
your heart.  
Your cozy niche!  
Just yours!



**FEATURES**

- G +14 Storied Tower.
- Earth Quake Resistant Construction Work.
- Pollution free Environment.
- Close to nature.
- Quality Infrastructure.
- Close proximity to the Mumbai - Pune Express Highway.
- Just 10 minutes drive from proposed International Airport & Special Economic Zone (SEZ).



ENJOY A HARMONIOUS LIFE !!



BHOOMI  
*Harmony*

A lifetime of  
domestic bliss



FACILITIES

Well planned facilities ease the daily grind of living.

**BHOOMI HARMONY** offers you facilities that makes it a sanctuary, because along with your aesthetic needs, we have provided for your convenience and security too.

Uniquely designed elevation.

Decorative entrance lobby & main gate.

Advance fire fighting & detection system.

Emergency generator for lift & passage.

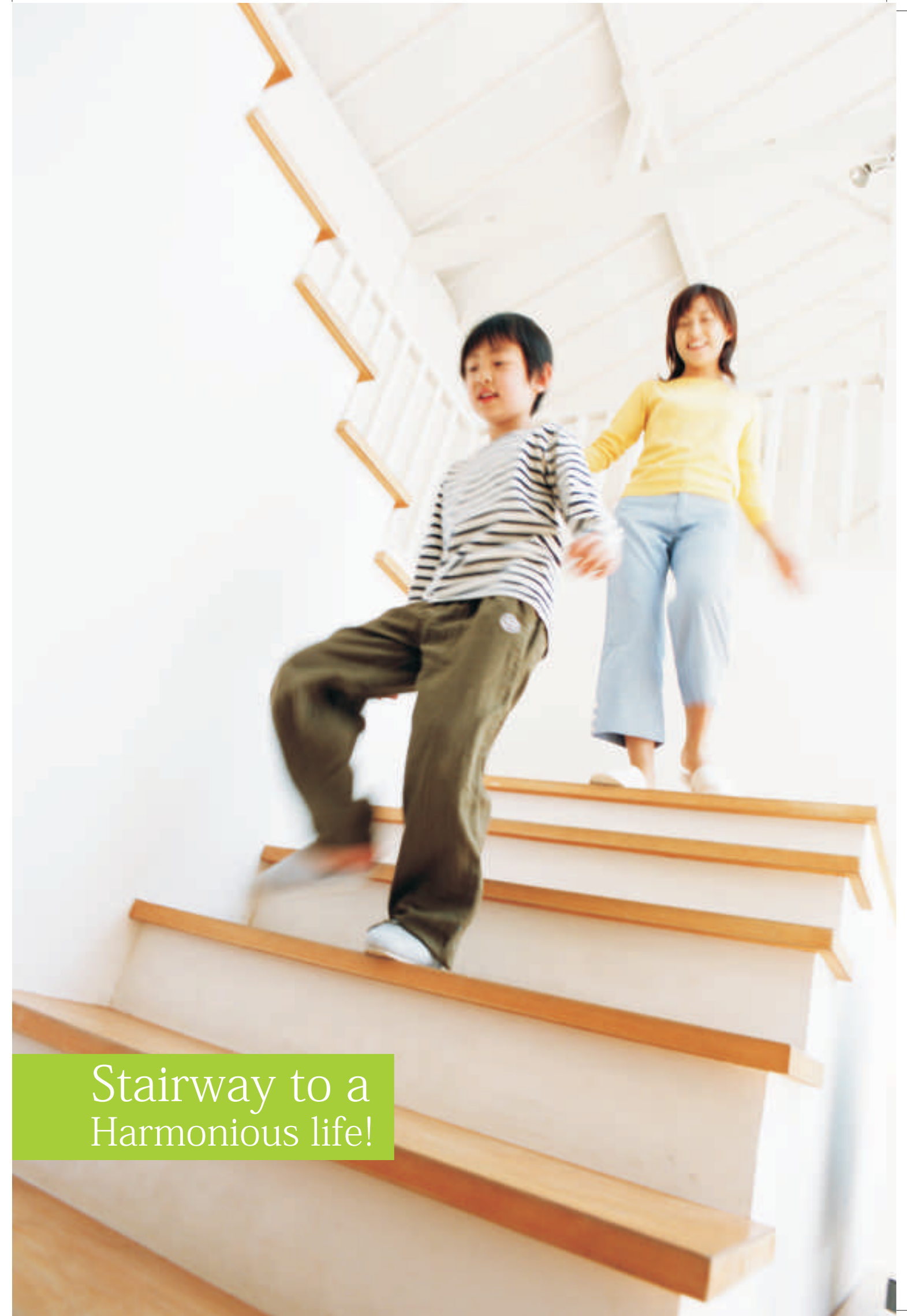

Stairway to a  
Harmonious life!

BHOOMI  
*Harmony*

Luxury redefined  
to suit modern  
lifestyles



**AMENITIES**

**Living & Dining Room**

Vitrified flooring, Telephone & TV points.

**Kitchen**

Granite kitchen platform with stainless steel sink, Colour glazed tiles on dado, points for refrigerator, exhaust fan and water purifier.

**Bedroom**

Vitrified flooring. Points for telephone, TV and air-conditioner.

**Doors**

Strong & long lasting granite frames, with water-proof doors for all toilets. Main door with laminated decorative sheets having high quality fixtures and fittings.

**Toilet**

Coloured glazed tiles on dado up to door height for extra protection, ceramic tiles flooring & C.P. fittings of Premium branded.

**Windows**

Powder coated heavy section aluminium windows with granite sills. Protective mosquito net.

**Plumbing**

Concealed plumbing with high quality fittings.

**Electrification**

Concealed copper wire with extensive lay-out in all rooms enabled by modular switches.

**Painting**

Distemper paint on internal walls & acrylic paint on external walls.

**Entrance**

Spacious ornamental entrance lobby.

**Lifts**

Automatic high-speed lifts of reputed brand.

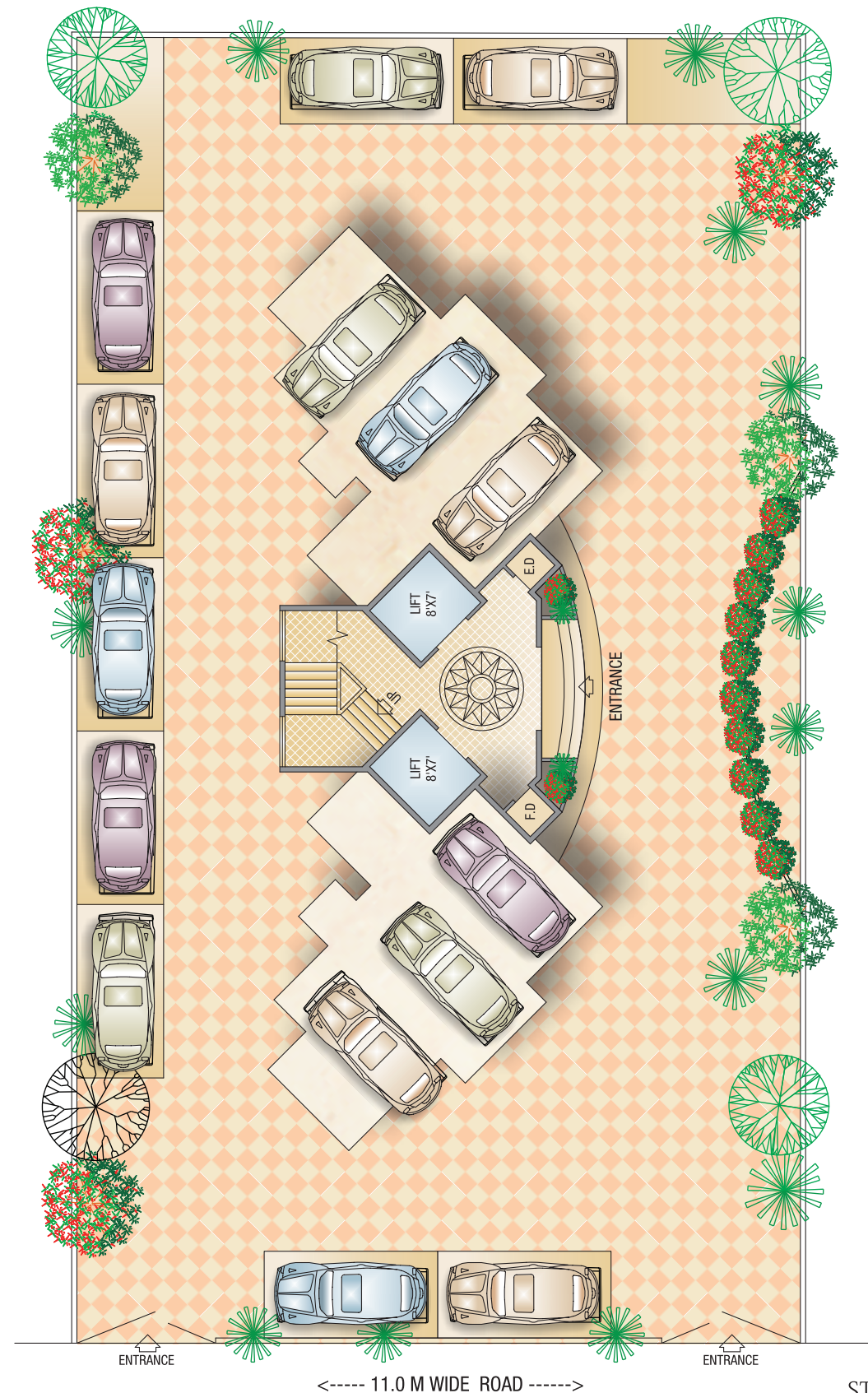

←----- 11.0 M WIDE ROAD -----→



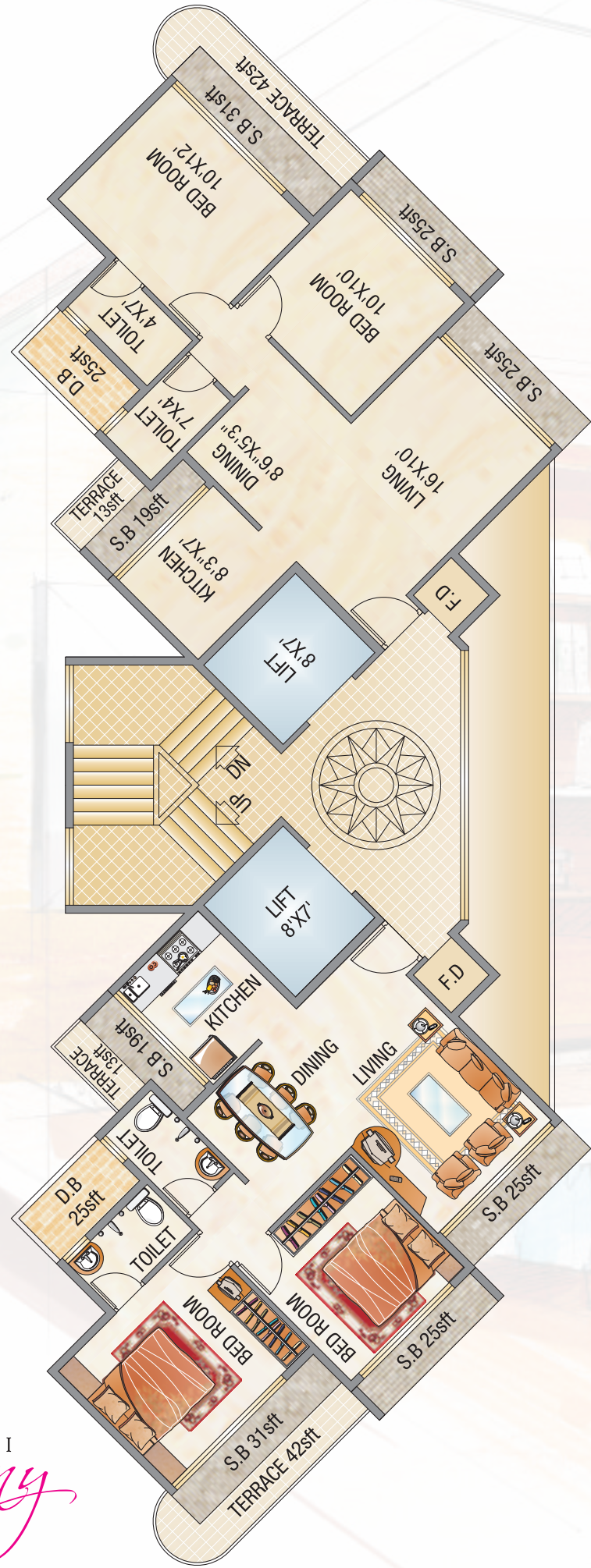

TYPICAL FLOOR PLAN  
(1, 3, 5, 7, 9, 11)

An eloquent expression  
of your affluence



TYPICAL FLOOR PLAN  
(2, 4, 6, 8, 10)





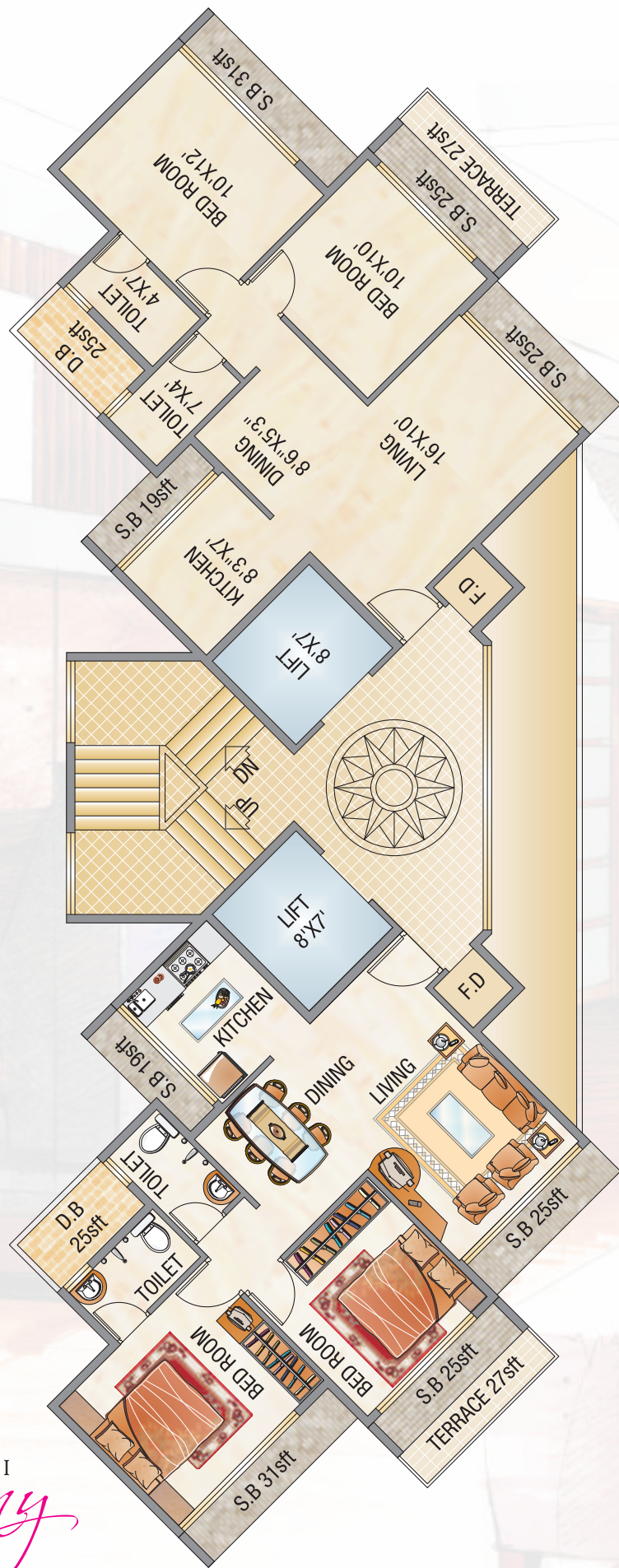

A serene & harmonious  
world of refined living

12TH FLOOR PLAN

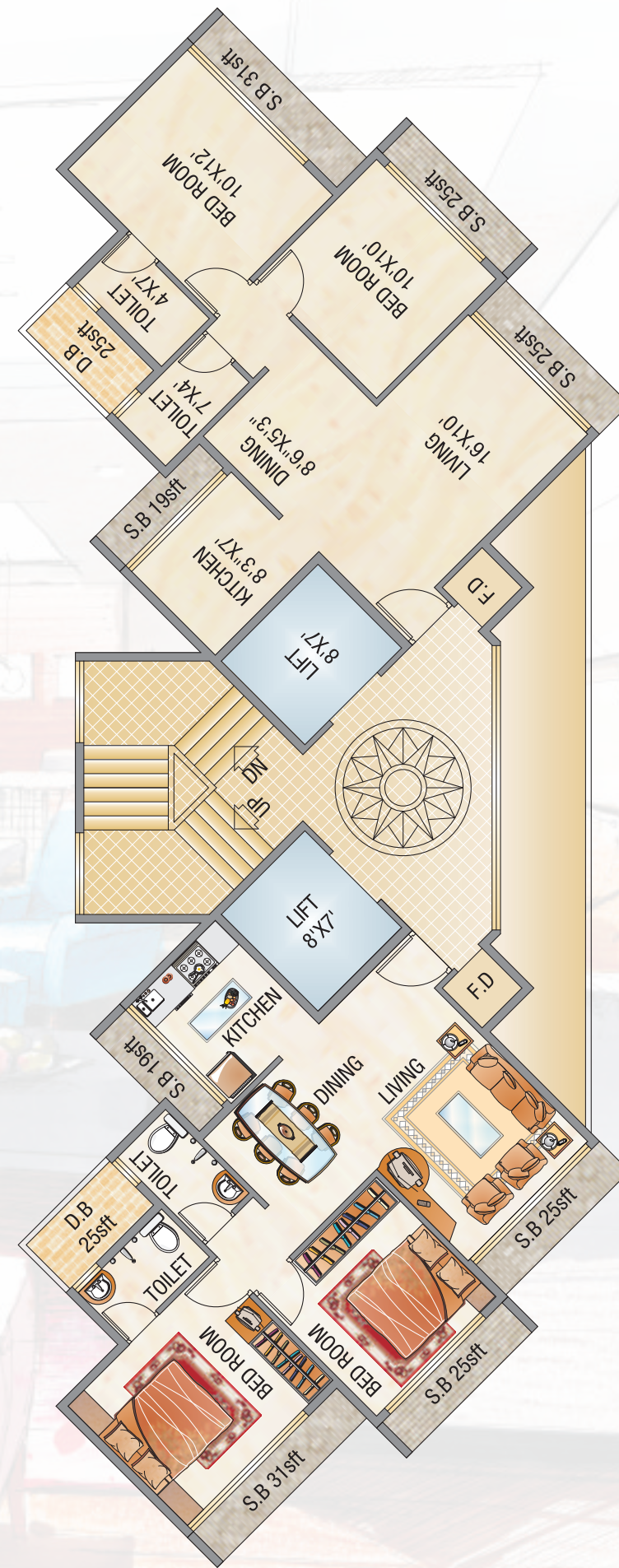

TYPICAL FLOOR PLAN  
(13, 14)