

Welcome to your dream world...





Ground Floor Plan

Ground Floor Plan	
Fiat No.	Saleable Area
101	1560 sq. ft.
102	1560 sq. ft.
103	1560 sq. ft.
104	1560 sq. ft.

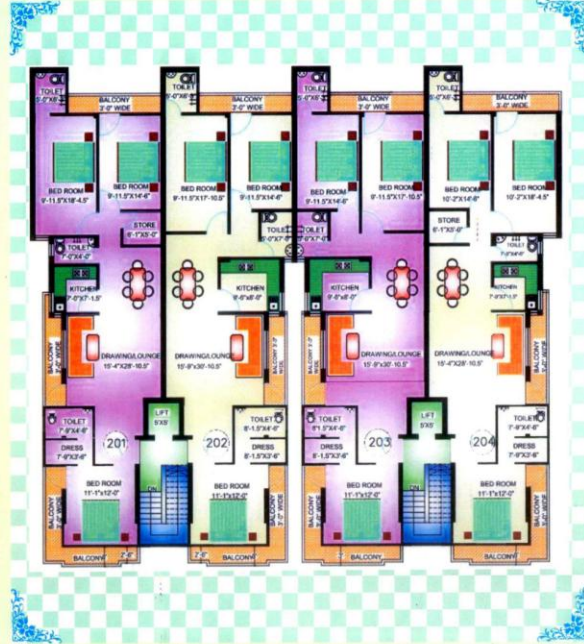

First & Second Floor Plan

Ground Floor Plan	
Fiat No.	Saleable Area
201	1700 sq. ft.
202	1700 sq. ft.
203	1700 sq. ft.
204	1700 sq. ft.

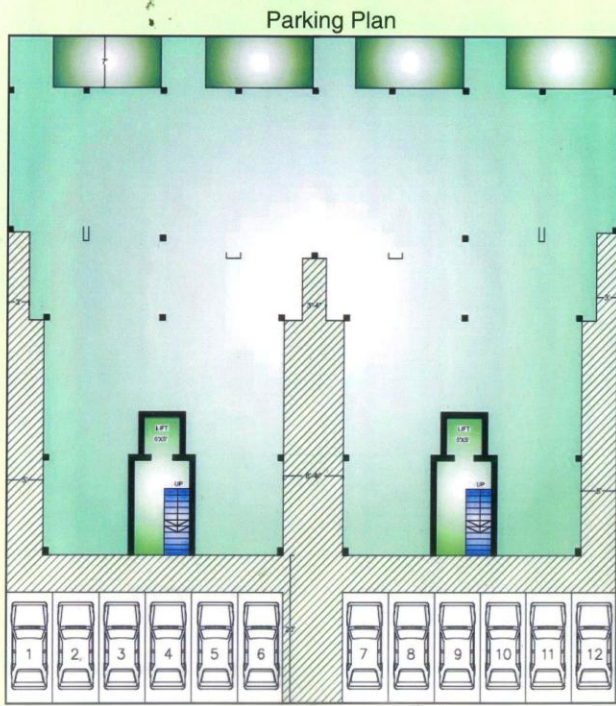

Features

- Well Designed plan with well ventilated & light.
- **Kitchen** : Modern Kitchen well designer tiles counter along with granite to with ISI taps & fitting.
- **Toilets** : All ISI Pipe & Fitting used in toilets and all fitting and fixtures with designer tiles.
- **Floor** : Marbal Floor with granite polish/vitrified tiles.
- **Structure** : Earthquake resistance RCC structure along with raft foundation.
- Elevator.
- Wooden flush doors & wooden glazed window panels.
- Rain water harvesting system.
- Chequered tiles on parking area.
- Modern electric system with modular switches.
- Modern security system with video camera.

Welcome to your dream world...



Location Plan



Site : Plot No. 18-19, Ayuwansingh Nagar, Maharani Farm, JAIPUR

Builders & Developers :
Bony Buildtech Pvt. Ltd.
40-41, Mansarovar Link Road
Gopalpura Bypass, JAIPUR

Ajay Singh (Director)
Phone : 0141-2762234
Mobile : 93145-03145, 93143-61444



Disclaimer : This Brochure is purely conceptual and not a legal offering. Further the Promoters reserve the right to add/delete/modify any details/specifications/elevation mentioned

Printed by: Sanyal Enterprises, Pvt. # 94142-39897