



A home with  
captivating comfort,  
luxury and ambience....



 **Santha**  
Towers

**Phase III**

Poonamallee - Avadi Road



# Typical Floor Plan

103 - 803  
1372.64 Sq.ft

101 - 801  
1372.64 Sq.ft

102 - 802  
1386.11 Sq.ft

102 - 802  
1386.11 Sq.ft

101 - 801  
1426.07 Sq.ft

103 - 803  
1426.07 Sq.ft

103 - 803  
1426.07 Sq.ft

101 - 801  
1426.07 Sq.ft

102 - 902  
1386.11 Sq.ft

102 - 902  
1386.11 Sq.ft

101 - 901  
1372.64 Sq.ft

103 - 903  
1372.64 Sq.ft

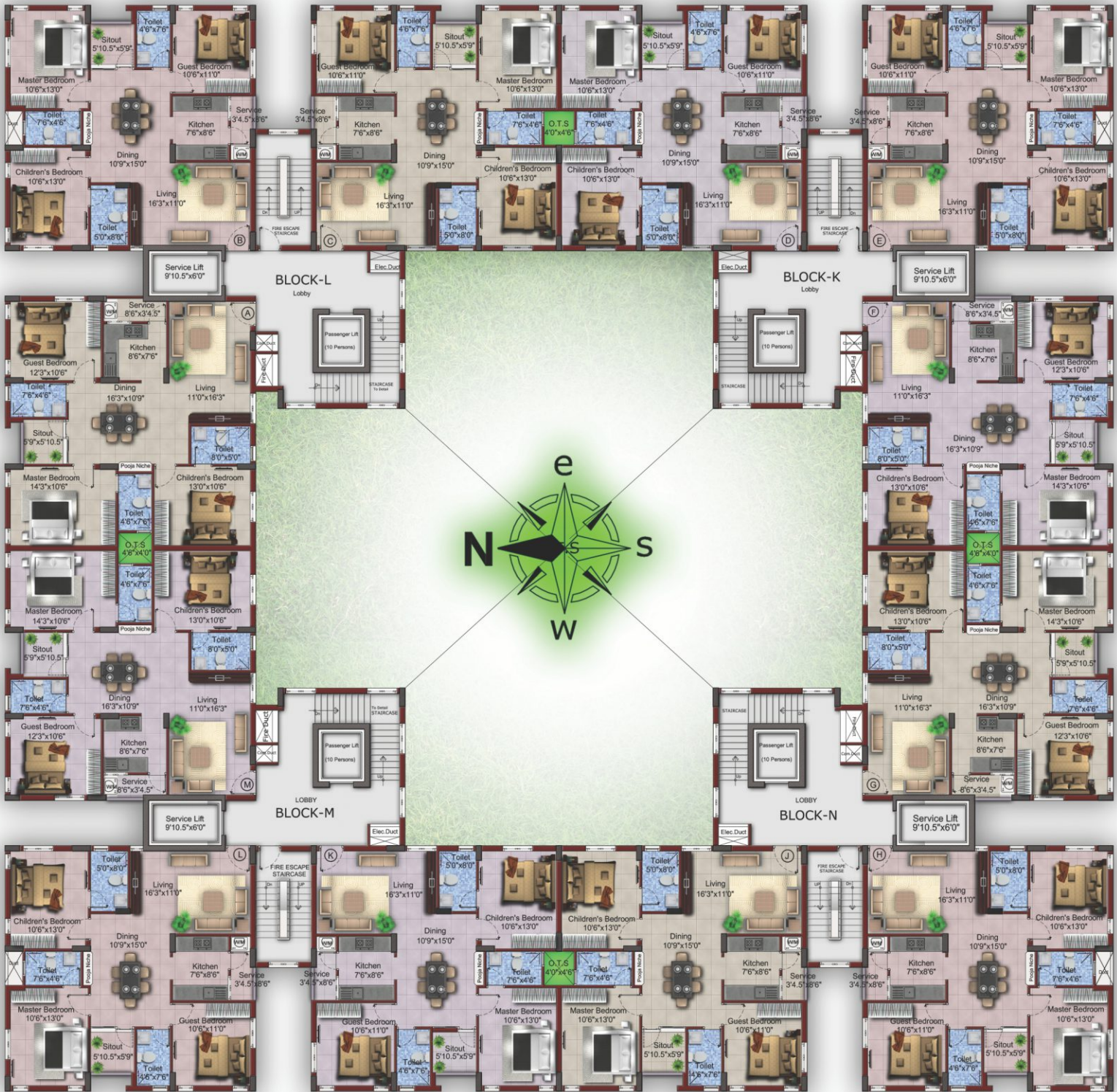



# Santha Towers

Phase III



Imagine a home that is spacious, luxurious and well-designed, enhanced further by delicate selection of top-notch amenities. A home where you can experience captivating comfort, luxury and ambience. A home where there is more space for your precious moments of life.

Santha Towers is an exclusive Gated Community with a Commercial Complex, consisting 508 Apartments spread across 4.57 acres, stands royally in one of the strategic locations of Paruthipattu, Avadi-Chennai, surrounded by all social infrastructures like educational institutions, commercial and recreational centres. Connected to all the parts of the city through well developed road and rail networks, which makes commuting as comfortable as living in Santha Towers.

Santha Towers (Phase III-100 Apartments) offers you an exceptional selection of ultra-modern spacious three bedroom apartments in areas 1372, 1386 & 1426 sq.ft., well crafted with amenities matching the modern day living.



Site Plan

Stilt  
+9  
floor

Spacious  
3 BHK  
homes

from  
1372  
to 1426  
sq.ft



# Specifications



## STRUCTURE

- RCC framed structure
- Brick walls



## JOINERIES

- MAIN DOOR: Teak wood frame with moulded skin door with melamine finish
- BEDROOM DOORS: Seasoned wood frame with panelled skin doors with enamel finish
- BATHROOM DOORS: Seasoned wood frame with PU coated doors with enamel finish
- WINDOWS: UPVC Windows with MS Grills  
French Door for balcony
- VENTILATORS: UPVC frame with louvered glass



## SANITARY & CP FITTINGS

- KITCHEN: Stainless Steel sink with drain board
- TOILETS: Jaquar or equivalent CP fittings and sanitary fixtures

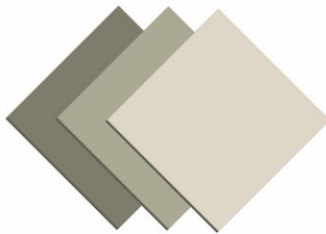

## FLOORING & TILING

- LIVING, DINING, BEDROOMS & KITCHEN flooring - Vitrified tiles
- UTILITY / BALCONY / BATHROOMS flooring - Anti skid joint-free tiles
- CAR PARK – Grano flooring
- STAIRCASE – Anti skid joint-free tiles
- TOILET – Glazed tiles upto false ceiling
- KITCHEN – Granite counter top  
– Glazed tiles upto 2'0" height



## PAINTING

- CEILING : Emulsion Paint
- INTERNAL : Emulsion Paint
- EXTERNAL : Exterior Emulsion Paint



## ELECTRICAL

- Concealed wiring – ISI approved brand
- Switches – Modular Switches – Legrand or equivalent make
- Power Supply – 3 Phase
- Power back-up – Common lights, Lifts, 500 watts for each Apartment with automatic change over







## Amenities

- Club House
- Swimming Pool
- Gymnasium
- Multipurpose Hall
- Indoor Games
- Landscaped Park
- Children Play Area
- Piped Gas Line
- Integrated DTH System
- Telephone / Broadband / FTH
- Passenger & Service Lifts
- 24x7 Power backup
- STP & WTP



Commercial Complex



# Route Map

Not to Scale

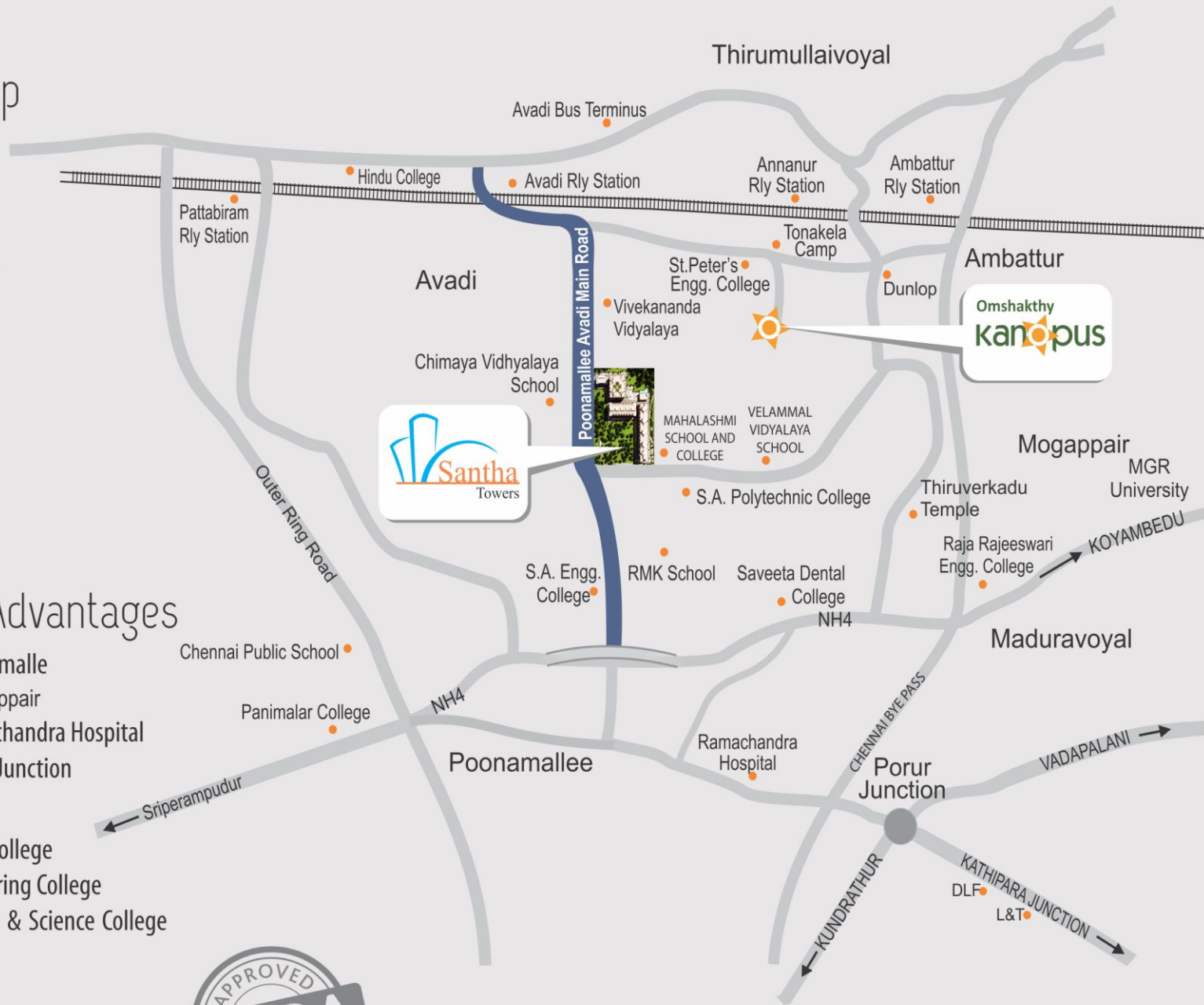

## Location Advantages

- 5 kms from Poonamalle
- 7 kms from Mogappair
- 8 kms from Ramachandra Hospital
- 9 kms from Porur Junction

### Colleges :

- S.A. Engineering College
- St. Peters Engineering College
- Mahalakshmi Arts & Science College

### Schools :

- Vivekananda
- RMK International
- Chinmaya Vidyalaya
- Velammal Vidyalaya Schools



## Omshakthy Homes Private Limited

TS 65, SIDCO Industrial Estate, Ekkattuthangal, Chennai-600 032,  
e.mail: sales@omshakthy.net [www.omshakthy.com](http://www.omshakthy.com)

**CALL 044 4030 3040**



Loans from Leading Banks

