

# SAI CHARAN COMPLEX

BUILDING NO.3

*Bring Home Prosperity & Joy*



MAHA RERA Registration Number : P51700001132

📍 SURVEY NO-80 (OLD), NEW 6,  
HISSA - NO-4 AT VILLAGE GODDEV



*A home you'll be proud to call your own...*

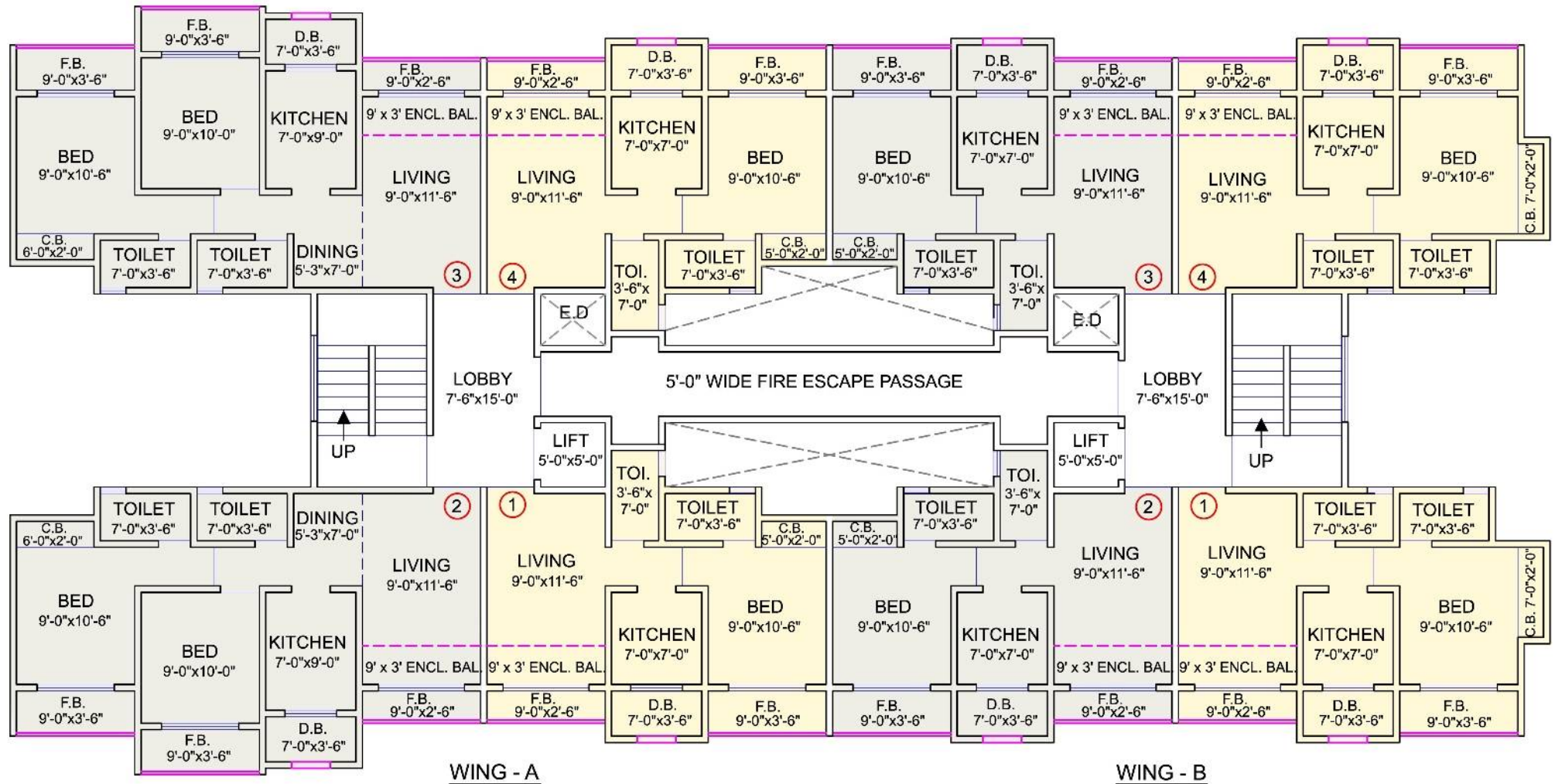

TYPICAL FLOOR PLAN



## AMENITIES

### ■ LIVING & BEDROOM

- Decorative main door
- Elegant vitrified flooring in entire flat with skirting
- False ceiling in living & bedroom
- Anodized aluminum french Windows with mosquito net Fitted
- TV, Telephone and AC point in living & bedroom.

### ■ KITCHEN

- Kitchen platform with granite & S.S.Sink
- Designer ceramic tiles dado up to door height
- Provision for exhaust fan, water purifier, fridge & washing machine point.

### ■ BATHROOM

- Designer anti skid flooring
- Designer tiles dado up to door height
- Concealed plumbing with quality sanitary ware fixtures and attractive CP fitting
- Storage water tank over bathroom

### ■ GENERAL

- Grand and Designer entrance lobby
- Otis/Schindler or equivalent elevator in each wing
- Internal wall with smooth P.O.P finish
- Rain water harvesting facility
- Adequate electric points with concealed wiring and modular switches of reputed brand
- Plastic paint in internal wall
- Loft over bathroom

### ■ SAFETY

- Well Designed RCC structure
- Modern fire fighting system
- 24X7 video surveillance
- Intercom facility
- Full Height M.S.Grill in all rooms.



1 BHK



2 BHK



Just Away 

## LOCATION PLAN

### Near by Location

### Distances

Mira - Bhayander Sports Complex	200 mtr.
Hanuman Mandir	200 mtr.
Apple Hospital	150 mtr.
Ram Mandir	150 mtr.
Abhinav Vidya Mandir School	300 mtr.
ICICI bank	800 mtr.
Canara Bank	700 mtr.
Maxus Mall	1.5 km.
Mira Road Railway Station	3.0 km.

**Bhayander Railway Station**  
Walking Distance = 10 to 15 min

\* Project approved with all leading banks \*



### DEVELOPERS

**M/S. OM SAI CHARAN BUILDERS**

✉ [omsaicharan999@gmail.com](mailto:omsaicharan999@gmail.com)

☎ 9833123138  
9821722650  
8433526976

### OFFICE ADDRESS

G-2, NEW SAI CHARAN COMPLEX BLDG. NO-1  
CHS. LTD., PRABHAKAR DATTU MHATRE MARG,  
BEHIND GODDEV VILLAGE, BHAYANDER EAST,  
DIST THANE - 401105

### ARCHITECT

**ANISH & ASSOCIATES**