



LEVERAGE   
**GREEN** PARK

**Onyx**  
2-BHK APARTMENTS

Maha-RERA Registration No. P50500013820



2-BHK (BLOCK-A / BLOCK-B)  
Typical Floor Plan

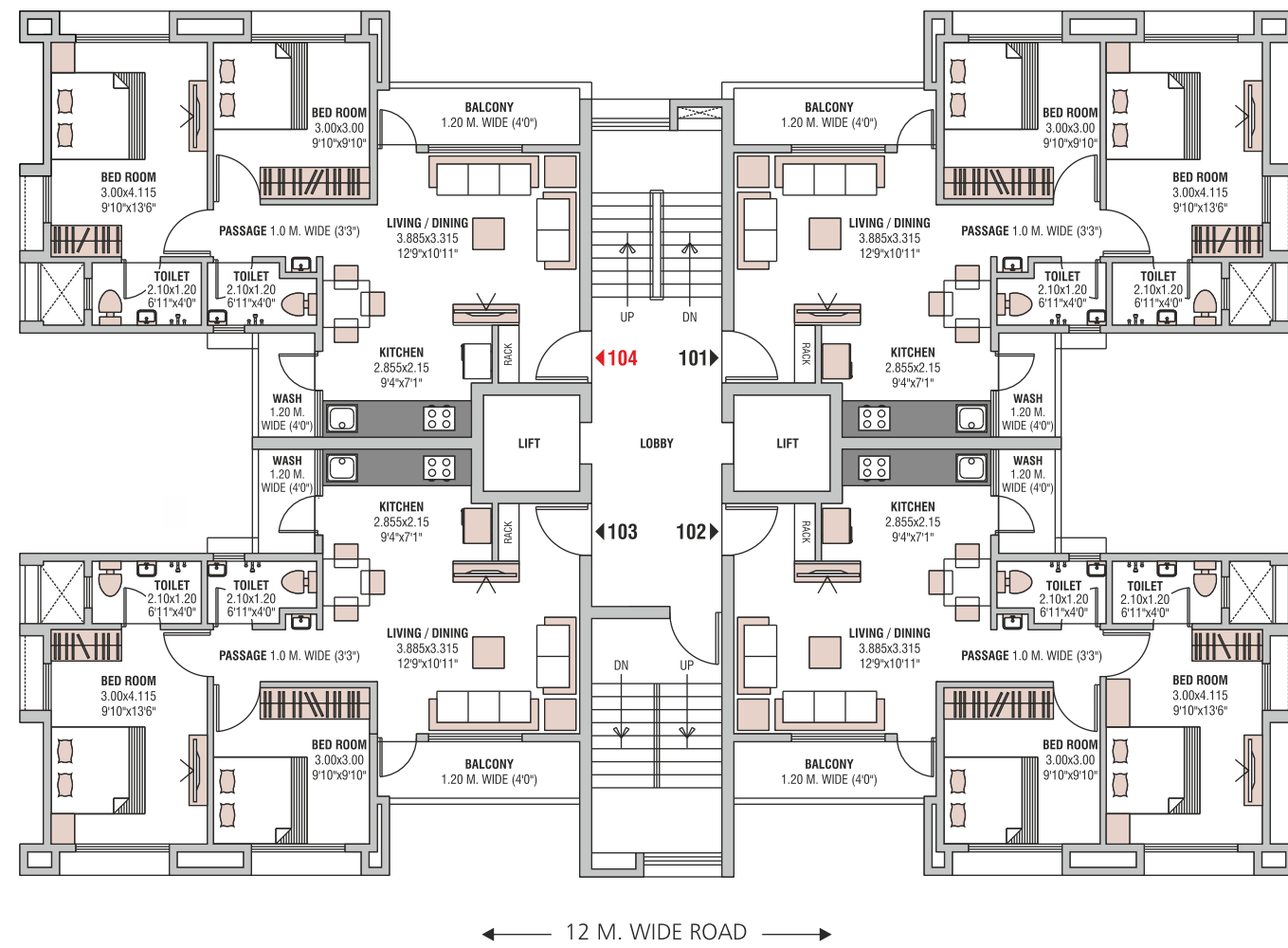

2-BHK  
ISOMETRIC VIEW  
Flat No. 104

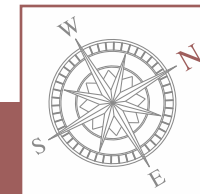



## SPECIFICATIONS

### Flooring

- Vitrified tiles in entire flat
- Anti-skid tiles in balcony, toilets and utility area

### Kitchen/Utility

- Granite platform with stainless steel sink
- Glazed tiles dado upto 2.0 ft. height above the platform
- Provision for water purifier

### Toilets

- Glazed tiles dado upto 7 ft. height
- Sanitary ware: Parryware or equivalent
- Bath fittings: Jaquar or equivalent

### Doors

- Main Door: Besecure Door or equivalent
- Other Doors: Decorative moulded Masonite / Flush Door
- R.C.C. door frames

### Windows

- Powder coated aluminum sliding windows
- M.S. grille and mosquito net
- Marble window sill

### Electrification

- Modular switches of Legrand or equivalent
- Telephone points in drawing room
- TV points in drawing room and master bed room
- Inverter wiring

### Painting

- Exterior: Weathershield emulsion paint
- Interior: In-touch interior emulsion

### Lifts

- 2 lifts in each block

### Back-up

- Power back-up for lift and common utilities

## RECENTLY COMPLETED PROJECTS

LEVERAGE  
**Greens** | **Orchid**



2/3 BHK APARTMENTS  
On Koradi Road, Near Modern School, Nagpur

MAPLE  
RESIDENCY



3-BHK APARTMENTS  
At Friends Colony, Katol Road, Nagpur

## LOCATION MAP

LEVERAGE  
**GREEN PARK** | **Onyx**  
2-BHK APARTMENTS

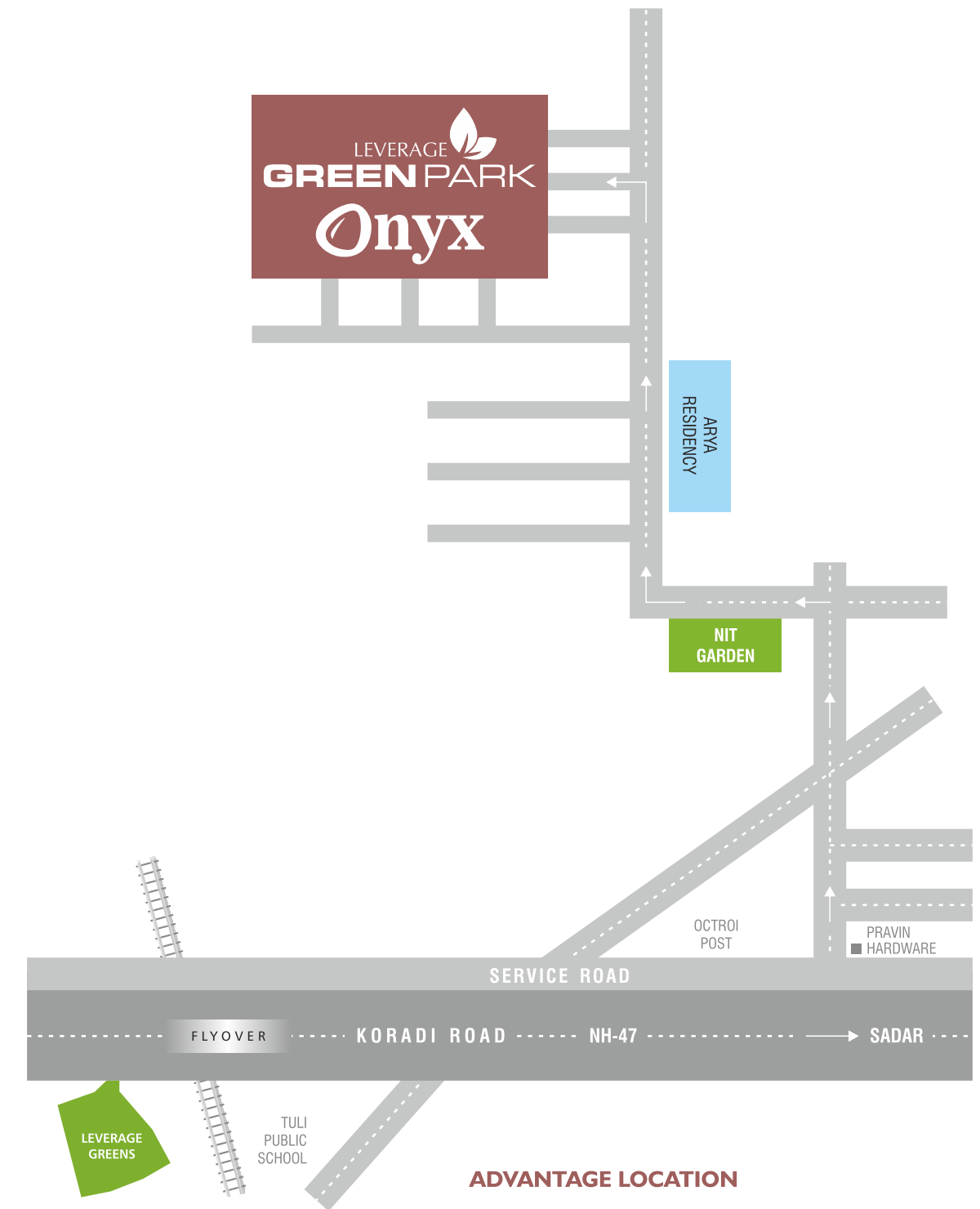

### ADVANTAGE LOCATION

- Affordable scheme within city limits
- 5 KM from Poonam Chambers, Sadar
- 7.5 KM from Railway Station / Zero Mile
- 13 KM from Airport

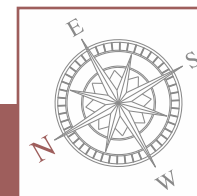

Architect  
**AR. PRASHANT SATPUTE**  
Design Cell, Nagpur

Structural Consultant  
**P.S. PATANKAR & ASSO.**  
Nagpur

Legal Consultant  
**ADV. ANIL MULCHANDANI**  
Nagpur

deepak.kaswa + 91-9823068326



**LEVERAGE**  
GROUP

**LEVERAGE REALTORS PVT. LTD.**

FF-1/2/3, Girish Heights, L.I.C. Square, Near Bharat Talkies, Sadar, Nagpur - 440 001 (M.S.), INDIA  
Tel.: 0712-6609960 E-mail: [sales@leveragegroup.in](mailto:sales@leveragegroup.in) Website: [www.leveragegroup.in](http://www.leveragegroup.in)

For enquiry and details, call:  
9552 755566 • 9552 655566  
9552 855566 • 9552 885566

MEMBER  
**CREDAI**  
NAGPUR METRO

Note: This brochure is purely a conceptual presentation and not a legal offering. Pictorial depiction and details of buildings, layouts, specifications, designs, dimensions, etc. as shown in this brochure are tentative, indicative and subject to amendment, variation and modification by the Company at its sole discretion and without any notice.