



[www.greengroup.co.in](http://www.greengroup.co.in)

**Ingeniously Designed, Intentionally Lavish**  
3.5 BHK APARTMENTS



Green City Actual Site Photography

# Green City Success Story

## WHERE LIFE HAS A NEW MEANING

Green City came into existence as a part of an integrated township project introduced by Green Group in Surat. A Green City project started in the year 2008 as the biggest residential project in Surat. Under a Green City project, Green group has successfully completed the construction of more than 27 towers and granted possession to people in the first phase of this project. In Adajan, Green group has already completed a number of prestigious projects successfully. The project was a huge hit and received a massive response with 100 % booking on the opening day of the second phase. The highlight of the project has been luxurious world class housing, amenities for middle income groups in a safe, secure, prudently administered and urbanely designed space. With an assurance of a healthy lifestyle, celestial landscape and an exotic view, Green City is a wonder in itself.



## Here Life is a Celebration!

We Promise You Affordable Luxurious  
home with Lifestyle Amenities



## Feel Fresh Inside and Outside

As you step out of your room with a coffee mug in your hands, the soft breeze sweeps through your hair and caress your cheeks.



Feel The Breeze at

**GGG**  
GREEN CITY GOLD

INTENTIONALLY LAVISH  
3.5 BHK APARTMENTS



## Forget Air Conditioners!

A bedroom which converts into a breezy zone as you push open windows!





## Greener Outside, Happier Inside

Who doesn't love coming back to lush green surroundings? A home in a distinct piece of land which purifies the air you breathe and maintains your health.

Pond | Fountains | Jogging Track | Cycling Track







## Flaunt Like Never Before

Your living area becomes the talk of the town. Show off the grandeur and luxury of your apartment while you feel like a king yourself.





## Swim Away Your Stress

Swimming is certainly a refreshing workout. No need to go away for swimming when there is a pool in your own living premises.

Swimming Pool | Steam | Jacuzzi | Sauna





## Elevated Lifestyle

Good thoughts derive their essence from a healthy environment, positive surroundings and a balanced lifestyle. The elevated buildings in GCG offer an elevated lifestyle and inculcate good living thoughts and values in your life.

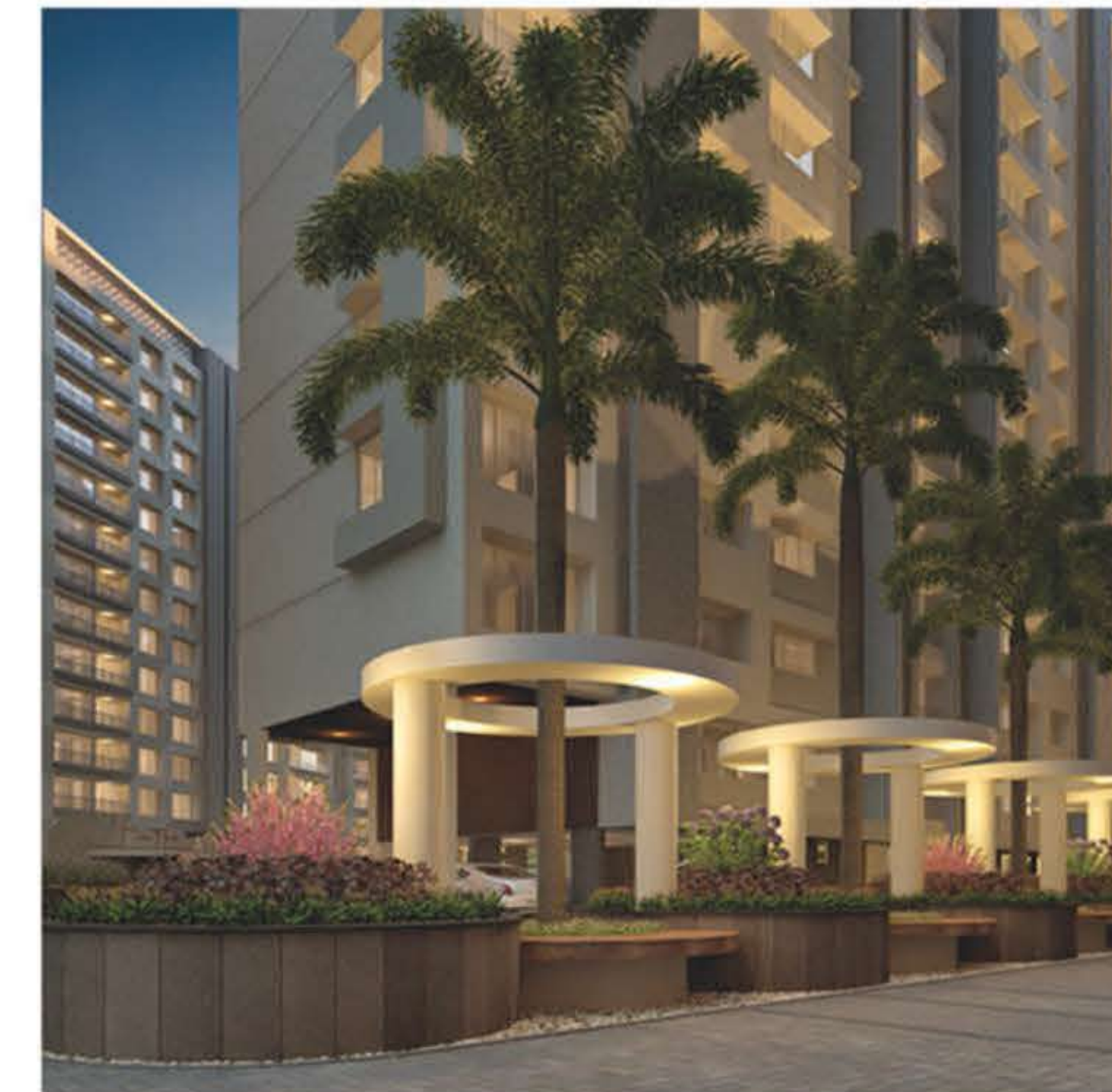



## It's Play Time

Break the monotony of a corporate schedule with energetic, refreshing sports activities. Badminton court and snooker room for those who have a love for sports.

Badminton Court | Pool Snooker Room





## Gym Calling...

No excuse would work now! Can't say no to Gym when it is in your own premises

Gym | Discotheque | Multipurpose Hall





## Say Hello to Beautiful Surroundings

Our soul gets purified when we are one with nature. Enjoy the bliss of purity in the garden that surrounds your house.

Lush Green Garden | Gazebos | Open Theater



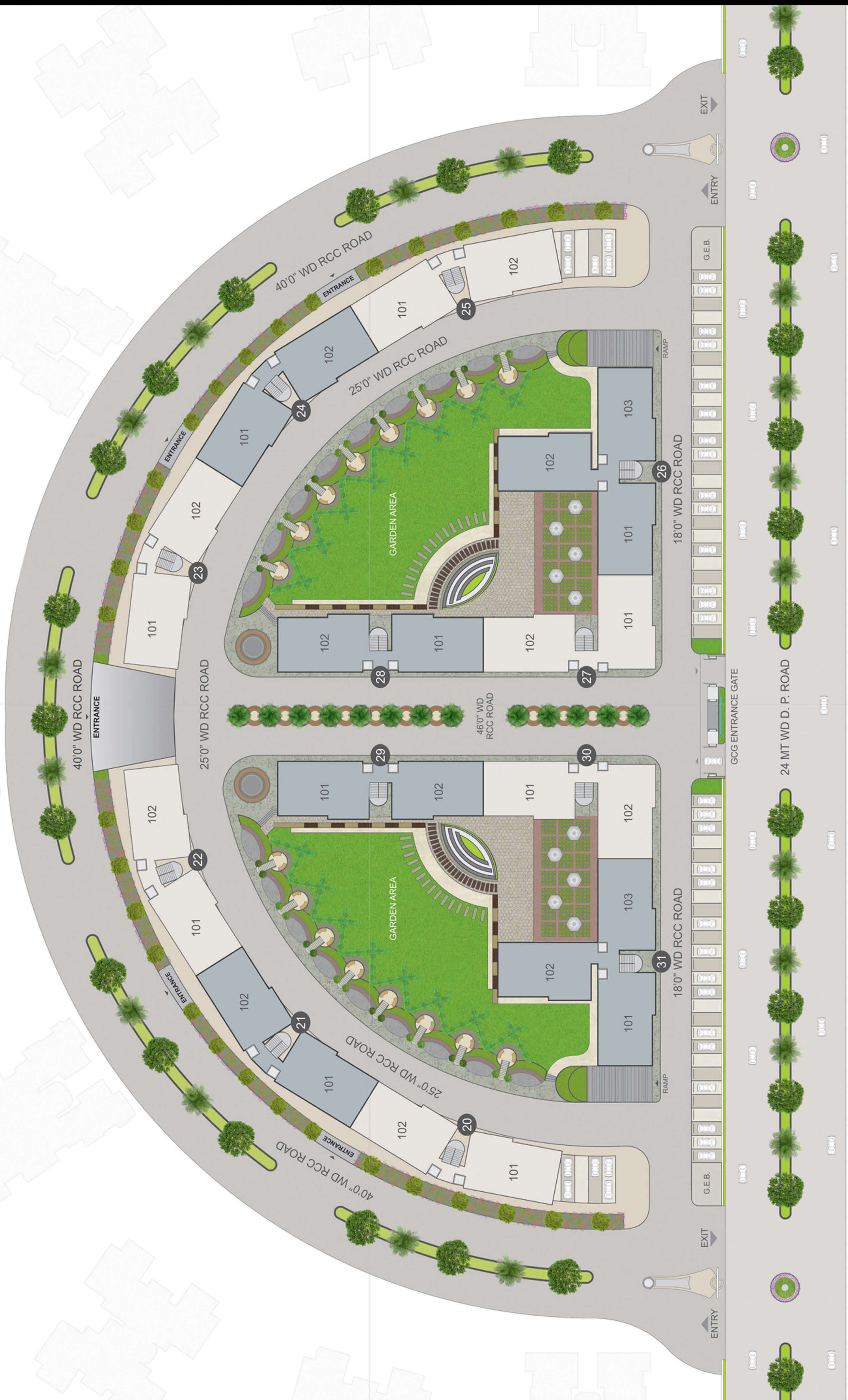



**So Lively Yet so  
Peaceful Surrounds**





FIRST FLOOR PLAN

**U1** BUILDING NO.  
20,25,22,23,26,31  
CARPET AREA 1197 SQ.FT.  
SUPER BUILT AREA 2064 SQ.FT.

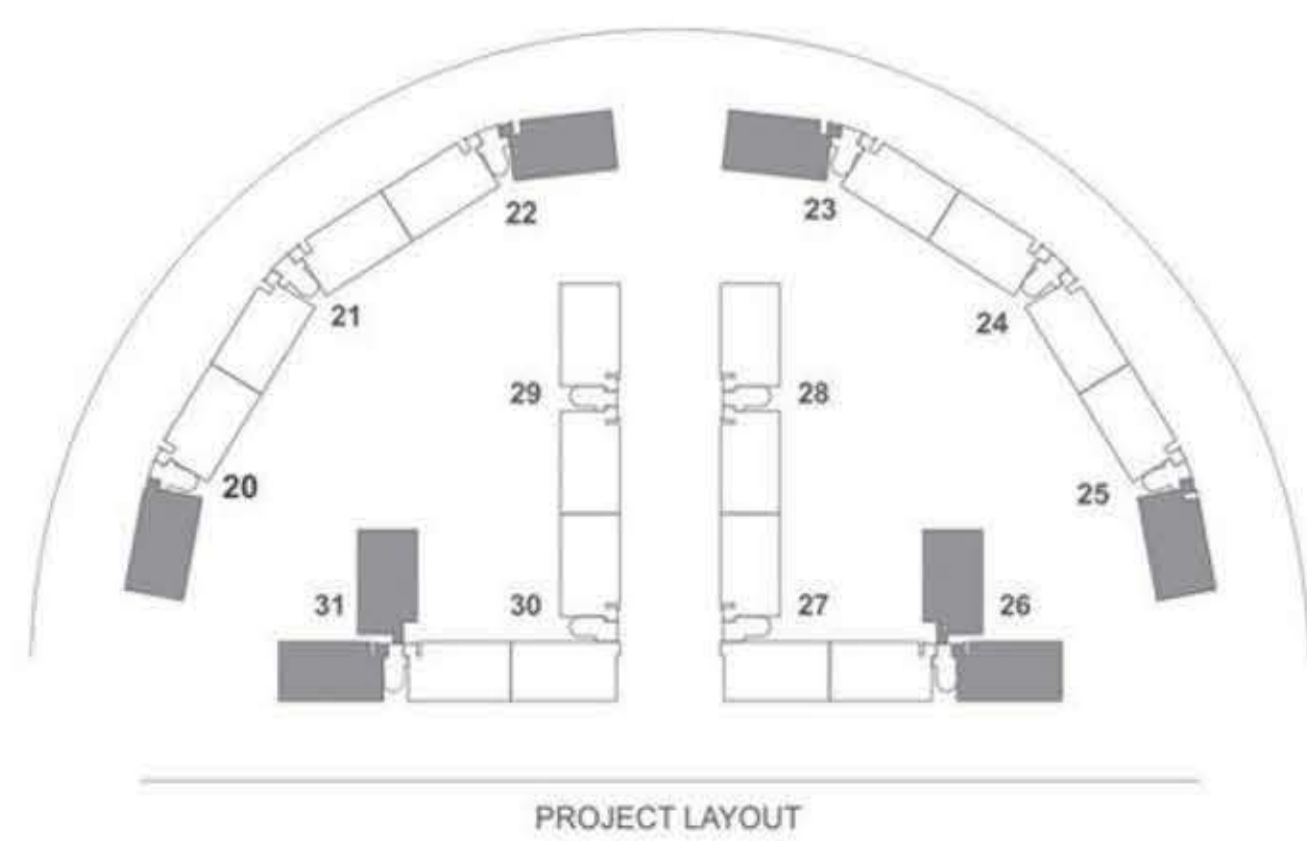

PROJECT LAYOUT

FIRST FLOOR PLAN

**U2** BUILDING NO.  
20,25,21,24,22,23,26,31,29,28,30,27  
CARPET AREA 1182 SQ.FT.  
SUPER BUILT AREA 2038 SQ.FT.

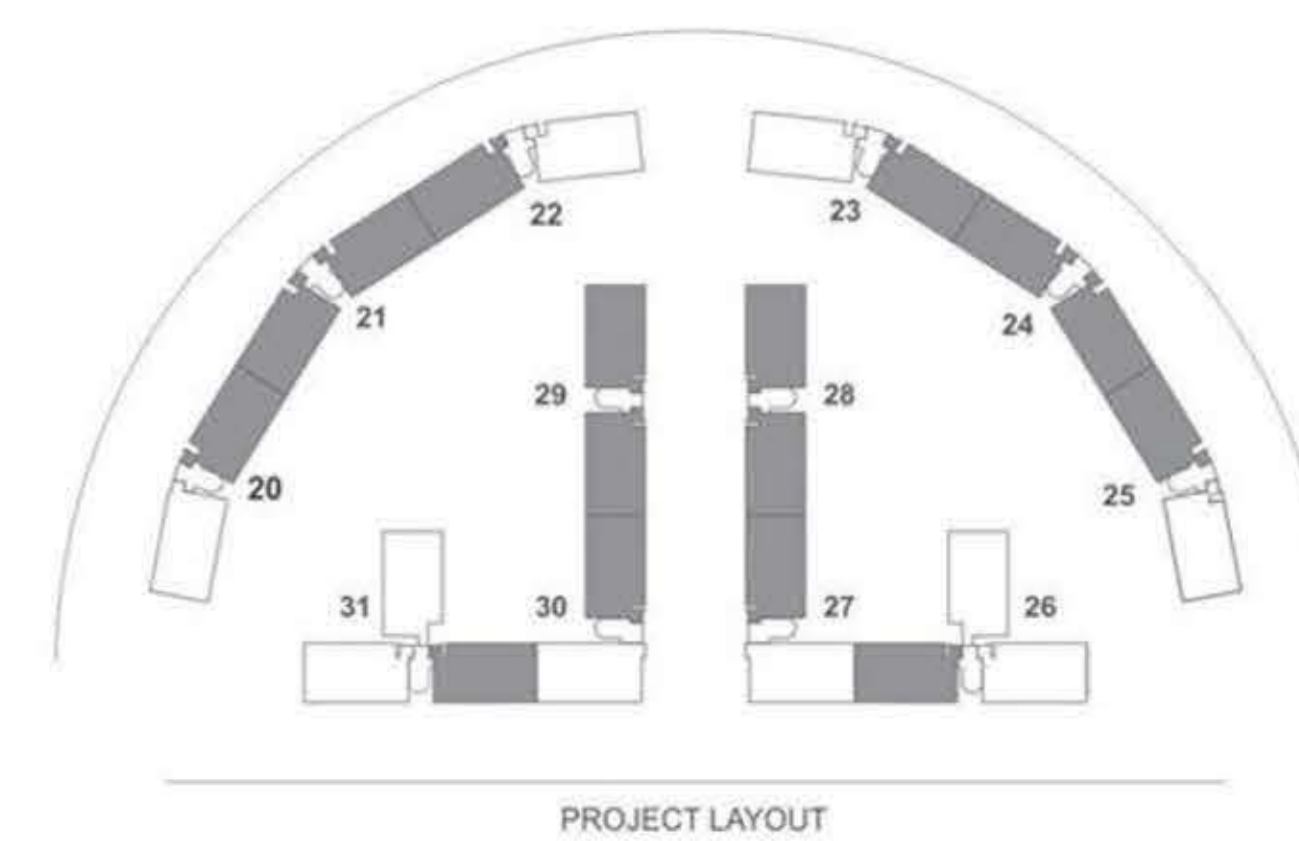

PROJECT LAYOUT

FIRST FLOOR PLAN

**U<sub>3</sub>** BUILDING NO.  
27,30  
CARPET AREA 1247 SQ.FT.  
SUPER BUIT AREA 2150 SQ.FT.

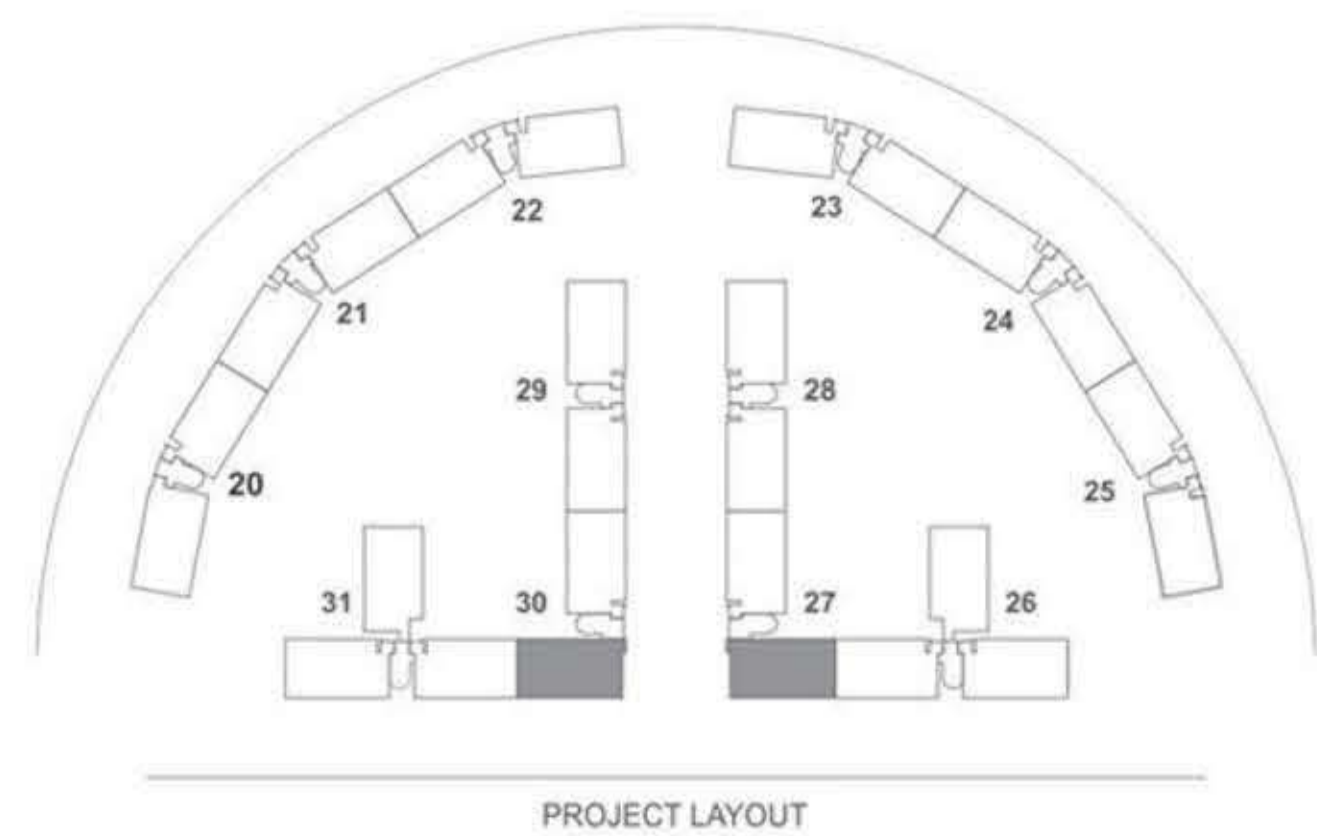

TYPICAL FLOOR PLAN

**U<sub>4</sub>** BUILDING NO.  
20,25,22,23,26,31  
CARPET AREA 1630 SQ.FT.  
SUPER BUIT AREA 2810 SQ.FT.

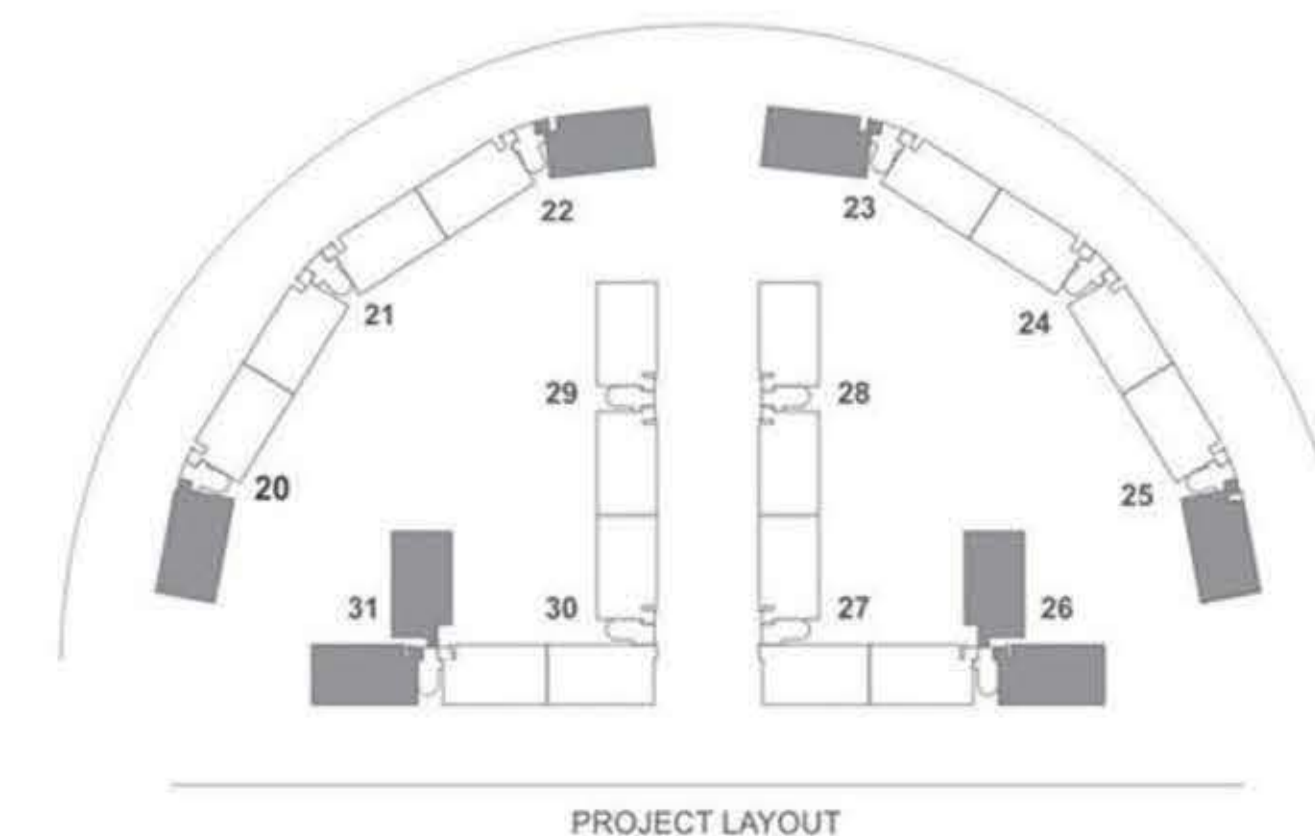

TYPICAL FLOOR PLAN

**U5** BUILDING NO.  
20,25,21,24,22,23,26,31,29,28,30,27  
CARPET AREA - 1600 SQ.FT.  
SUPER BUIT AREA - 2759 SQ.FT.

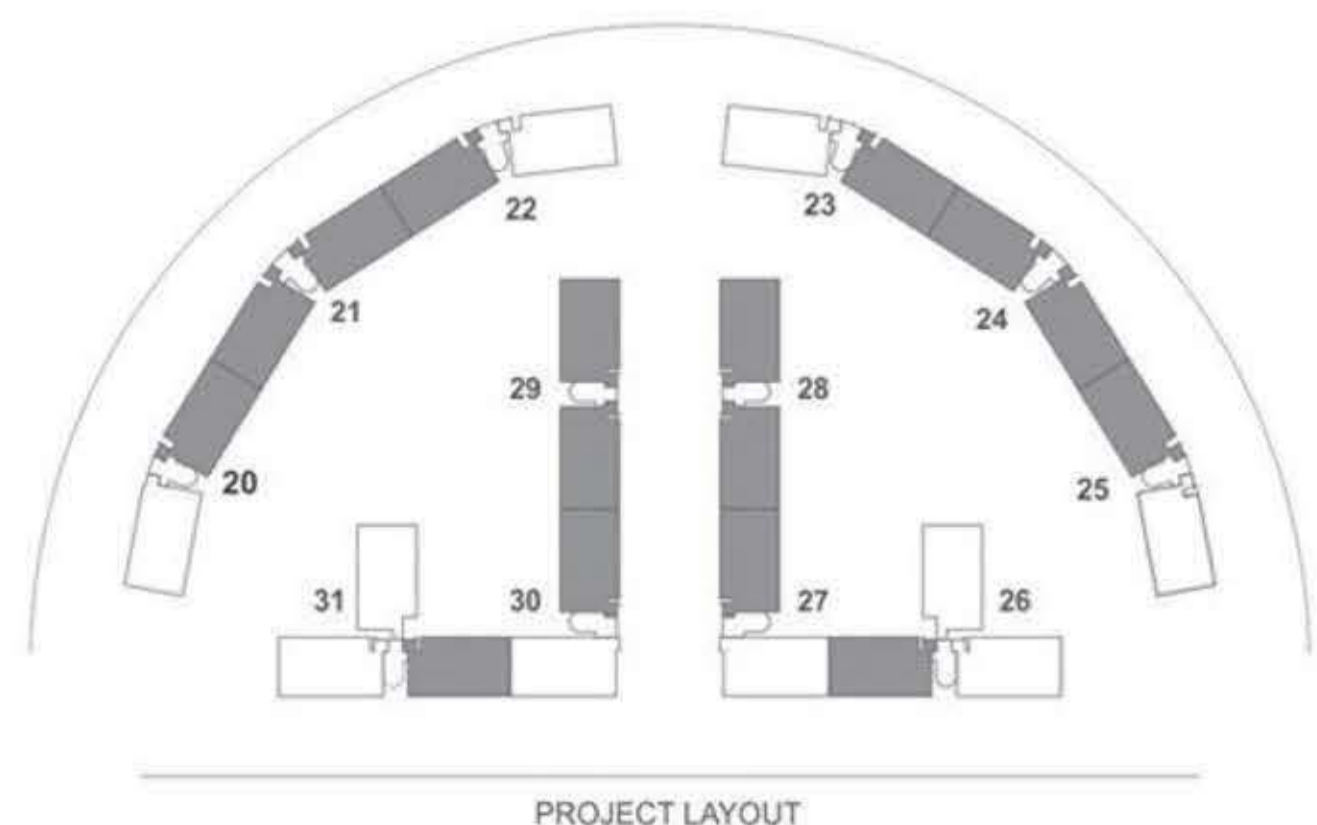

TYPICAL FLOOR PLAN

**U6** BUILDING NO.  
27,30  
CARPET AREA 1663 SQ.FT.  
SUPER BUIT AREA 2867 SQ.FT.

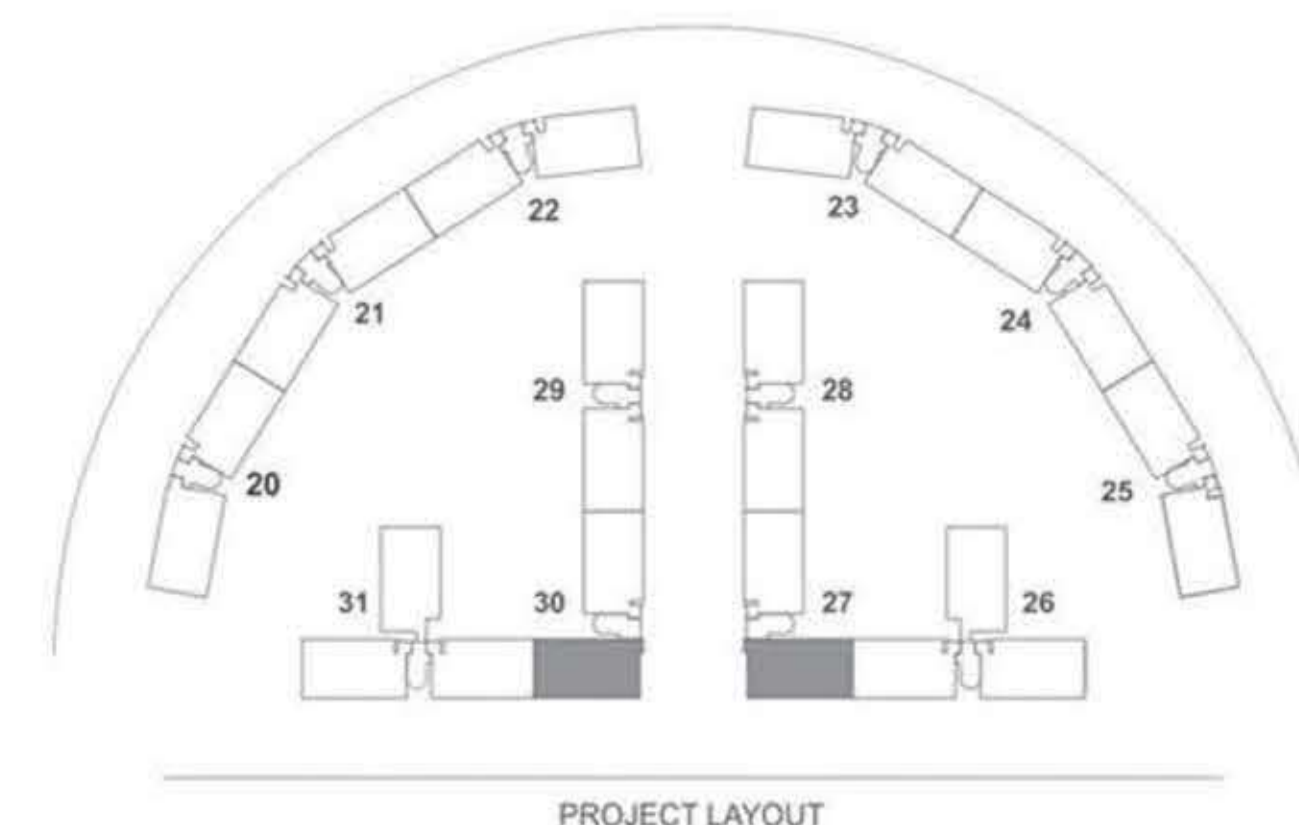



## Quick Access to all Areas Central Location

SITE : GREEN CITY, NEAR GAURAV PATH ROAD, PAL, ADAJAN, SURAT



## There's Much More to Life

Because Green City Gold is not just a home, it's a complete package of a modern and a healthy lifestyle.

Aerobic | Yoga Area | Cafeteria | Zumba





## A walk in Heaven

Just how plush can you imagine the garden outside your home to be? Enjoy your evening walk in the garden with international style landscaping and with a sitting area designed especially for lovely evening hangouts.



## Spend quality time with your loved ones

Provision for Indoor Games to let you enjoy life to the fullest In addition there is a **Small Individual Club House** cum get together area in each building for the residents.

Table Tennis | Carrom Board | Chess Room





## Amenities At a Glance

Temple - As per Hindu mythology, humans are constituted of five elements. The divine Shivling in the temple is made of "Panch Dhatu" and is as pure as the air of the GCG.

Shiv Temple | Library







## Bed Time has to be Special

Spend the most relaxing hours of your day in utmost comfort and luxury. Your master bedroom is designed with pure delicacy and thoughtful privacy. Master bedroom toilet is constructed with Satvari finish tiles dado of 1200X600mm & black vitrified tiles flooring of 600X600mm and the floor has Italian design tiles.



## A Place that Knows All your Secrets

Living area reflects our lifestyle. It is the liveliest part of the house. It is where we fight, love, receive our guests, share family moments, celebrate festivals and do midnight parties. The big living area gives you ample space to move around and live all these moments to the fullest.





## The origin of The Best Aroma

A healthy food is one of the prime ingredients for a healthy lifestyle. Cooking is a tiresome job but our skillfully designed Modern kitchen makes cooking fun as is equipped with fittings for all basic and non-basic necessities. The kitchen dado tiles is 1200 X 600 mm with designer POP structures providing corner finish.



## Family Time

A family that prays together and eats together stays together. Dining area not only serves the purpose of a routine dinner but also becomes the place for sensitive topics, permissions and special dinner. Dining area is intelligently separated from the personal space and is close to kitchen for convenience of serving.



## Nothing but the Best

**Structure and Foundation:** For Earthquake resistance, Green City gold provides RCC frame structure with design as per code. For the first time in Surat, Green City Gold offers enhanced structure for safety against earthquake by providing cast in situ RCC pile and raft foundation, a cast which is generally used during the construction of flyovers, bridges etc.

**Flat Specifications:** Your dream home comes with ample space to paint your imagination with colours of reality.

**Flooring and Fittings:** Avail the luxury of wooden flooring in 2 bedrooms and 3 split units of Mitsubishi or equivalent brand for air conditioners.

**Design :** POP Cornish to accentuate the design in hall, kitchen, family sitting and passage.

**Kitchen :** Modern Kitchen equipped with fittings for all basic necessities. The kitchen dado is of 1200 X 600 mm

**Walls :** Decorative acrylic based rustic texture worn with weather shield color in exterior wall finish.

**Balcony :** Balcony railing is of SS finish

**Bathe in luxury :** A good day starts with a good bath. Enter in an indulgent bath space with Jaguar/Kohler taps and wash basins to make you feel good during the most relaxing time of the day.

**Toilet :** Skilfully designed toilet with efficient flush system.

**Tiles :** The Living, kitchen, dining and family sitting have Italian style Dyna finish tiles in a size of 1200 X 600 mm. Beautiful Granite and marble/tiles have been used for floors, staircase and terrace.

**Doors and Windows :** The main door comes with Viner finish and all the internal doors are flush doors with standard paint. Toilet door frame is made up of granite and other door frame is made up of Salwood. All window sections are domal type.

**Laundry Area :** We have provided dedicated wash area for washing and drying of clothes which includes appropriate plumbing points and electrical sockets to connect washing machine, gas geysers etc.

## Additional Facilities

**Car Parking :** Feel free to park your vehicles with safety in the allotted parking area sufficient enough for parking two cars.

**Elevator :** Imagine you live on the seventh floor and you come with loads of shopping bags in your hand or accompanied by elders and children. Do not Worry! At Green City Gold, you move up and down carefree with automatic branded elevators which are functional 24\*7 and can carry up to 8 passengers at a time.

**Lounge area :** Lounge area has been provided building wise for drivers & servants at the ground floor foyer.

**Sports Time :** Your evenings and weekends will not be monotonous. There is a small private club house for each building which has a provision for indoor games like T. T., pool table, carom; etc.

## Comfort Living

**Geyser :** Every flat comes with gas geyser that has a capacity of 16 liter and two gas connections for kitchen and geyser.

**Generator :** An uninterrupted supply of electricity with 24X7 power back-up ensures your life goes as smooth as possible. This power back up is provided for a total of 10 points area including lights and fans in bedrooms, living and kitchen along with back up point for refrigerator.

**Intercom :** Connect quicker in times of any emergency or otherwise with intercom facility across the whole campus.

**Water Supply :** Live carefree with 24x7 water supply backed by private supply. We have also taken care of rain water harvesting to ensure maximum utilization of fresh and natural water.

## Safety Parameters

**CCTV surveillance :** Your safety is one of our prime concerns and therefore, the complete area is under CCTV surveillance.

**Wire and Switches :** All the wires and switches are good brand stuff to ensure safety at the very basic level. All switches installed are of RR or equivalent brand.

**Fire-Fighting System :** Fire control system is installed in the campus area as per NBC standards.



A PROJECT BY



SINCE 1983

DEVELOPERS

FINANCE BY

THIS PROJECT IS FUNDED BY

TATA CAPITAL  
HOUSING FINANCE LIMITED

Home loans are brought to you by  
Tata Capital Housing Finance Limited  
and are at their sole discretion.  
Terms and conditions apply.

RERA NO. : PR/GJ/SURAT/CHORASI/SUDA/RAA00815/241117

BOOKING CONTACT : 090166 60660

BOOKING ADDRESS : GREEN GROUP OFFICE , B/S CHOKSYWADI  
NEW RANDER ROAD, SURAT, GUJARAT, INDIA. T: 0261 2796400

e : [contact@greengroup.co.in](mailto:contact@greengroup.co.in) | w : [www.greengroup.co.in](http://www.greengroup.co.in)

w : [www.gujrera.gujarat.gov.in](http://www.gujrera.gujarat.gov.in) |



Green Group Associates :



ARCHITECT & LANDSCAPE



STRUCTURE CONSULTANTS



BHAGAT & ASSOCIATES

MEP CONSULTANT



This is not an offer or an invitation to offer. Designs, costs, facilities, plans and specifications in static and/or interactive publicity material depict anticipated appearance of completed development and are subject to change without notice.

Design Concept : [edconcept.in](http://edconcept.in) 09099169944 All Rights Reserved



CORPORATE OFFICE : 'GREEN HOUSE' , B/S CHOKSYWADI  
NEW RANDER ROAD, SURAT, GUJARAT, INDIA. T: 0261 2796400

e : [contact@greengroup.co.in](mailto:contact@greengroup.co.in) | w : [www.greengroup.co.in](http://www.greengroup.co.in) | [f](#) [y](#) [t](#) [in](#)



Download Brochure