

COME HOME TO  
PRIVILEGE SPIRITUAL  
LIFESTYLE

Nandani  
  
**Gowlok Dham**  
RESIDENTIAL HIGH RISE APARTMENTS  
**vrindavan**

**MVDA APPROVED**



# vrindavan

A RELIGIOUS HERITAGE



Nandani  
Gowlok Dham  
RESIDENTIAL HIGH RISE APARTMENTS  
Vrindavan



## THE LOCATION



Prem Mandir



Iskcon Mandir



Madan Mohan Temple



Bankey Bihari

## ABOUT VRINDAVAN

Etymologically, the ancient name of the city, Brindavana, comes from its groves of 'Brinda' Ocimum tenuiflorum (Holy Basil or tulasi) with vana (Sanskrit: वन) meaning a grove or a forest. Two small groves still exist at Nidhivan and Seva Kunj. Vrindavan has an ancient past, associated with Hindu history, and is an important Hindu pilgrimage site. One of its oldest surviving temples is the Govinda Dev temple, built in 1590, with the town founded earlier in the same century.

It is believed that the essence of Vrindavan was lost over time until the 16th century, when it was rediscovered by Chaitanya Mahaprabhu. In the year 1515, Chaitanya Mahaprabhu visited Vrindavan, with purpose of locating the lost holy places associated with Lord Sri Krishna's transcendent pastimes. Chaitanya wandered through the different sacred forests of Vrindavan in a spiritual trance of divine love. It was believed that by His divine spiritual power, he was able locate all the important places of Krishna's pastimes in and around Vrindavan.

We, now 400 years later, are willing/planning to do the same with our latest offering. We visualize providing a peaceful abode to people, quenching their spiritual & philosophical needs.

Vrindavan is considered to be a holy place by all traditions of Hinduism. The major tradition followed in the area is Vaisnavism, and it is a center of learning with many Vrindavan Ashrams operating. Its a center of Krishna worship and the area includes places like Govardhana and Gokul that are associated with Krishna. Many millions of devotees of Radha-Krishna visit these places of pilgrimage every year and participate in a number of festivals that relate to the scenes from Krishna's life on Earth.

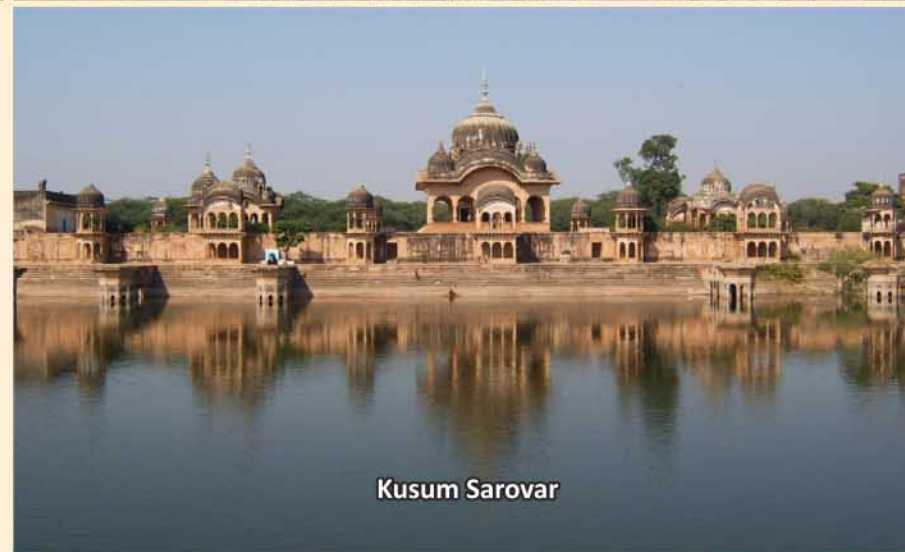

Kusum Sarovar

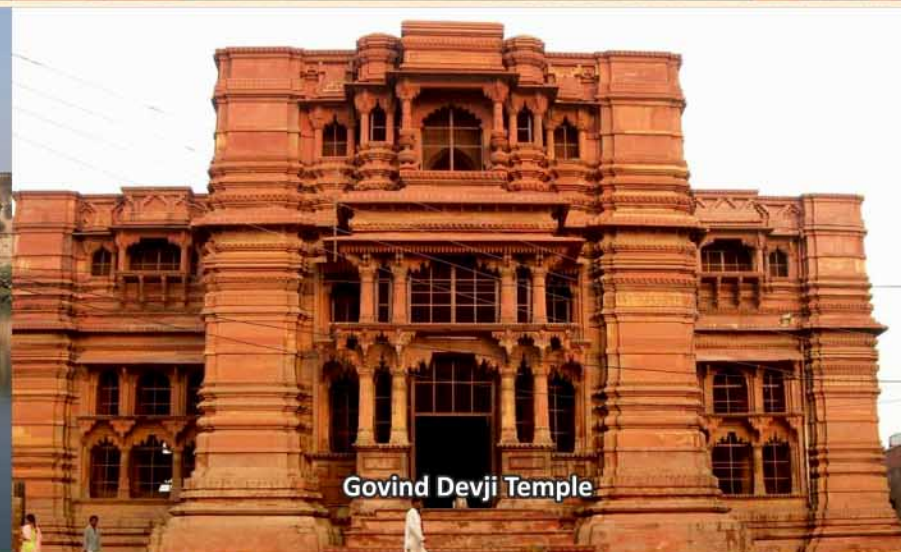

Govind Devji Temple

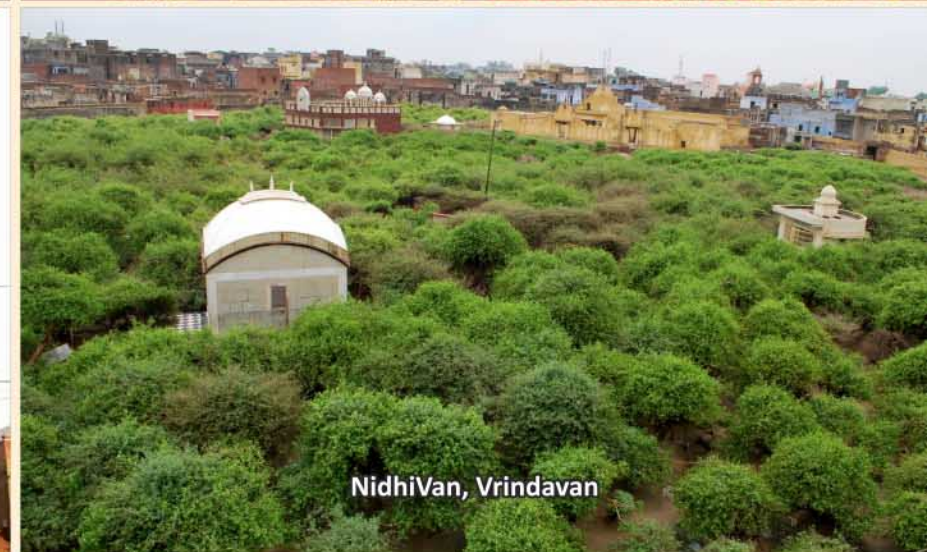

NidhiVan, Vrindavan



Rangji Temple, Vrindavan



Latthamar Holi in Barsana



Keshi Ghat, Vrindavan



Nandani  
Gowlok Dham  
RESIDENTIAL HIGH RISE APARTMENTS  
Vrindavan



# OVERVIEW



**GREAT SURPRISE  
ULTRA PREMIUM FLAT AT  
AFFORDABLE PRICE**

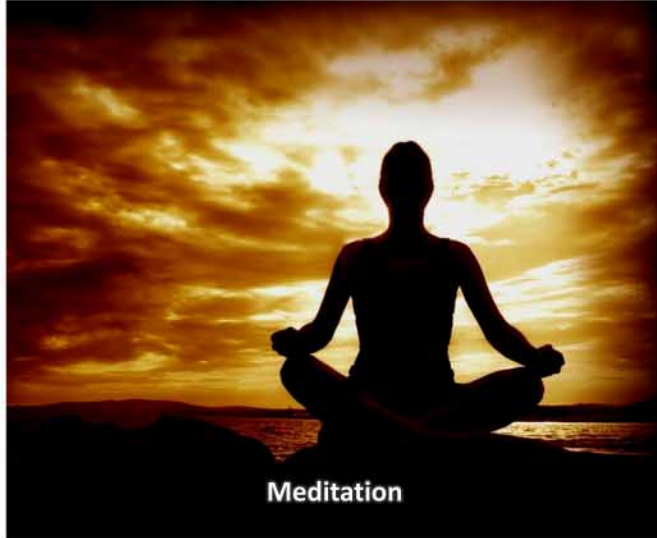

Meditation



Children Park

A PLACE WHERE NATURE  
CONNECTS TO A  
SPIRITUAL LIVING  
A DESIRABLE REALITY...

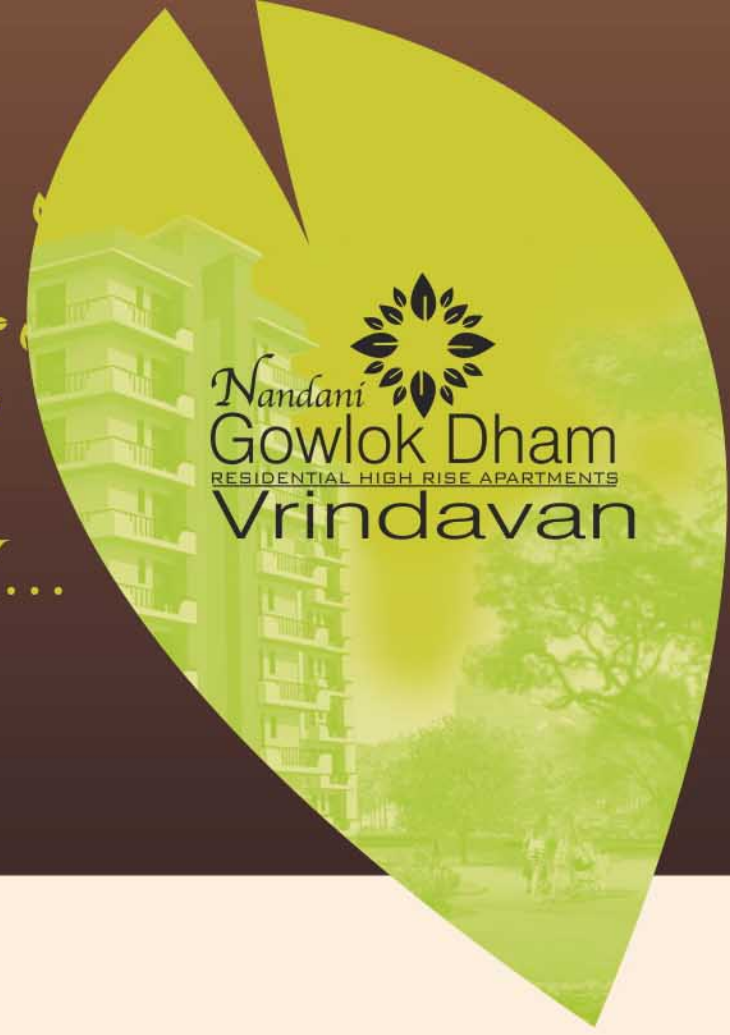

Nandani  
Gowlok Dham  
RESIDENTIAL HIGH RISE APARTMENTS  
Vrindavan



Musical Fountain Park



Swimming Pool



Gymnasium & Health Centre

**Features**

- A Green House Concept
- Bank Finance Available
- Club House
- CC TV Security Cameras
- Children Park
- Gymnasium & Health Centre
- Interest Free easy Installment
- Lift Facility
- Lush Green & Clean Environment
- Luxurious swimming pool with separate baby pool
- Musical Fountain Park
- No.1 Construction Quality
- Power back-up
- Space for outdoor Games
- Stilt Floor car Parking
- Temple with Meditation House
- Total Cross-ventilation
- Wide common area & common Galleries
- 24 hours water supply
- Transportation facility available for Bankey Bihari, Prem Mandir & ISKCON Mandir maintained by society

**A DESIRABLE REALITY...**

*I woke this day in a valley of dream; a sight like this had never been seen; in the distance I saw a glimmer of hope; and the grove gave way to a gentle slope. As I reached the clearing. Oh! What a sight to see; my eyes opened wide, what could this place be? In cascading greens, laden trees drooped, in every corner, nature bloomed; and towering mammoths rose from the ground, casting shadows of luxury all around.*

**GOWLOK DHAM** is a place where nature connects to a recreation destination, social activities and gracious living.



Garden



Club House



CCTV Camera

# LAYOUT PLAN



**STILT + 8 FLOOR**



# 3 BHK

Area: 1750.00 Sqft

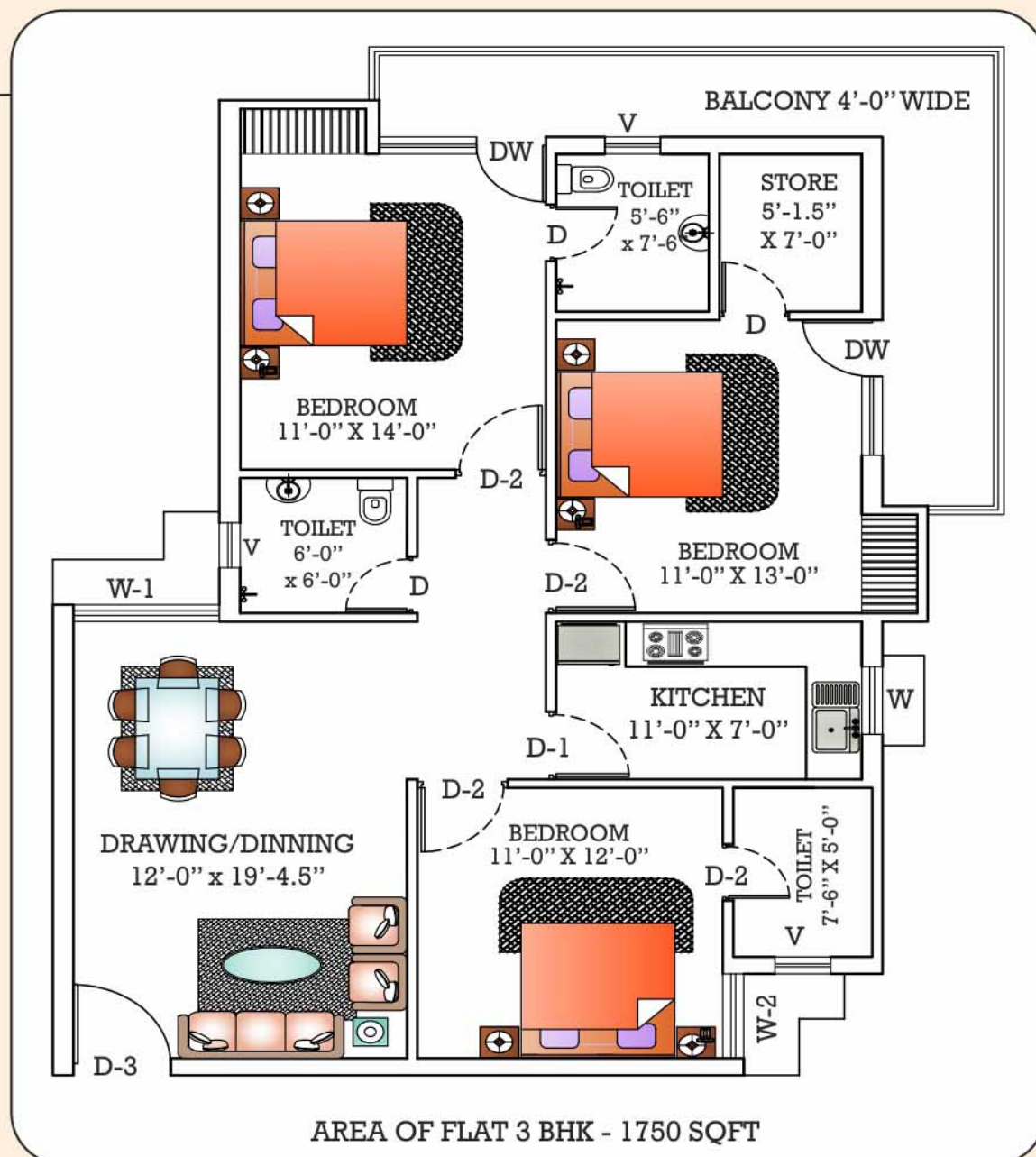

# 2 BHK

Area: 1250.00 Sqft

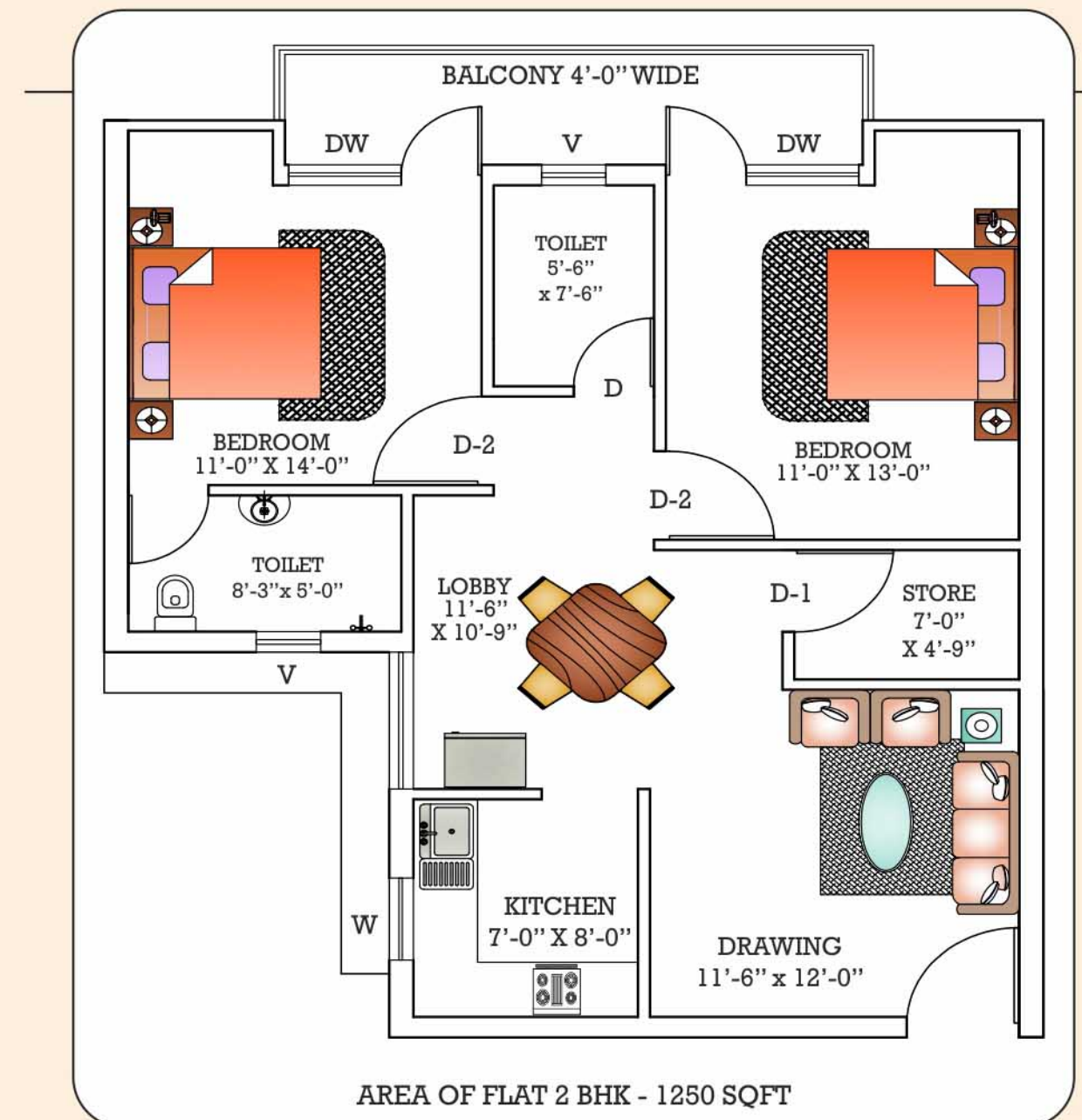

# I BHK

Area: 750.00 Sqft



# STUDIO FLAT

Area: 500.00 Sqft

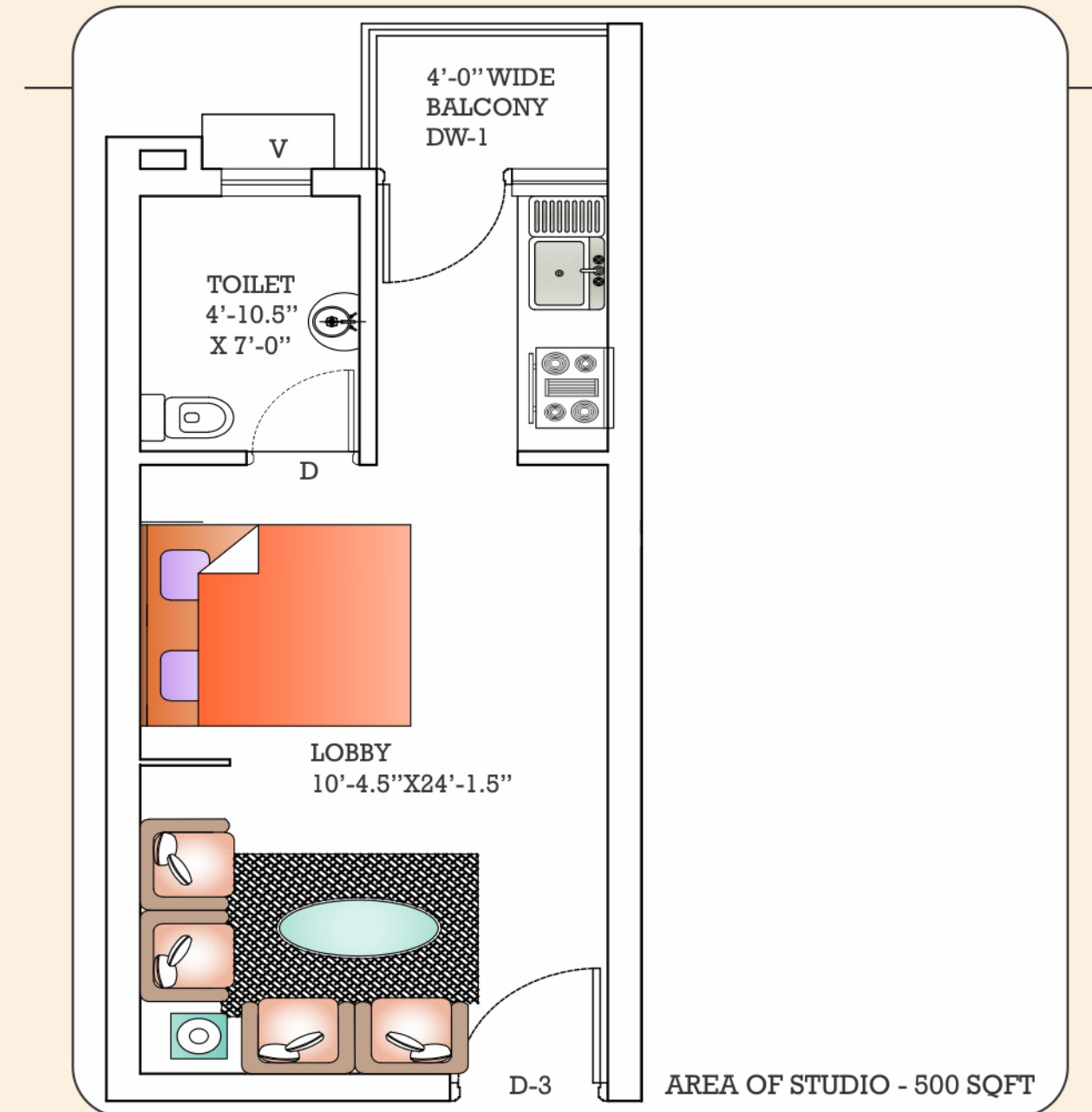
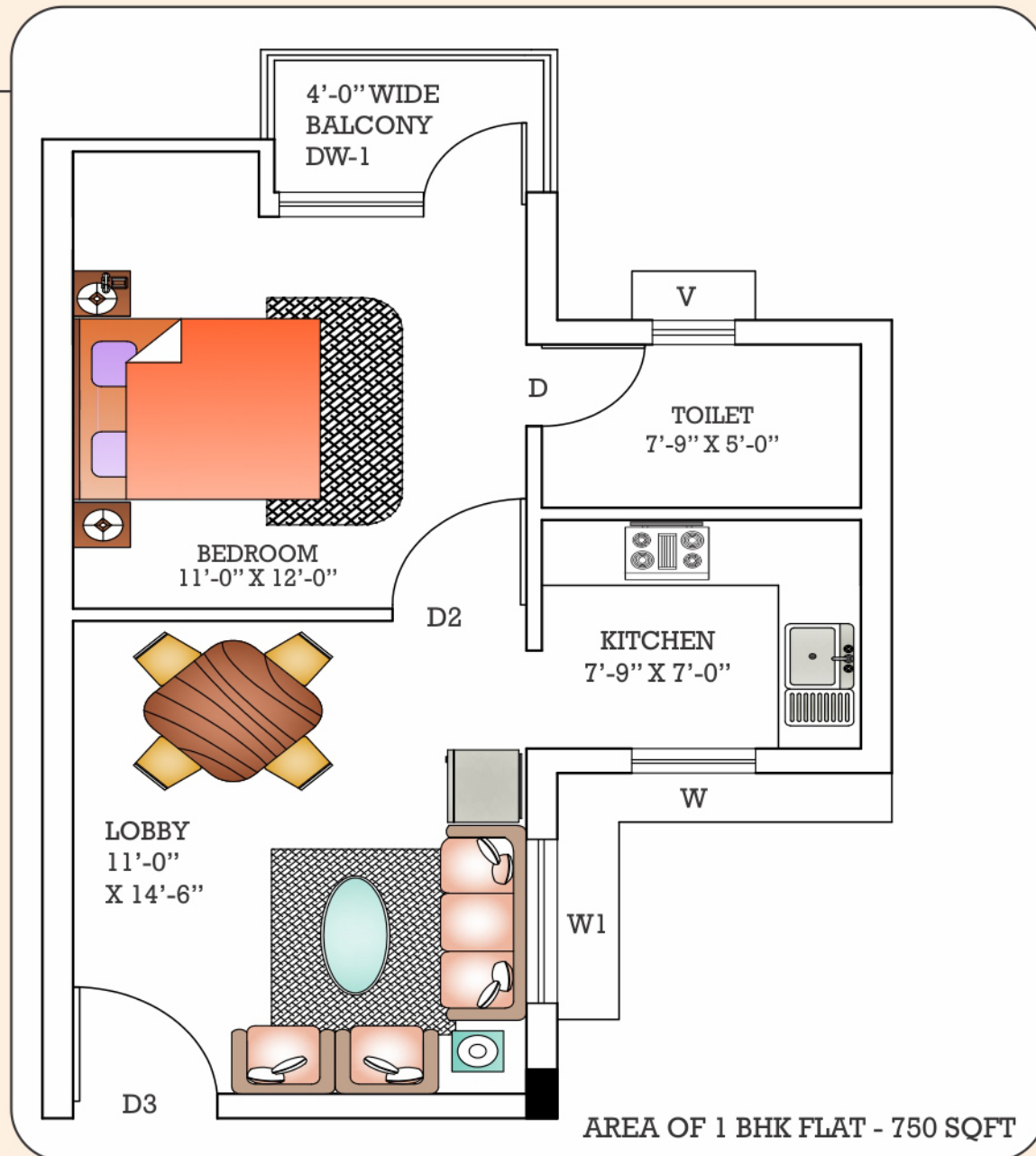

# SPECIFICATIONS

## STRUCTURE

- Earthquake resistant RCC framed structure.

## FLOORING

- Drawing/Dining Bedroom kitchen to have double charged vitrified tiles.

## DOOR & WINDOW

- Exterior door & windows ivory imported teak with S.S. net & glass. Main door & internal doors framed in wooden with Brazilian skin layer.

## HARDWARE

- All door and window will have S.S. fitting with premium quality locks.

## KITCHEN

- Superfine granite platform with 3ft highly glazed ceramic tiles with S.S. sink & individual R. O. unit for drinking water.

## TOILETS

- Ceramic Floor tiles
- Highly luxurious finish tiles on walls up to door level.
- Bathroom fittings of luxurious range.

## INTERNAL FINISH

- White ceiling with emulsion paints.
- Decorative premium emulsion paint in drawing/dining & bedroom.

## ELECTRICITY

- All Copper wiring in PVC pipe concealed conduit fitting.
- Modular switches with Telephone & TV outlets in every room.
- Protective M.C.Bs.

## EXTRA FEATURE WITHOUT CHARGE

- Modular electric fitting.
- Luxury bathroom fitting.
- Shall wooden Chaukhat & teakwood shuttles shatter.
- Double Take door with class 4 S.S. net.
- Complete A.C. fitting.
- Window M. S. Grills.
- S.S. Railing in balconies & common area.



Perspective View





Nav Nikunj

# OUR PROJECTS



Shri Nikunj



Keshav Kunj



Sarang Vatika



Ashram Vihar

location map



## Krishna Kanha Residency Pvt. Ltd.

Regd. Off. : 17, Chaitanya Vihar Phase-1, Vrindavan (Mathura) U.P.  
 Tel : 09760120000, 09837128001, 09411000007, 0565-2540019, 2540130  
 Website: [www.gowlokdham.com](http://www.gowlokdham.com), e-mail: [martanddev\\_333@yahoo.co.in](mailto:martanddev_333@yahoo.co.in)