



.... प्रमुख  
ELYSIUM

2 BHK EXCLUSIVE  
APARTMENTS & SHOPS

Elegant, refined and exclusive, the homes have much to offer. From the lush green surroundings to the breath-taking view to the intricate detailing of each home, these warm and spacious 2 BHK apartments are indeed the quintessence of the good life. So if you love the classics, then you'll feel right at home here.



..... प्रमुख  
ELYSIUM





ENJOYING OUTDOOR

प्रमुख  
ELYSIUM



LANDSCAPE GARDEN



FITNESS CENTER



SPACE FOR YOGA



CHILDREN PLAY AREA



SENIOR CITIZEN SITTINGS



DROP-OFF ZONE



POWER BACK-UP



GOOD QUALITY LIFT



BASEMENT PARKING



24 HRS. SECURITY



24 HRS. WATER



COMMITTEE ROOM

TYPICAL FLOOR PLAN

18.00 MT. WIDE ROAD



7.5 MT. WIDE ROAD

9 MT. WIDE ROAD

7.5 MT. WIDE ROAD

9 MT. WIDE ROAD

18.00 MT. WIDE ROAD



# 2 BHK

BLOCK A

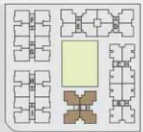
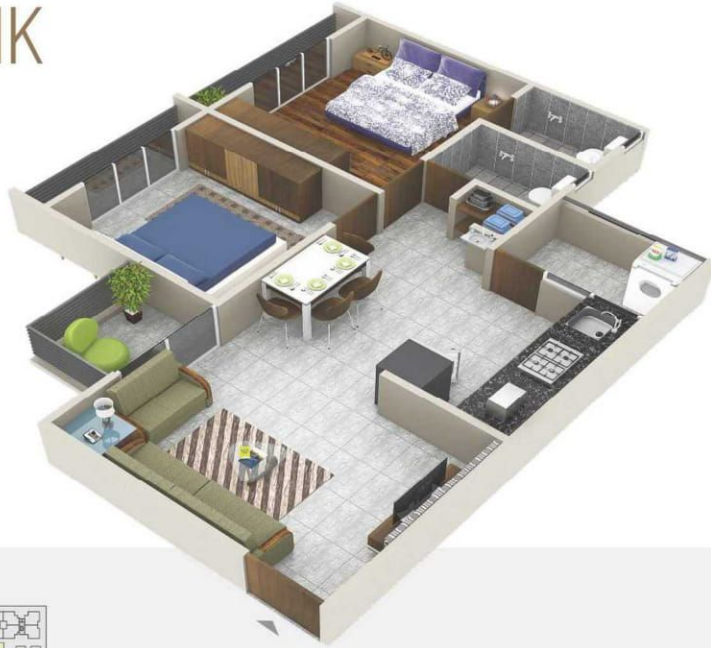

# 2 BHK

BLOCK B, C

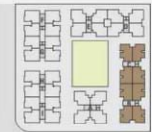

# 2 BHK

BLOCK D, E CORNER UNIT

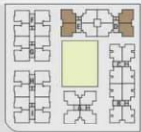
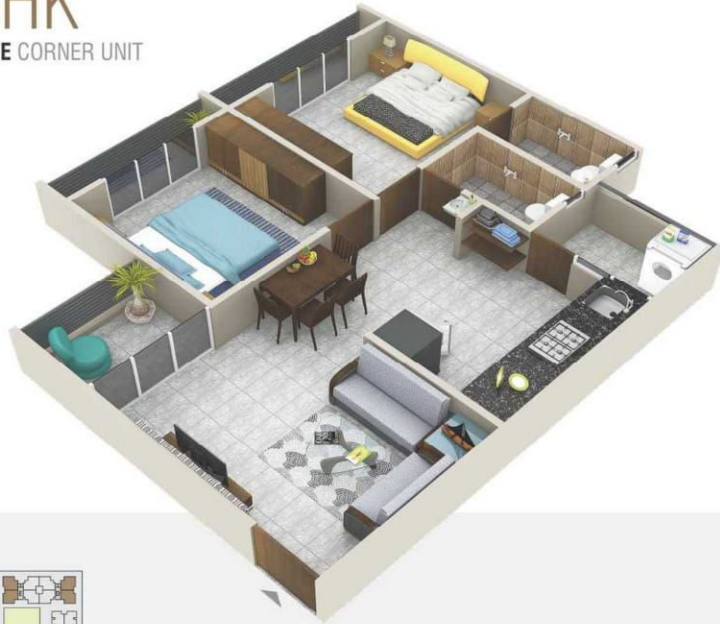

# 2 BHK

BLOCK D, E CENTER UNIT

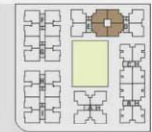

# 2 BHK

BLOCK F, G, H, I

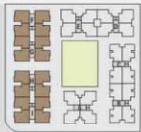
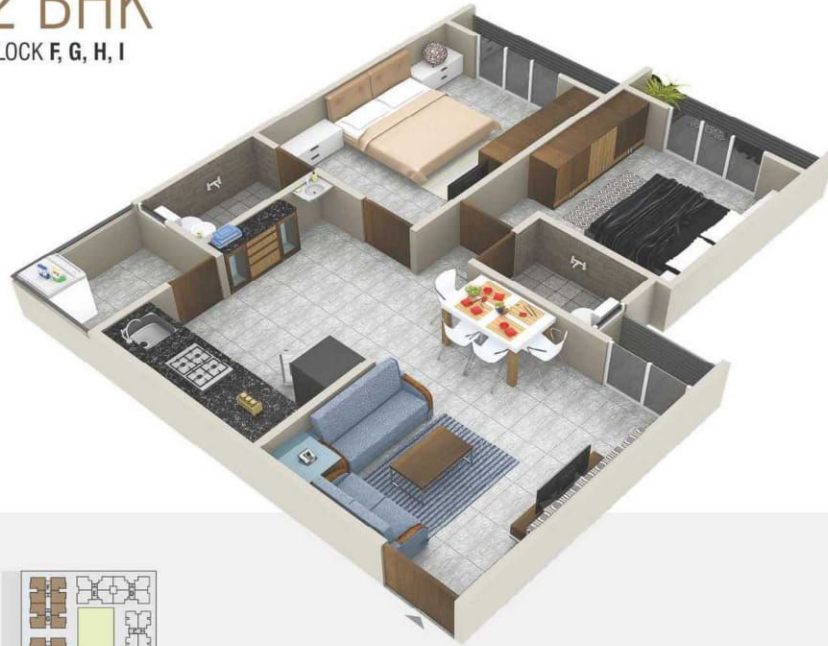

## SPECIFICATIONS

**Structure**  
Earthquake resistant R.C.C. frame structure as per by laws.

**Flooring**  
Vitrified tiles in the entire flat. Chaina mosaic in all terraces.

**Kitchen**  
Mirror polished granite platform with S.S. sink. Glazed tiles dado up to lintel level.

**Wall finish**  
Internal mala plaster with white putty. External double coat sand faced plaster with acrylic paints.

**Doors & Windows**  
Decorative Wooden main door.  
All other doors are flushed door.  
Fully glazed powder coated aluminum section in all windows.

**Toilets**  
Glazed tiles in floor & dado upto lintel level. CP fittings of leading brand.

**Electrification**  
Concealed copper wiring with Modular switches & sufficient number of points.  
A.C. point in all Bedrooms. T.V. point in Drawing room. MCB in each apartment.

प्रमुख  
**ELYSIUM**





प्रमुख  
**ELYSIUM**





..... प्रमुख  
ELYSIUM



**PSY Group ( Nilay Desai )**

704, 7th floor, Pratik Mall, Nr. Swaminarayan Dham,  
Koba-Gandhinagar High way, Gandhinagar 382421.  
Ph. 079- 2360 0158, (Cheques in favour of **PSY ORGANIZER**)  
Web : [www.psyprojects.com](http://www.psyprojects.com)

Architect  
**GREY LEAF**  
98250 07071

Structure Engineer  
**Torsion**  
Vasant Soni

Partners

98258 67305 - Bankim Joshi  
94260 09520 - Rakesh Shah  
98254 14342 - Sanjay Ladhawala  
98792 04165 - Mahesh Prajapati

E-mail : [inquiry.psygroup@gmail.com](mailto:inquiry.psygroup@gmail.com)

Web : [www.pramukhelysium.com](http://www.pramukhelysium.com)

Marketing Executive

97236 17635 - Devraj Rana      91571 55943 - Rajkumar Rathod  
95745 92863 - Hitesh Nanavati      90990 34145 - Kiran Desai

Site : **Pramukh Elysium**, Beside Zion Bungalows, Opp. Pramukh Oasis, S.G. Road, Sargasan, Gandhinagar.

**NOTES** ● Developers reserves the rights for alteration of specifications and design. ● GEB, GUDA, Legal expenses, Service Tax & other GOVT. Charges if any, Stamp duty, Registration fees & Maintenance deposit shall be borne by the members. ● All dimensions are approximate, average & subject to variations. ● Irregular payment shall cause cancellation of booking without any prior notice & deposited amount will be refunded after new booking with 10% deduction of total amount as administration charge.  
● This brochure is not to be treated as part of the legal document. It is only for easy display of the project.

RERA NO: PR/GJ/GANDHINAGAR/GANDHINAGAR/Others/MAA01741/230218