

**FUTURE WILL BE
BEAUTIFUL,
WHEN THE PAST
INSPIRES
THE PRESENT.**

IT'S TIME TO THINK.







ONCE UPON A TIME...
**THERE WERE
STORIES
ABOUT TREES
& BIRDS**

IT'S TIME TO BRING BACK THOSE STORIES...



ONCE UPON A TIME...

THERE WAS
A CHILD WHO
DREAMT OF
WINNING
A CYCLE RACE



IT'S TIME TO BRING BACK THOSE VICTORIES...



ONCE UPON A TIME...

THERE WAS
THE GRANDMA
WHO PLUCKED
FRESH
TOMATOES



IT'S TIME TO BRING BACK THAT FRESHNESS...



ONCE UPON A TIME...

THERE WAS
A BOY WHO
CHASED
BUTTERFLIES



IT'S TIME TO BRING BACK THAT EXCITEMENT...



ONCE UPON A TIME...
THERE WERE
GARDENS
THAT WERE
THE GYM



IT'S TIME TO BRING BACK THAT JOY...



ONCE UPON A TIME...

THERE WERE MISCHIEVOUS MANGO EATING ADVENTURES



IT'S TIME TO BRING BACK THOSE ADVENTURES...





PRESENTING



arkade earth

return to roots

Kanjurmarg (E)

1, 2 & 3 BHK NATURE-RESIDENCES



RUN



JOGG



CHASE



HIDE 'N' SEEK

4 ACRES OF HAVEN BUILT ON EARTH, LIKE EARTH.



BREATHE



RELAX



RELIVE



REJOICE



CHILDREN & INNOCENCE

- Skating Rink
- Tennis Court
- Basketball Court
- Kid's Pool
- Children's Play Area.



SIGHT & SOUND THERAPY

- Fruit Bearing Trees
- Hammock Garden
- Meditation Deck



BODY. MIND & SOUL

- Swimming Pool
- Jacuzzi
- Gazebo
- Squash Court
- Gymnasium.



PEOPLE & MOMENTS

- Amphitheatre
- Indoor Games Room
- Multipurpose Hall



RAISING A CHILD
IS LIKE TENDING
A GARDEN.
YOU HAVE TO
GIVE IT THE RIGHT
ENVIRONMENT.

CHILDREN & INNOCENCE
ACTIVE ZONES FOR HEALTHY GROWTH YEARS

- Skating Rink
- Tennis Court
- Basketball Court
- Kid's Pool
- Children's Play Area





NATURE IS A PAINTER,
SINGER, FARMER
AND A
PHILOSOPHER,
ALL AT THE
SAME TIME.

SIGHT & SOUND THERAPY
LEISURE ZONES FOR THE MUCH NEEDED RELAXATION

- Fruit Bearing Trees
- Meditation Deck
- Hammock Garden





ROUTINE FOR YOUR BODY, RETREAT FOR THE MIND, A NEW WEALTH OF JOY FOR THE SOUL.



BODY. MIND & SOUL

INDULGENCE ZONES THAT REDEFINE FRESHNESS

- Swimming Pool
- Jacuzzi
- Gazebo
- Squash Court
- Gymnasium.



WHEN YOU MEET,
GREET AND
INTERACT,
YOU EXPRESS,
OPEN-UP &
RECLAIM LIFE.

PEOPLE & MOMENTS

SOCIALISING ZONES FOR ENGAGING CONVERSATIONS

- Amphitheatre
- Indoor Games Room
- Multipurpose Hall





CABANAS AMIDST DESIGNER LANDSCAPE



GRAND CLUBHOUSE & AZURE SWIMMING POOL



PLAY COURTS & OPEN-AIR AMPHITHEATRE



BLISSFUL GREEN SPACES FOR SOLACE

Artist's Impression



LIFESTYLE THAT TOWERS ABOVE LUSH GREENERY

Artist's Impression



AERIAL NIGHT VIEW



KANJURMARG EAST - THE DESTINATION OF NEW DEVELOPMENTS

Kanjurmarg - A destination that is one of the fastest growing suburbs in Mumbai. With serene ambience comes along connectivity of major landmarks & places within 10 mins drive. Overall, it is an ideal address to live at with enormous scope of growth and new standard of living.

Education

- Podar International School
- Hiranandani International School
- Bombay Scottish School
- IIT Powai
- K J Somaiya Campus

Hospitals

- Fortis Healthcare
- Dr. LH Hiranandani Hospital

Conveniences

- R City Mall
- Powai Galleria
- D Mart
- Haiko Mall

SITE LAYOUT PLAN & AMENITIES

TOWERS

- A - Aspen
- B - Blue Bell
- C - Carnation
- D - Daffodil
- E - Ebony
- F - Fern
- G - Gardenia
- H - Hazel

LEGENDS

Landscape Amenities

- 01) Urban Plaza
- 02) Drop off Plaza to Towers
- 03) Flag Hoisting Pole
- 04) Lawn
- 05) Adult Swimming Pool
- 06) Kid's Swimming Pool
- 07) Amphitheatre
- 08) Infinity Pool Edge
- 09) Pool Deck
- 10) Garden Lounges
- 11) Open Shower
- 12) Meditation Deck

- 13) Children's Play Area
- 14) Agriculture Field
- 15) Basketball Court
- 16) Tennis Court
- 17) Sparrow Housing Colonies
- 18) Amenity Space
- 19) Clubhouse

Club Building Amenities

- Gymnasium
- Squash Court
- Multipurpose Hall
- Indoor Games Room
- Skating Rink on Club Terrace



*TO BE DEVELOPED IN PHASE WISE MANNER AS REGISTERED WITH MAHARERA.
 *FOR MORE DETAILS, PLEASE VISIT "maharera.mahaonline.gov.in"

TYPICAL FLOOR PLAN - ASPEN

MahaRERA No.: P51800006579

Sr. No.	RERA Carpet in Sq.Ft.	RERA Carpet in Sq. Mt.
1	466	43.29
2	682	63.36
3	678	62.99
4	723	67.17

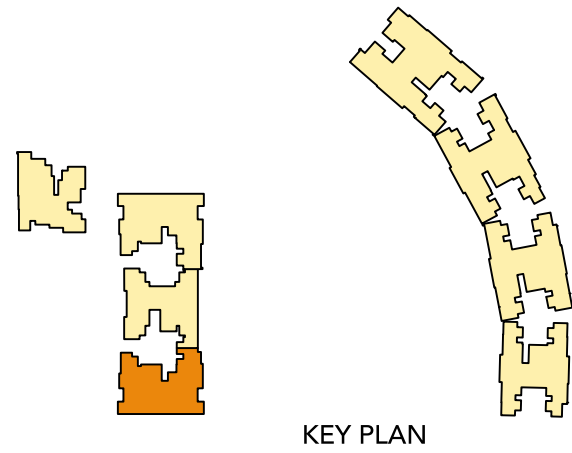

KEY PLAN

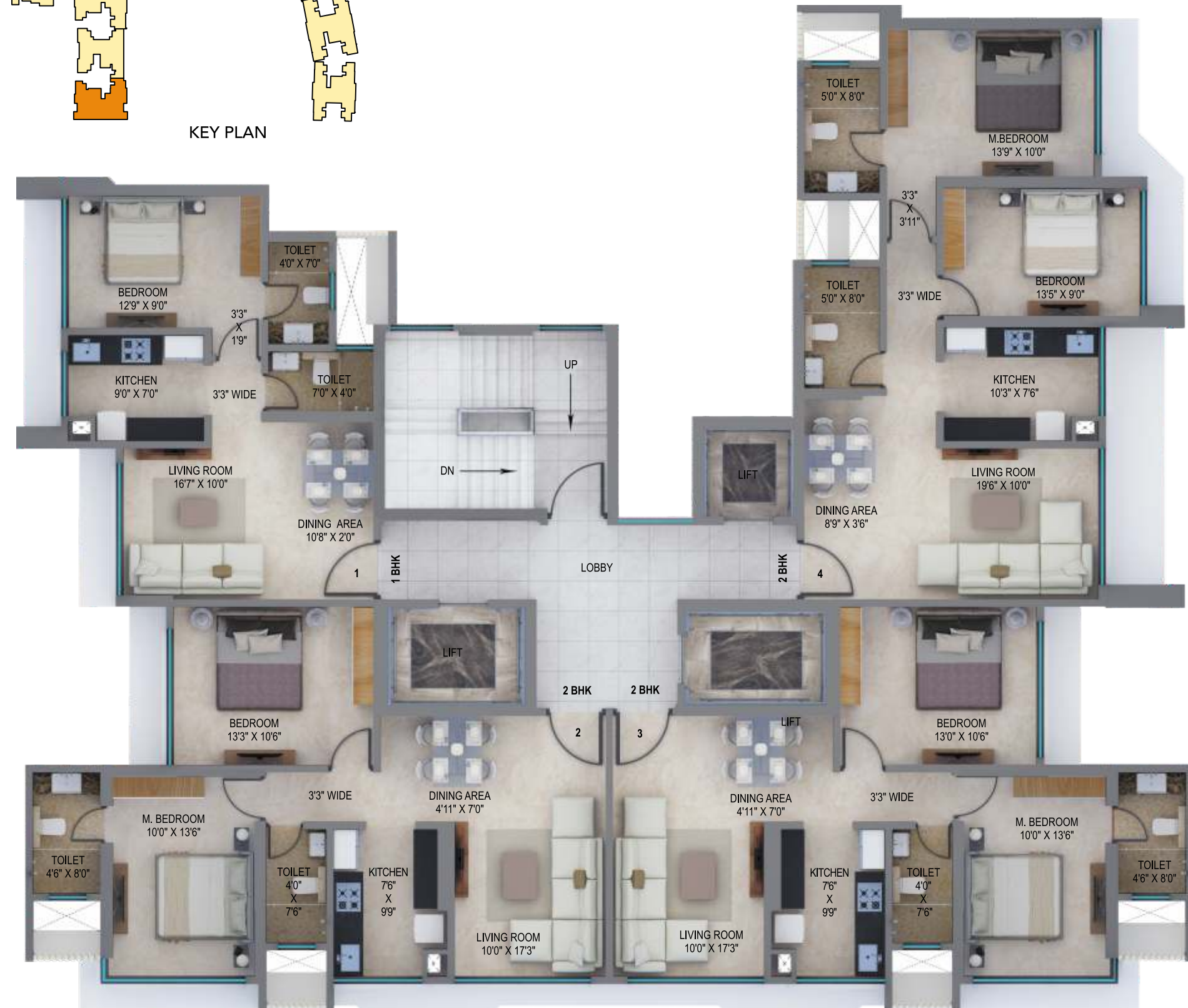

TYPICAL FLOOR PLAN - BLUEBELL

MahaRERA No.: P51800011586

Sr. No.	RERA Carpet in Sq.Ft.	RERA Carpet in Sq. Mt.
1	466	43.29
2	466	43.29
3	466	43.29
4	466	43.29

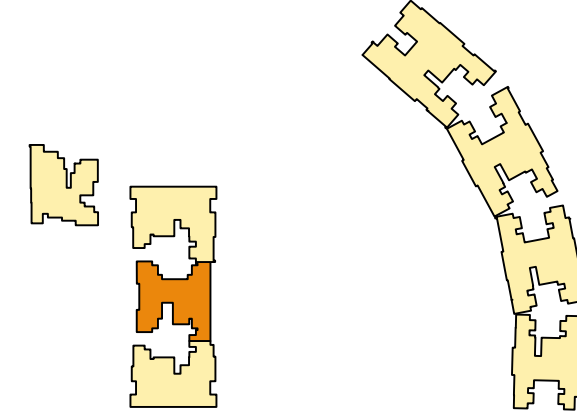

KEY PLAN



TYPICAL FLOOR PLAN - CARNATION

MahaRERA No.: P51800014422

Sr. No.	RERA Carpet in Sq.Ft.	RERA Carpet in Sq. Mt.
1	466	43.29
2	682	63.36
3	678	62.99
4	723	67.17

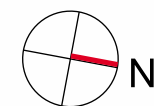
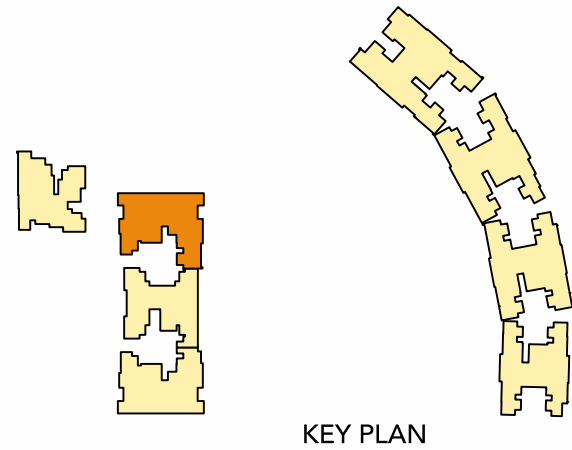
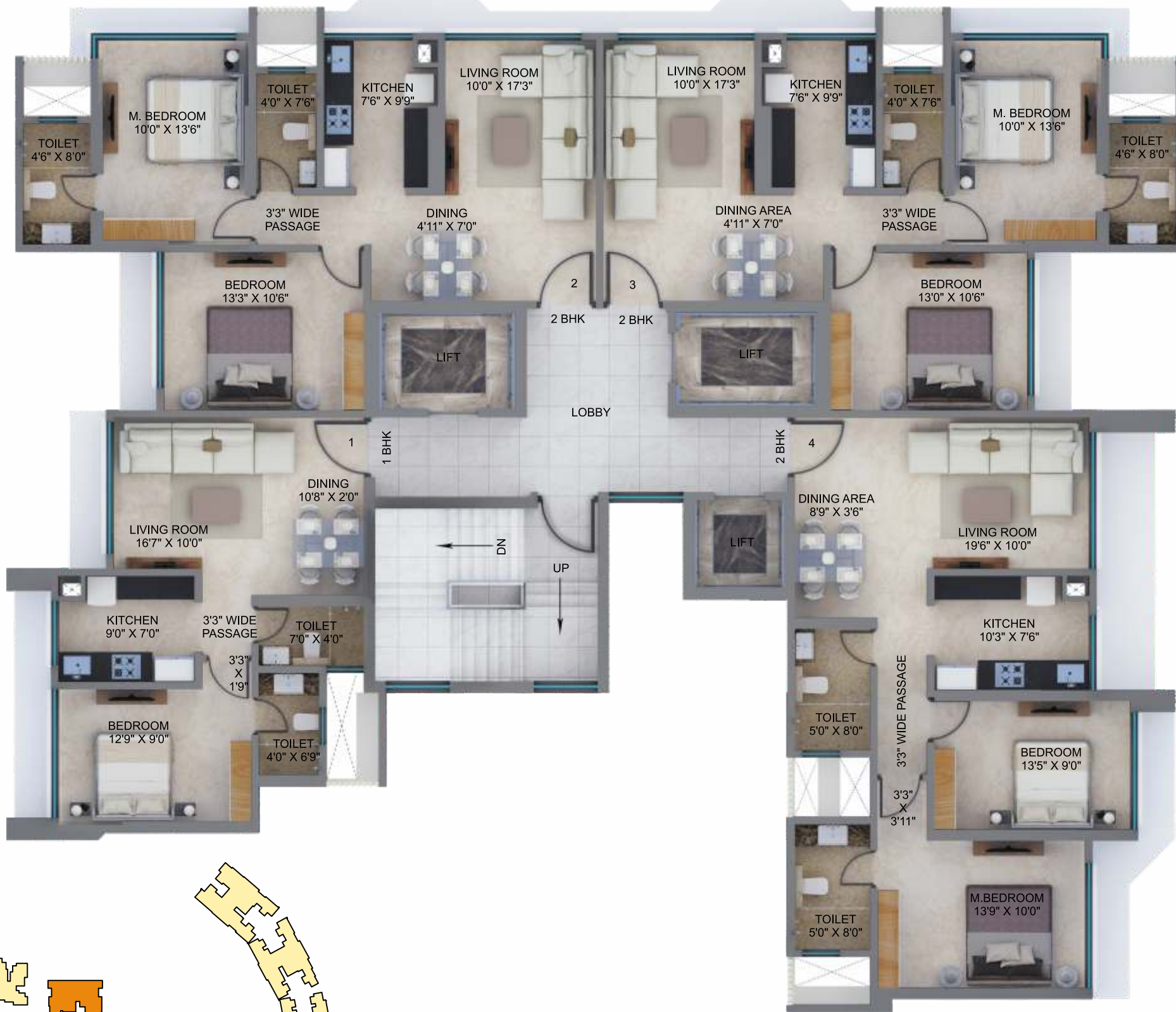

TYPICAL FLOOR PLAN - DAFFODIL

MahaRERA No.: P51800004440

Sr. No.	RERA Carpet in Sq.Ft.	RERA Carpet in Sq. Mt.
1	780	72.46
2	1099	102.10
3	973	90.39
4	780	72.46

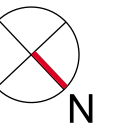
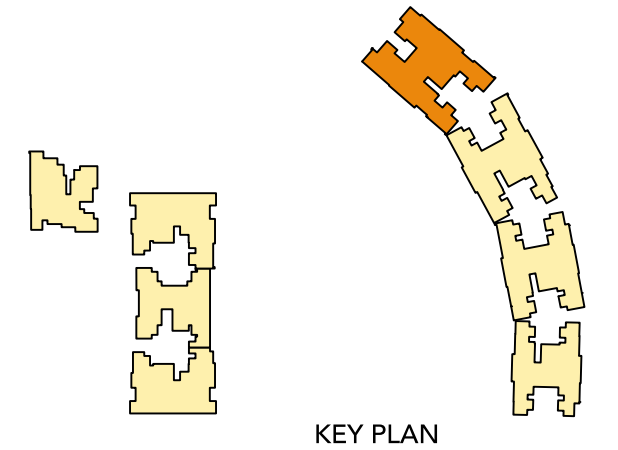

TYPICAL FLOOR PLAN - EBONY

MahaRERA No.: P51800008953



Sr. No.	RERA Carpet in Sq.Ft.	RERA Carpet in Sq. Mt.
1	707	65.68
2	707	65.68
3	780	72.46
4	784	72.84

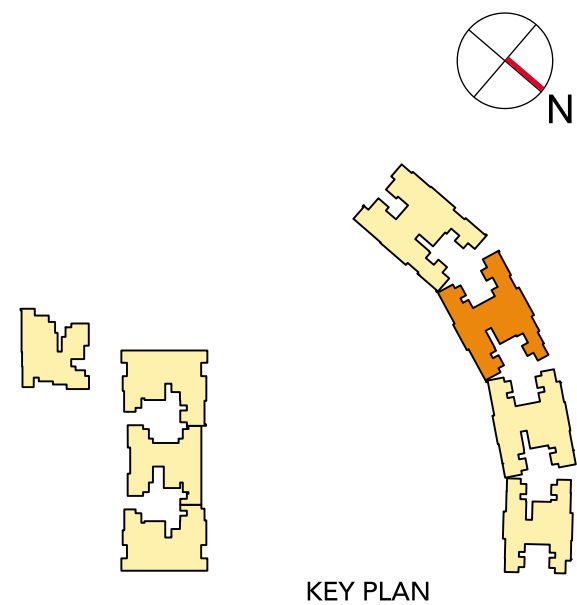

TYPICAL FLOOR PLAN - FERN

MahaRERA No.: P51800004750



Sr. No.	RERA Carpet in Sq.Ft.	RERA Carpet in Sq. Mt.
1	677	62.89
2	707	65.68
3	681	63.27
4	677	62.89

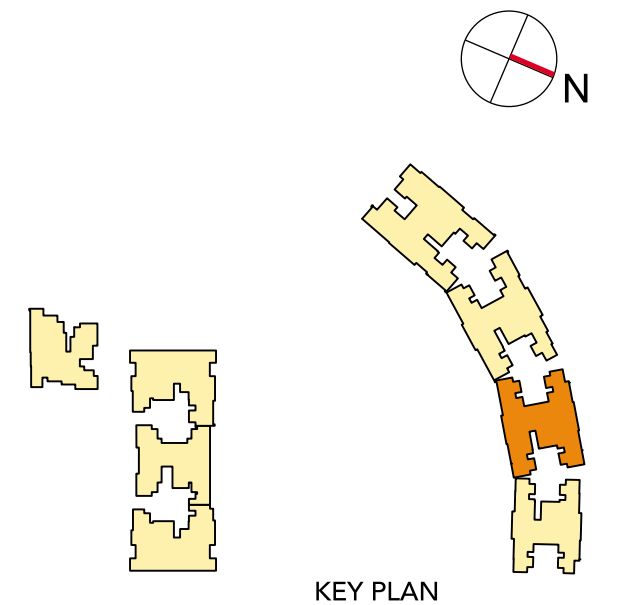

TYPICAL FLOOR PLAN - GARDENIA

MahaRERA No.: P51800010074



Sr. No.	RERA Carpet in Sq.Ft.	RERA Carpet in Sq. Mt.
1	562	52.21
2	562	52.21
3	562	52.21
4	562	52.21

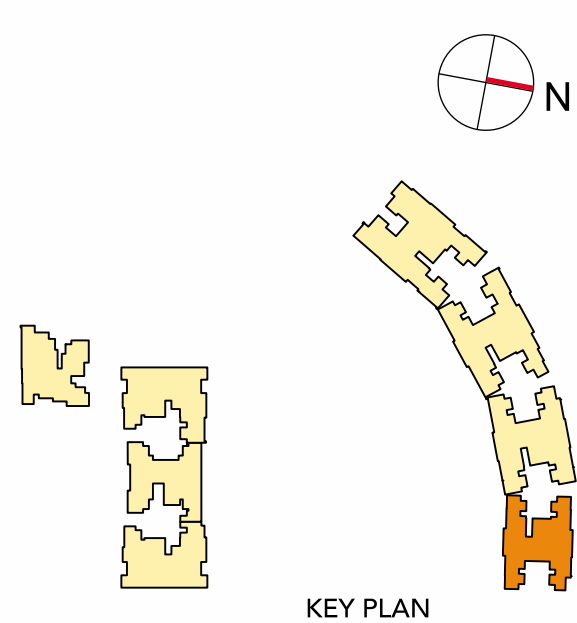

SHAPING THE PRESENT. WELCOMING THE FUTURE, THAT IS NOW.

When vision goes beyond what we see, it reaches a new world that is yet to take shape. At Arkade, looking at future, we reinvent the present. We build symbols of desires, shapes of dreams that epitomise living. As a progressive enterprise, our each effort goes in finding a value that we are able to transfer to our customers, and transform lives while we are at it. For us, future is not tomorrow, it is now, taking shape in front of us.

MILESTONES & BENCHMARKS

- 3000+ HAPPY FAMILIES
- 2.5 MILLION SQ. FT. DEVELOPED TILL DATE
- 1.5 MILLION SQ. FT. DEVELOPMENT IN PROGRESS

FLAGSHIP COMPLETED PROJECTS



WALLACE FORTUNA, MAZGAON | JEEVAN SARITA, VILE PARLE (E) | ARKADE ADORNIA, GOREGAON (E)

ICONIC ONGOING PROJECTS



ARKADE RISE, CARMICHAEL ROAD | ARKADE ART, MIRA ROAD (E) | ACROPOLIS, VIRAR (E)





Site: Junction of Seth Govind Ram Jolly Marg & Kanjur Village Road, Off JVLR, Kanjurmarg (E), Mumbai - 400 042

Tel.: **92228 92229**, Website: www.arkadegroup.com

Corporate Office: Arkade House, Next to Children's Academy, Ashok Nagar, Kandivali (E), Mumbai - 400 101

MahaRERA
Registration No.

Aspen
P51800006579

Bluebell
P51800011586

Carnation
P51800014422

Daffodil
P51800004440

Ebony
P51800008953

Fern
P51800004750

Gardenia
P51800010074

For more details visit:
maharera.mahaonline.gov.in

Disclaimer : The information/details contained in this Brochure are purely indicative and may/may not form part of the final Project. The Information/ representation made/shown in this Brochure is only designer's/architect's conception with the intention to depict tentative concept of the Project and is only indicative of the envisaged developments and the same is subject to approvals from local authorities. We reserve our rights to make additions, deletions, alterations or amendments as and when it deem fit and proper and in accordance with applicable laws. No representation or warranty is made or intended and no commitments are being given under this Brochure as to the accuracy or totality of the "Arkade Earth" Project as represented under this Brochure.

The Planning as shown in this Brochure may vary/differ due to construction contingencies and site conditions, etc., consequently actual development and any other aspect may differ from what is portrayed herein. All layouts, plans, specifications, dimensions, designs, measurements and locations are indicative and not to scale and are subject to variation as may be required. All dimensions are approximate and subject to construction variances. Interior designing shown in the flat/unit is only for representation purpose.

The picture of the proposed Residential Flat/Unit and all furniture's, fixtures, items, electronic goods, amenities, landscaping, accessories etc. specified therein are only for the purpose of show casing the Residential Flat/Unit and we are not liable / required to provide any furniture, items, electronic goods, amenities, accessories etc. as displayed in the Brochure. The views shown in the Brochure may vary over period of time. All intending purchaser/s are bound to inspect all plans and approvals and acquaint with the relevant information in this Project.

You are therefore required to verify all the details, including area, amenities, services, terms of sales and payments and other relevant terms independently with the sales team/ company prior to concluding any decision for buying any unit(s) in the above Project. In any event, we shall not be liable for any expense, claim, loss or damage of whatsoever nature, caused due to reliance placed upon the depiction made in this Brochure of Project.