Aarbur
POINT



MODERN & ASPIRATIONAL APARTMENTS ON GARIA MAIN ROAD



Aarbur POINT is an exclusive G+5 Storied edifice coming up on NSC Bose Road (Garia Main Road). Located just a stone's throw away from Garia Metro Station, the project boasts of excellent connectivity to all major parts of the city.

Offering state of the art specifications, it comprises of a mix of 2BHK and 3BHK residential units and premium retail space on the Ground and First Floors. The breezy, cross ventilated, contemporary homes are your perfect companion for a life time.



INTERNAL

SPECIFICATIONS

WALL FINISH

- Interior - Conventional brickwork with plaster of paris

FLOORING

- Vitrified tiles in living, dining and bedrooms
- Anti-skid tiles in Bathroom & Kitchen

TOILET

- White sanitary ware of reputed make
- Glazed tiles on the wall up to door height
- CP fittings of ESSCO make or equivalent
- Electric point for geyser and exhaust fan
- Plumbing provision for hot & cold water line

ELECTRICALS

- AC points in master bedroom
- Cable TV & telephone points in living / dining and master bedroom
- PVC conduit pipe with copper wiring and MCB of reputed brand
- Door bell point at the main entrance
- Semi modular switches of reputed brand
- Intercom system from flat to ground floor lobby

KITCHEN

- Granite platform with champhered edges
- Stainless steel sink
- Dado tiles up to 2ft. above the counter / platform
- Plumbing provision for hot and cold water line
- Electrical point for refrigerator, water purifier and exhaust fan

DOORS & WINDOWS

- Main door - Wooden flush door
- Main door fittings - Godrej or equivalent night latch and eyepiece
- Internal doors - Flush doors
- Internal door fittings - Mortice locks
- Kitchen door - Flush door
- Windows - Sliding aluminum windows

DECORATED ROOF TOP WITH COMMUNITY SPACE



EXTERNAL SPECIFICATIONS

ELEVATION

→ Modern aesthetic elevation

STAIRCASE & LOBBY

→ Polished kota in staircases

→ Vitrified tiles in floor lobbies

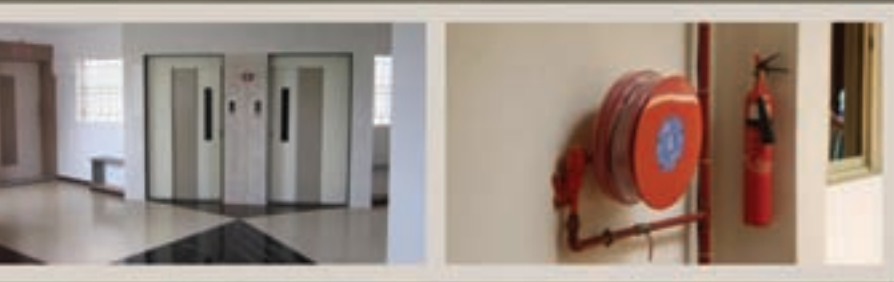

LIFTS

→ Automatic lifts of adequate capacity of ADAMS or equivalent make

POWER BACK UP (on cost sharing basis)

→ Full power back up to run one lift, pumps and common lighting

→ Limited power backup to all flats

FIRE FIGHTING

→ As per recommendations of WBFS

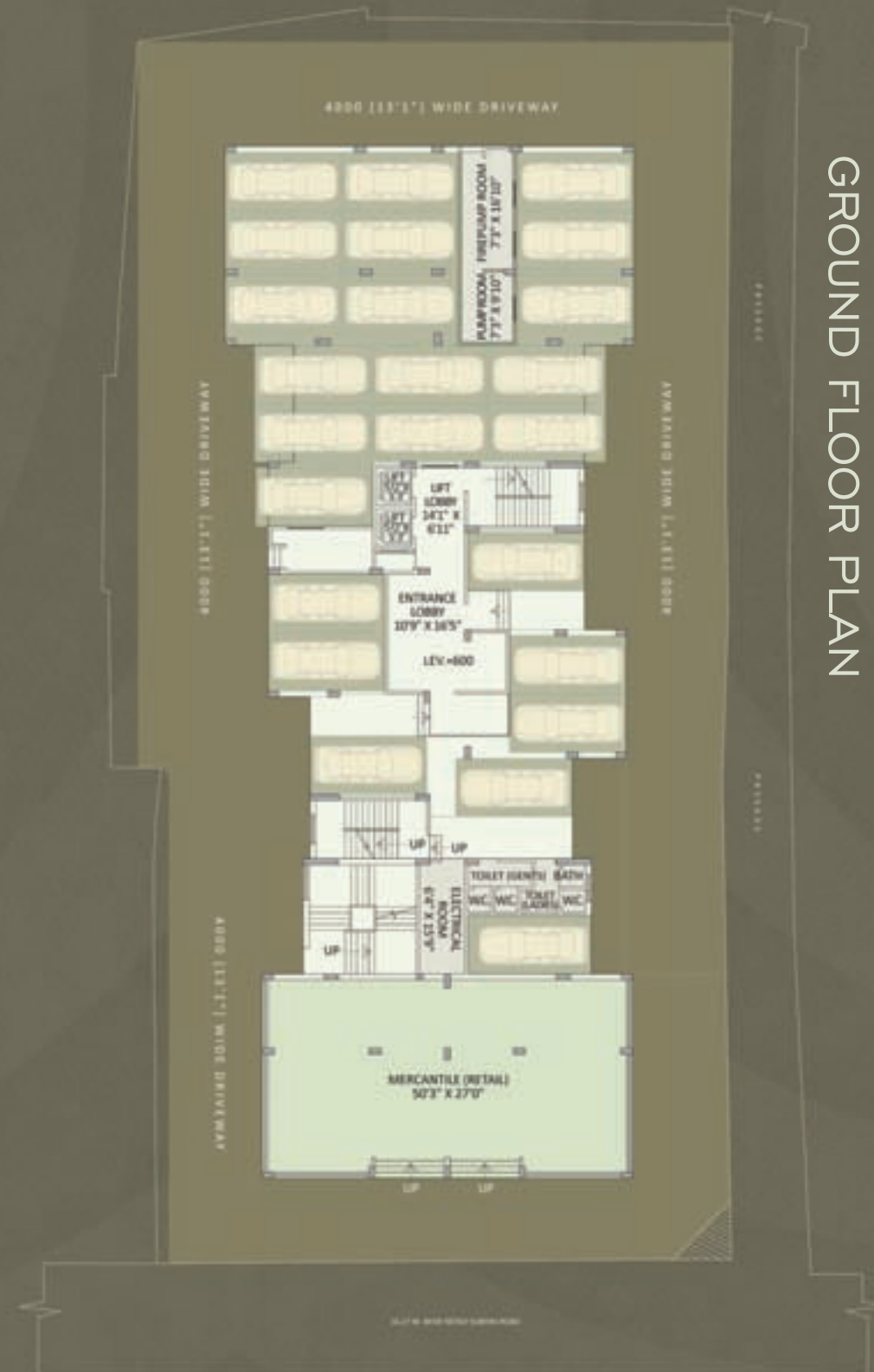

GROUND FLOOR PLAN



UNIT	RETAIL
SUPER BUILT-UP SQUARE FEET	1750

1ST FLOOR PLAN



UNIT
SUPER BUILT-UP
SQUARE FEET

UNIT	C	D	E	F	RETAIL
SUPER BUILT-UP SQUARE FEET	1115	1115	1400	1500	2145

TYPICAL FLOOR PLAN



UNIT
SUPER BUILT-UP
SQUARE FEET

UNIT	A	B	C	D	E	F
SUPER BUILT-UP SQUARE FEET	1405	1400	1115	1115	1400	1500

THE LOCATION

Garia is one of the fastest developing and most upcoming areas of Kolkata. Aarbur point is located on NSC Bose Road (Garia Main Road) just minutes away from Kavi Nazrul Metro Station and provides the optimum mix of connectivity and affordability.

Kavi Nazrul Metro Station	5 mins	B.D. Memorial Institute	2 mins
Garia Railway Station	15 mins	Ramkrishna Mission, Narendrapur	4 mins
Big Bazaar, Narendrapur	4 mins	Peerless Hospital	20 mins

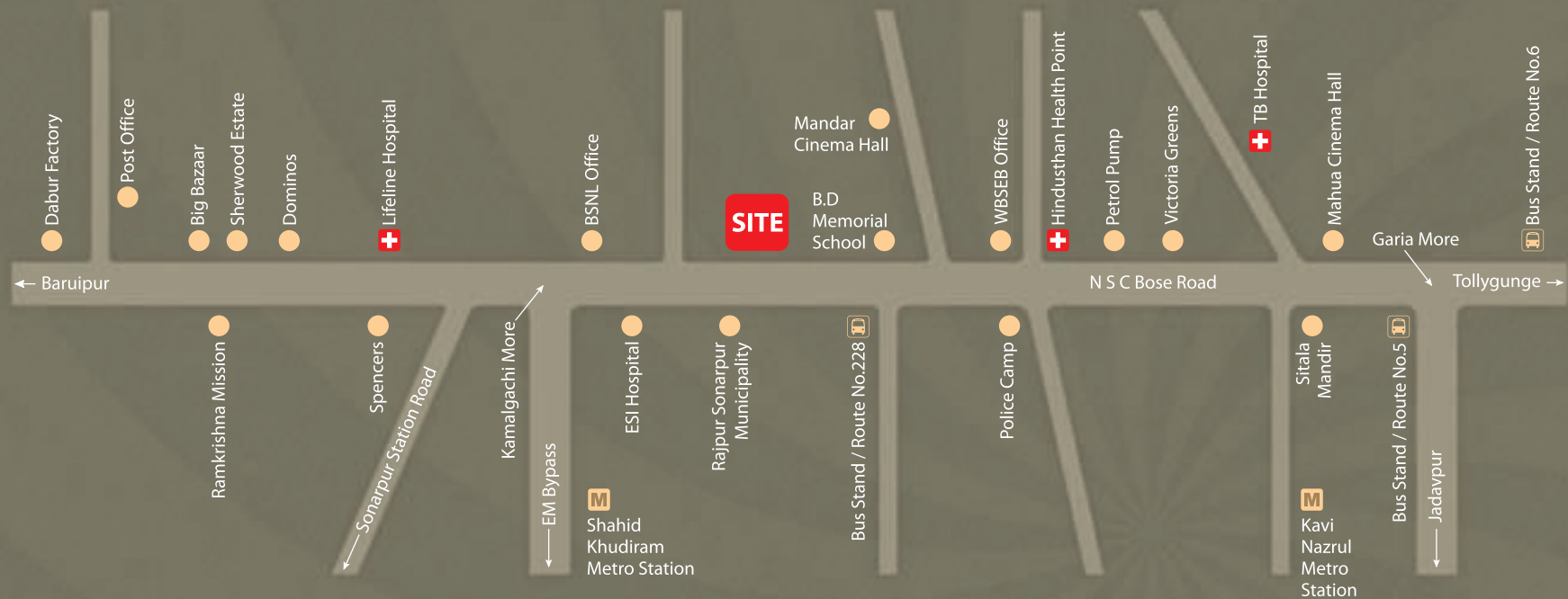

A JOINT INITIATIVE OF

ARCHITECT

MARKETED BY



Multicon Group
Mansarowar
3B, Camac Street, Kolkata 700016
p +91 33 2217 2600 / 2007
e aarburpoint@multicon.in
w www.multiconrealty.in



SLS Group
8th Floor, 3A, Shakespeare Sarani
Kolkata 700071
p +91 33 4010 3700
+91 33 4010 3777
e rajivgadia@scenterprise.com



Kohinoor
105, Park Street
Kolkata 700016



20/1, Ashutosh Chowdhury Avenue
1st floor, Kolkata 700019
p +91 33 6454 3333 / 4010 4010
m +91 9830288888 /
e bo1@amitproperties.com
w amitproperties.com

Cheque / DD to be drawn in favour of Eskay Tower Pvt. Ltd.

Disclaimer: All information, floor plans, features and offerings given in the brochure are subject to change without prior notice. Visuals used in the brochure are for illustration purpose only and may not bear any resemblance to actual features / offerings. This brochure is not a legal offering or document.