

PURAVANKARA



PASSION AT WORK

MARINA ONE

Super-luxury waterfront residences. Marine Drive, Kochi

Every home at Marina One gets glorious views of the waterfront

Welcome to Marina One

Greetings from Team Marina One! Marina One is one of Kerala's largest super-luxury residential projects located in the heart of Kochi on Marine Drive. 1141 homes ranging from 3BHK+ Study to 4BHK are arranged in a revolutionary C-shaped design around a unique 5 Acre Urban Park which is packed with world-class facilities and features.

5 Reasons to love Marina One

We've spent countless hours packing in hundreds of fine details into this project, but there are five features that make this project absolutely special.

A 497-metre waterfront in the heart of the city

Marina One is a rare project that provides an exclusive location in the heart of the city but does not compromise on peace and tranquility. The High Court Junction is 1.5 kms away from Marina One and several super-speciality hospitals and some of the city's best schools are located close by. With water on two sides and some of Kochi's best shopping, dining and entertainment destinations a quick drive away, Marina One embraces the best of both worlds.

Water-views for every home

Marina One's unique C-shaped design ensures that every home gets a view of the water.

Design of the homes

Marina One's homes have been designed to maximise the effect of the glorious breeze and the magnificent views.

Quality and Delivery

SOBHA's 2 decade old track record of delivering projects on or before time combined with formidable in-house capabilities of design and execution ensure that the quality of each home is world-class.

5-acre Urban Park

The luxurious Urban Park at Marina One is packed with facilities and features. From Lap Pools to Fitness Stations to an actual Mini Theater, residents of Marina One have it all.

[Download all the plans from www.sobha.com](http://www.sobha.com)



Your living room at Marina One



The 5-acre Urban Park has several water based features that take the edge off Kochi Summers

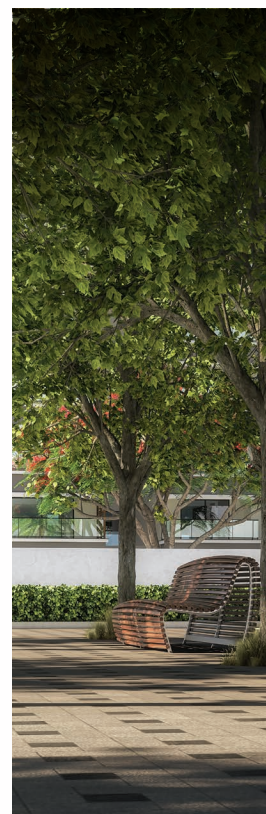



Marina One's Urban Park has several such cosy nooks and corners to relax in



The giant Urban Park is packed with facilities and features, both at podium level and below ground in the clubhouse

The residences: Area statement

ROOM DESCRIPTION	NORTH WING 03				EAST WING 01		
	N3011	N3012	N3013	N3014	E1011	E1012	E1013
TOTAL AREA (In SFT)	3670	3710	2930	3530	3061	2482	2511
LIVING AREAS	All areas are in square feet						
Living	454	454	343	454	289	226	226
Dining	305	305	264	305	242	150	150
Balcony	87	119	95	87	92	90	90
KITCHEN & UTILITY							
Kitchen	160	160	150	158	179	104	104
Utility	129	129	103	119	133	89	89
Utility room	82	82	95	91	55	74	74
MASTER BEDROOM							
Bedroom	362	362	279	362	282	257	257
Walk-in wardrobe	97	97	67	97	61	NA	NA
Balcony	112	112	NA	NA	NA	NA	NA
BEDROOMS							
Bedroom 2	216	216	162	216	253	213	213
Bedroom 3	213	213	174	213	181	194	208
Bedroom 4	216	216	162	216	164	NA	NA
Study	NA	NA	NA	NA	NA	114	114

Comparison of features

	N3011	N3012	N3013	N3014	E1011	E1012	E1013
LIVING AREAS							
L-shaped living and dining room	✓	✓	✓	✓			
Rectangular living and dining room					✓	✓	✓
Waterfront-balcony	✓			✓	✓	✓	✓
Urban Park-facing with a water view		✓	✓		✓	✓	✓
Vastu-compliant entry	✓	✓	✓	✓	✓	✓	✓
2400mm lintel height	✓	✓	✓	✓	✓	✓	✓
KITCHEN & UTILITY							
Space for island counter in kitchen	✓	✓	✓	✓			
Large, ventilated utility	✓	✓	✓	✓	✓	✓	✓
Clothes drying area	✓	✓	✓	✓	✓		
Domestic help room	✓	✓	✓	✓	✓	✓	✓
Separate entry for domestic help	✓	✓	✓	✓			
MASTER BEDROOM							
Attached balcony	✓	✓					
Waterfront view	✓			✓	✓	✓	✓
2400 mm lintel height	✓	✓	✓	✓	✓	✓	✓
Urban Park view		✓	✓		✓	✓	✓
Attached walk-in wardrobe	✓	✓	✓	✓	✓		
Windows on two walls	✓	✓				✓	
Window on one wall			✓	✓	✓	✓	✓
BEDROOM 2							
Waterfront view	✓			✓	✓		
2400 mm lintel height	✓	✓	✓	✓	✓	✓	✓
Urban Park view		✓	✓		✓		
BEDROOM 3							
Waterfront view							
2400 mm lintel height	✓	✓	✓	✓	✓	✓	✓
Urban Park view					✓		
BEDROOM 4							
Waterfront view	✓			✓	✓		
2400mm lintel height	✓	✓	✓	✓	✓	✓	✓
Urban Park view		✓		✓	✓		

What is lintel height?

Lintel height refers to the height of the top level of the opening of a door or window from the floor level

Your lifestyle around WATER

Water One

- Leisure Pool
- Beach Deck
- Pool Deck
- Step Plaza
- Sun Deck
- Tree Promenade
- Event Plaza
- Poolside Party Lawn
- Changing Rooms
- 50m Lap Pool



Activity One

- Cricket Pitch
- Fitness Stations
- Jogging / Bike Track
- Multi-Court
- Tennis Court

Tranquility One

- Bio-pond
- Meditation Deck
- Butterfly Eco-trail

Entertainment One

- Waterside Party Lawn
- Seating Alcove
- Amphitheatre
- Children's Play Mound
- Skating Rink
- BBQ Corner
- Children's Play Park
- Activity Lawns
- Fountain Roundabout



Recharge One

- Library
- Salon
- Steam / Sauna
- Chess / Carrom
- Gym
- 2 Multi-purpose Halls
- Crèche
- Convenience Store
- Clinic
- Badminton Courts
- Squash Court
- Yoga Room
- Table Tennis
- 30 Seat Mini Theatre



Marina One, GIDA Road - Queens Way, Marine Drive, Kochi - 682018
Call **+91 96330 08080** or write to salescochin@sobha.com for more details

www.sobha.com

Disclaimer

The pictorial landscapes, gardening, artistic works, soft furnishing/furniture, gadgets etc. contained in this communication material are only artistic representations which are not part of the actual deliverables and cannot be construed or treated to form as part of any agreement or offer from the part of Sobha Ltd and/or Puravankara Projects Ltd. The product and technology displayed or referred to herein are for manifestation purpose only and the companies do not guarantee the use of all of them as part of the deliverables. Specifications given are indicative and are subject to change as per requirements or on the recommendations of experts as marginal variations may become necessary during construction. The unit area indicated in the brochure is the super built up area and the actual carpet area would be provided on contacting the sales representatives/office of Marina One. The extent/number/variety of the equipments/appliances used and their brands are tentative and are liable to change at the sole discretion of the company and no objections in this regard will be entertained. The responsibility to evaluate the accuracy, completeness and usefulness of any opinion, advice, service or other information contained herein is with the understanding that the authors, publishers and distributors are not rendering legal or professional advice or opinions on specific facts or matters, and accordingly assume no liability whatsoever in connection with its use. In no event shall Sobha Ltd and/or Puravankara Projects Ltd. and their related, affiliated, subsidiary companies be liable for any direct, indirect, incidental, consequential claims arising out of the use of the information provided herein.