



RESIDENCY

Shakyasinha



KID presents **Shakyasinha**, a premium residential duplex projects that's dedicated to the Elites. In its endeavor to create the second best address of finest living next to your Heart for a Select few.

Take advantage of Life to the fullest. Luxury villas consisting of 3 BR houses finished with all modern facilities and essentials.

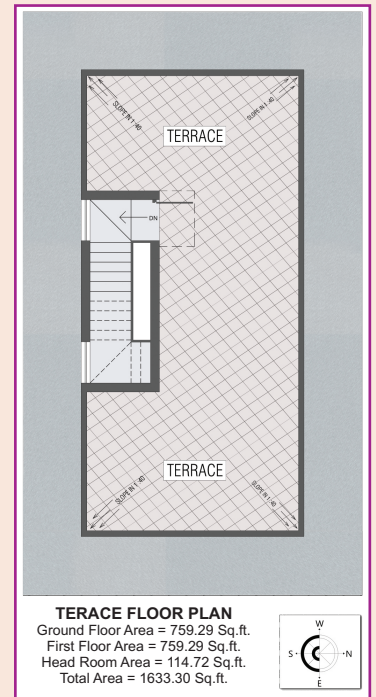

It's a place where tranquility and sophistication mix with a great environment, salubrious surroundings and recreational facilities. It's a home where design spells out a great lifestyle and the attention to every detail creates a tailor made home that is exclusively yours. Come, live and witness for yourself, inspiration in every brick and carved to perfection with imagination and would be a manifestation of quest for architectural excellence. Each home will be designed with an accent on high aesthetic appeal, blending it with modern comforts. Altogether the natural environs will enliven your soul even when you are in the lap of the crowded city.





SPECIFICATIONS

- Structure : R.C.C. framed structure.
- Super Structure : Fly ash/Concrete/Red burnt brick walls in C.M.
- Finishing : Plastering on ceiling and walls in C.M.
- Main Doors : Sal wood frame with teak wood shutters (Polished) with eye piece and rest are flush doors of approved make.
- Windows : Aluminum anodized frames and shutters with plain glass and safety grills.
- Flooring : Vitrified tiles in bed rooms, drawing and living rooms.
- Kitchen : Cooking platform and sink with black granite slab and anti skid tiles in flooring.
- Toilets : Antiskid ceramic tile in flooring with up to 6' height dado. Sanitary ware or C.P. fittings of branded make will be provided.
- Painting : Internal walls and ceiling with cement putty and plastic emulsion paint. External plasters finish with weather coat paint.
- Electrification : Concealed wiring network with copper conductor. Adequate light & fan points, T.V. & telephone point.
- Water supply : Concealed piping with good quality fittings and 24 hours water supply through bore well.



Master Plan for Dhauli

The Government of Orissa planned to develop Dhauli for domestic and international tourists. This Master Plan suggested the tourist facilities such as 3-star hotels, wayside amenities and a Museum of Buddhism. The Dhauli Development Plan included a Zone of Peace including an Ashtamarga Meditation Path, Spiritual maze, etc., Zone of Learning including a Vipassana Centre, Jataka tale depiction, a Display zone, Nature zone, an Art zone including a Sculpture garden and a Water zone. The tourism department is also working on another project called Dhauli Peace Park around the ancient complex. The project includes construction of two beautiful pathways, renovation of nearby water bodies, development of a parking area, construction of a restaurant atop the Panthika building and a multimedia centre in public-private partnership for which The state government is planning to acquire nearly 56 acres around the famous Buddhist pagoda at Dhauli with an investment of Rs. 23 cr...

Road to cut a long route short

The Dhauli-Khandagiri Road will start from NH-203 from near the Daya river and converge at NH-5 near Dharma Vihar. Plans are also afoot for a proposed railway overbridge near Pokhariput.

The road will be built with a proposed investment of Rs 29 crore, while the overbridge alone will cost Rs 42 crore.

A road from IIT Argul near Jatni will also be connected to the Dhauli-Khandagiri corridor so that the approach to the city airport and the IIT is reduced to 20km from the existing 35km via the Jatni-Sundarpada road

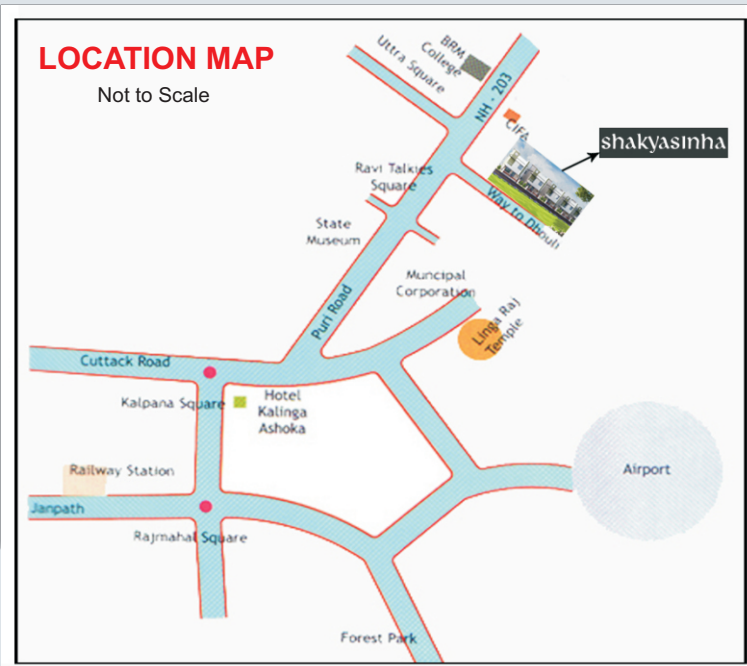

PAYMENT SCHEDULE

1 st installment	: On booking	-10%
2 nd installment	: On allotment	-10%
3 rd installment	: On foundation	-10%
4 th installment	: On ground floor brick work	-15%
5 th installment	: On ground floor slab casting	-15%
6 th installment	: On first floor brick work	-10%
7 th installment	: On first floor slab casting	-10%
8 th installment	: On ground floor finishing	-10%
9 th installment	: On first floor finishing	-5%
10 th installment	: On or before possession	-5%

- Expenses related to registration cost, taxes and duties if any imposed by Govt. shall be borne by the purchaser over and above the cost of land & duplex.
- In case if any increase/decrease in the plot size/area of construction or any sorts of addition/modification in the structure as specified the company will fix up the price of the plot area/construction accordingly.



Kasturi Infra Developers Pvt. Ltd.

USHA VILLA, Plot No.-103, 2nd Floor, Budheswari Colony
Bhubaneswar - 751006, Odisha

Phone : 0674 - 3296990, Cell : 9937096000, 9853094001

E-mail : info@kasturiinfra.com, Web : www.kasturiinfra.com