



Sumukha TELECOM CLUSTERS



Enjoy Every Moment

With Your Dream Home



for beautiful life

Sumukha TELECOM CLUSTERS

About

We "Sai Sumukha Properties Pvt. Ltd." believe in developing and constructing aesthetically designed, functionally efficient residential and commercial complexes of good quality, offering "more value for your money".

We believe that our buildings reflect engineering excellence with a view to provide complete customer satisfaction. It is our intention that the quality of our products and services should result in complete value for our clients.

Customer's Satisfaction

Sumukha TELECOM CLUSTERS, located at Timber layout Main Road, consisting of 2 & 3 BHK luxurious apartments are set to inspire all your senses. It is well connected to the Mysore Road, Hanumantha nagr and Banshankari. This artery offers easy accessibility to educational institutions, Hospitals, Shopping Centers, Restaurants. These apartments are especially designed on the principles of vastu and free flow of natural light and air.



40' Wide Road

Typical Floor Plan

To Hanumanth Nagar

To Mysore Road

20' Wide Road

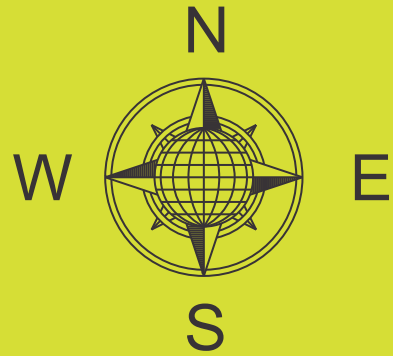

To Mysore Road

To Hanumanth Nagar

20' Wide Road

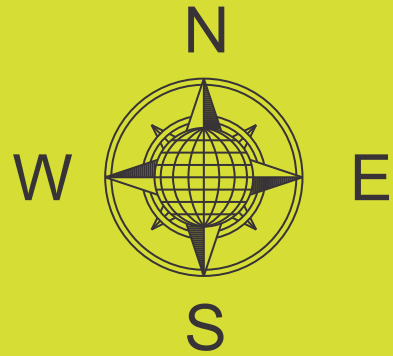

SPECIFICATIONS

Sumukha

TELECOM CLUSTERS

**Structure:**

RCC framed structure designed for zone II regulation

**Walls:**

6" thick external walls and 4" thick internal walls of solid black masonry (AVS Concreat Blocks)

**Plastering:**

Smooth finish with lime rendering
Sponge finish for exterior

**Doors:**

Main & Pooja doors with teak wood frames and solid wood shutters.
All other doors of saal wood frames with flush shutters.

**Windows:**

3 Track sliding aluminum frame with safety grills for bedrooms
and 2 track with safety grills for other windows.

**Flooring:**

Vitrified flooring for living, dining, bedrooms and kitchen.
Common areas with contemporary tile flooring.

**Kitchen:**

Stainless steel sink on granite platform.
Power point provision for drinking water purifier, refrigerator,
cooking range and exhaust fan.

**Electrical:**

Provision for AC point 1 No. concealed copper wiring using
Anchor brand cables and Roma Viola switches. TV and Telephone
points at living and master bedroom.

**Bathroom/Toilets:**

Anti skid tiles for flooring, glazed tile dadoing up to 7' height.
Geyser and exhaust points. Starting range of Jaguar & Hind
ware fittings

**Painting:**

Internal walls : Premier emulsion
External Walls : APEX weather proof cement.
based paint . Enamel paint for doors and window grills.

**Lift:**

4 No's. of 6 passenger lift of Surya make.

**Interior work:**

As per the clients choice at extra cost



1
1225SFT



2
1175SFT

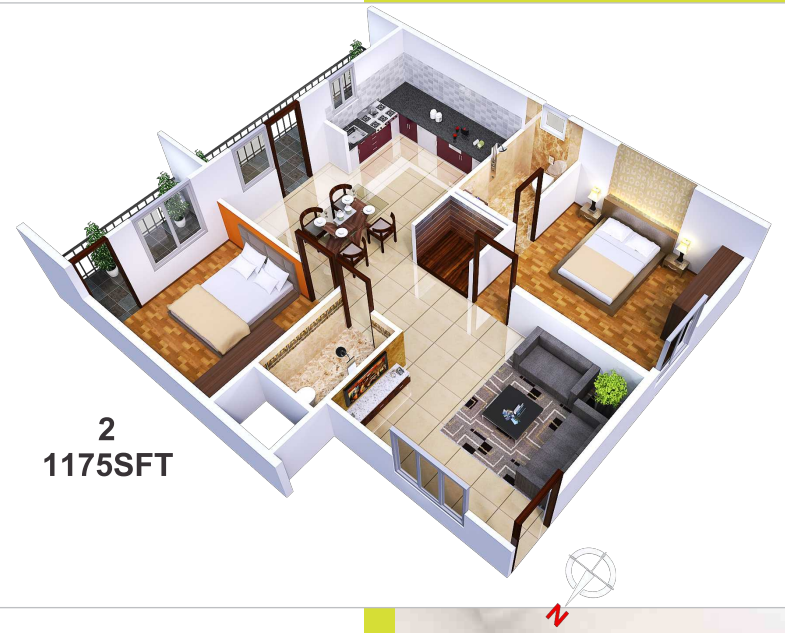

3
1570SFT



4
1230SFT



5 to 08
1220SFT



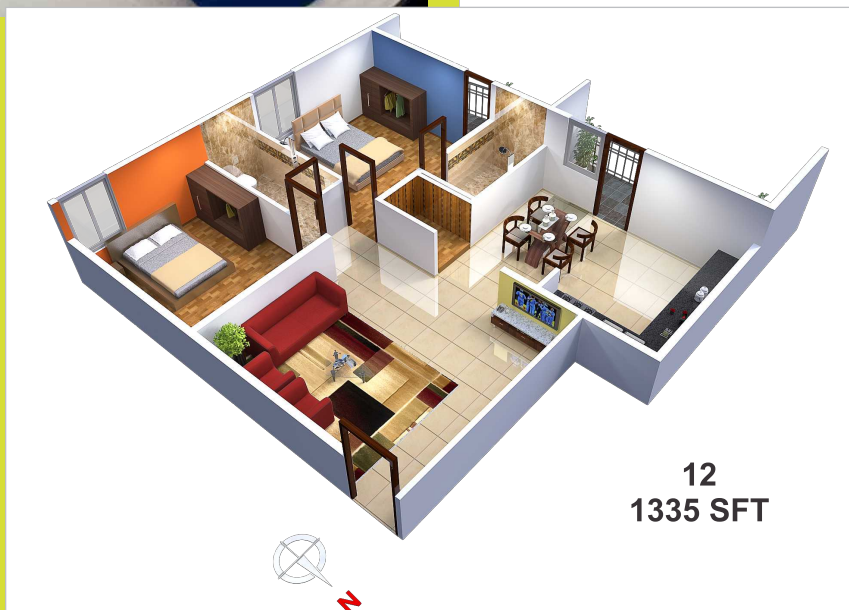

14
1220 SFT



15
1290SFT



16
1425SFT



17
1300SFT



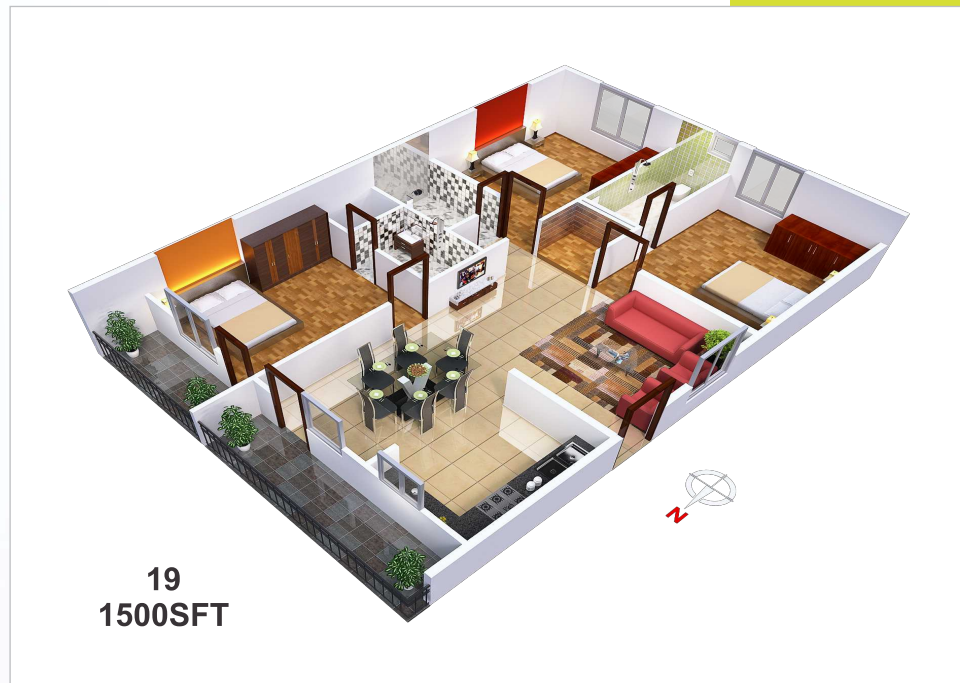



Sumukha TELECOM CLUSTERS



Complementing its serene setting, Sumukha Telecom Clusters apartment are soaked in visual details-perfectly in tune with its stately class Encircled by greenery from all sides, the spacious dwellings at the layout. Facilities like kid's play area high-tech gym intercom power backup CCTV etc.... to add to the joy to residing here.intercom power backup CCTV etc.... to add to the joy to residing here.

Highlights

- ✓ BBMP approved
- ✓ Excellent land mark
- ✓ 100 % Vastu compliant
- ✓ Trendy architecture
- ✓ Close Proximity to IT corridor
- ✓ Reputed schools in the close vicinity
- ✓ Close to big malls and hospitals
- ✓ Optimum space utilization
- ✓ Close to Satellite Bus stand

ASSURING FUN, FROLIC AND FELICITOUS MOMENTS TO ALL





Sumukha Telecom Clusters designed as per contemporary standards, and vastu it enables sophisticated accommodation standards.

The apartment homes provide a vivacious retreat from mundane living. The fine interior plans offer free flow of space with trendy touches of useful niches.



Amenities

- ✓ Children play area
- ✓ Swimming Pool
- ✓ Full equipped gym
- ✓ Party Hall / Club house
- ✓ Round the clock security
- ✓ CCTV for parking Area
- ✓ Landscaped garden
- ✓ Power Backup 24 Hrs.
- ✓ Rain water harvesting
- ✓ Intercom facility



Route Map

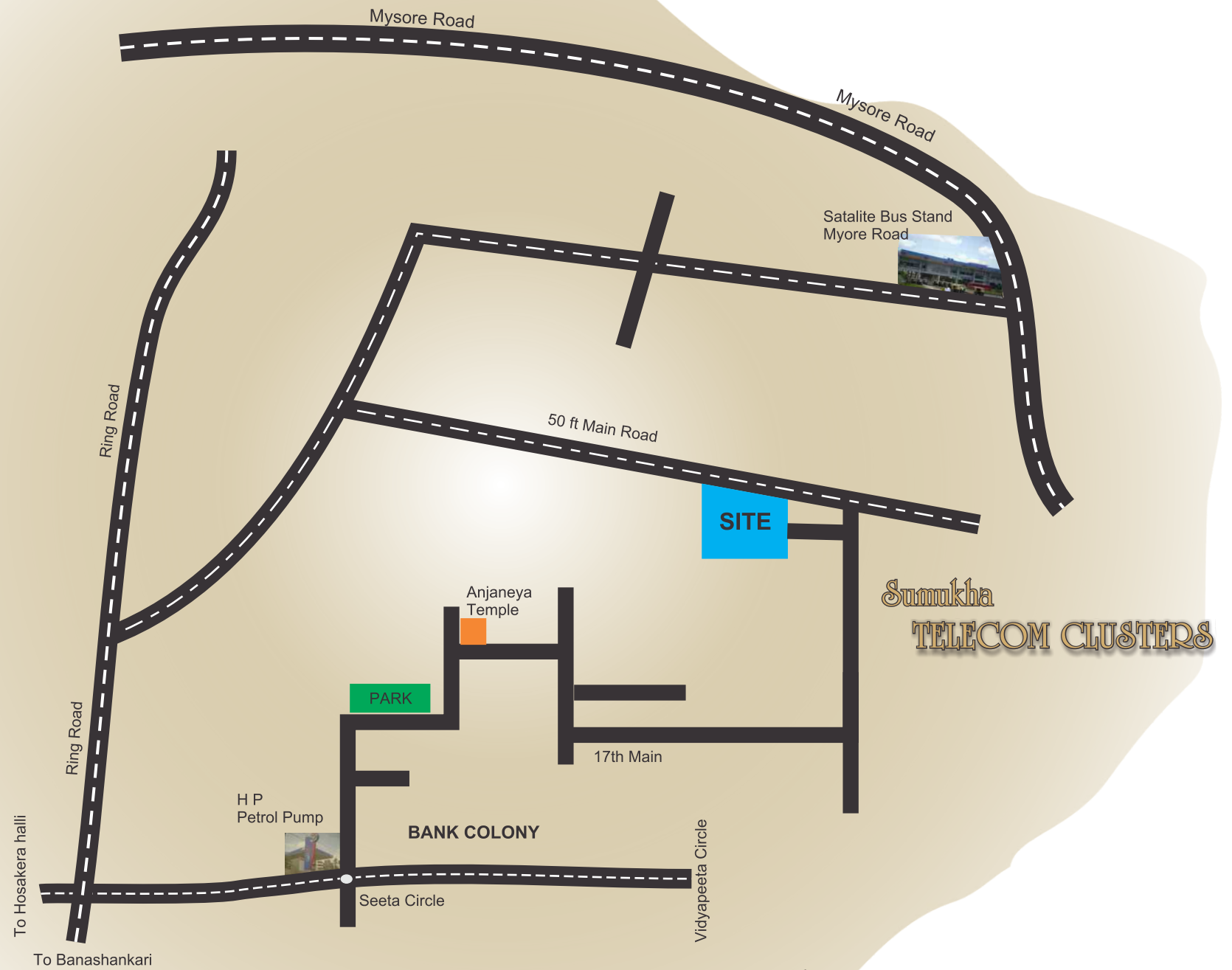

Builders :



Sai Sumukha Properties Pvt. Ltd

16, Kathriguppe Main Road, ITI Layout Cross,
BSK 3rd Stage, Bangalore - 560 085

For Details Contact :

Note: The Company reserves the right to revise specifications without notice or obligation.
All photos & illustrations are representative & should be used as a guide only.