

HILIFE



# MAGNIFIQUE

The craft of living

[www.hilifeventures.com](http://www.hilifeventures.com)

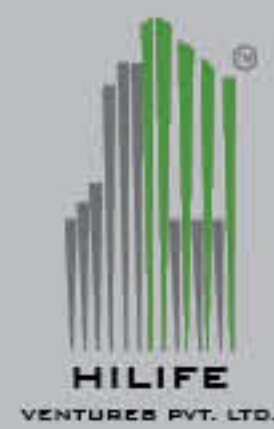

**HILIFE VENTURES PVT. LTD.**  
ISO 9001:2008 Certified Company  
Plot No. 303, Balagere Road, Devasthanagalu, Balagere, Bangalore - 560087  
Ph: 080 6537 9999 Cell: +91 948111 8888 +91 948222 8888  
e-mail: sales@hilifeventures.com

ARCHITECTS

**FWD**  
architects

NOTE : This brochure is only a conceptual presentation of the project and not a legal offering.  
The promoters reserve the right to make changes in plans, specifications and elevation as deemed fit.

Artifice +91 988523570

“Experiences  
for life, made  
magnifique.”

2 & 3 BHK Luxury Apartments @ Balagere, Varthur, Bangalore.

A project by

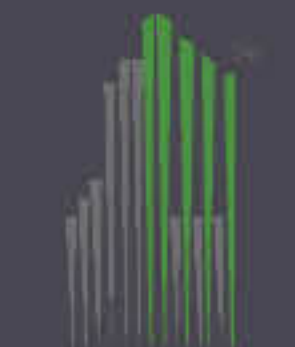

**HILIFE**  
VENTURES PVT. LTD.



“Living a life that's  
magnifique.”

The sun quietly fades away and the brightness merges into the gray of the night. The stars are beginning to twinkle brightly and the moon is shining awesomely in its full glory. And here it is, your abode and address in all its splendour under the night-sky. The world calls it Hilife Magnifique, and you, with all the pride you have within call it home. Yes, that's where it all begins. Cause' you're living a life that's all so magnificent and one that's so magnifique in essence and practice.

HILIFE  
  
**MAGNIFIQUE**  
The craft of living

A project by

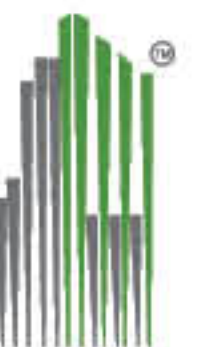

**HILIFE**  
VENTURES PVT. LTD.

# Master Plan

- Gate 1
- Security 2
- Transformer yard 3
- D.G.Set 4
- Stone garden 5
- Skating rink 6
- Practice pitch 7
- Sump below 8
- S.T.P. below 9
- Aroma garden 10
- Wide driveway 11
- Lawn tennis / badminton court 12
- Sand pit 13
- Kid's play area 14
- Elder's sitting area 15
- Basketball court 16
- Change room 17
- Deck area 18
- Swimming pool 19
- Toddlers pool 20
- Open-air theatre 21



“Something here and something there! Truly magnifque.”

If you've always desired for a life that's superior in every sense of the word, a splendid living environment that matches your kind of thinking, and a place that serves your wishes to make them come true, Hilife Magnifique is the place for you. Because everything you have desired for, in your everyday life, is right here you. From homes you will call luxurious to amenities that you will clearly state as club-class. There's something for everyone, wherever one looks around.



# Master Plan



# 3 BHK 3D VIEW

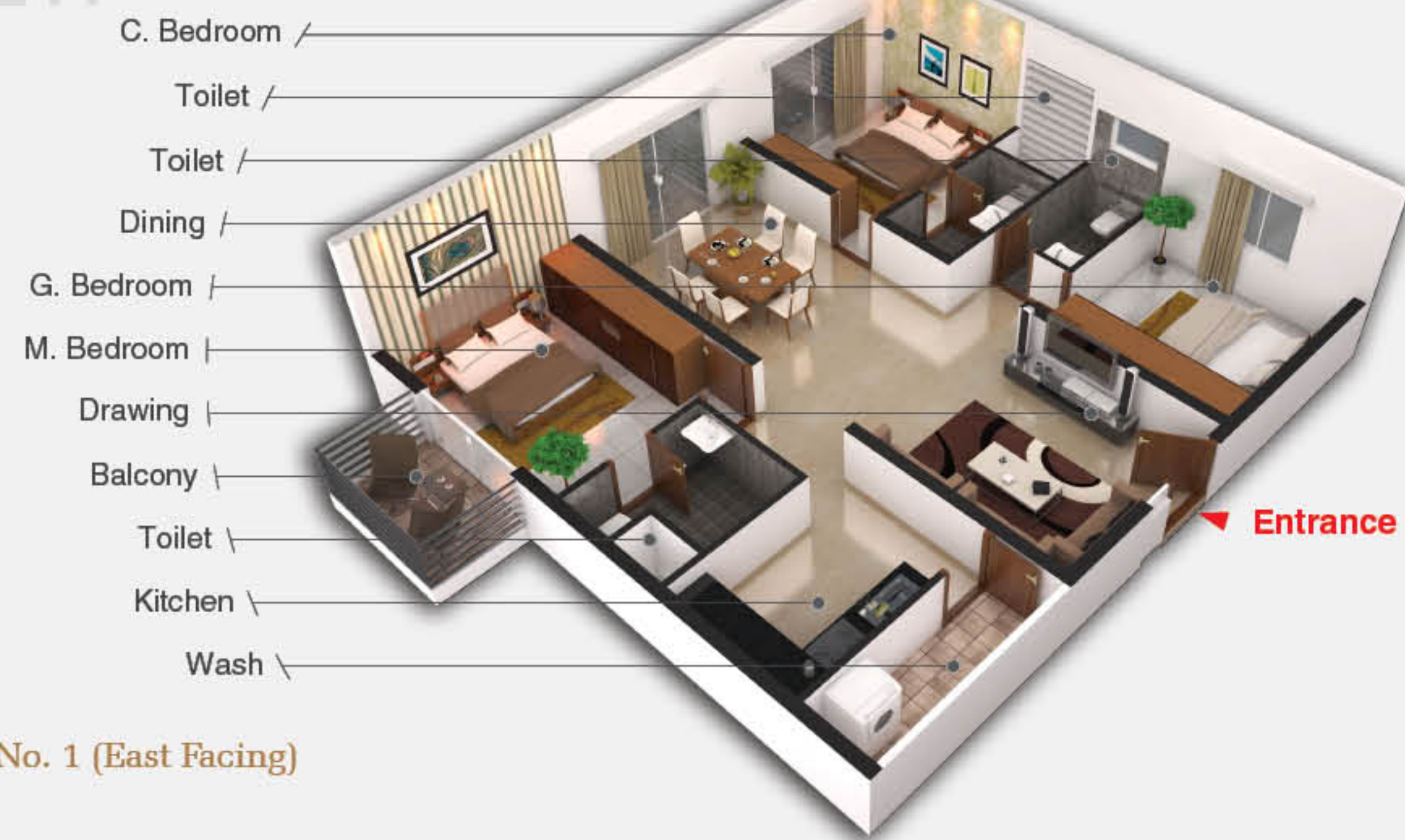

FLAT No. 1 (East Facing)

"Living with all, yet living private. Now that's magnifique!"



For all that you have expected in your home, feel more than elated to discover that every home here at Hilife Magnifique keeps private life private, as none of the flats have a common wall. And yet, you will find the best of neighbourhood right on the floor you live on.

On that note, may we enlighten you more about this alluring landmark. Hilife Magnifique comes with smartly planned, luxurious, contemporary-styled 2 BHK and 3 BHK homes that span between 1095 sft & 1605 sft of space, to host you in the most comfortable and classiest of environments that elevate up to 11 floors.

# 2 BHK 3D VIEW

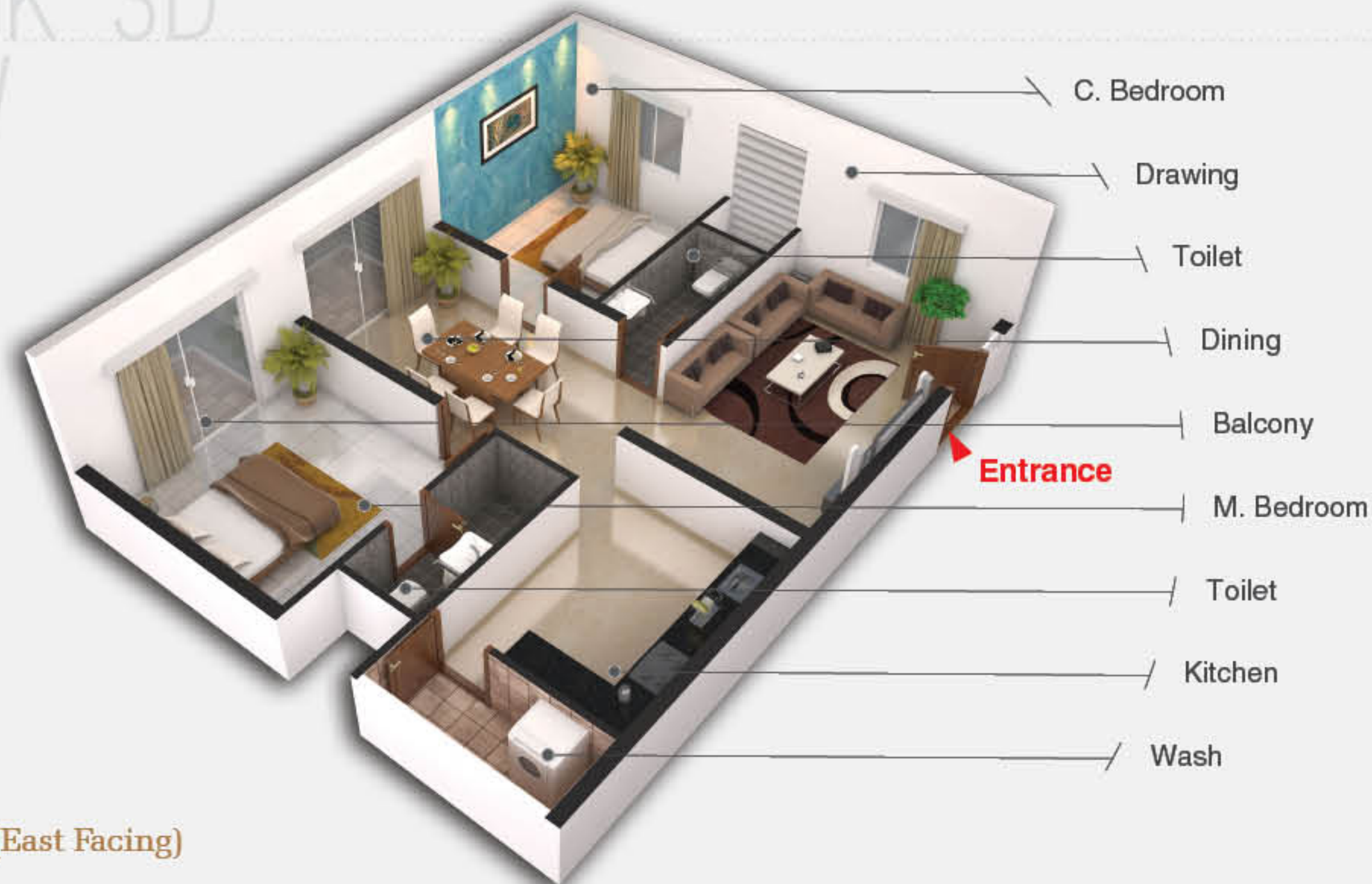

FLAT No. 2 (East Facing)

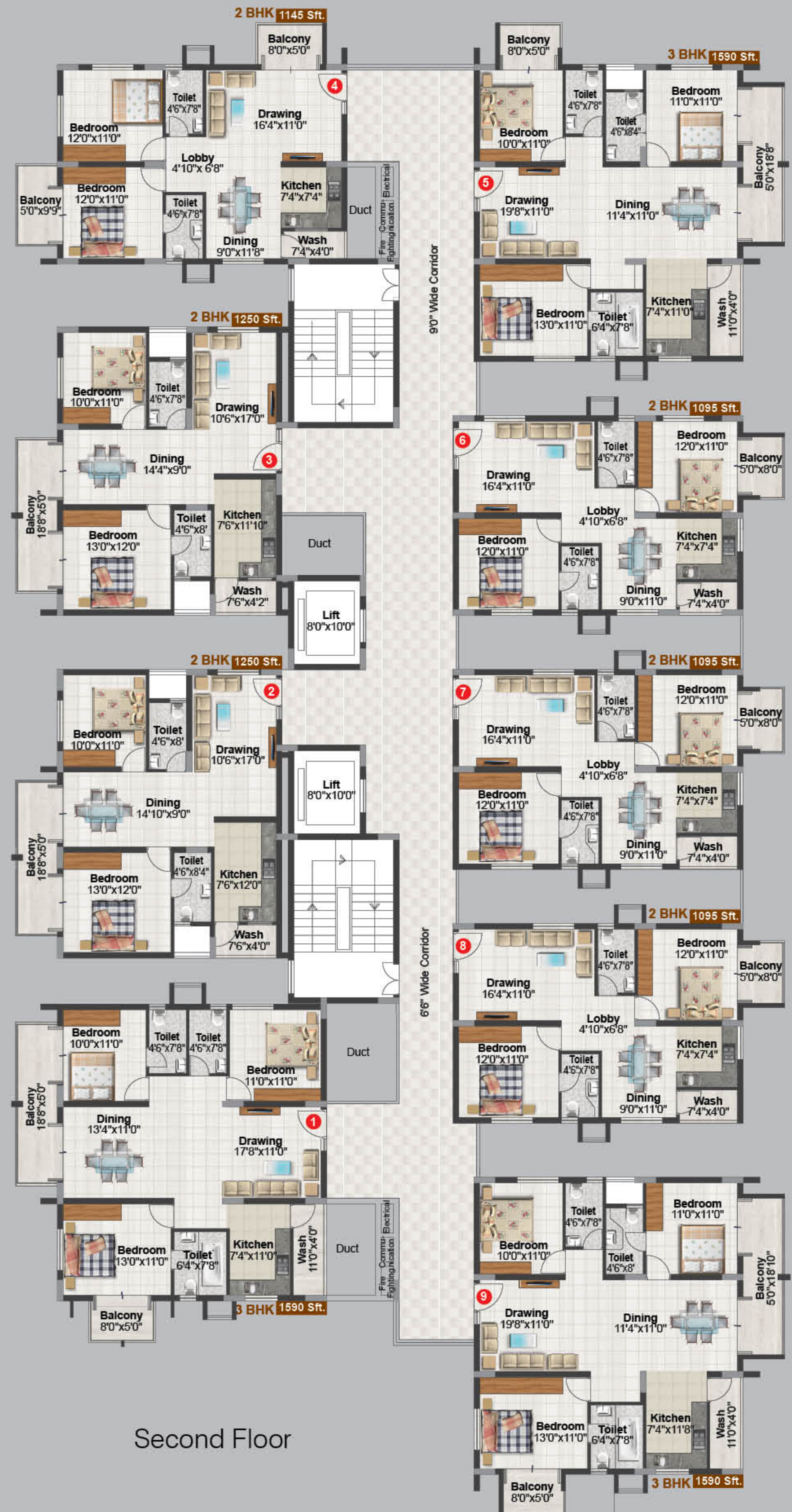

Second Floor

HILIFE  
  
**MAGNIFIQUE**  
 The craft of living

AREA STATEMENT

FLAT	1	2	3	4	5	6	7	8	9
FACING	EAST	EAST	EAST	EAST	WEST	WEST	WEST	WEST	WEST
10 <sup>th</sup> Floor	1590 Sft	1235 Sft	1235 Sft	1175 Sft	1590 Sft	1095 Sft	1095 Sft	1095 Sft	1590 Sft
9 <sup>th</sup> Floor	1590 Sft	1235 Sft	1235 Sft	1145 Sft	1590 Sft	1095 Sft	1095 Sft	1095 Sft	1590 Sft
8 <sup>th</sup> Floor	1590 Sft	1235 Sft	1235 Sft	1145 Sft	1590 Sft	1110 Sft	1095 Sft	1110 Sft	1605 Sft
7 <sup>th</sup> Floor	1590 Sft	1235 Sft	1235 Sft	1145 Sft	1590 Sft	1110 Sft	1095 Sft	1110 Sft	1605 Sft
6 <sup>th</sup> Floor	1590 Sft	1235 Sft	1235 Sft	1175 Sft	1590 Sft	1095 Sft	1095 Sft	1095 Sft	1590 Sft
5 <sup>th</sup> Floor	1590 Sft	1235 Sft	1235 Sft	1175 Sft	1590 Sft	1095 Sft	1095 Sft	1095 Sft	1590 Sft
4 <sup>th</sup> Floor	1590 Sft	1235 Sft	1235 Sft	1180 Sft	1600 Sft	1095 Sft	1095 Sft	1095 Sft	1605 Sft
3 <sup>rd</sup> Floor	1590 Sft	1235 Sft	1235 Sft	1145 Sft	1590 Sft	1095 Sft	1095 Sft	1095 Sft	1590 Sft
2 <sup>nd</sup> Floor	1590 Sft	1250 Sft	1250 Sft	1145 Sft	1590 Sft	1095 Sft	1095 Sft	1095 Sft	1590 Sft
1 <sup>st</sup> Floor	1590 Sft	1250 Sft	1250 Sft	1145 Sft	1590 Sft	1095 Sft	1095 Sft	1095 Sft	1590 Sft
Ground Floor	1480 Sft	1135 Sft	1135 Sft	1095 Sft	1480 Sft	C.House	C.House	1080 Sft	1465 Sft
BHK	3 BHK	2 BHK	2 BHK	2 BHK	3 BHK	2 BHK	2 BHK	2 BHK	3 BHK

Area Statement

“Yes, it’s designed to be magnifique.”

We know, that nothing heightens your happiness when every single compliment you receive is about the things that are just yours. Alike, you’ll find your place at the Hilife Magnifique will be on top of every single object of desire you own, and add to it the heap of compliments you’ll receive for it. For the way it’s designed, for the way it’s planned, for the way it looks. More importantly and rightly so, for the appropriate decision you’ve made.



# 2 BHK 3D VIEW



FLAT No. 8 (West Facing)



“When it’s well-made it’s truly magnifique.”

They say, the size of the home you live in matters. But we would like to go one step beyond that. We say, the intelligence and planning that a home is built with, matters even more. Irrespective of the size of the home you pick, at Hilife Magnifique, every home is made to fit the current-day lifestyle with equal élan and grandness. So go ahead, don’t constraint yourself, and live the life you’ve always imagined to belong.

# 3 BHK 3D VIEW

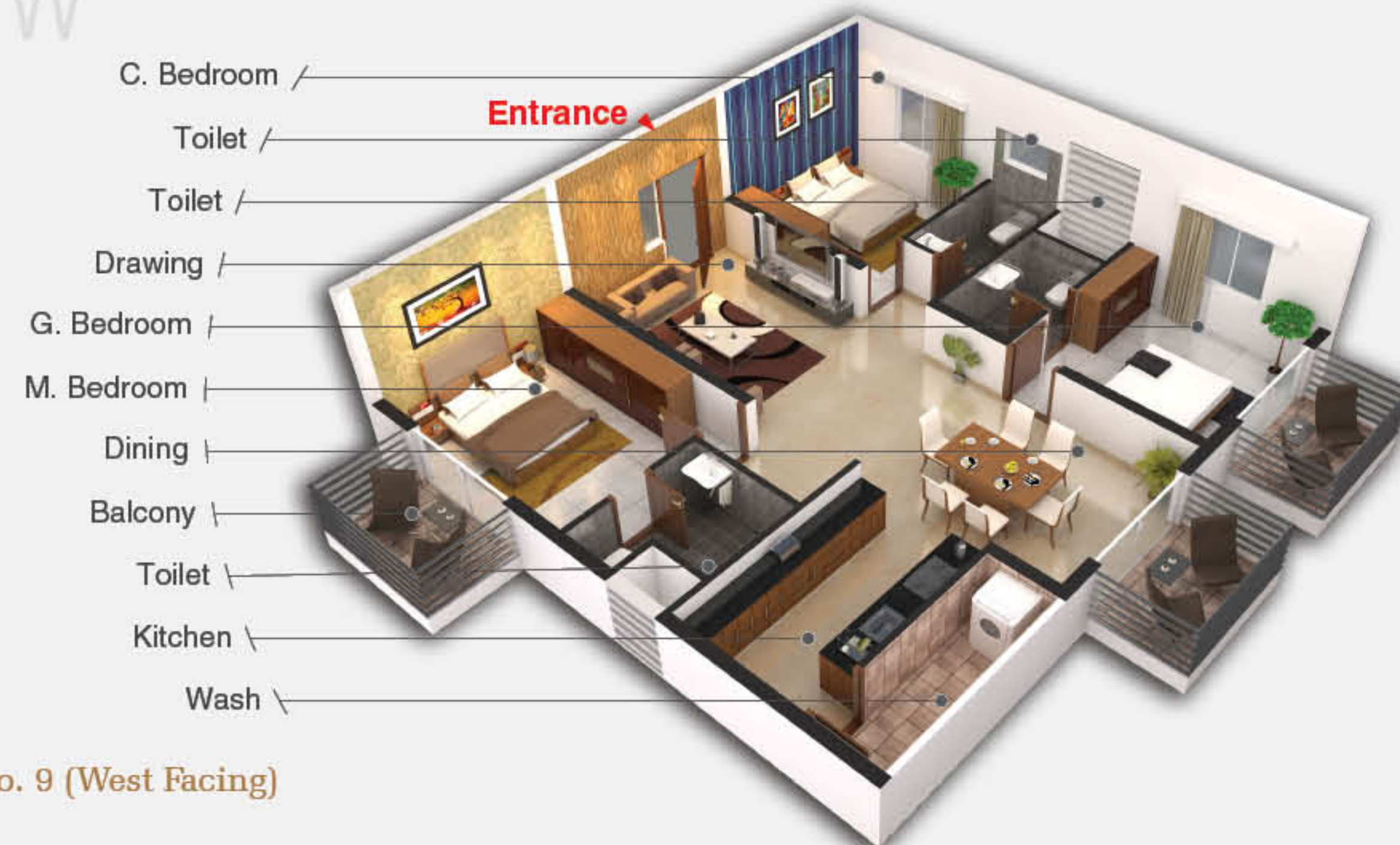

FLAT No. 9 (West Facing)

**STRUCTURE**  
RCC framed structure. 6” solid cement blocks for exterior walls and 4” solid cement blocks for internal walls.

**PAINTING**  
Interior Walls - One coat of primer and two coats of emulsion paint with smooth finish and Oil bound distemper for common areas. Exterior Walls - One coat of primer and two coats of cement paints.

**FLOORING**  
Vitrified tiles flooring, 24”x24”, for living, dining and all bedrooms. Ceramic tiles for balconies and kitchen. Anti-skid tiles in toilets of a minimum size of 12”x 12”.

**DOORS & WINDOWS**  
Main Door - Teak frame with moulded OST shutter.  
Internal Doors - Sal wood frames with moulded skin shutters.  
Windows - 3 track powder-coated Aluminium windows with mosquito mesh fitted and elegantly designed M.S painted grills.

**TOILETS**  
Colored glazed tiles upto 7ft height. Fitting & Accessories — EWC commode and wash basins (white color) of Parryware / Hindware or equivalent make. Hot and Cold Shower Mixer, pillar cock, health faucet in each toilet of standard make like Jaguar / Essess or equivalent brand.

**KITCHEN**  
Black granite platform with stainless steel sink 2ft glazed tile dado above platform. Provision for water purifier. Provision for washing machine in utility area.



S p e c i f i c a t i o n s

**ELECTRICAL**  
Power supply of 3KVA for 2BHK and 4KVA for 3 BHK apartment. Concealed conduits with good quality copper wire - Anchor or equivalent. Modular electrical switches-Anchor or equivalent. One Earth Leakage Circuit Breaker (ELCB) for each apartment. One Miniature Circuit Breaker (MCB) for each room. Points for geyser in toilets, washing machine in utility, refrigerator in kitchen or dining, microwave oven in kitchen, air conditioner in all bedrooms, TV and telephone points in living and master bedrooms.

**SECURITY**  
CC TV, Intercom facility from each apartment to security room, clubhouse and other apartments.

**FACILITIES**  
Sewage treatment plant.  
Rainwater harvesting pits.

**BACK-UP GENERATOR**  
Standby generator for light in common area, lifts and pumps 0.5 KVA power backup to each apartment.

**LIFTS**  
8 Passenger Automatic Lift make will be Johnson/Kone or equivalent.



“If the world admires,  
it’s magnifique.”

In a world where everything has come to be imperfect and imbalanced, quite rarely will you come across a place you’ll admire. We believe Hilife Magnifique has it all to be your object of admiration. Take a keen look at it through every magnifying lens you wish, and you’ll find yourself ticking every point on your checklist. It’s the kind of address you’ll have on your personal list of ‘most desired places to live in’. Come, give the world another reason to admire your choice.











HILIFE  
  
**MAGNIFIQUE**  
The craft of living



-  Tennis court
-  Badminton court
-  Open air theater
-  Swimming pool
-  Toddler pool
-  Club House
-  Gymnasium
-  Cricket pitch & Bowling machine
-  Kids play area
-  Fish pond
-  Kitty party hall
-  Skating rink
-  Water fountain

## Amenities & Features



-  Toy library
-  Elders' sit-out
-  Jogging track
-  Aroma lawn
-  Drivers' lounge
-  Intercom
-  Sports lounge
-  24x7 Security
-  Rain water harvesting
-  Indoor games

Hilife Magnifique is a home that's more than just a home. It's an address that blends easily the comforts and emotions that a home brings along and luxuries, leisure and fun that a place of recreation brings with it. For infants, for toddlers, for adolescents, for those working, for those retired – there's something to cheer for everyone. And yes, every feature and amenity here is top-class and one that'll hardly find a match in its vicinity.

"Recreation and luxuries that are quite magnifique."



## AMENITIES & FEATURES

"A home,  
oh so magnifique !"

Very often in life, we find ourselves in moments when it's not enough that we are satisfied by what's offered to us in the first instance. That's because we always crave for something more, something better, something that we've already pictured in our mind. And until we come face to face with what we wish, our quest continues. It continues for that magnificent something we will praise, we will be in awe of and will exclaim... 'it's so magnifique'!

Hilife Ventures Pvt. Ltd.  
presents to you that  
something called Hilife  
Magnifique.

HILIFE  
  
**MAGNIFIQUE**  
The craft of living



HILIFE  
  
**MAGNIFIQUE**  
 The craft of living

“Being in the midst of it all is magnifique”

If your home is such a splendour to live in, a location that's the sought-after can only make it a highly coveted place. Yes, with a location like Whitefield, Hilife Magnifique can only be everyone's desire. What with everything you want being in the proximity of this address. From top IT corporates, top-class education, leading healthcare facilities, premium entertainment options, transport network to much more, there's everything here to make this a magnifique place.

Location Map



LOCATION MAP

SOME OF OUR PROJECTS



Pearl Shell  
 @ Balagere, Varthur, Bangalore.



Palm Grove  
 @ KR Puram, Bangalore.



Sunny Side  
 @ Sarjapur Road, Bangalore.

“Trust and experience make a magnifique place.”



Hilife Magnifique is an offering of Hilife ventures pvt. Ltd., one of Bangalore's premium real estate developers bringing to you quality homes. Every community we build is known for its benchmark quality, customer-centric approach, brilliant engineering, umpteen research, uncompromising ethics, timeless values and transparent interaction. Come experience what we have to bring for you.

A project by

