

A Project By

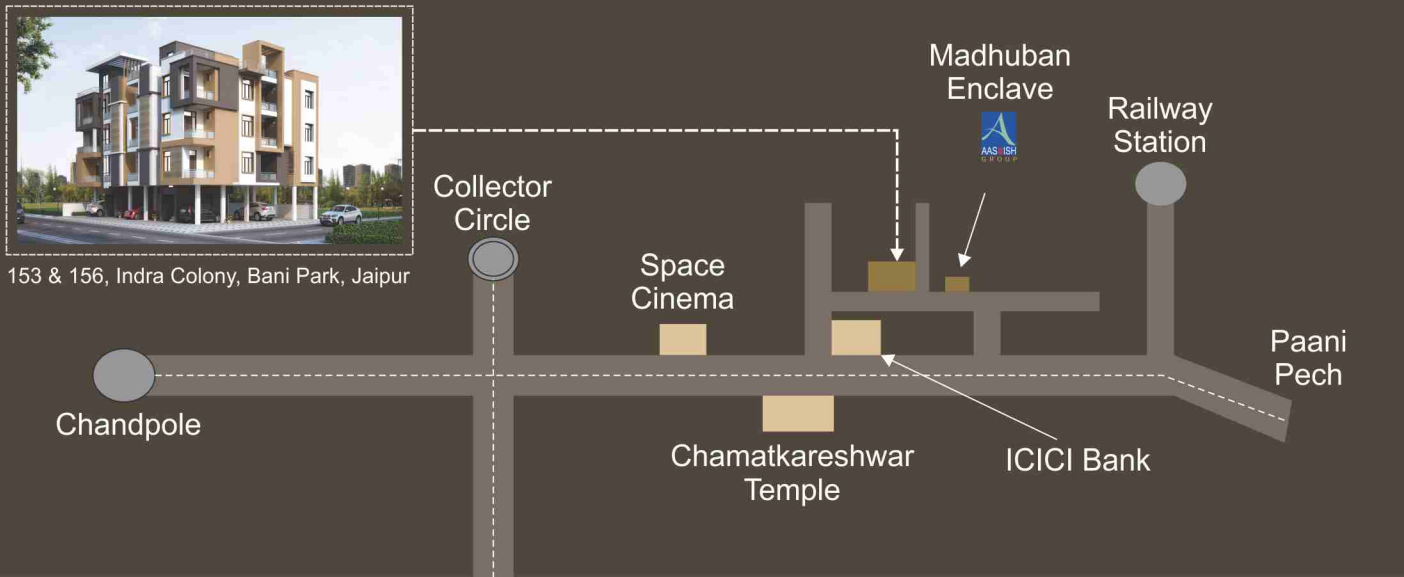

Location Map



OM SHANTI GANGA Enclave

Our Projects



Devaashish City- Gramin Police Line Road, Borekhera, Kota



Acacia- H-Block, Sidharth Nagar, Near Jawhar Circle, Jaipur



Forest View, Model Town, Jagatpura Jaipur



Aashish Saffire, Civil Lines



Aashish Enclave Veshali Nagar, Jaipur



Aashish Sarovar, Vashali Nagar



Gagandeep Residency, Raja park



1A-1B, Mangal Vihar, Jaipur



Madhuban Enclave, Bani Park, Jaipur



Coral Residency, Keshav Vihar



Ganga Path, Shanti Nagar, Near Gujar Ki Thadi, Jaipur



16-17, Ganga Path, Shanti Nagar, Near Gujar Ki Thadi, Jaipur



82-A, Keshav Vihar, Jaipur



71, Mangal Vihar, Jaipur



Corporate Office : **AASHISH GROUP**
Hotel Aashish, Opp Hatroi School, Ajmer Road, Jaipur (RAJ) - 302001
Tel : 9828018930, 9829084736 | Email : aashishgroupjaipur@gmail.com
Web : www.aashishgroup.co.in

Tech N Gen # 9829334122, 9799390022



*Note :- Details, Photographs given above are the exclusive property of M/s. AASHISH GROUP BUILDER & DEVELOPERS, are only the artistic impressions, shown only to give approximate idea about upcoming project, company has the sole right to change, modify any details and specification given above without giving any prior notice. No claim, obligation can be found/claim based upon details given above.

First Floor Plan Layout



Saleable Area

FLAT	TYPE	S.B.U.A.sq.ft.
FLAT-101	4 BHK	2250.00
FLAT-102	4 BHK	2400.00



Typical Floor Plan



Saleable Area

FLAT	TYPE	S.B.U.A.sq.ft.	FLAT	TYPE	S.B.U.A.sq.ft.
FLAT-201	2 BHK	1200.00	FLAT-203	2 BHK	1170.00
FLAT-202	2 BHK	1085.00	FLAT-204	2 BHK	1240.00

Stilt Floor Plan

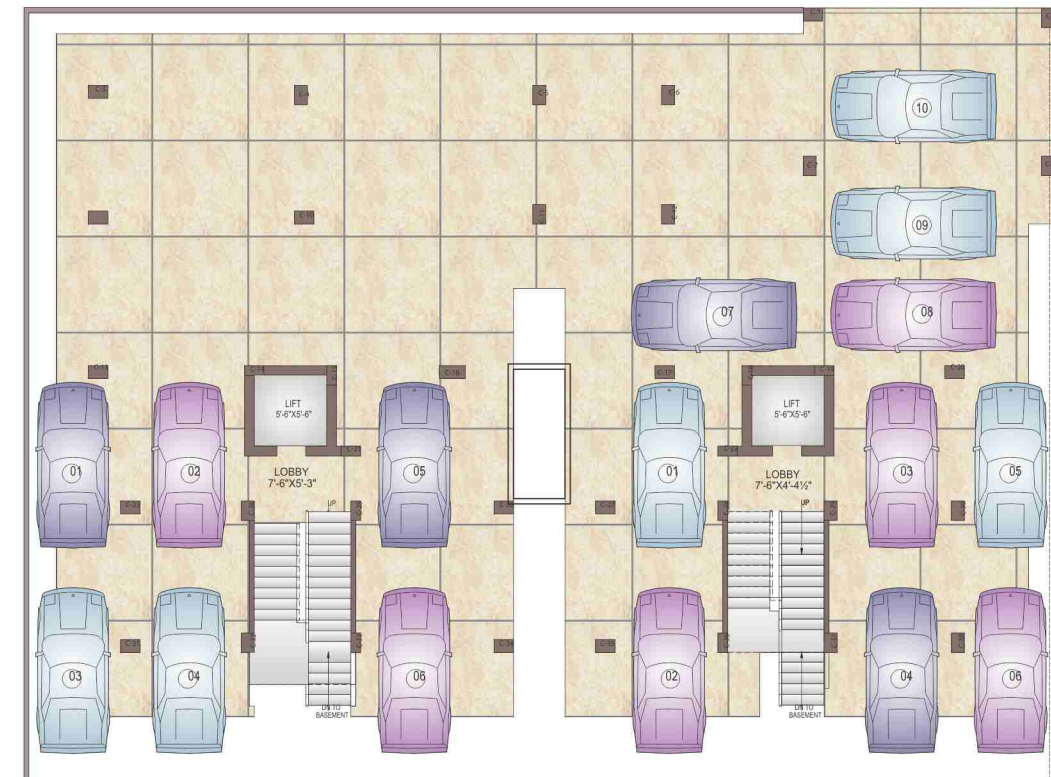

Specification

Structure

- RCC composite structure with Brick Masonry
- Cement plastering and POP finish

Flooring

- Vitrified Tiles / Marble Flooring in living/dining and all bedrooms
- Ceramic Tiles in Toilets & Balcony
- Cement Pavers in Drive Way and Porch
- Granite Stairs

Doors, Windows and Wooden work

- Wooden Frames with wooden flush doors
- Wooden/Anodized Aluminum Frames
- Wooden Wardrobes in all Bedrooms

Paint

- Quality Plastic Paint for interior walls
- Water proof texture paint for external front wall

Electrical

- Modular Switches
- Concealed conduits with fire retardant copper wires
- Suitable and sufficient points for power & lighting
- Segregated power and lighting circuits
- Provision for Split AC with copper coil fitting in all bedrooms & Living area
- TV Points in all bedrooms and drawing
- Telephone points in all bedrooms and living room
- Electrical Fittings Like - Fans, Tube light

Toilets

- Ceramic tiles on walls up to 7'heights

Extra

- Semi Modular Kitchen
- S.S. Railing
- Partial false ceiling
- Lift