



1 & 2 BHK Exclusive Apartments

KRISHNA 99  
RESIDENCY



1 & 2 BEDROOM  
LUXURIOUS  
APARTMENTS

### Exclusive amenities

- Earthquake resistant structure design.
- Entrance gate with security cabin & children drop off zone.
- 24 hours water supply from common bore well.
- Underground and overhead water tanks.
- Developed landscape garden.
- 5 Passenger lift in each block.
- Children play area.
- Senior citizens sitting arrangements.
- Well planned car parking & visitor parking.





LAYOUT  
PLAN



# BLOCK A



redefine luxury and create an unmatched living experience

1 & 2 Bedroom

Luxurious flats



# BLOCK B,C



# BLOCK D

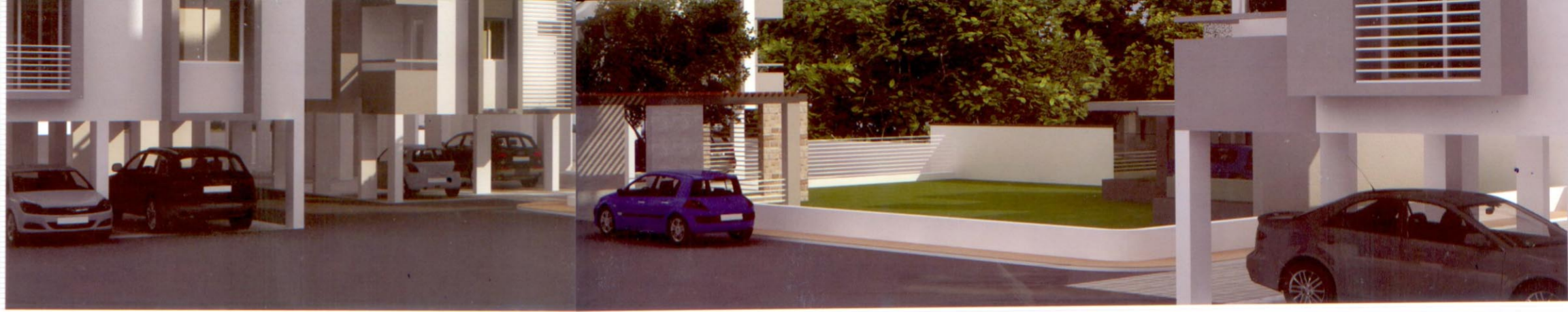

# BLOCK E







Developer

## Krishna Reality

Mo : 78789 74311

Design

## Pathway Design

Vijay Shah

Site

## Krishna 99

Nr. Tejendra Nagar, I.O.C.-Tragal Road, Chandkheda, Ahmedabad

### Structure

R. C.C. frame structure with bricks masonry partition Wall.

### Palster

Internal smooth finish palster with Lapi. external sand faced plaster with semi-acrylic paint.

### Flooring

Vitrified tiles flooring in entire Apartment.

### Doors & windows

Decorative main entrance door in wooden frame with S.S. fitting. All other door are flush door with oil paints & S.S. fittings. All windows are made of aluminum section with fittings.

### Toilets

Colour glazed tiles dado up to lintel level. Branded c.p. fittings. European type w.c pan in master bedroom toilet, orissa pan type w.c in common toilet.

### Kitchen

Mirror polished granite platform with glazed tiles dado up to lintel level with S.S. sink.

### Electrification

Single phased concealed copper wiring with adequate number of points in all rooms. One T.V. & Telephone points in drawing room. One A.C. point in master bedroom. One geyser point in bathroom.

### Terrace

open terrace to be finished with china-mosaic flooring.

### Rules & Regulations :

- Internal or external change shall not be permitted.
- GEB charges, LEGAL charges, AUDA, A.M.C., charges shall be borne by members.
- Stamp duty, registration fee, service tax & all other taxes shall be born by purchaser and applicable as per prevailing law.
- Maintenance deposit for common facilities shall be paid at the time of possession.
- Irregular payments shall cause cancellation of booking.
- This brochure is not be treated as part of the documents; it is an easy display and general information of this project.