

Key Plan

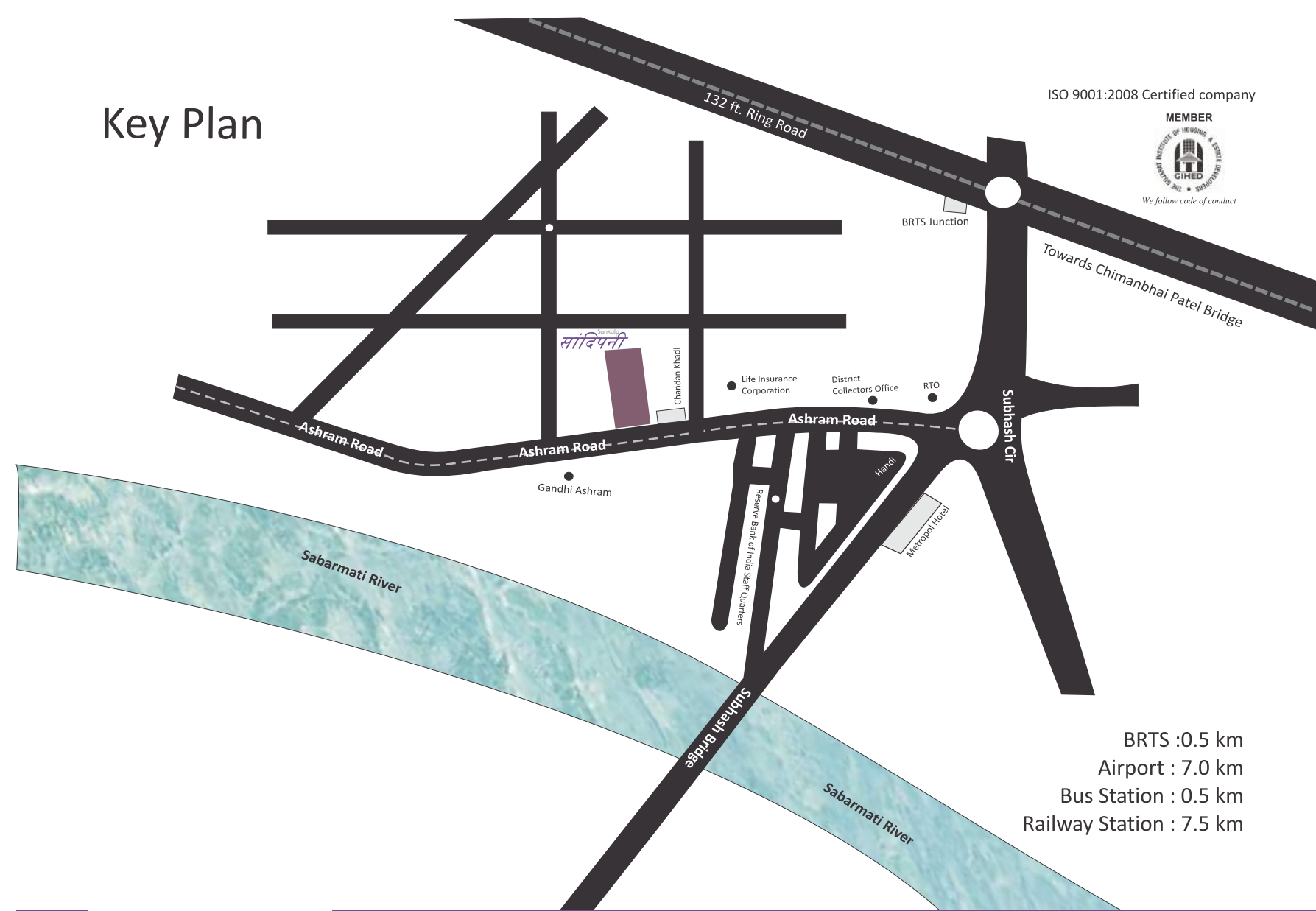

ISO 9001:2008 Certified company



BRTS : 0.5 km
Airport : 7.0 km
Bus Station : 0.5 km
Railway Station : 7.5 km



Corporate Office

Sankalp
Organisers Pvt.Ltd.

505, Iscon Elegance, Opp. Karnavati Club, S.G. Road, Ahmedabad-380 015.

Phone: 079-27445998 / 99 • Mobile : 98250 17433, 99257 67000

Mail : info@sankalporganisers.com • Web : www.sankalporganisers.com

Disclaimer

The information contained in this brochure is indicative of the kind of development that is proposed. It is prepared and issued in good faith and is for guidance only. It does not constitute part of an offer or contract. All plans, drawings, facilities are subject to the approval of the respective authorities and would be changed, if necessary and the developers reserve the right to change plan, specifications or features without prior notice or obligations. This brochure is not to be treated as part of legal document and is for an easy display of the project.

Architect -

Sankalp
सांदिपनी

2 & 3 BHK Lifestyle Apartments



Escape to a world where
Your Dreams Come True



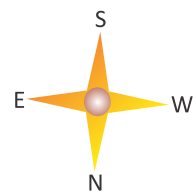

Site Plan



Sankalp
सांदिपनी

- | 40 Spacious Apartments | 2 BHK (20 Units) | 3 BHK (20 Units)
- | 5 Floor | 4 Apartments on each floor | Hi-Tech elevator

Block-A & B
 Unit Floor Plan
 3 BHK - 201 Sq. Yds.

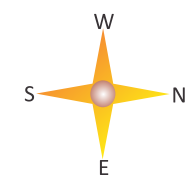

Block-A & B
 Unit Floor Plan
 2 BHK - 135 Sq. Yds.

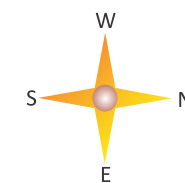

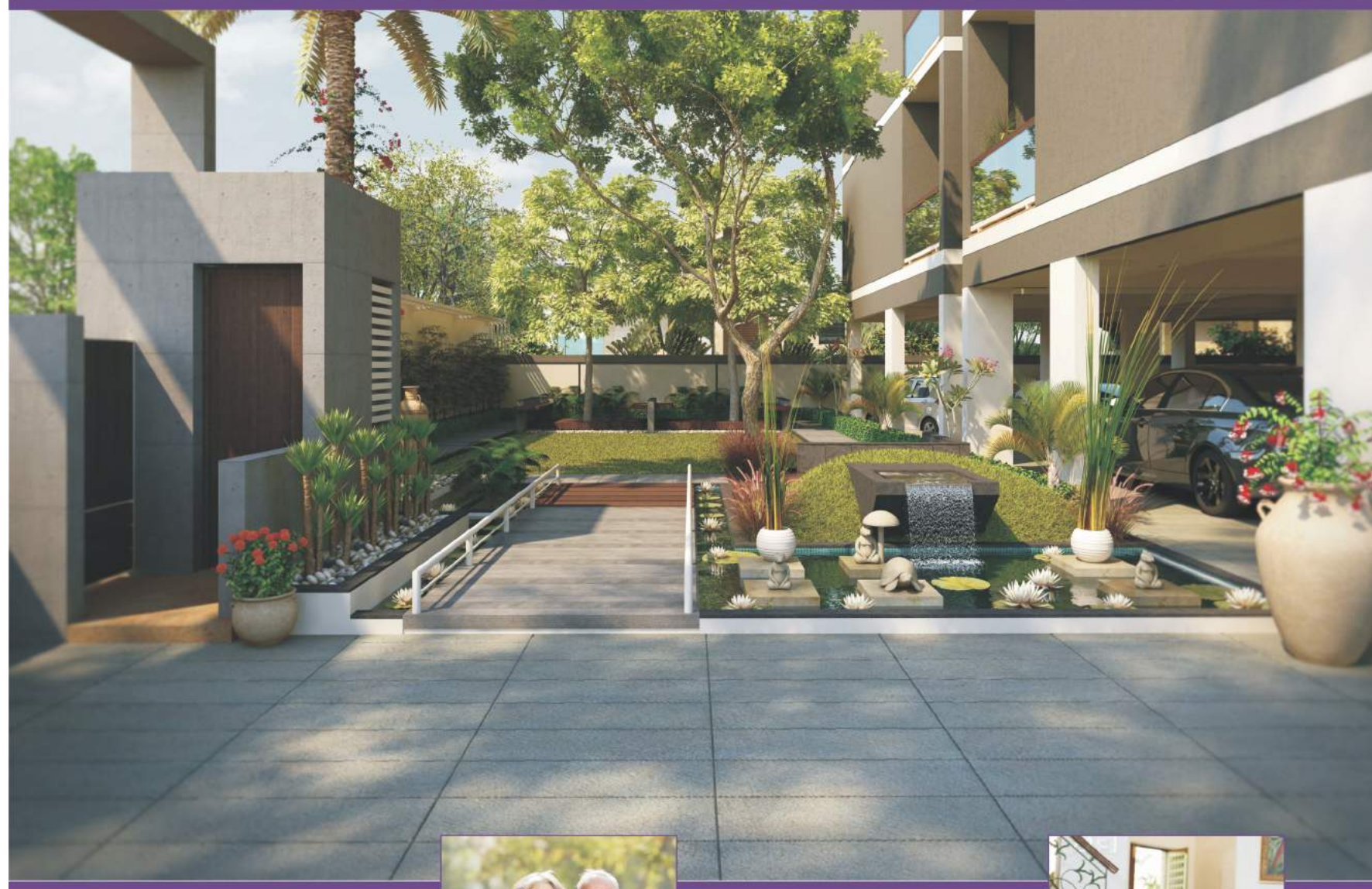

Provision for Terrace development



Fun, Fitness, Leisure...

FEATURES

- | Attractive entrance foyer | 24hrs security | Landscaped garden | Childrens' play area | Senior citizen sit-outs
- | 24hrs water supply with bore well | Allotted car parking in basement & ground level | Provision for piped gas supply in each apartment

Saffron
@Maninagar

Sankalp Square
@ Gurukul

Sankalp Grace
@Bodakdev

Sankalp Sapphire
@Prahladnagar

Sankalp Grace 2
@ Ambli Bopal Road

Sankalp Serenity
@ Off S.G. Highway

Successful Journey...



Specification

Structure :

Exclusive Earthquake resistant structure design with RCC shear wall

Flooring :

Vitrified tiles flooring in drawing/dining/ kitchen/ bedrooms

Kitchen :

Black granite platform with S.S. Sink and dado of ceramic tiles

Doors :

Decorative main door, wooden door frames. All other flush door with SS fitting

Windows :

Aluminum sliding windows with stone jamb

Wall Finish :

Internal wall with mala plaster & putty finish

Toilet :

Designer ceramic tiles on floor and dado up to lintel level

Electrification :

Three phase concealed copper wiring with adequate number of points.
Modular accessories with MCB