



WESTLINE CONSTRUCTIONS & DEVELOPMENTS

I thank you God for most this amazing day:
for the leaping greenly spirits of trees and a
blue true dream of sky;
and for everything which is natural which is
infinite which is a yes.

- E.E. Cummings

WESTLINE[®]
*Splendid
Homes...*

Kulashekar, Mangalore

PROJECT SYNOPSIS:

Project Name
Westline Splendid Homes

Type of Development
Contemporary Apartments
with Modern Amenities

Location
Kulashekar, Mangalore

No. of Units
48 Apartments

Structure
Ground + 4 Storeys
+1 Floor Amenities & Facilities

Studio Unit
490 sft

1 BHK Range
605, 650 and 725 sft

2 BHK Range
935, 990, 995, 1015 and 1080 sft

3 BHK Range
1360 and 1370 sft

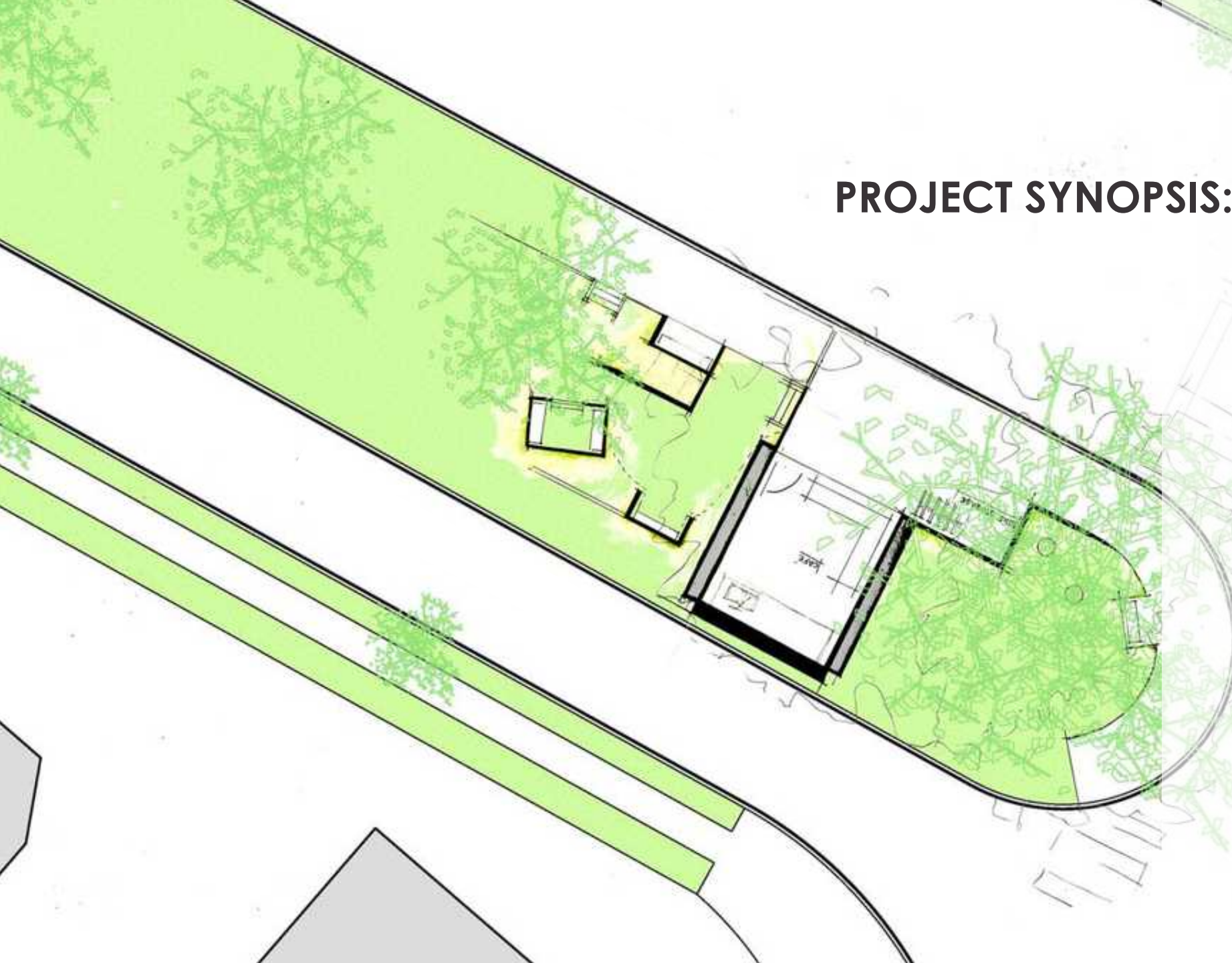

Amenities

Club House
Swimming Pool
Yoga - Aerobics Room
Gymnasium with panoramic city view
Jacuzzi
Indoor Games - Billiards Room
Court Library - Reading Room
Party Hall
Children's Play Area
Generator Back Up
Reticulated Gas Connections
Electronic Access Card
Security Surveillance Cameras
Telephone with Centrex Facility
Louvers for Utility Balconies
Security Personnel
Maintenance Staff
Superior Quality Construction
24X7 power and water provision



Things you should know

Building site elevated and have unrestricted and beautiful view of city and surroundings

Built on environment friendly concepts

Contemporary architecture

Thoughtfully designed homes with maximum privacy, comfort, natural light, cross ventilation and utilization of space.

Rain water harvesting system

Use of solar panels for hot water for common amenities

Municipality water and plenty of bore well for drinking water

Re-use of storm water & grey water



WESTLINE®
*Splendid
Homes...*

A grand north
entry elevation
of the project



WESTLINE®
*Splendid
Homes...*

CONTEMPORARY DESIGN
VAASTU COMPLIANT LAYOUTS



quality



A quality dwelling locality, a superior investment option

Kulashekara of Mangalore is habitually referred to as 'Serene Suburb'. It's quiet, friendly and sociable surroundings have crafted it as the most claimed locality. Mangalore's housing segment has noted these dynamics and consequently an exceptional consideration is given to this locality. This locale is consistently growing into a mega self sustainable suburb with all the infrastructures at an arm's length. It's proximity to the famous schools, the proposed super shopping malls, spiritual places, restaurants and other daily essentials making it an unsurpassed choice.

- Granite-Marble flooring for common areas and staircase.
- Attractive Melamine-PU Coated decorative front doors.
- Superior designer locks for doors.
- Putty finished painting for ceiling and walls.
- Texture paint spot finish for external walls.
- Concrete interlock paving for car parking, driveway and yard.
- First quality modular electrical switches.
- Top quality electrical wiring using Finolex, V-GUARD or equivalent
- Jindal or equivalent Aluminum Windows.
- Quality fixtures for Doors and windows.
- Overhead water tank and underground sump tank with required

specifications

Bedrooms



- Telephone Points in Master Bedroom
- Option of wooden or vitrified flooring for master bedroom
- AC point in Master bedroom
- Internet Provision in Master Bedroom
- Premium vitrified flooring in other bedrooms
- Two way light controls in master bedroom

Living-Dining



- TV and Telephone points in living room
- Intercom - Centrex Facility in Living room
- High Quality Vitrified Flooring

Balconies



- Contemporary balcony railings adhering to safety measures
- Ceramic or Terra-cotta anti skid tiles
- Electrical point for usage of laptops or other equipments
- Utility balconies covered with Aluminum Louvers for better aesthetics
- Toughened glass balconies with SS railings for the front elevation
- Waterproofing

Bathrooms



- Trendy glazed tiles dadoing
- Jaquar or equivalent CP fittings
- Hindware or equivalent sanitary ware
- Pressure checked plumbing and drainage lines to ensure total leak proof toilets
- Wall mount commodes with flush valves or cocks
- Shower head with hot and cold mixers
- Anti-skid ceramic tiles for bath room floors
- Health Faucet in all bathrooms
- Provisions for exhaust fan and ventilators
- Water proof treatment for sunken R.C.C slab

Kitchen



- Granite platform with stainless steel sink.
- Provision for washing machine in utility balcony.
- Adequate power points.
- Provisions for water purifier.
- Provisions for exhaust fan
- Power supply for refrigerator and microwave.
- Ample day light design

Elevator



- Otis or equivalent automatic lifts
- Stainless steel finish with attractive roof lights
- Risk free operation
- Emergency Alarm facility
- Floor notification facility

location map

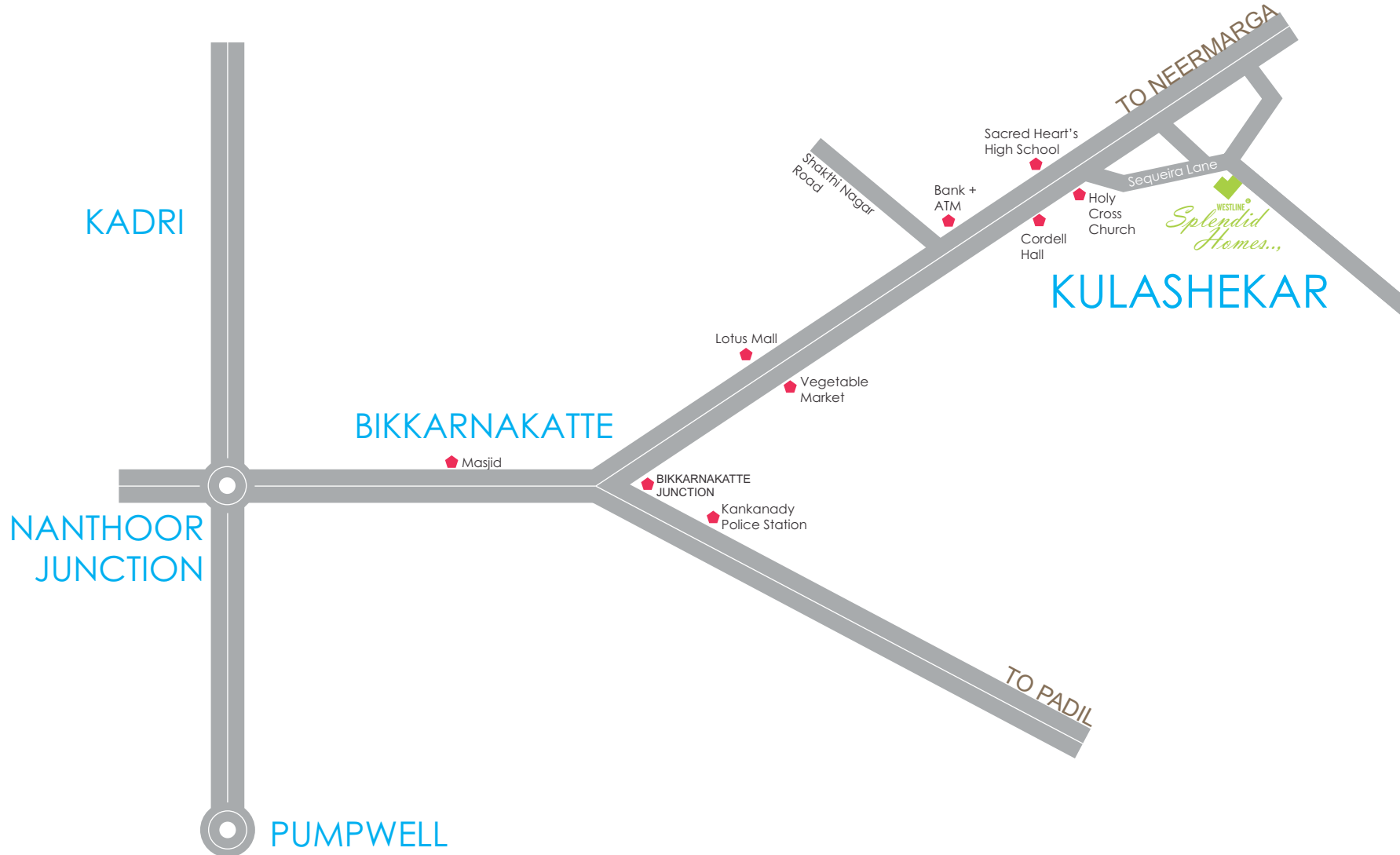

Educational Institutions

Sacred Heart Convent School	0.4 KMS
Cambridge School	1.6 KMS
Presidency School	4.3 KMS
St Joseph's Engineering College	3.9 KMS
Mangalore Marine College	7.0 KMS

Commute

Local Bus stop	0.2 KMS
Auto Stand	0.3 KMS
KSRTC BUS STAND	5.1 KMS
Railway Station	4.0 KMS
Airport	16 KMS

Convenience

Vegetable Market	1.2 KMS
Lotus Mall	1.2 KMS
Convenience Stores	0.3 KMS
Bank / ATMS	0.8 KMS
Clinics	0.7 KMS
Major Hospital	4.4 KMS
Police Station	1.5 KMS

Religious Places

Cordell church	0.4 KMS
Mosque	1.5 KMS
Temple	0.1 KMS

Other

Pilikula Golf Course	5.2 KMS
Pilikula Nisargadhama	5.8 KMS

ONGOING PROJECT



WESTLINE BONITA
NH66 THOKKOTTU, MANGALORE

UPCOMING PROJECTS



WESTLINE FAIRMONT
NANTHOOR, MANGALORE



WESTLINE EL-RIO
JEPPU, MANGALORE



WESTLINE GREEN SQUARE
BEJAI, MANGALORE



WESTLINE CONSTRUCTIONS & DEVELOPMENTS

Call
2444 444

WESTLINE CONSTRUCTIONS & DEVELOPMENTS PVT LTD
Mangalore Gate Building, First Floor
Kankanady Circle, Mangalore 575006

MO : 99022 03301
MO : 99000 33888
FX : 0824 2437 111
EM : properties@westlinebuilders.com

www.westlinebuilders.com