

A Project by



**GRUHASHILPI**  
CONSTRUCTIONS PVT. LTD.

# Gruhashilpi's *Shubhanjali*

enjoy every color of LIFE



# Gruhashilpi's *Shubhanjali*

enjoy every color of LIFE

Home is where the heart is, and Gruhashilpi's Shubhanjali is where the heart of the city is. Strategically Located 5min. away from Punjagutta Junction, near Srinagar Colony - Gruhashilpi's Shubhanjali offers vastu compliant, 2+ Study BHK/ 3 BHK spacious luxury living spaces.

The architecture, aesthetics and technology converge to create apartments that personify elegance and grandeur, for the unique, for the connoisseurs of finer things of life.

Come! Enjoy every color of life.

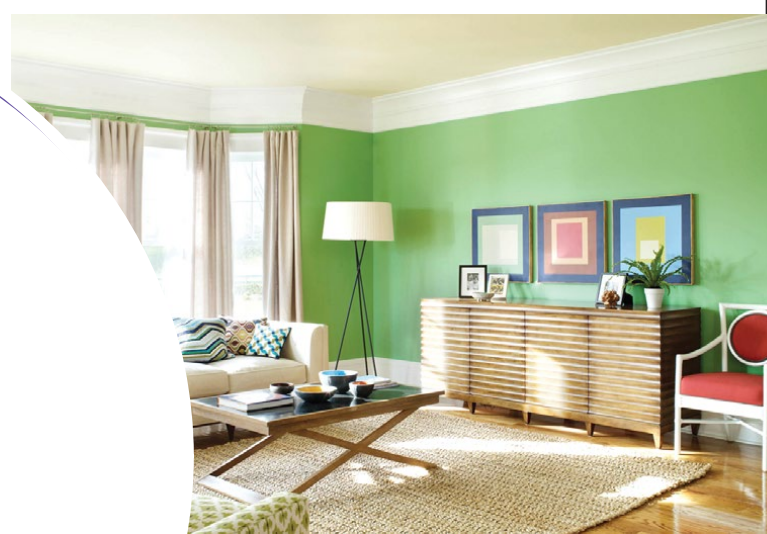

Addressing Unique Living Style



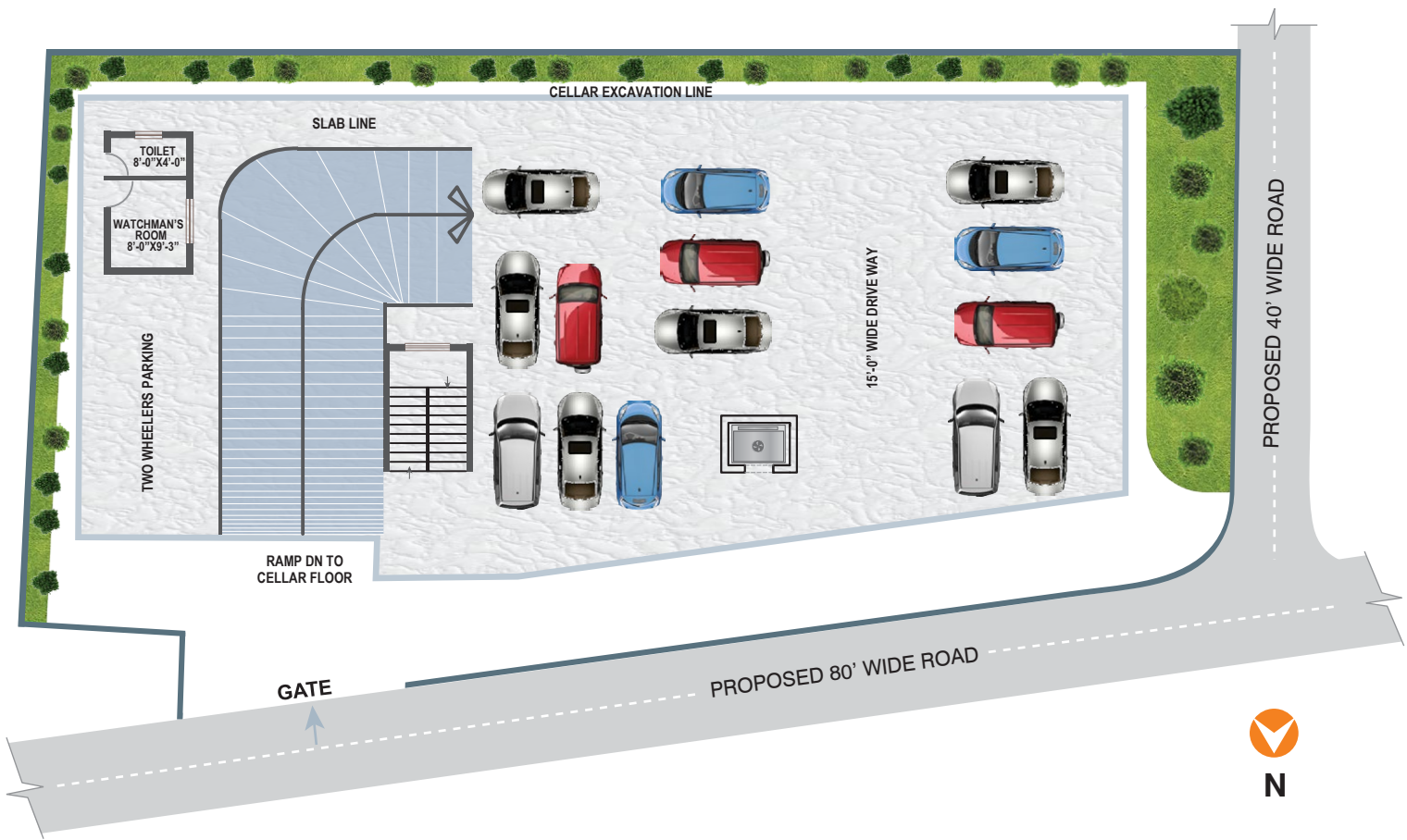

STILT FLOOR PLAN

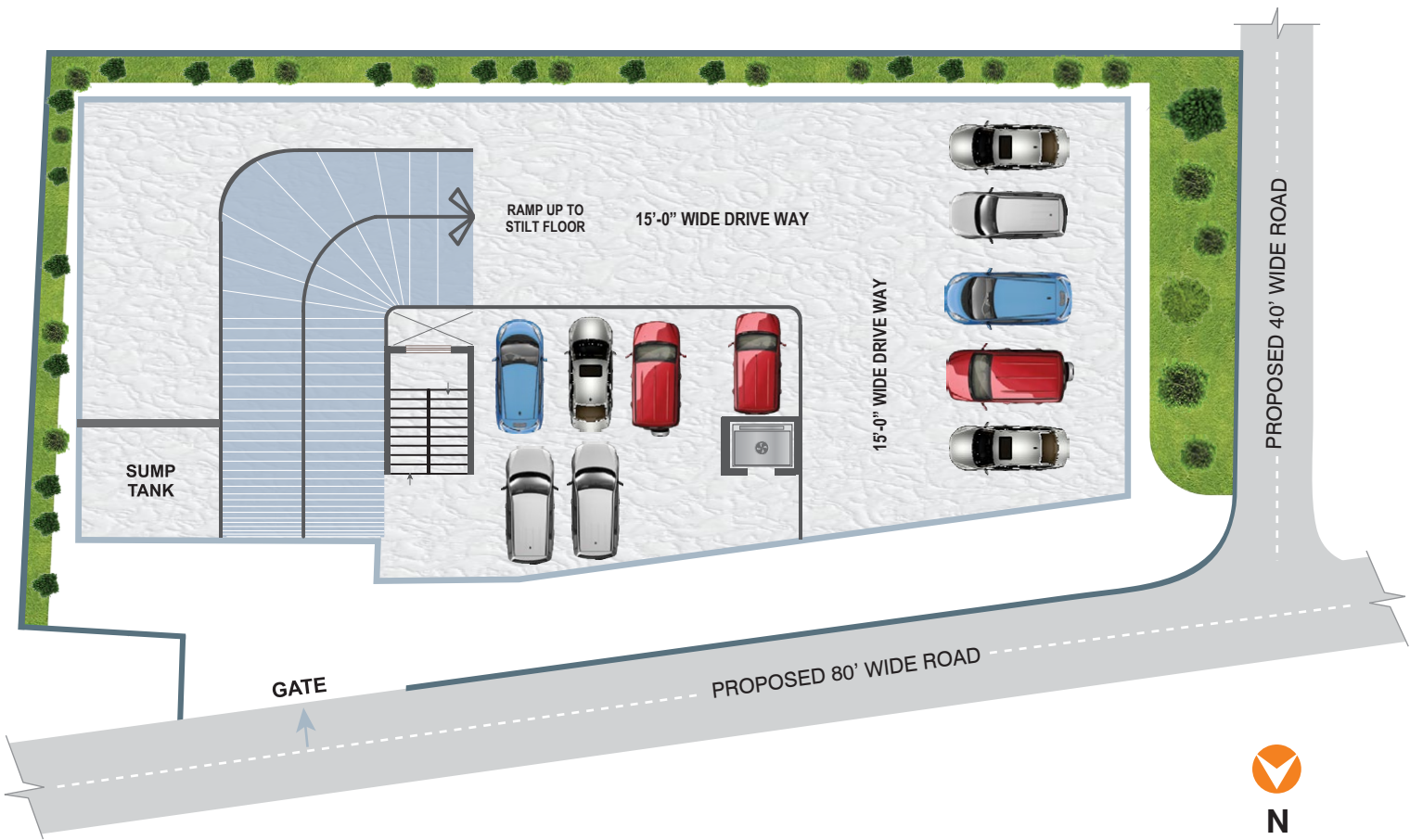

CELLAR FLOOR PLAN

PROPOSED 40' WIDE ROAD



PROPOSED 80' WIDE ROAD

AREA STATEMENT

















Flat No.	TYPE	Plinth Area in Sft.	Common Area in Sft.	Total Area in Sft.
1	3 BHK	1268	317	(A+B)=C 1585
2	2 1/2 BHK	999	249	1248
3	3 BHK	1288	322	1610

TYPICAL FLOOR PLAN



## SPECIFICATIONS

-  **Structure** : R.C.C. framed structure
-  **Superstructure** : Light weight brick work in Cement mortar with 9" external walls and 4½" internal walls.
-  **Plastering** : Internal double coat cement plaster with Birla white putty finish.  
External double coat sponge finish cement mortar with front side texture finish.
-  **Main Door** : Teak wood frame and shutter with S.S. fittings.
-  **Internal Doors** : Teak wood frames with one side teak veneer flush doors.
-  **Windows** : UPVC Windows
-  **Flooring** : 3' x 3' vitrified tiles for drawing, living, dining, 2'X2' vitrified tiles for bedrooms and balconies. Anti-skid ceramic tiles for bathrooms, kitchen and utility (Johnson or Kajaria make).
-  **Toilets** : CPVC piping with good quality fittings, ceramic tiles flooring, dado 7' height with glazed tiles. Provision for Geyser. (Hindware, Jaguar or Marc).
-  **Kitchen** : Granite platform with stainless steel sink. 3' height Dado with glazed tiles.
-  **Utility / Wash** : Glazed ceramic tiles dado upto 3' height. Provision for Washing Machine.
-  **Painting** : Internal doors and windows one side polished and other side painted. Internal walls with Plastic Emulsion. External walls with Apex or equivalent make.
-  **Electricals** : Adequate power and lighting points with concealed copper wiring with Modular Switches.  
  
Power outlets for Air Conditioners in bedrooms and hall 3-Phase supply for each flat.  
Telephone & TV cable in living room and bedrooms.  
(Finolex wire, Anchor Roma switches)
-  **Lift** : Six passenger capacity lift will be provided.
-  **Generator** : Generator for Lift, common lights and three points in each flat.  
(Mahindra or Kirloskar make)
-  **Parking Area** : Cement based tiles over PCC bed.

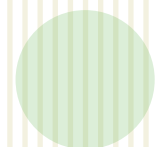
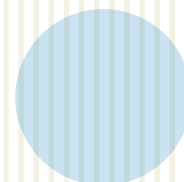

# LOCATION



**Site Address**  
**Gruhashilpi's Shubhanjali**  
 H.No. 8-3-835 & 836, Near Water Tank  
 Yellareddyguda, Hyderabad

**Architects**  
**Prasad Associates**  
 #104, First Floor, G.B.S. Enclave, Trimulgherry Main Road  
 Secunderabad - 500015. Ph: 2774 0550, 2774 0244.  
[www.PrasadAssociates.com](http://www.PrasadAssociates.com)

**Legal Advisor**  
**C. Prabhakar Rao**  
 Cell: 98490 12193

**Structural Engineers**  
**Consolidated Concept Consultants**  
 90, P & T Colony, Trimulgherry, Secunderabad-15.  
 Tel: 040 - 2774 2230, Cell: 9441491830



**Promoters & Builders:**  
**Gruhashilpi Constructions Pvt. Ltd.**  
 3-6-293, First Floor, Sesh Villas, Hyderguda, Hyderabad - 500 029. Call: 040 - 6625 0775, Mobile: 98480 19391  
 Fax : 040 - 2322 0775 E-mail: [gruhashilpiconstructions@gmail.com](mailto:gruhashilpiconstructions@gmail.com) web: [www.gruhashilpiconstructions.com](http://www.gruhashilpiconstructions.com)

Note : This brochure is a conceptual presentation of the project and not a legal offering.  
 The promoters reserve the right to alter and make changes in elevation, specifications and plans as deemed fit.